

C:\pw_work\mhoemke\d0831129_42 Alignment Sheet.dwg Dwg Created: 23-Feb-24 - _o2 standard bw.stb - Plot Date: 23-Feb-24

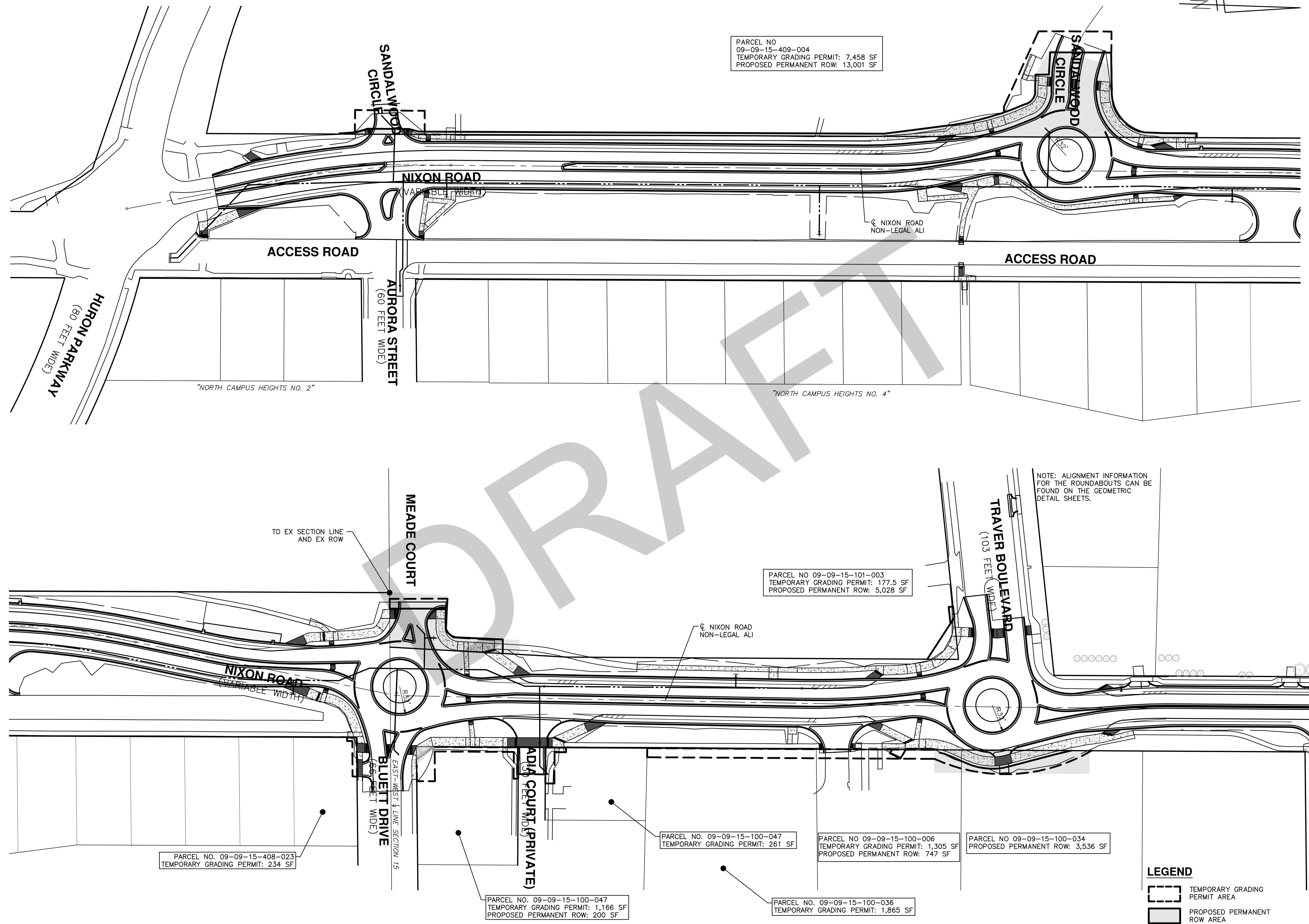

PARCEL NO 09-09-15-409-004
 TEMPORARY GRADING PERMIT: 7,458 SF
 PROPOSED PERMANENT ROW: 13,001 SF

PARCEL NO 09-09-15-101-003
 TEMPORARY GRADING PERMIT: 177.5 SF
 PROPOSED PERMANENT ROW: 5,028 SF

PARCEL NO. 09-09-15-408-023
 TEMPORARY GRADING PERMIT: 234 SF

PARCEL NO. 09-09-15-100-047
 TEMPORARY GRADING PERMIT: 1,166 SF
 PROPOSED PERMANENT ROW: 200 SF

PARCEL NO. 09-09-15-100-047
 TEMPORARY GRADING PERMIT: 261 SF

PARCEL NO 09-09-15-100-006
 TEMPORARY GRADING PERMIT: 1,305 SF
 PROPOSED PERMANENT ROW: 747 SF

PARCEL NO 09-09-15-100-034
 PROPOSED PERMANENT ROW: 3,536 SF

PARCEL NO. 09-09-15-100-036
 TEMPORARY GRADING PERMIT: 1,865 SF

LEGEND

- TEMPORARY GRADING PERMIT AREA
- PROPOSED PERMANENT ROW AREA

NOTE: ALIGNMENT INFORMATION FOR THE ROUNDABOUTS CAN BE FOUND ON THE GEOMETRIC DETAIL SHEETS.



CITY OF ANN ARBOR
 PUBLIC SERVICES
 301 EAST HURON STREET
 ANN ARBOR, MI 48106-8647
 www.a2gov.org



CITY OF ANN ARBOR - ENGINEERING
 NIXON ROAD
 #####
 ALIGNMENT SHEET

SCALE PLAN: 1" = 50'
 DRAWING No. 201-4000-20

REV.	DESCRIPTION	DATE	BY	CHECKED
00	COPY TO NEXT LINE AND EDIT THE TEXT			

C:\pw_work\mhoemke\d0831129\6 Alignment Sheet_2.dwg Dwg Created: 22-Feb-24 - _o2 standard bw.stb - Plot Date: 23-Feb-24

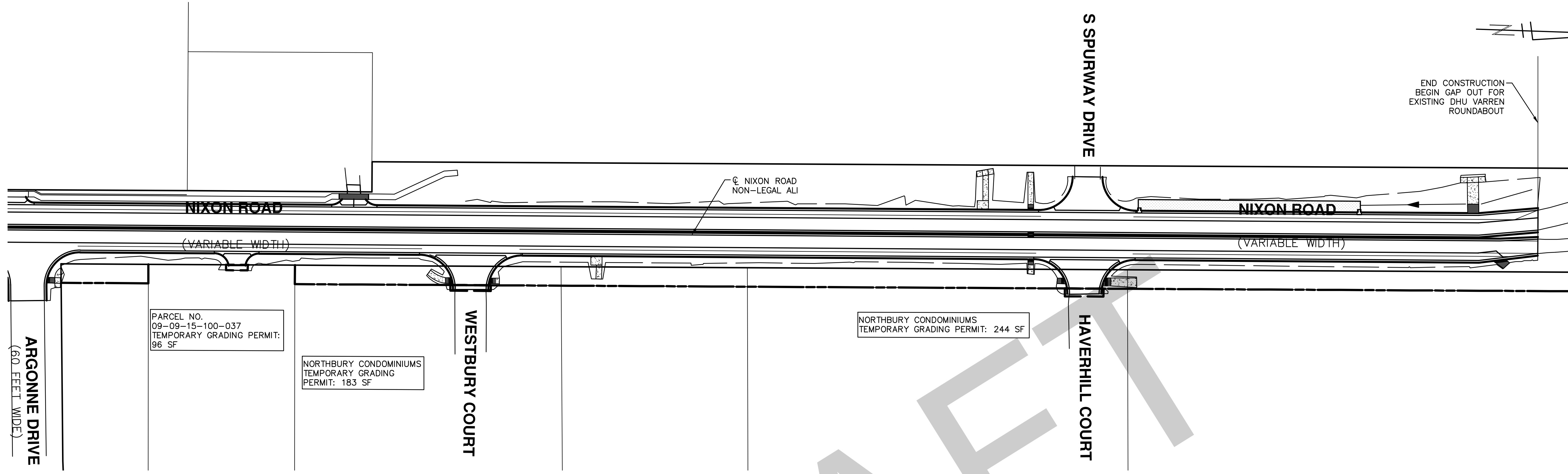



PARCEL NO.
09-09-15-100-037
TEMPORARY GRADING PERMIT:
96 SF

NORTHBURY CONDOMINIUMS
TEMPORARY GRADING
PERMIT: 183 SF

NORTHBURY CONDOMINIUMS
TEMPORARY GRADING PERMIT: 244 SF

LEGEND

-  TEMPORARY GRADING PERMIT AREA
-  PROPOSED PERMANENT ROW AREA



CITY OF ANN ARBOR
PUBLIC SERVICES
301 EAST HURON STREET
ANN ARBOR MI 48106-8647
www.a2gov.org

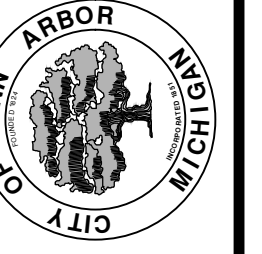

CITY OF ANN ARBOR - PUBLIC SERVICES - ENGINEERING
NIXON ROAD
ALIGNMENT SHEET

SCALE PLAN: 1" = 50'
DRAWING No. 201-4000-21

NO	REV	DESCRIPTION	DATE	BY	CHECKED