

From: [Victoria Green](#)
To: [Cameron Evans](#)
Cc: [Chludzinski, Adam](#); [Engineering](#); [City of Ann Arbor Transportation Commission](#); [Tony Bortz](#); [Eric Mergen](#); [Jared Carney](#)
Subject: Re: State Street closed Stimson to Packard rather than Arch to Packard?
Date: Wednesday, May 13, 2026 10:00:31 AM
Attachments: [image.png](#)
[image.png](#)

This message was sent from outside of the City of Ann Arbor. Please do not click links, open attachments, or follow directions unless you recognize the source of this email and know the content is safe.

Thank you! I super appreciate how you both jumped right on this.

I will let you know if the signs migrate again!

Gratefully,
Victoria

On Wed, May 13, 2026, 9:24 AM Cameron Evans [REDACTED] wrote:

Hi Victoria, Adam,

I walked this myself this morning, barricades were moved out of the bike lanes and into the road lanes as shown on our approved street plans (we had them set up properly so they must be getting moved by citizens), but as of this morning the signage is back in the street blocking the car lane to warn of closure / no thru traffic and you should be able to bike still as you get to Arch Street, and then you must detour.

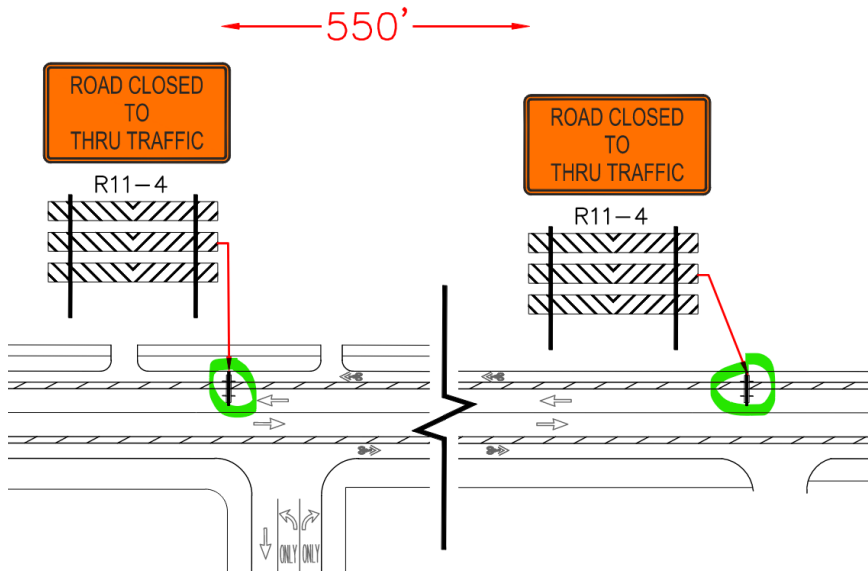

Thanks,

Cameron B. Evans
Project Manager

FINDORFF
Building & Beyond

findorff.com

*An **employee-owned** company.*

From: Chludzinski, Adam [REDACTED]
Sent: Wednesday, May 13, 2026 9:00 AM
To: Victoria Green [REDACTED]; Cameron Evans [REDACTED];
Engineering [REDACTED]; City of Ann Arbor Transportation Commission
[REDACTED]
Subject: Re: State Street closed Stimson to Packard rather than Arch to Packard?

CAUTION: This email originated from outside of Findorff's email system. Do not click on links or open attachments unless you were expecting this email. If you have questions or concerns please contact the IT Help Desk at (414) 977-4357.

Hi Victoria,

Bicycles are to be detoured from the work area on S State Street using the posted signed on Granger Avenue and Packard Street. The detour signage will be reviewed to make sure the bike lane is not blocked between Stimson Street and Granger Avenue.

Thank you,

Adam Chludzinski, Project Engineer

City of Ann Arbor | Engineering – Private Development
Guy C. Larcom City Hall | [301 E. Huron Street, Ann Arbor, MI 48104](http://301.E.Huron.Street.Ann.Arbor.MI.48104)

From: Victoria Green [REDACTED]
Sent: Tuesday, May 12, 2026 6:32 PM
To: Chludzinski, Adam [REDACTED]; [REDACTED]
Engineering [REDACTED] City of Ann Arbor Transportation Commission
[REDACTED]
Subject: State Street closed Stimson to Packard rather than Arch to Packard?

You don't often get email from [REDACTED] [Learn why this is](#)

[important](#)

This message was sent from outside of the City of Ann Arbor. Please do not click links, open attachments, or follow directions unless you recognize the source of this email and know the content is safe.

Hi, folks. [The city's posting](#) says State Street bike lanes are closed Arch to Packard.

But they are actually closed Stimson to Packard. Cars can go to Arch but not bikes.

Can you please advise whether you can open the bike lanes to what is listed or else amend the posting?

Thank you.
Victoria Green

Disclaimer

The information contained in this communication from the sender is confidential. It is intended solely for use by the recipient and others authorized to receive it. If you are not the recipient, you are hereby notified that any disclosure, copying, distribution or taking action in relation of the contents of this information is strictly prohibited and may be unlawful.

This email has been scanned for viruses and malware, and may have been automatically archived.