

**NOTE**

- 1. ALL ITEMS LISTED TO MEET THE FOLLOWING REQUIREMENTS:
- 2. ENERGY STAR CERTIFIED WATER HEATER OR TANKLESS WATER HEATER.
- 3. ENERGY STAR CERTIFIED APPLIANCES (OVEN, REFRIGERATOR, FREEZER).
- 4. ENERGY STAR CERTIFIED HEATING AND COOLING SYSTEMS (FURNACE, AIR CONDITIONING).
- 5. ENERGY STAR LIGHTING / FIXTURES.
- 6. ENERGY STAR CERTIFIED EXTERIOR DOORS.
- 7. WATER SOURCE LABELED FIXTURES.
- 8. CARBON FILTER / SCREENS FOR ODOR CONTROL.

**TYPICAL NOTES**

- 1. HARDWARE SELECTED BY OWNER.
- 2. DOOR HANDLES, PULLS, LATCHES LOCKS AND OTHER OPERATIONS TO BE AT 48" A.F.F. MAX. AND 34" A.F.F. MIN.
- 3. ALL EXIT DOORS TO BE EQUIPPED WITH PANIC DEVICE CLOSERS AND SHALL NOT LOCK AGAINST EGRESS OR OTHER HARDWARE.
- 4. LOCKING DEVICES TO BE ACTIVATED BY NO MORE THAN ONE-HALF TURN, ACTIVATED BY LEVER.
- 5. ALL DOOR HANDLES TO BE LEVER TYPE.
- 6. ALL MILLWORK/CASEWORK COUNTERTOPS TO HAVE A MAX. 3/4" HEIGHT A.F.F. UNLESS NOTED OTHERWISE.
- 7. OWNER TO PROVIDE VIDEO SURVEILLANCE THROUGHOUT INTERIOR AND EXTERIOR.
- 8. ALL DOORS SHALL CONSIST OF A COMMERCIAL-GRADE LOCKING MECHANISM.
- 9. SECURE (VAULT ROOM SHALL CONSIST OF A COMMERCIAL-GRADE LOCKING MECHANISM DIFFERENT THAN ALL OTHER DOORS).
- 10. EXTERIOR DOORS CONVEIENCED TO ALARM SYSTEM.

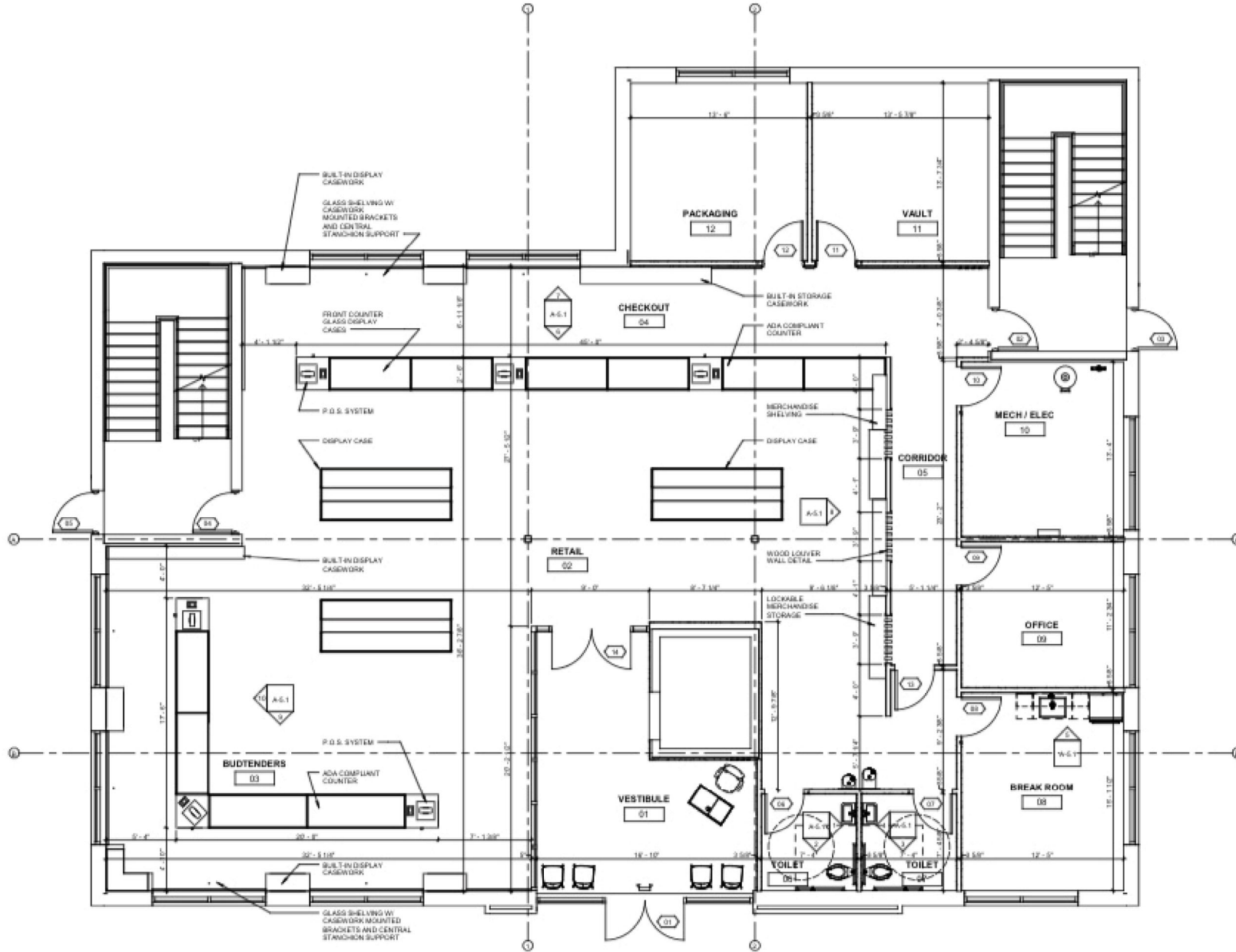

**1 MAIN LEVEL FLOOR PLAN**  
1/4" = 1'-0"  
NORTH



**OWNER**  
WM Solutions LLC  
22855 Northwestern Highway  
Farmington Hills, MI 48334

**PROJECT**  
Farm Farm  
3880 Research Park Drive, South  
Ann Arbor, MI 48106

**DRAWING**  
MAIN LEVEL FLOOR PLAN

**ISSUED FOR DATE**

NO.	DATE	DESCRIPTION

**JOB #** PROJ\_3320\_01  
**SHEET #** A-1.1

K170 Washington Blvd. Suite 430  
Farmington Hills, MI 48334  
616.333.5545  
616.333.5546  
616.333.5547  
www.thefarmshop.com