



Know what's below.
Call before you dig.

THE LOCATIONS OF EXISTING UNDERGROUND UTILITIES ARE SHOWN IN AN APPROXIMATE WAY ONLY AND HAVE NOT BEEN INDEPENDENTLY VERIFIED BY THE CONTRACTOR. THE CONTRACTOR SHALL DETERMINE THE EXACT LOCATION OF ALL EXISTING UTILITIES BEFORE COMMENCING WORK, AND AGREES TO BE FULLY RESPONSIBLE FOR ANY AND ALL DAMAGES WHICH MIGHT BE OCCASIONED BY THE CONTRACTOR'S FAILURE TO EXACTLY LOCATE AND PRESERVE ANY AND ALL UNDERGROUND UTILITIES.

NOTICE: CONSTRUCTION SITE SAFETY IS THE SOLE RESPONSIBILITY OF THE CONTRACTOR. NEITHER THE OWNER NOR THE ENGINEER SHALL BE EXPECTED TO ASSUME ANY RESPONSIBILITY FOR SAFETY OF THE WORK, OF PERSONS ENGAGED IN THE WORK, OF ANY NEARBY STRUCTURES, OR OF ANY OTHER PERSONS.

COPYRIGHT © 2023 ATWELL LLC. NO REPRODUCTION SHALL BE MADE WITHOUT THE PRIOR WRITTEN CONSENT OF ATWELL LLC.



SECTION 16
TOWN 02 SOUTH, RANGE 06 EAST
ANN ARBOR TOWNSHIP
WASHTENAW COUNTY, MICHIGAN

ROBERTSON BROTHERS
VILLAGE OF ANN ARBOR
EGLE IMPACT PLANS
EXISTING CONDITIONS

DATE
JANUARY 24TH, 2023

REVISIONS
SCALE 0 75 150
1" = 150 FEET
DRAWN BY: MB
CHECKED BY: BS
P.M.: PH
JOB #: 18002264
FILE CODE: -
SHEET NO. 02

EGLE
WBP/PTW/ML
Approved
Issued On: 06/20/2023
Expires On: 06/20/2023

A:\18002264\DWG\PLAN SET\EGLE\18002264\EGLE-02-EG.DWG, 2/15/2023, 2:31 PM, MADELINE BACH

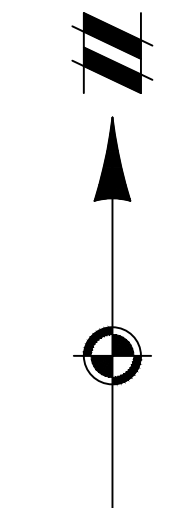

LEGEND	
	BOUNDARY LINE
	EXIST. EASEMENT
	SECTION LINE
	BOUNDARY/PROPERTY LINE
	SECTION CORNER
	EXIST. TREE LINE
	EXIST. FENCE
	EXIST. 1' CONTOUR
	EXIST. 5' CONTOUR
	EXIST. ASPHALT
	EXIST. GRAVEL
	EXIST. WATERS EDGE
	EXIST. SOILS
	MATCHLINE
	EXIST. BUILDING
	EXIST. WETLAND
	EXIST. WETLAND BUFFER
	SOIL BORING / TEST PIT
	EXIST. TREE (TO BE REMOVED)
	EXIST. WATER MAIN
	EXIST. SANITARY
	EXIST. GAS
	EXIST. STORM
	EXIST. OVERHEAD ELEC. LINE
	EXIST. OVERHEAD TELE. LINE
	EXIST. CABLE LINE
	EXIST. UNDERGROUND TELE. LINE
	EXIST. CULVERT
	EXIST. CATCH BASIN/INLET
	EXIST. VALVE
	EXIST. HYDRANT
	EXIST. SANITARY SEWER
	EXIST. UNSPECIFIED UTILITY
	EXIST. SIGN
	EXIST. LIGHT POLE
	EXIST. UTILITY POLE
	EXISTING TELEPHONE RISER
	EXISTING MAILBOX
	EXISTING WELL



Know what's below.
Call before you dig.

THE LOCATIONS OF EXISTING UNDERGROUND UTILITIES ARE SHOWN IN AN APPROXIMATE WAY ONLY AND HAVE NOT BEEN INDEPENDENTLY VERIFIED BY THE OWNER OR ITS REPRESENTATIVE. THE CONTRACTOR SHALL DETERMINE THE EXACT LOCATION OF ALL EXISTING UTILITIES BEFORE COMMENCING WORK, AND AGREES TO BE FULLY RESPONSIBLE FOR ANY AND ALL DAMAGES WHICH MIGHT BE OCCASIONED BY THE CONTRACTOR'S FAILURE TO EXACTLY LOCATE AND PRESERVE ANY AND ALL UNDERGROUND UTILITIES.

NOTICE: CONSTRUCTION SITE SAFETY IS THE SOLE RESPONSIBILITY OF THE CONTRACTOR. NEITHER THE OWNER NOR THE ENGINEER SHALL BE EXPECTED TO ASSUME ANY RESPONSIBILITY FOR SAFETY OF THE WORK, OF PERSONS ENGAGED IN THE WORK, OF ANY NEARBY STRUCTURES, OR OF ANY OTHER PERSONS.

COPYRIGHT © 2023 ATWELL LLC. NO REPRODUCTION SHALL BE MADE WITHOUT THE PRIOR WRITTEN CONSENT OF ATWELL LLC.



SECTION 16
TOWN 02 SOUTH, RANGE 06 EAST
ANN ARBOR TOWNSHIP
WASHTENAW COUNTY, MICHIGAN

ROBERTSON BROTHERS
VILLAGE OF ANN ARBOR
EGLE IMPACT PLANS
MITIGATION TRANSECTS

DATE
JANUARY 24TH, 2023

REVISIONS table with columns for description and date.

SCALE 0 2.5 5
1" = 5 FEET
DRAWN BY: MB
CHECKED BY: BS
P.M.: PH
JOB #: 18002264
FILE CODE: -
SHEET NO. 06

Approved
Issued On: 06/20/2023
Expires On: 06/20/2023

SCRUB-SHRUB &
EMERGENT
MITIGATION WETLAND
±0.068 ACRES
(±2,962.08 SF)

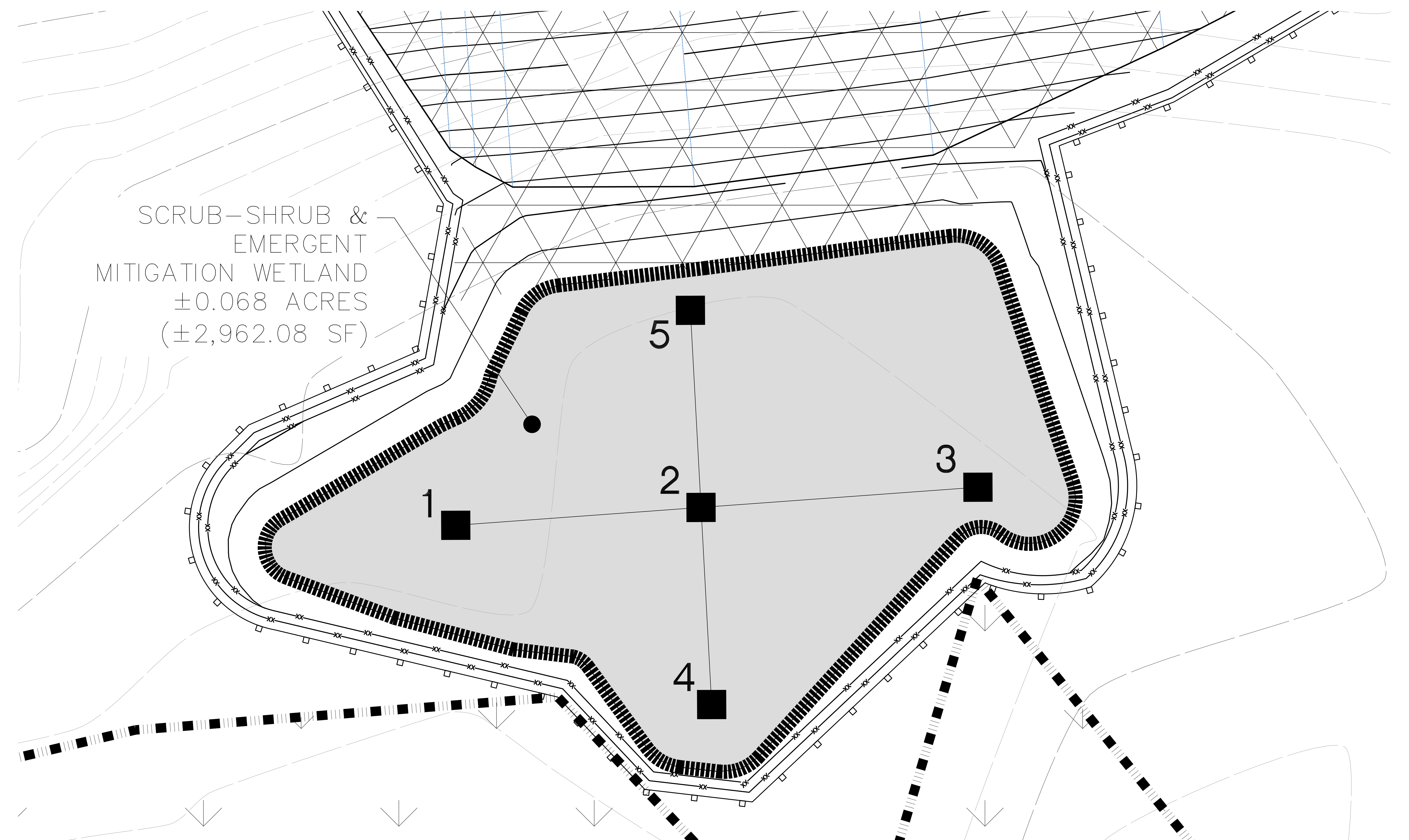

LEGEND table with symbols for boundary lines, contours, wetlands, and transects.

PLAN SET: EGLE\18002264\EGLE-05-MITD.DWG 2/15/2023 2:34 PM MADELINE BACH

CAD FILE: 18002264EGLE-05-MITD.DWG

