

**ANN ARBOR HISTORIC DISTRICT COMMISSION****Staff Report****ADDRESS:** 512 W William Street, Application Number HDC18-150**DISTRICT:** Old West Side Historic District**REPORT DATE:** September 20, 2018**REPORT PREPARED BY:** Jill Thacher, Historic Preservation Coordinator**REVIEW COMMITTEE DATE:** September 17, 2018

	<b>OWNER</b>	<b>APPLICANT</b>
<b>Name:</b>	Erin Cech & Heidi Sherick	Kingdom Construction/Chad Zabin
<b>Address:</b>	512 W William Ann Arbor, MI 48103	498 Farmer St Plymouth, MI 48170
<b>Phone:</b>	(405) 580-4063	(734) 927-5227

**BACKGROUND:** This 1 ¾ story gable-fronter features a shingled second floor, wood lap siding on the first floor, and gable corner returns. The front porch is not original. The house originally had a full-width front porch, which was removed after 1948 (when it still appears on a Sanborn Fire Insurance Map).

**LOCATION:** The site is located on the north side of West William Street between Third and Fourth Streets.

**APPLICATION:** The applicant seeks HDC approval to construct a single-car garage at the northwest corner of the site, and extend the driveway.

**APPLICABLE REGULATIONS:****From the Secretary of the Interior's Standards for Rehabilitation:**

- (2) The historic character of a property will be retained and preserved. The removal of distinctive materials or alteration of features, spaces, and spatial relationships that characterize a property will be avoided.
- (9) New additions, exterior alterations, or related new construction shall not destroy historic materials that characterize the property. The new work shall be differentiated from the old and shall be compatible with the massing, size, scale, and architectural features to protect the historic integrity of the property and its environment.
- (10) New additions and adjacent or related new construction will be undertaken in such a manner that, if removed in the future, the essential form and integrity of the historic property will be unimpaired.

**From the Secretary of the Interior's Guidelines for Rehabilitating Historic Buildings (other SOI Guidelines may also apply):**

**Building Site**

Recommended: Designing new exterior additions to historic buildings or adjacent new construction which is compatible with the historic character of the site and which preserve the historic relationship between a building or buildings, landscape features, and open space.

Retaining the historic relationship between buildings, landscape features, and open space.

Identifying, retaining, and preserving buildings and their features as well as features of the site that are important in defining its overall historic character.

Not Recommended: Introducing new construction onto the building site which is visually incompatible in terms of size, scale, design, materials, color and texture or which destroys historic relationships on the site.

**From the Ann Arbor Historic District Design Guidelines (other Guidelines may apply):****Residential Accessory Structures**

Not Appropriate: Introducing new structures or site features that are out of scale with the property or the district or are otherwise inappropriate.

**STAFF FINDINGS:**

1. The new garage would be located at the end of the existing driveway off West William Street. There is currently a driveway that ends at the back wall of the house. That driveway would be extended with a concrete pad that is 9' at the driveway and about 16' wide at the garage.
2. The proposed garage is 12'8" wide and 21'8" deep. It features a roll-up overhead vehicle door (Clopay brand, with small panels) and a person door on the east side (facing the backyard). The 8:12 roof has vinyl soffits. Cladding is dark gray 4" vinyl with aluminum trim.
3. Since this is a modern building at the rear of the lot, staff believes that the proposed materials are appropriate. The garage is small, and the design is simple. It is logically sited on the lot and won't negatively affect neighboring historic structures.
4. A zoning review will be required before permits may be issued, if the application is approved.
5. Staff recommends approval of the application. The proposed garage is appropriately sized, does not detract from the historic house, and the design and materials are compatible with the historic house and neighboring historic structures.

**MOTION**

I move that the Commission issue a certificate of appropriateness for the application at 512 W William Street, a contributing property in the Old West Side Historic District, to

construct a single-story garage, as proposed. The work is compatible in exterior design, arrangement, materials, and relationship to the house and the surrounding area and meets *The Secretary of the Interior's Standards for Rehabilitation and Guidelines for Rehabilitating Historic Buildings*, in particular standards 2, 9, and 10 and the guidelines for building site, as well as the *Ann Arbor Historic District Design Guidelines*, particularly as they pertain to residential accessory structures.

**ATTACHMENTS:** application, drawings.

512 W William (staff photo, 2008)





# HISTORIC DISTRICT COMMISSION

## PLANNING AND DEVELOPMENT SERVICES

City Hall: 301 E. Huron St. Ann Arbor, MI 48104-6120  
 Mailing: P.O. Box 8647, Ann Arbor, MI 48107-8647  
 Phone: 734.794.6265 ext. 42608 [itthacher@a2gov.org](mailto:itthacher@a2gov.org)  
 Fax: 734.994.8460

APPLICATION MUST BE FILLED OUT COMPLETELY

OFFICE USE ONLY	
Permit Number	HDC# 18-150
	BLDG# 18-1469
DATE STAMP	
CITY OF ANN ARBOR RECEIVED	
JUL 09 2018	
PLANNING & DEVELOPMENT SERVICES	

### PROPERTY LOCATION/OWNER INFORMATION

NAME OF PROPERTY OWNER Erin Cech & Heidi Shenick		HISTORIC DISTRICT
PROPERTY ADDRESS 512 West William		CITY ANN ARBOR
ZIP CODE 48103	DAYTIME PHONE NUMBER (405) 580-4063	EMAIL ADDRESS erinacech@gmail.com
PROPERTY OWNER'S ADDRESS (IF DIFFERENT FROM ABOVE)		CITY STATE, ZIP

### PROPERTY OWNER'S SIGNATURE

SIGN HERE	PRINT NAME	DATE
-----------	------------	------

### APPLICANT INFORMATION

NAME OF APPLICANT (IF DIFFERENT FROM ABOVE) Kingdom Construction / Chad Zabik				
ADDRESS OF APPLICANT 498 Farmer St			CITY Plymouth	
STATE MI	ZIP CODE 48170	PHONE / CELL # (734) 927-5227	FAX No ( )	
EMAIL ADDRESS				

### APPLICANT'S SIGNATURE (if different from Property Owner)

SIGN HERE	PRINT NAME	DATE
-----------	------------	------

### BUILDING USE - CHECK ALL THAT APPLY

<input checked="" type="checkbox"/> SINGLE FAMILY	<input type="checkbox"/> DUPLEX	<input type="checkbox"/> RENTAL	<input type="checkbox"/> MULTIPLE FAMILY	<input type="checkbox"/> COMMERCIAL	<input type="checkbox"/> INSTITUTIONAL
---	---------------------------------	---------------------------------	--	-------------------------------------	--

### PROPOSED WORK

Describe in detail each proposed exterior alteration, improvement and/or repair (use additional paper, if necessary).

Building a 1 car garage - 12x20 w/ Double 4" Vinyl Siding

### DESCRIBE CONDITIONS THAT JUSTIFY THE PROPOSED CHANGES:

They need a garage and there is not one that currently exists

For Further Assistance With Required Attachments, please visit [www.a2gov.org/help](http://www.a2gov.org/help)





# HISTORIC DISTRICT COMMISSION APPLICATION

## FEE CHART

DESCRIPTION	
<b>STAFF REVIEW FEES</b>	
Application for Staff Approval	\$35.00
Work started without approvals	Additional \$50.00
<b>HISTORIC DISTRICT COMMISSION FEES</b>	
All other proposed work not listed below	\$100.00
Work started without approvals	Additional \$250.00
<b>RESIDENTIAL – Single and 2-story Structure</b>	
Addition: single story	\$300.00
Addition: taller than single story	\$550.00
New Structure - Accessory	\$100.00
New Structure – Principal	\$850.00
Replacement of single and 2-family window(s)	\$100 + \$25/window
<b>COMMERCIAL – includes multi-family (3 or more unit) structures</b>	
Additions	\$700.00
Replacement of multi-family and commercial window (s)	\$100 + \$50/window
Replacement of commercial storefront	\$250.00
<b>DEMOLITION and RELOCATION</b>	
Demolition of a contributing structure	\$1000.0
Demolition of a non-contributing structure	\$250.00
Relocation of a contributing structure	\$750.00
Relocation of a non-contributing structure	\$250.00

### FOR COMMISSION REVIEWS:

- Application withdrawals made before public notice is published will qualify for a 50% refund of the application fee.
- Application withdrawals made after public notice is sent but before the public hearing will qualify for a 25% refund of the application fee.

## INSTRUCTIONS FOR SUBMITTING APPLICATIONS

All HDC applications must be signed by the property owner and the applicant, if different, with the exception of staff approvals, which may be signed by only the applicant.

All completed HDC applications and their attachments may be submitted to Planning and Development Services by mail, in person (paper or digital), faxed, or via email to [building@a2gov.org](mailto:building@a2gov.org).

We accept CASH, CHECK, and all major credit cards. Checks should be made payable to "City of Ann Arbor"

HDC applications that are incomplete or not submitted with the required documentation or payment will not be processed or approved.

### APPLICATION EXPIRATION

HDC applications expire three (3) years after the date of approval.

### OFFICE USE ONLY

Date of Hearing:		
Action	<input type="checkbox"/> HDC COA	<input type="checkbox"/> HDC Denial
	<input type="checkbox"/> HDC NTP	<input type="checkbox"/> Staff COA
Staff Signature		
Comments		
Fee:	\$ _____	
Payment Type	<input type="checkbox"/> Check: # _____ <input type="checkbox"/> Cash <input type="checkbox"/> Credit Card	



# HISTORIC DISTRICT COMMISSION

## PLANNING AND DEVELOPMENT SERVICES

City Hall: 301 E. Huron St. Ann Arbor, MI 48104-6120  
 Mailing: P.O. Box 8647, Ann Arbor, MI 48107-8647  
 Phone: 734.794.6265 ext. 42608 [jthacher@a2gov.org](mailto:jthacher@a2gov.org)  
 Fax: 734.994.8460

OFFICE USE ONLY	
Permit Number	HDC#
	BLDG#
DATE STAMP	

APPLICATION MUST BE FILLED OUT COMPLETELY

### PROPERTY LOCATION/OWNER INFORMATION

NAME OF PROPERTY OWNER Erin Cech & Heidi Sherick		HISTORIC DISTRICT	
PROPERTY ADDRESS 512 West William		CITY ANN ARBOR	
ZIP CODE 48103	DAYTIME PHONE NUMBER (405) 580-4063	EMAIL ADDRESS erinacech@gmail.com	
PROPERTY OWNER'S ADDRESS (IF DIFFERENT FROM ABOVE)		CITY	STATE, ZIP

### PROPERTY OWNER'S SIGNATURE

SIGN HERE	<i>Erin Cech</i>	PRINT NAME	Erin A. Cech	DATE	7/29/18
-----------	------------------	------------	--------------	------	---------

### APPLICANT INFORMATION

NAME OF APPLICANT (IF DIFFERENT FROM ABOVE) Kingdom construction / Chad Zabik				CITY Plymouth	
ADDRESS OF APPLICANT 498 Farmer St				CITY Plymouth	
STATE MI	ZIP CODE 48170	PHONE / CELL # (734) 927-5227	FAX No ( )		
EMAIL ADDRESS					

### APPLICANT'S SIGNATURE (if different from Property Owner)

SIGN HERE	<i>CJZ</i>	PRINT NAME	Chad Zabik	DATE	7/29/18
-----------	------------	------------	------------	------	---------

### BUILDING USE - CHECK ALL THAT APPLY

<input checked="" type="checkbox"/> SINGLE FAMILY	<input type="checkbox"/> DUPLEX	<input type="checkbox"/> RENTAL	<input type="checkbox"/> MULTIPLE FAMILY	<input type="checkbox"/> COMMERCIAL	<input type="checkbox"/> INSTITUTIONAL
---	---------------------------------	---------------------------------	--	-------------------------------------	--

### PROPOSED WORK

Describe in detail each proposed exterior alteration, improvement and/or repair (use additional paper, if necessary).

Building a 1 car garage - 12x20 w/ Double 4" Vinyl siding

### DESCRIBE CONDITIONS THAT JUSTIFY THE PROPOSED CHANGES:

They need a garage and there is not one that currently exists

For Further Assistance With Required Attachments, please visit [www.a2gov.org/hdc](http://www.a2gov.org/hdc)

APPLICATION CONTINUED ON OTHER SIDE

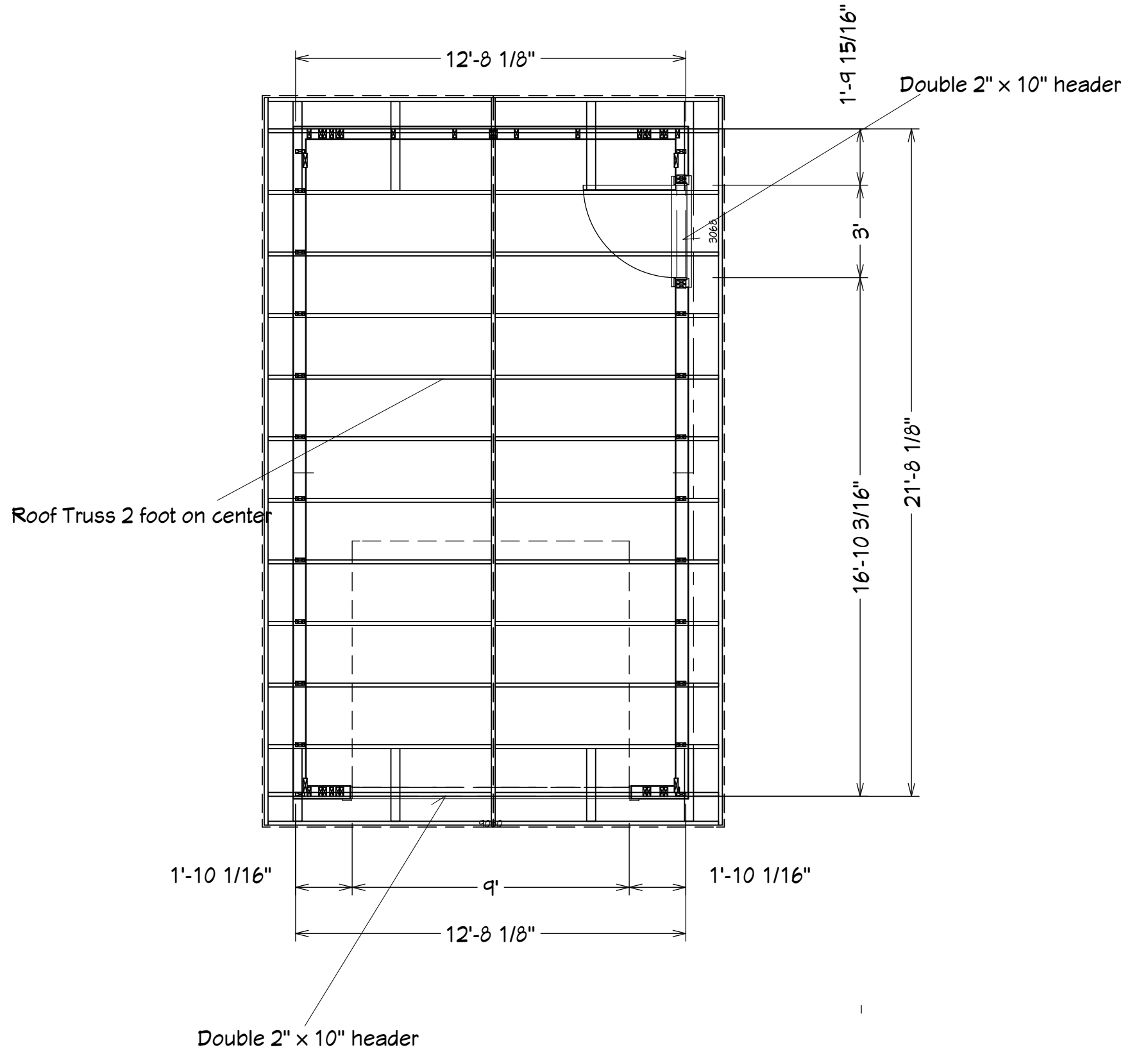
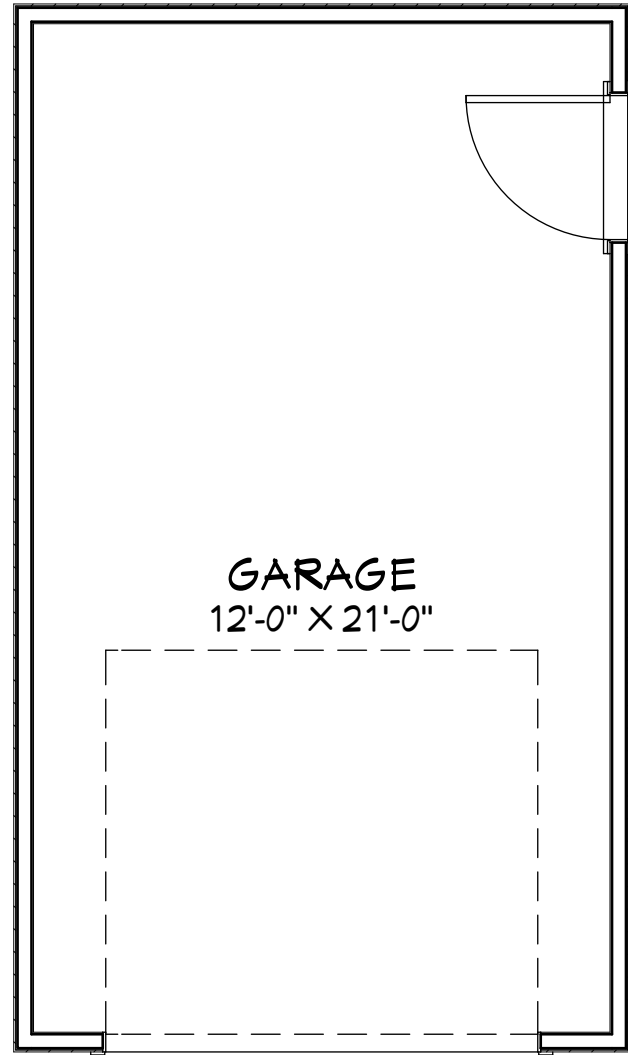



South Elevation	
Cech Garage	Scale 1/4" = 1'



East Elevation
Cech Garage   Scale 1/4" = 1'

Elevation 7



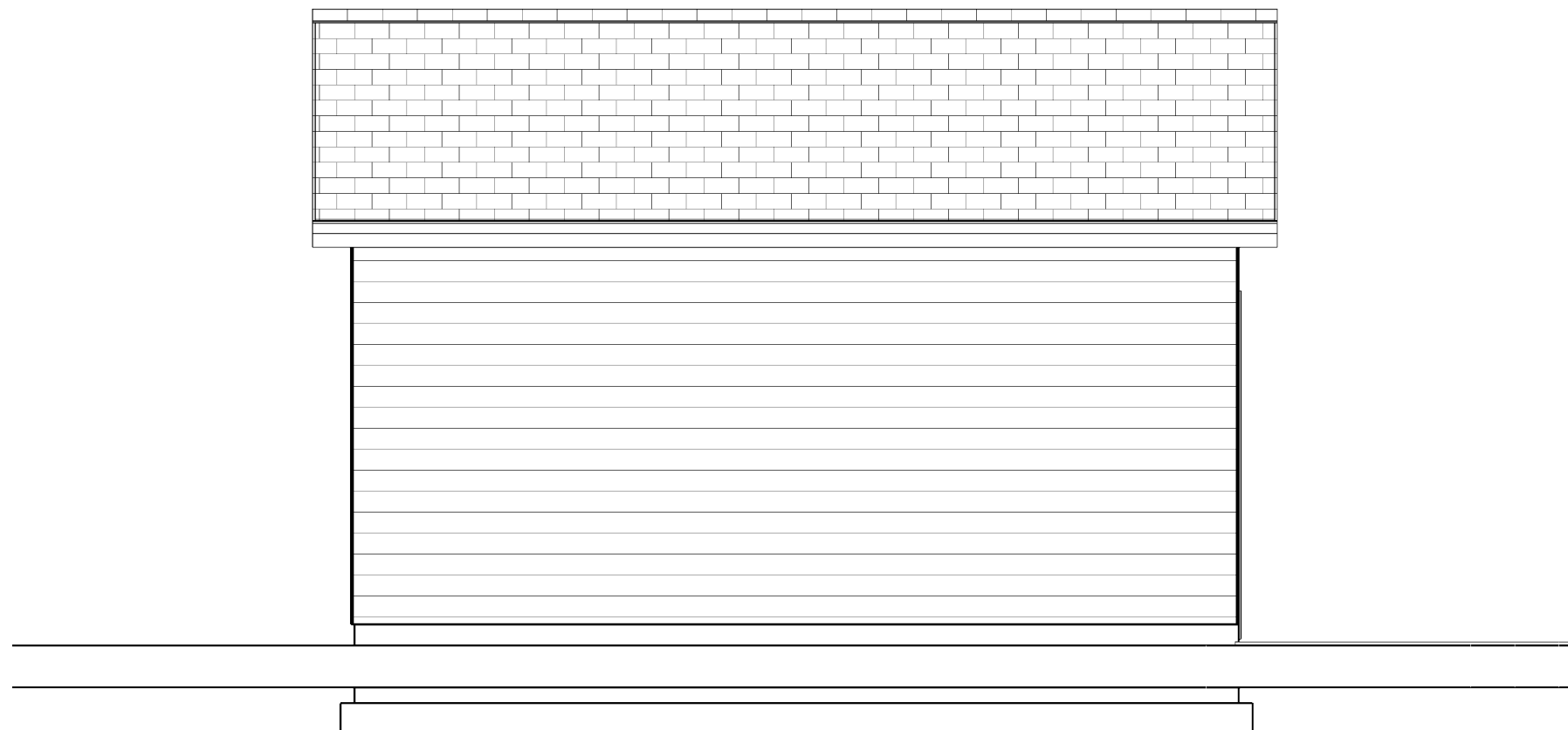

West Elevation
Cech Garage Scale 1/4" = 1'

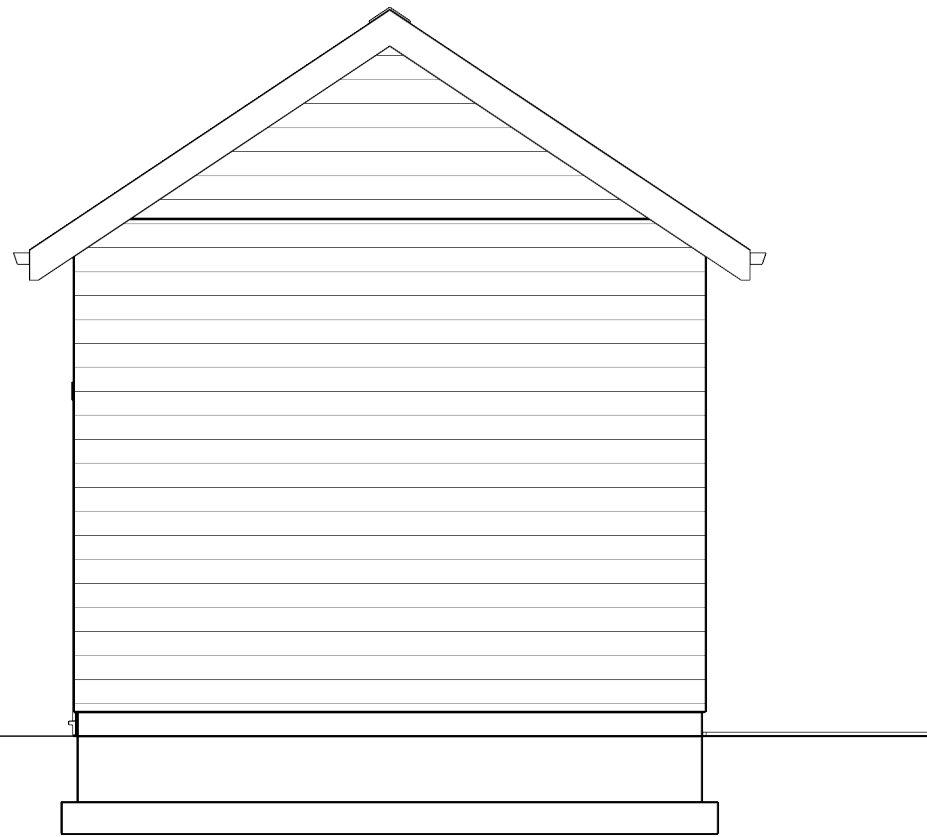

North Elevation	
Cech Garage	Scale 1/4" = 1'



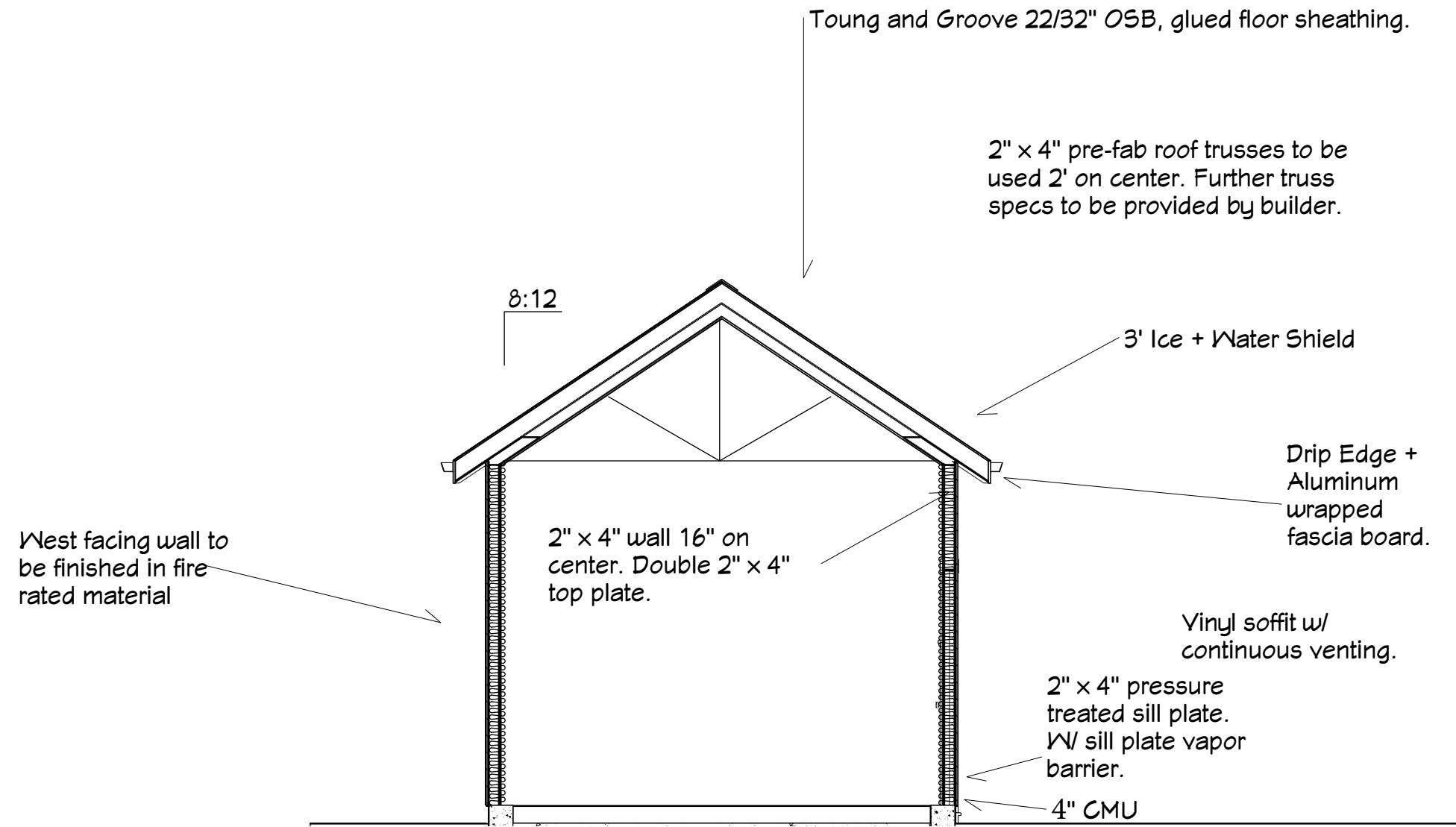

Foundation Diagram not to scale

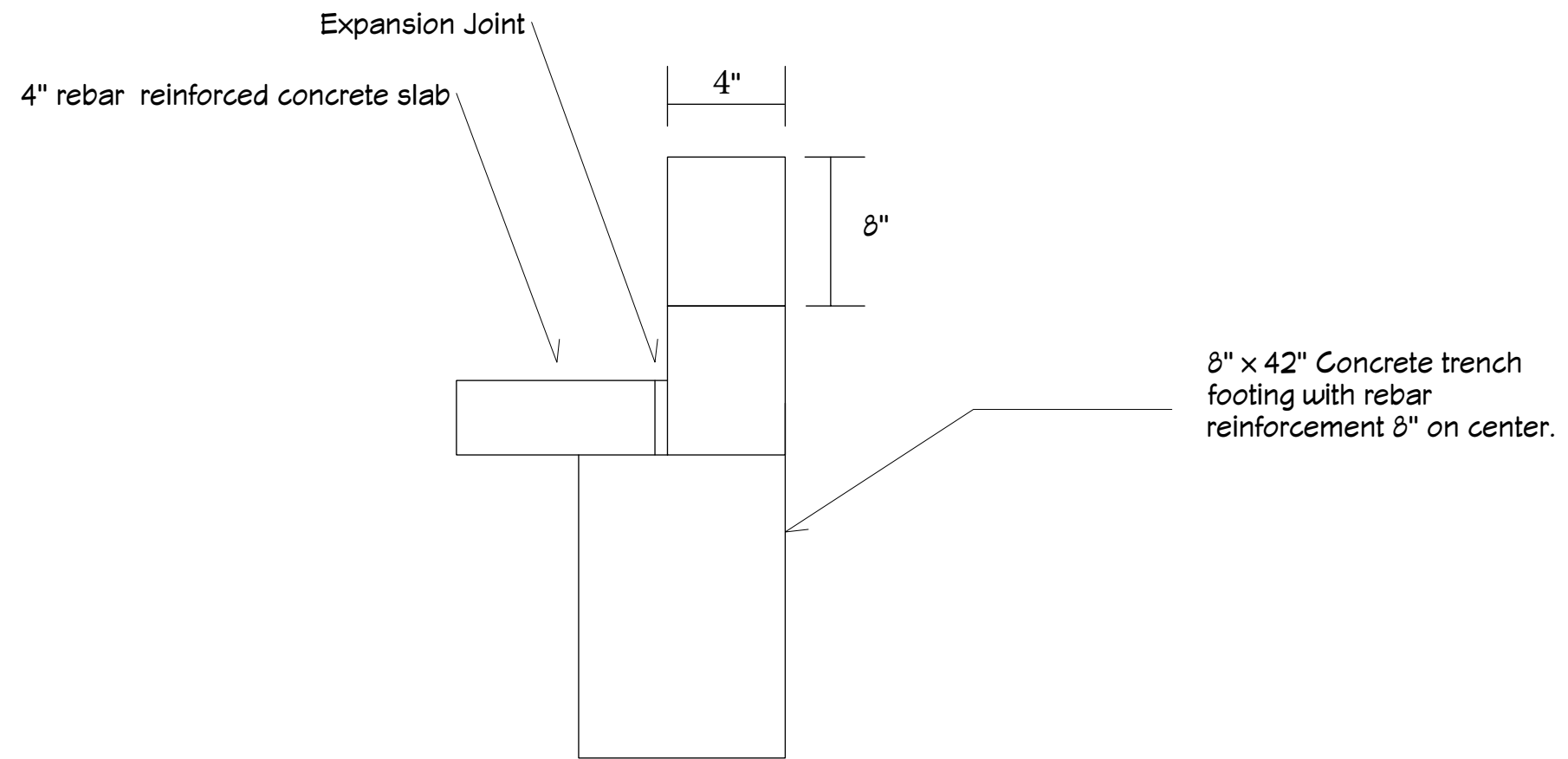



CLASSIC™ COLLECTION

# VALUE PLUS

series



America's Favorite Garage Doors®



*Model T42L, Long Traditional Panel with Optional Madison 611 Window Design*

# VALUE PLUS series

Improve your home's appearance and energy efficiency with a Clopay Value Plus Series insulated garage door. Available in 24 or 25 gauge steel with 1-5/16" polystyrene insulation, Value Plus Series models offer moderate insulating R-values, strength and security, as well as quiet operation and a beautiful appearance. Choose from two panel styles, many color options and a wide range of decorative window options to create a door that fits your budget and enhances your home's curb appeal.

## 2-LAYER CONSTRUCTION

1-5/16" polystyrene insulation provides comfort, energy efficiency and quiet operation in every season.

- Tongue-and-groove/shiplap section joints help seal out wind, rain and snow.
- Replaceable bottom weatherseal in a rust-resistant aluminum retainer helps prevent elements from entering garage.
- Patented Safe-T-Bracket® helps prevent serious injury that could occur if the bottom bracket were removed with the garage door closed and under tension.
- Long-life nylon rollers are smooth and quiet.
- Galvanized steel hinges are durable, reliable and secure.
- Inside/outside step plates and grip handles make doors easy and safe to operate.



Tongue-and-Groove Section Joints

Shiplap Section Joints

**24**  
GAUGE  
STEEL

**T42S** short panel  
**T42L** long panel

**25**  
GAUGE  
STEEL

**T52S** short panel  
**T52L** long panel

**25**  
GAUGE  
STEEL

**1500** short panel  
**76V** long panel

**1 5/16"**  
POLYSTYRENE

EFFICIENCY  
**6.3**  
R-VALUE\*

**1 5/16"**  
POLYSTYRENE

EFFICIENCY  
**6.3**  
R-VALUE\*

\*Calculated door section R-value is in accordance with DASMA TDS-163.





*Model T52S, Short Traditional Panel  
with Optional Colonial 509 Window Design*

## DETAIL



Deep panel edging and natural embossed woodgrain texture improve appearance close-up and from the curb.

## STYLE



### **Traditional Short**

Complements homes with traditional styling. Models T42S, T52S, and 1500.



### **Traditional Long**

Ideal for ranch style homes. Models T42L, T52L and 76V.

*Doors range from 6' to 16' high and 4'2" to 18' wide. Consult your Clopay dealer for size options.  
WindCode® doors available to meet most regional wind load requirements.  
Consult your local dealer for specific information.*



Model 76V, Long Traditional Panel with  
Optional Prairie 610 Window Design

## COLORS

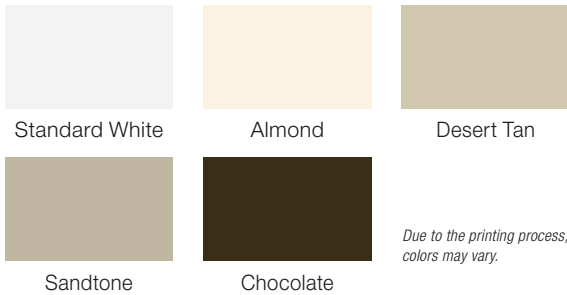

- Exterior steel on standard color doors has a natural woodgrain texture.
- Doors can be painted to match the home's exterior using a high-quality latex exterior paint. Do not use oil-based paint.

## STEP PLATE/LIFT HANDLE



Color-matched exterior step plate/lift handles are durable, attractive and allow for safe opening and closing of your door.

## CUSTOM PAINT OPTION



Color Blast® offers more than 1,500 Sherwin-Williams® color options® to complement your home. Clopay's durable two-part paint system has been thoroughly tested and is backed by a five-year warranty.

## RUST-PREVENTION SYSTEM



Steel skins are protected through a tough, layered coating system, including a hot-dipped galvanized layer, a protective metal oxide pretreatment and a baked-on primer and top coat.





Model 1500, Short Traditional Panel

## WARRANTIES

<b>PAINT SYSTEM</b>	<b>PAINT SYSTEM</b>
<b>LIMITED LIFE WARRANTY</b>	<b>LIMITED 25YR WARRANTY</b>

Model T42

Models T52,  
1500, 76V

<b>WINDOWS</b>	<b>HARDWARE</b>
<b>LIMITED 10YR WARRANTY</b>	<b>LIMITED 3YR WARRANTY</b>

All Models

All Models



Model T42S, Short Traditional Panel with Optional Short Trenton® Window Design

## A FOCUS ON *green.*



Clopay is committed to designing, manufacturing and distributing garage doors that enhance the beauty, safety and value of your home while minimizing the impact on the environment.

The Value Plus Series helps conserve natural resources by providing a durable, reliable, low-maintenance door. Steel doors and hardware are impervious to moisture and will not rot, warp or crack, and the steel used in Clopay's doors is made from over 75% recycled content. All Clopay doors are made in the U.S., minimizing shipping, damage and handling. For more details on Clopay's green practices, visit our website at [clopaydoor.com/green](http://clopaydoor.com/green)



# WINDOW OPTIONS

Our windows add natural light to your garage while adding curb appeal to your home. All Clopay window frames are UV-protected and are color matched to our prefinished door colors. Window frames screw in from the inside for easy glass replacement or to change designs.

## DECORATIVE WINDOWS

Clopay's decorative windows are created to complement many home styles. Short windows are 19-1/2" x 12" and long windows are 40-1/2" x 12".

Available on These Models

T42S\* T52L  
T42L 1500\*  
T52S\* 76V

### Wrought Iron Series (Acrylic)



Tuscany Short



Tuscany Long



Trenton® Short



Trenton® Long



Carlisle® Short



Carlisle® Long



Orleans Short



Orleans Long



Kristin® Short



Kristin® Long



Roselle® Short



Roselle® Long

### Leaded Series (Glass)

## DECORATIVE INSERT SERIES WINDOWS

UV-protected cellular plastic insert designs snap into either the inside or outside of the window frame for easy cleaning or to change designs. Windows are offered in single strength, double strength, acrylic or obscure glass. Short windows are 19-1/2" x 12" and long windows are 40-1/2" x 12".

Available on These Models

T42S\* T52L  
T42L 1500\*  
T52S\* 76V



Plain†



Plain Long†



Charleston 508



Charleston 608



Colonial 509



Stockton 612



Prairie 510



Prairie 610



Madison 611



Madison Arch 613



Sunset 501<sup>†</sup>  
(8', 9', 12', 16', 17', 18' widths only)



Sunset 502<sup>†</sup>  
(7', 7'6", 12' widths only)



Sunset 601<sup>†</sup>



Sunset 503<sup>†</sup> (8', 9', 16', 17', 18' widths only)



Sunset 504<sup>†</sup> (14', 15', 15'6" widths only)



Sunset 505<sup>†</sup> (16', 17', 18' widths only)



Sunset 506<sup>†</sup> (10', 20' widths only)



Sunset 603<sup>†</sup>



Sunset 605<sup>†</sup>

Windows are available single pane in clear, frosted, obscure and rain designs. Clear acrylic also available.

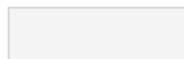

Clear



Frosted



Obscure



Rain

Short windows not available on long panel doors.

\*Panel emboss may not align on long window with short panels. Some size limitations apply.

†Shown with clear glass. Acrylic and obscure glass optional.

Additional charges for optional glass apply.

Acrylic windows require special cleaning. Never use products that contain ammonia or petroleum products to clean acrylic. Please visit [clopaydoor.com/acrylic](http://clopaydoor.com/acrylic) for complete details.



Visit [clopay.com](http://clopay.com) or call 1-800-2CLOPAY (800-225-6729) for more information on Clopay, America's Favorite Garage Doors. Follow us on



**From:** Peggy Kotkiewicz  
**To:** [Thacher, Jill](#); [Brian Powers](#)  
**Subject:** Fwd: 512 W William HDC Application  
**Date:** Friday, August 24, 2018 3:46:06 PM  
**Attachments:** [SPG American Legend Glamour Brochure WT045.pdf](#)  
[SPG American Legend Spec Sheet.pdf](#)  
[LandmarkSeriesBrochNortheast.pdf](#)  
[Classic Garage Door Brochure.pdf](#)  
[Cech Garage Plan Revision 8.23.18.pdf](#)

---

Peggy Kotkiewicz  
Kingdom Construction

----- Forwarded message -----

**From:** Brian <[brian@kingdomremodel.com](mailto:brian@kingdomremodel.com)>  
**Date:** Thu, Aug 23, 2018 at 10:56 AM  
**Subject:** 512 W William HDC Application  
**To:** [JBougher@a2gov.org](mailto:JBougher@a2gov.org)  
**Cc:** Peggy Kotkiewicz <[peggy@kingdomremodel.com](mailto:peggy@kingdomremodel.com)>, Chad Zabik <[cz@kingdomremodel.com](mailto:cz@kingdomremodel.com)>, Kelley Anderson <[kelley@kingdomremodel.com](mailto:kelley@kingdomremodel.com)>, Ronald Cox <[ron@kingdomremodel.com](mailto:ron@kingdomremodel.com)>

Hi Jill,

Below are the answers to your copied questions, please let me know if you need any further information. We were waiting for the client's approval on the desired finish selections on the project prior to sending our response to you, and I wanted to make sure you had these answers prior to the August 24th cut off. We appreciate your help in moving this project forward!

**1) The drawings aren't legible. The printing is very light, plus the text and measurements on the drawing are too small to read. Please either drop off or email to me a more clear set of drawings. I'd suggest you divide the drawings onto more pages, so they don't have to be so tiny when printed on 8 1/2 x 11 paper.**

New Drawings Attached with Multiple Pages.

**2) There are two sheets of drawings, both labeled P-1. Please change one of them to P-2.**

Fixed.

**3) The elevations aren't consistent. There are south (front) and east side elevations on both sheets but they don't match. Please provide one drawing of each elevation and a floor plan that shows windows and the front canopy accurately.**

Corrected.

**4) I can't read the plot plan, but if the garage is less than 5' from the property line it will need to have a fire-rated wall. That's not important to the HDC, but I want to make sure you're aware of it.**

Thank you for sharing this information.

**5) Please add material information for the doors and windows (wood, steel, fiberglass, etc.) and manufacturer's information/cut sheets if you've already picked them out.**

Siding (attached)- Certainteed American Legend vinyl (double 4"), color charcoal gray

Roofing (attached)- Certaineed Landmark Dimensional Shingles, color Pewter

Trim / Facia - White Aluminum

Soffits - White Vinyl

Side Entry Door (attached) - Therma-Tru Benchmark Door - Craftsman Simulated  
Divided Light Steel Pre-Hung Door with Insulating

Garage Door (attached) - Clopay White Traditional Short Raised Panel Insulated Single Car

Gutters - 5" White Aluminum

Windows - N/A

**6) I'm assuming the pavement leading to the garage is new also? Is any part of the driveway currently paved?**

The driveway is currently brick pavers. Client preference is to do a cement drive from where the current pavers end (at existing angled fence) to the entry of the new garage.

**7) A property owner must sign the HDC application. Also, the review fee for a new accessory structure is \$100, so \$65 is due for this application.**

Completed. Please use AMX on file with city for payment if this has not already been done.

Sincerely,

--

Brian Powers

Mobile [248-425-8095](tel:248-425-8095)

***Kingdom Construction & Remodel***  
***498 Farmer Street, Plymouth, MI 48170***

Office: [734-927-5227](tel:734-927-5227)

Fax: [877-353-7435](tel:877-353-7435)

[info@kingdomremodel.com](mailto:info@kingdomremodel.com)

[www.kingdomremodel.com](http://www.kingdomremodel.com)



# LANDMARK<sup>®</sup> SERIES

Designer  
Roofing Shingles



**CertainTeed**  
SAINT-GOBAIN





# Trust Your Home to Landmark®

Our Landmark Series starts with trust at the foundation. We engineer each shingle to make it the heaviest in its class, back it with our 100+ year legacy of proven performance, and deliver it with the industry's best lifetime limited warranty.

## EXCEPTIONAL QUALITY

In addition to offering a flexible range of architectural design options, Landmark Series shingles are certified as meeting the highest quality standards for roofing to provide your home with exceptional performance and protection.

## LASTING BEAUTY

Within the Landmark Series, you get the authentic appeal of wood shake roofing combined with the flexibility of the industry's largest collection of colors. And they come with our exclusive StreakFighter® warranty, protecting your roof from streaking caused by airborne algae.

## PEACE OF MIND

CertainTeed's asphalt shingle warranty is an industry-best. Our enhanced lifetime limited warranty protects against ANY manufacturing defect, including aesthetic defects.





*Landmark Premium, shown in Max Def Weathered Wood*

# Top Shelf

## LANDMARK® PREMIUM

A sophisticated look, brilliantly executed. Our Premium line is engineered to protect, enhance and endure.

- Outclasses ordinary roofing in both appearance and performance
- Tough two-piece laminated fiberglass-based construction
- Features Max Def colors for a deeper, richer mixture of surface granules

### LANDMARK PREMIUM COLOR PALETTE



Max Def Burnt Sienna



Max Def Cobblestone Gray



Max Def Colonial Slate

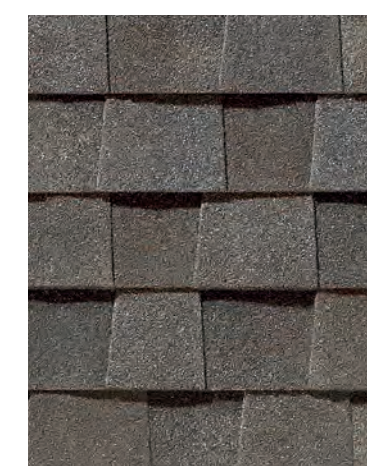

Max Def Driftwood



Max Def Georgetown Gray



Max Def Moire Black



Max Def Pewterwood



Max Def Weathered Wood





# The Expert's Choice

## LANDMARK® PRO

A refined union of vision and value, our PRO line leads its class in optimal performance and color.

- Engineered to meet professional contractors' exacting specifications
- Available in a wide selection of eye-catching Max Def colors
- Outweighs standard laminates to provide greater protection from the elements

*Landmark Pro, shown in Max Def Moire Black*

## LANDMARK PRO COLOR PALETTE

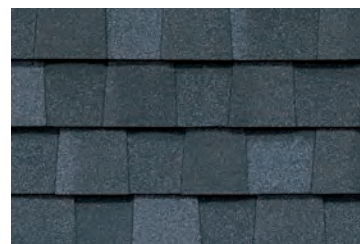

Max Def Atlantic Blue

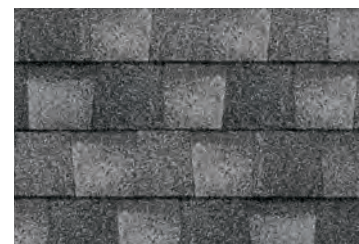

Max Def Birchwood

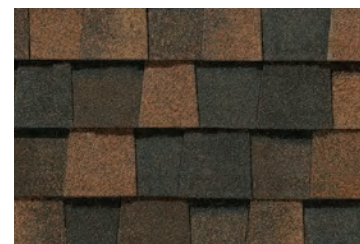

Max Def Burnt Sienna

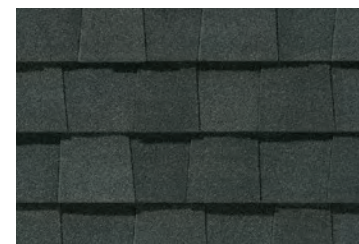

Max Def Charcoal Black



Max Def Cobblestone Gray



Max Def Colonial Slate



Max Def Driftwood

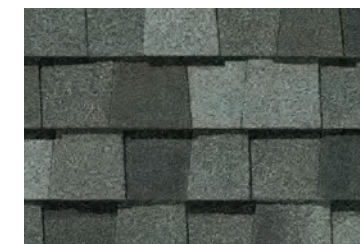

Max Def Georgetown Gray

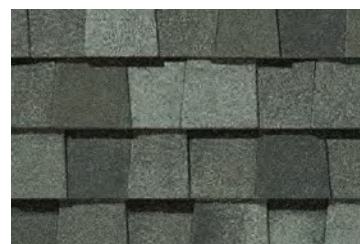

Max Def Granite Gray

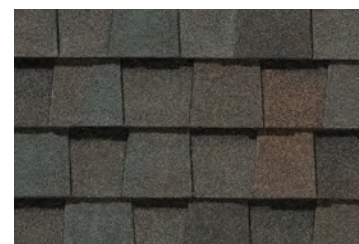

Max Def Heather Blend

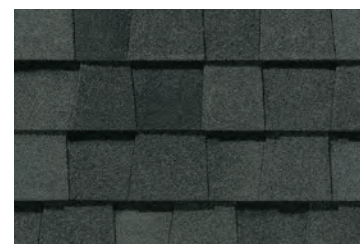

Max Def Moire Black



Max Def Pewterwood



Max Def Resawn Shake

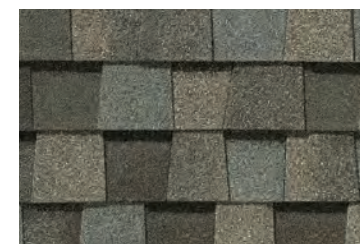

Max Def Weathered Wood



Silver Birch

See page 11 for specifications and warranty details.





Landmark, shown in Birchwood

# The Trusted Classic

LANDMARK®

Owning a Landmark roof brings peace of mind. Landmark's heavy weight and exceptional reliability make it a 'Best Buy' by a leading Consumer Magazine.



- Dual-layered for extra dimensionality and protection from the elements
- Offers the widest array of colors in the industry
- Independently certified as meeting the highest quality standards for roofing

## LANDMARK COLOR PALETTE



Atlantic Blue



Birchwood

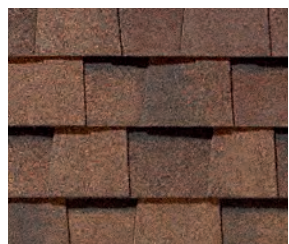

Burnt Sienna

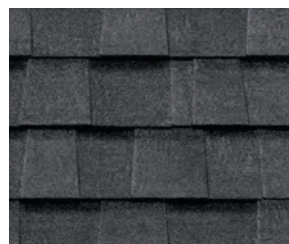

Charcoal Black



Cobblestone Gray



Colonial Slate



Cottage Red

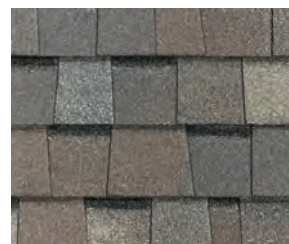

Driftwood



Georgetown Gray



Granite Gray



Heather Blend



Hunter Green

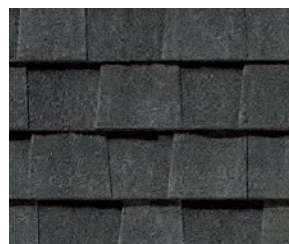

Moire Black

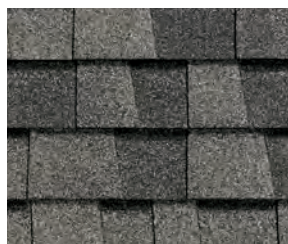

Pewterwood

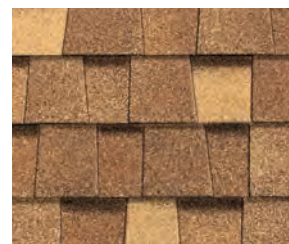

Resawn Shake



Silver Birch



Weathered Wood



# Strength with Style

## LANDMARK<sup>®</sup> PREMIUM

- Dual-layer, high performance
- 300 lbs. per square
- Max Def color palette
- Industry-best lifetime limited warranty

## LANDMARK<sup>®</sup> PRO

- Dual-layer, high performance
- 250 lbs. per square
- Max Def color palette
- Industry-best lifetime limited warranty

## LANDMARK<sup>®</sup>

- Dual-layer durability
- 235 lbs. per square
- Industry-best lifetime limited warranty



## LANDMARK PREMIUM

### SPECIFICATIONS

- Two-piece laminated fiberglass-based construction
- Classic shades and dimensional appearance of natural wood or slate
- 300 lbs. per square

*For U.S. building code compliance, see product specification sheets.*

CertainTeed products are tested to ensure the highest quality and comply with the following industry standards:

#### Fire Resistance:

- UL Class A
- UL certified to meet ASTM D3018 Type 1

#### Wind Resistance:

- UL certified to meet ASTM D3018 Type 1
- ASTM D3161 Class F

#### Tear Resistance:

- UL certified to meet ASTM D3462
- CSA standard A123.5

#### Wind Driven Rain Resistance:

- Miami-Dade Product Control Acceptance: Please reference [www.certainteed.com](http://www.certainteed.com) to determine approved products by manufacturing location.

#### Quality Standards:

- ICC-ES-ESR-1389 & ESR-3537

### WARRANTY

- Lifetime limited transferable warranty against manufacturing defects on residential applications
- 50-year limited transferable warranty against manufacturing defects on group-owned or commercial applications
- 15-year StreakFighter<sup>®</sup> algae-resistance warranty 
- 10-year SureStart<sup>™</sup> protection
- 15-year 110 mph wind-resistance warranty
- Wind warranty upgrade to 130 mph available. CertainTeed starter and CertainTeed hip and ridge required

*See actual warranty for specific details and limitations.*



## LANDMARK PRO

### SPECIFICATIONS

- Two-piece laminated fiberglass-based construction
- Classic shades and dimensional appearance of natural wood or slate
- 250 lbs. per square

*For U.S. building code compliance, see product specification sheets.*

CertainTeed products are tested to ensure the highest quality and comply with the following industry standards:

#### Fire Resistance:

- UL Class A
- UL certified to meet ASTM D3018 Type 1

#### Wind Resistance:

- UL certified to meet ASTM D3018 Type 1
- ASTM D3161 Class F

#### Tear Resistance:

- UL certified to meet ASTM D3462
- CSA standard A123.5

#### Wind Driven Rain Resistance:

- Miami-Dade Product Control Acceptance: Please reference [www.certainteed.com](http://www.certainteed.com) to determine approved products by manufacturing location.

#### Quality Standards:

- ICC-ES-ESR-1389 & ESR-3537

*Landmark Pro Silver Birch is an ENERGY STAR rated product and may qualify for a federal tax credit.*

### WARRANTY

- Lifetime limited transferable warranty against manufacturing defects on residential applications
- 50-year limited transferable warranty against manufacturing defects on group-owned or commercial applications
- 15-year StreakFighter<sup>®</sup> algae-resistance warranty 
- 10-year SureStart<sup>™</sup> protection
- 15-year 110 mph wind-resistance warranty
- Wind warranty upgrade to 130 mph available. CertainTeed starter and CertainTeed hip and ridge required

*See actual warranty for specific details and limitations.*



## LANDMARK

### SPECIFICATIONS

- Two-piece laminated fiberglass-based construction
- Classic shades and dimensional appearance of natural wood or slate
- 235 lbs. per square

*For U.S. building code compliance, see product specification sheets.*

CertainTeed products are tested to ensure the highest quality and comply with the following industry standards:

#### Fire Resistance:

- UL Class A
- UL certified to meet ASTM D3018 Type 1

#### Wind Resistance:

- UL certified to meet ASTM D3018 Type 1
- ASTM D3161 Class F

#### Tear Resistance:

- UL certified to meet ASTM D3462
- CSA standard A123.5

#### Wind Driven Rain Resistance:

- Miami-Dade Product Control Acceptance: Please reference [www.certainteed.com](http://www.certainteed.com) to determine approved products by manufacturing location.

#### Quality Standards:

- ICC-ES-ESR-1389 & ESR-3537

*Landmark Silver Birch is an ENERGY STAR rated product and may qualify for a federal tax credit.*

### WARRANTY

- Lifetime limited transferable warranty against manufacturing defects on residential applications
- 10-year StreakFighter<sup>®</sup> algae-resistance warranty 
- 10-year SureStart<sup>™</sup> protection
- 15-year 110 mph wind-resistance warranty
- Wind warranty upgrade to 130 mph available. CertainTeed starter and CertainTeed hip and ridge required

*See actual warranty for specific details and limitations.*



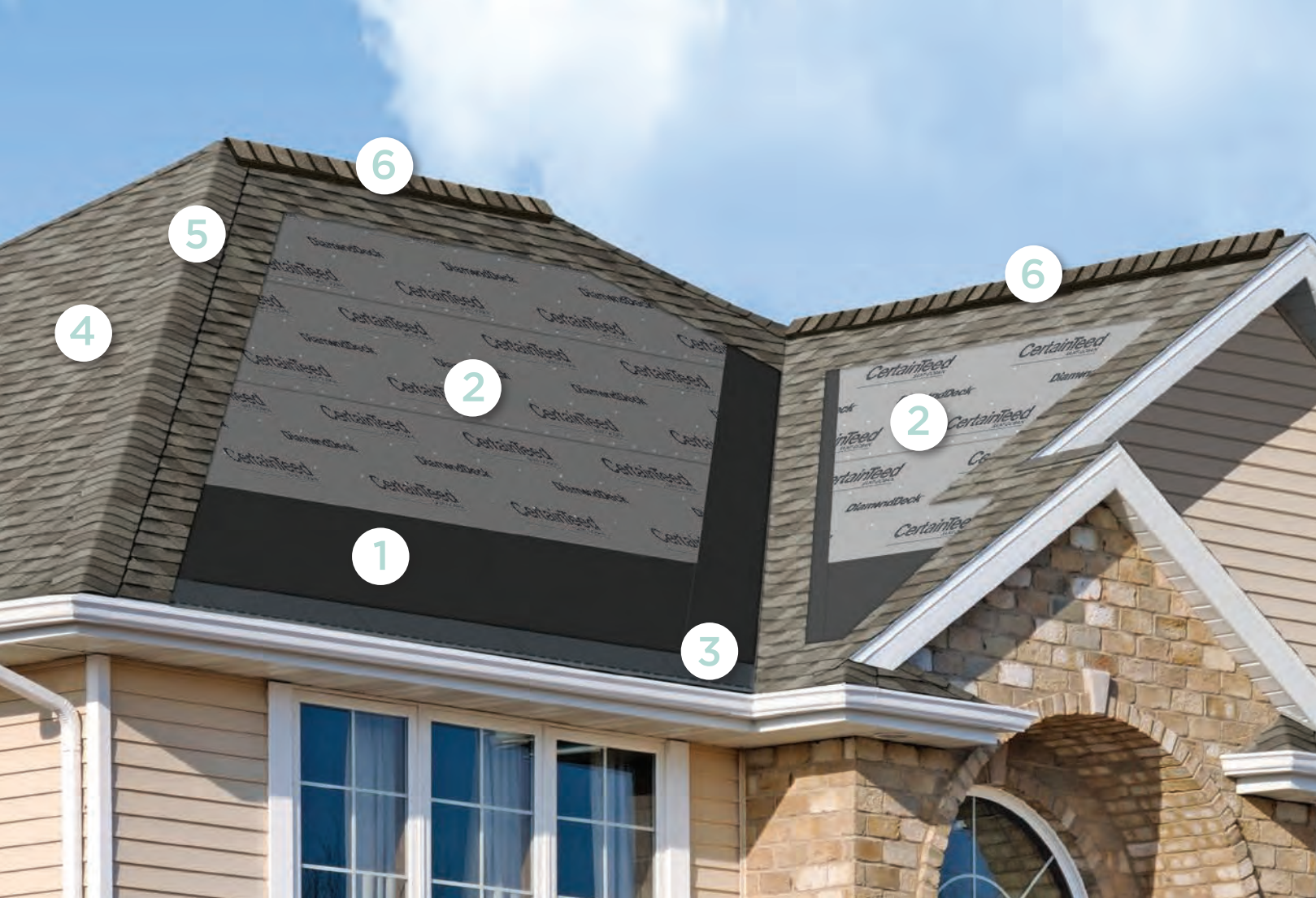

# Integrity Roof System™

Integrity is built from the bottom up. Layer-on-layer, only CertainTeed provides the peace of mind that comes with the best components performing together for peak efficiency.



## 1. Waterproof Underlayment

Waterproofing shingle underlayment prevents leaks from wind-driven rain and ice dams

## 2. Water-Resistant Underlayment

High-performance underlayment provides a water-resistant layer over the roof deck and a secondary barrier against leaks

## 3. Starter Shingles

Perfect starts every time and designed to work in tandem with the roof shingles above

## 4. Roof Shingles

Choose the best, covered by the strongest warranty in the business

## 5. Hip & Ridge Caps

Perfect finish for hip and ridge lines, complementing all CertainTeed shingles

## 6. Roof Ventilation

Engineered for ideal roof ventilation especially when matched with CertainTeed Intake Vents



## Add a Little Accent to Your Roof

The visually impactful choice for capping the hips and ridges of your roof, CertainTeed's Cedar Crest® accessory shingles will complement or match any shingle in the Landmark Series. For a low-profile hip and ridge look, CertainTeed also offers Shadow Ridge® accessory shingles.

## Color Companion Products™ for Flat Roof Areas

With CertainTeed Flintlastic® SA, you can coordinate flat roof areas like carports, canopies and porches with your main roof. Flintlastic SA is a self-adhering low slope roofing product available in eight colors that complement some of the most popular CertainTeed shingles.

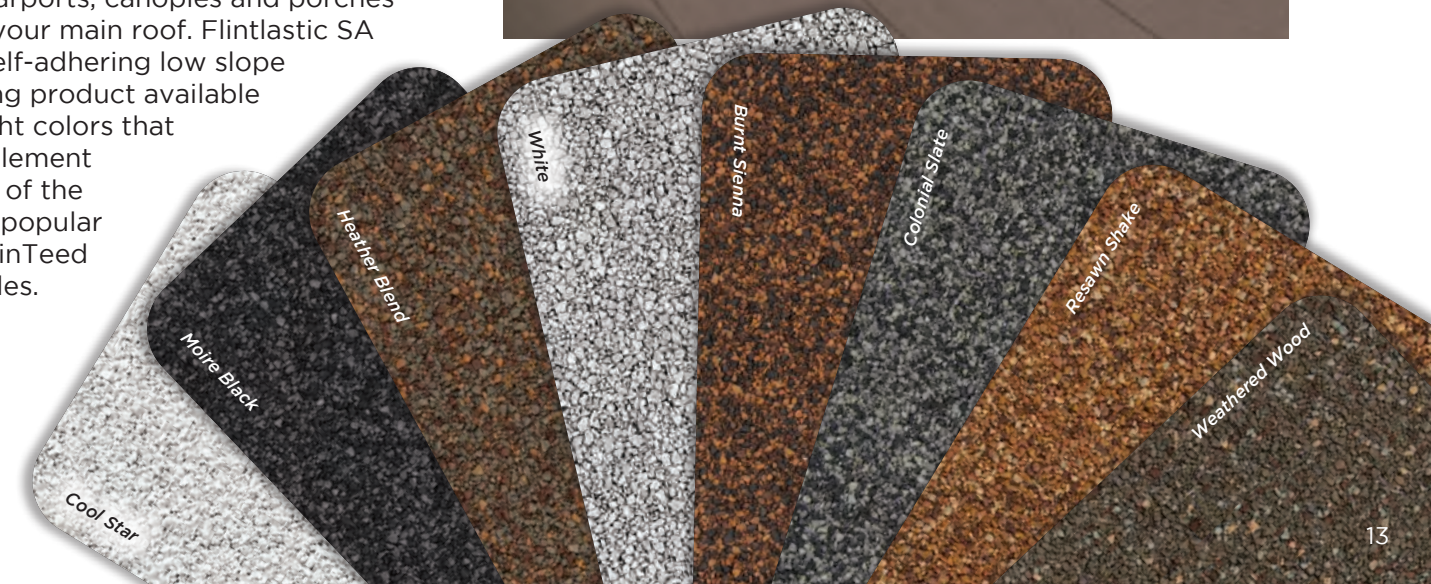





# Trust Your Home to Landmark®

LANDMARK®



High-Quality,  
Reliable Choice



Industry-Best  
Warranty



Century of **Trusted**  
Performance



PEACE OF MIND



Landmark, shown in Georgetown Gray



# RESIDENTIAL ROOFING



The best formula under one roof.

We start with the highest-quality raw materials and add state-of-the-art technology to monitor our manufacturing process and test our finished products. The result is superior performance from beginning to end.



Landmark® Series available in areas shown



*NOTE: Due to limitations of printing reproduction, CertainTeed can not guarantee the identical match of the actual product color to the graphic representations throughout this publication.*

learn more at: [certainteed.com/roofing](https://certainteed.com/roofing)



## CertainTeed Corporation

ROOFING • SIDING • TRIM • DECKING • RAILING • FENCE • GYPSUM • CEILINGS • INSULATION

20 Moores Road Malvern, PA 19355 Professional: 800-233-8990 Consumer: 800-782-8777 [certainteed.com](https://certainteed.com)





CertainTeed products are designed to work together and complement each other in color and style to give your home a beautiful finished look.



POLYMER SHAKES & SHINGLES



ROOFING AND VENTILATION



FENCE



INSULATED SIDING



PVC EXTERIOR TRIM & BEADBOARD



DECKING AND RAILING



VINYL SIDING



VINYL CARPENTRY® TRIM



HOUSEWRAP



[facebook.com/certainteedfreedomofchoice](https://www.facebook.com/certainteedfreedomofchoice)



[youtube.com/ctfreedomofchoice](https://www.youtube.com/ctfreedomofchoice)

**ASK ABOUT OUR OTHER CERTAINTEED® PRODUCTS AND SYSTEMS:**

ROOFING • SIDING • TRIM • DECKING • RAILING • FENCE  
GYPSUM • CEILINGS • INSULATION

CertainTeed Corporation  
20 Moores Road  
Malvern, PA 19355

Professional: 800-233-8990  
Consumer: 800-782-8777  
[www.certainteed.com](http://www.certainteed.com)

Code No. WT045, © 01/18 CertainTeed Corporation, Printed in U.S.A.



# American Legend™





# Wolverine American Legend

With STUDfinder™ and GripLock™  
for Smooth, Attractive Installations

## A Heritage of Authenticity

Wolverine, a quality brand of CertainTeed Corporation, has a long tradition of developing innovative and architecturally inspired cladding products for generations of American homes. Learn more at [www.siding.com](http://www.siding.com).

## Design Choices

Wolverine offers the industry's widest selection of siding, soffit, trim and accessories, in a broad range of profiles and colors. This gives you choices from a complete exterior design system. You can mix and match from many options to help achieve the style and look you want, whether your home is remodeled, restored or brand new.



Above: This remodeled home features American Legend D4" Clapboard siding and Cedar Impressions Half-Rounds in the gables, both in heritage cream. Trim is Vinyl Carpentry® and Restoration Millwork®.

## Number One in Quality

Thousands of architects, builders, remodelers and homeowners put their trust in Wolverine.

In fact, Wolverine consistently ranks *number one* in quality among architects, builders and remodelers in numerous leading trade publications.

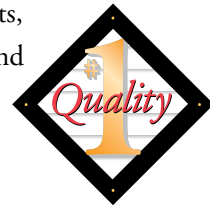

American Legend is backed by a lifetime limited warranty that's even transferable should you sell your home.

On cover: American Legend in buckskin with Vinyl Carpentry® and Restoration Millwork® trim.

## The STUDfinder™ Installation System

The patented STUDfinder system is designed to make it easy for your contractor to install American Legend siding accurately and securely. The indicator letters on the precisely spaced nail slots, engineered to align with standards of 16" and 24" on-center construction, help locate studs time after time. STUDfinder can also help avoid the dangers of nailing into something in the wall cavity, such as wiring, plumbing and mechanical systems.

### STUDfinder for Accuracy

- Nail slots align with 16" on-center standards for stud spacing
- Indicator letters help:
  - Determine location of studs
  - Ensure nails are positioned correctly
  - Ensure correct number of nails are used

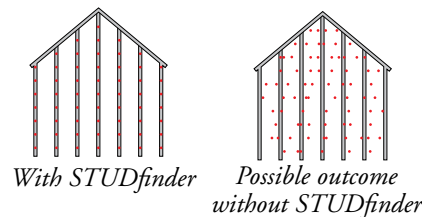

### STUDfinder for Security and Performance

- Nailing to studs provides a strong and secure connection
- Protects against blow offs from under-nailing
- Protects against buckling from over-nailing
- Helps avoid nailing into hazardous items between studs like plumbing or wiring

STUDfinder, because beauty and performance start with a quality installation

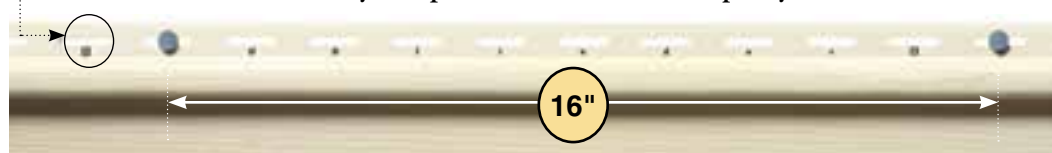

American Legend coordinates with Vinyl Carpentry® and Restoration Millwork® trim so you can create and achieve the look you desire. Panels are available in a wide range of colors with a woodgrain or brushed finish. American Legend is virtually maintenance-free and features a lifetime limited warranty. For great looks that last, choose American Legend.



Double 4" Woodgrain Clapboard in light maple

Double 5" Woodgrain Clapboard in oxford blue

Double 4-1/2" Woodgrain Dutchlap in desert tan

### Color Options:

Autumn Red*	Hearthstone*	Spruce*
Forest*	Flagstone*	Charcoal Gray*
Granite Gray	Sterling Gray	Oxford Blue
Seagrass	Cypress	Warm Sand
Herringbone	Desert Tan	Natural Clay
Savannah Wicker	Light Maple	Buckskin
Heritage Cream	Autumn Yellow	Snow
Colonial White		

Note: Colors shown are as accurate as printing methods will permit. Please see product samples for actual shades.

\*Deluxe Color

PermaColor™ System — Color performance, impact resistance and durability are assured through our exclusive PermaColor System, a blend of our own Certavin™ resin, superior micro-ingredients and state-of-the-art pigment chemistry.



## Finish the Job with Vinyl Carpentry and Restoration Millwork Trim



### Crown and Base Cap

Restoration Millwork Crown and Base Cap build-up with Beadboard Panel ceiling.



### Beaded Triple 2" Soffit

This Vinyl Carpentry soffit is also ideal for use as a vertical siding or to provide vertical design elements such as wainscoting.



### Patented Corner Block and Rosette

This Vinyl Carpentry final finishing touch for wide window and door corners has historic precedence.

## American Legend™

### Vinyl Siding

**General Description:** American Legend™ Siding provides the look of wood siding, but does not require the upkeep common to wood. American Legend Siding is available in a selection of profiles and finishes that offer the industry's best real wood replication. It is appropriate for use in new construction for single family homes, multi-housing projects and light commercial developments. American Legend is also an ideal product for remodeling.

**Styles:**

Profile	Finish	Panel Projection (Nominal)	Wall Thickness (Nominal)	Lock Design	Colors	Accessory Pocket
Double 4" Clapboard	Woodgrain	9/16"	.042"	GripLock™ post-formed positive lock	22	½", 5/8", 3/4"
Double 5" Clapboard	Woodgrain	9/16"	.042"	GripLock™ post-formed positive lock	22	½", 5/8", 3/4"
Double 4½" Dutchlap	Woodgrain	9/16"	.042"	GripLock™ post-formed positive lock	22	½", 5/8", 3/4"

**Colors:** American Legend siding profiles are available in the industry's widest selection of colors. All colors are Spectrophotometer controlled and utilize exclusive PermaColor™ color science.

Autumn Red	Colonial White	Forest	Herringbone	Savannah Wicker	Sterling Gray
Autumn Yellow	Cypress	Granite Gray	Light Maple	Seagrass	Warm Sand
Buckskin	Desert Tan	Hearthstone	Natural Clay	Snow	
Charcoal Gray	Flagstone	Heritage Cream	Oxford Blue	Spruce	

**STUDfinder™:** The patented STUDfinder Installation System combines precisely engineered nail slot locations with graphics. Nail slots are positioned 16" on center to allow for alignment with studs. STUDfinder graphics centered at each slot provide a quick and easy guide to help locate studs.

**Accessories:** Wolverine manufactures a wide range of siding accessories that are compatible with American Legend siding styles and colors. Accessory products include installation components, soffit, window and door trim, corner lineals, corner systems and decorative moldings.

**Composition:** American Legend siding products are produced using CertaVin™ custom-formulated PVC resin. This resin is produced exclusively by Wolverine, allowing Wolverine to maintain the high quality of its siding products.

**Technical Data:** American Legend siding is in compliance with ASTM specification for Rigid Polyvinyl Chloride (PVC) Siding D 3679, and the requirements of section R703.11 of the International Residential Code, and section 1405.14 of the International Building Code. American Legend siding meets or exceeds the properties noted in Table 1.

**Table 1:**

ASTM E 84	Meets Class A flame spread requirements as tested according to ASTM E84.
ASTM D 1929	Self-ignition temperature 813°F
ASTM D 635	Material is self-extinguishing with no measurable extent of burn when tested in accordance with this specification.
NFPA 268	Radiant Heat Test - Ignition Resistance of Exterior Walls - Conclusion that Wolverine met the conditions for allowable use as specified in section 1406 of the International Building Code.

**Important Fire Safety Information:** When rigid vinyl siding is exposed to significant heat or flame, the vinyl will soften, sag, melt or burn, and may thereby expose material underneath. Care must be exercised when selecting underlayment materials because many underlayment materials are made from organic materials that are combustible. You should ascertain the fire properties of underlayment materials prior to installation. All materials should be installed in accordance with local, state and federal Building Code and fire regulations.

**Wind Load Testing:** Wolverine American Legend™ Double 4" siding has been tested per ASTM D 5206 standard test method for resistance to negative wind load pressures of 38 psf, which equates to more than 170 mph ( $V_{ASD}$ ) and 223 mph ( $V_{ULT}$ ), when installed with nails positioned 16" on center. Check with your local building inspector for windload requirements in your area on the type of structure you are building.

**Documents:** Wolverine Vinyl Siding meets the requirements of one or more of the following specifications.

- Texas Department of Insurance Product Evaluation EC-11
  - Conforms to ASTM Specification D3679
  - Florida BCIS Approval FL1573
  - ICC-ES Evaluation Report ESR-1066
- For specific product evaluation/approval information, call 800-233-8990.

**Installation:** Prior to commencing work, verify governing dimensions of building, examine, clean and repair, if necessary, any adjoining work on which the siding is in any way dependent for its proper installation. Sheathing materials must have an acceptable working surface. Siding, soffit and accessories shall be installed in accordance with the latest editions of Wolverine installation manuals on siding and soffit. Installation manuals are available from Wolverine and its distributors.

**Warranty:** Wolverine supports American Legend siding products with a Lifetime Limited Warranty including PermaColor Lifetime Fade Protection to the original homeowner. The warranty is transferable if the home is sold.

**Technical Services:** Wolverine maintains an Architectural Services staff to assist building professionals with questions regarding Wolverine siding products. Call 800-233-8990 for samples and answers to technical or installation questions.

**Sample Short Form Specification:** Siding as shown on drawings or specified herein shall be American Legend Vinyl Siding as manufactured by Wolverine Siding, Malvern, PA. Installation shall be in accordance with manufacturer's instructions.

**Three-part Format Specifications:** Long form specifications in three-part format are available from Wolverine by calling our Architectural Services Staff at 800-233-8990. These specifications are also available on our website at [certainteed.com](http://certainteed.com).

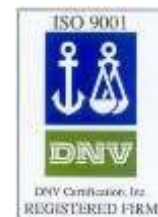

CertainTeed Corporation  
 20 Moores Road  
 Malvern, PA  
 certainteed.com  
 © 01/18

