

UNLESS OTHERWISE NOTED, THE SURVEY INFORMATION AND DATA ARE THE PROPERTY OF WASHTENAW ENGINEERING, INC. THE SURVEYOR MAKES NO WARRANTY AS TO THE ACCURACY OF THE INFORMATION PROVIDED. THE SURVEYOR DOES NOT WARRANT THAT THE UNDERGROUND UTILITIES SHOWN ARE IN THE EXACT LOCATION INDICATED. ALTHOUGH THE SURVEYOR HAS MADE EVERY REASONABLE EFFORT TO LOCATE AND MARK THE UTILITIES, THE SURVEYOR DOES NOT GUARANTEE THE LOCATION OF UTILITIES. THE SURVEYOR HAS NOT PHYSICALLY LOCATED THE UNDERGROUND UTILITIES.

UNLESS OTHERWISE NOTED, THE SURVEY INFORMATION AND DATA ARE THE PROPERTY OF WASHTENAW ENGINEERING, INC. THE SURVEYOR MAKES NO WARRANTY AS TO THE ACCURACY OF THE INFORMATION PROVIDED. THE SURVEYOR DOES NOT WARRANT THAT THE UNDERGROUND UTILITIES SHOWN ARE IN THE EXACT LOCATION INDICATED. ALTHOUGH THE SURVEYOR HAS MADE EVERY REASONABLE EFFORT TO LOCATE AND MARK THE UTILITIES, THE SURVEYOR DOES NOT GUARANTEE THE LOCATION OF UTILITIES. THE SURVEYOR HAS NOT PHYSICALLY LOCATED THE UNDERGROUND UTILITIES.

UNLESS OTHERWISE NOTED, THE SURVEY INFORMATION AND DATA ARE THE PROPERTY OF WASHTENAW ENGINEERING, INC. THE SURVEYOR MAKES NO WARRANTY AS TO THE ACCURACY OF THE INFORMATION PROVIDED. THE SURVEYOR DOES NOT WARRANT THAT THE UNDERGROUND UTILITIES SHOWN ARE IN THE EXACT LOCATION INDICATED. ALTHOUGH THE SURVEYOR HAS MADE EVERY REASONABLE EFFORT TO LOCATE AND MARK THE UTILITIES, THE SURVEYOR DOES NOT GUARANTEE THE LOCATION OF UTILITIES. THE SURVEYOR HAS NOT PHYSICALLY LOCATED THE UNDERGROUND UTILITIES.

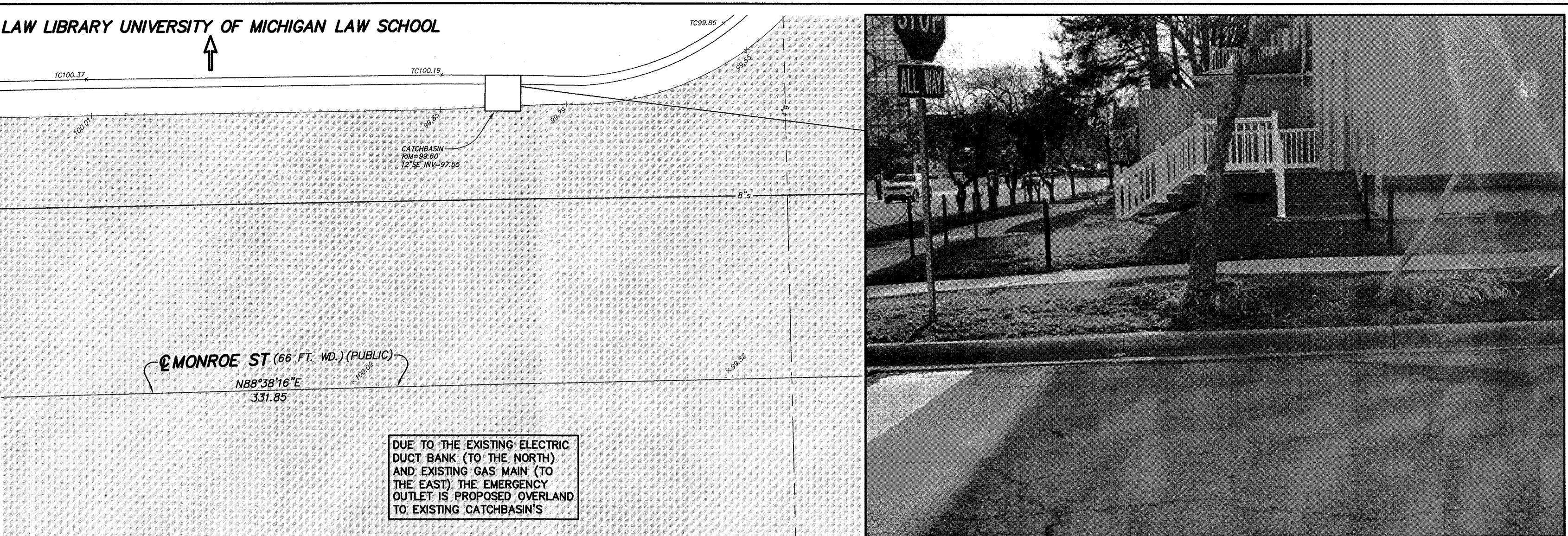
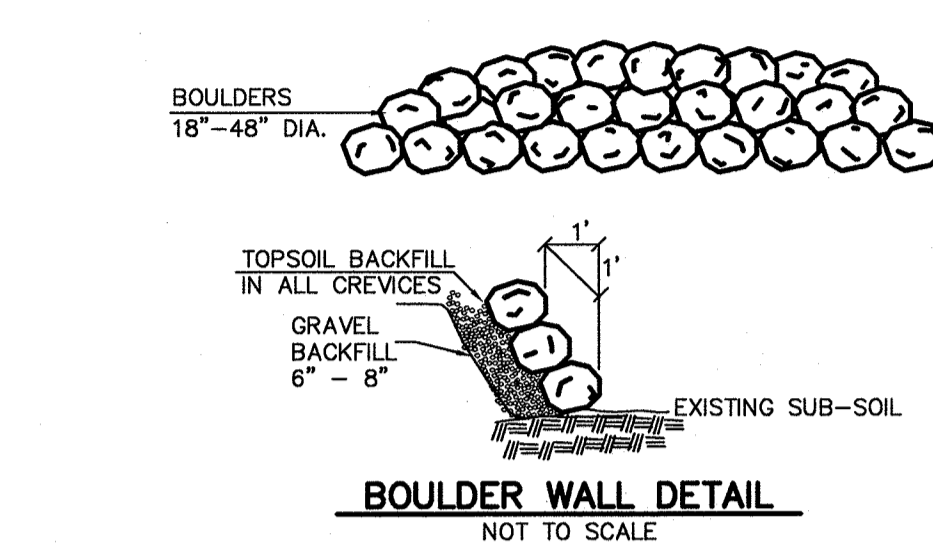
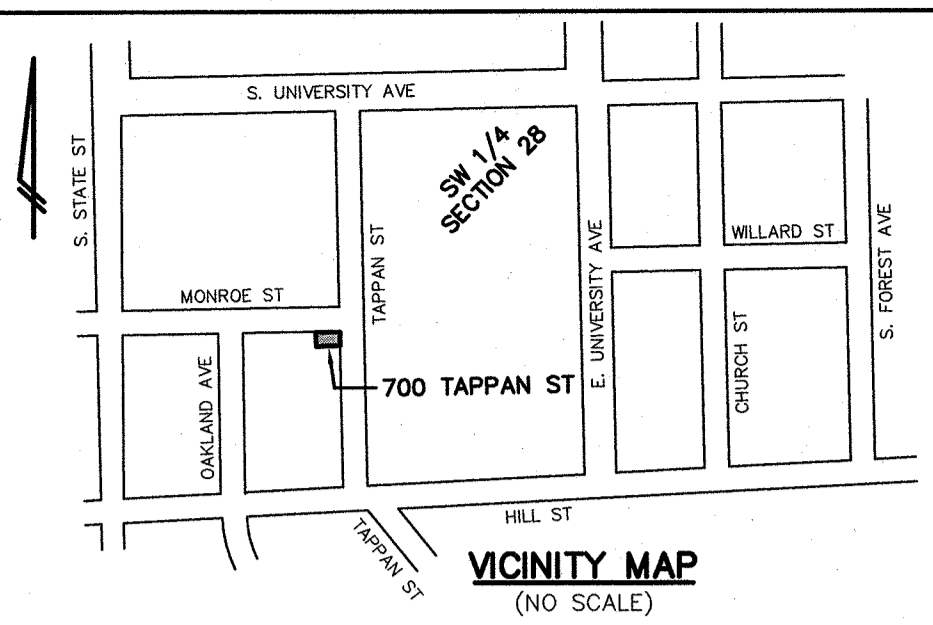

Rain Garden Mixture

A Combination of Wetland Grasses and Forbs
 Height Range: 24 - 60 inches
 Seeding Rate: Broadcast: 1 Lb. / 1,000 sq ft | Drilled: 15 Lbs. / Ac
 Colors: Blue Orange Pink Purple Red White Yellow
 Growing Season: February - August

ALL NATIVE combination of grasses and forbs designed to hold soil along the fluctuating shorelines or lagoons. It consists of 28 species that will provide soil stabilization and habitat not only in the water, but on the banks leading down to it as well. Plants will filter run-off flowing into the body of water while providing food and cover for wildlife and waterfowl.

Species: Blue Flag Iris, Bluejunt Reedgrass, Blue Vervain, Bristley Sedge, Canada Anemone, Cardinal Flower, Common Arrowhead, Dark Green Bulrush, Fox Sedge, Frank's Sedge, Giant Bur Reed, Great Blue Lobelia, Hardstem Bulrush, Hop Sedge, Joe Pye Weed, Monkey Flower, New England Aster, Prairie Cordgrass, Rice Cut Grass, Riverbank Wildrye, Softstem Bulrush, Soft Rush, Swamp Milkweed, Sweet Flag, Tussock Sedge, Virginia Wildrye, Water Plantain, Woodgrass

2' OVERHANG ASSUMED FOR ROOF AREA=1032 SQFT

IMPERVIOUS AREA STORAGE CALCULATION
 ROOF AREA = 1032 SQFT X .08 FT = 82.56 CUFT
 ASPHALT AREA = 600 SQFT X .08 = 48.0 CUFT
 TOTAL = 130.56 CUFT

VOLUME OF RAIN GARDEN
 AVG AREA = 197 SQFT
 DEPTH = 0.66 FT
 TOTAL VOLUME PROPOSED = 131.3 CUFT

OWNER TO CONNECT DOWNSPOUTS TO RAINGARDEN OR OVERLAND TO TRENCH DRAIN

700 Tappan Street
 Land in the City of Ann Arbor, Washtenaw County, Michigan described as follows:
 Commencing at the Northeast corner of Lot 14 in Block 7 South of Huron Street, Range 11 East; thence running South along the West side of Ingalls Street (now Tappan St) 39 feet; thence West parallel with the South line of Monroe Street 64 feet; thence North parallel with the West line of South Ingalls Street (now Tappan St) 39 feet to the South line of Monroe Street; thence East along the South line of Monroe Street 64 feet to the Place of Beginning. Being a part of Lot 14 in Block 7 South of Huron Street, Range 11 East, according to the alteration of Ann Arbor Land Company's Addition to the Village (now City) of Ann Arbor, as recorded in Liber U of Deeds, Page 252, Washtenaw County Records.

WASHTENAW COUNTY SOIL SURVEY CLASSIFICATION
 FOA - FOX SANDY LOAM, 0 TO 2 PERCENT SLOPES
 SOILS BOUNDARY
 SOILS ARE BASED ON USDA SOIL SURVEY OF WASHTENAW COUNTY.

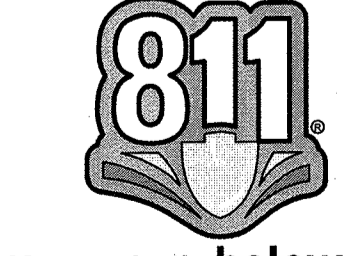

LEGEND

○	UTILITY POLE	○	SPOT ELEV.	---	GRAVEL	---	EXISTING STORM
○	UTILITY POLE	○	POST	---	FENCE	---	EXISTING SANITARY
○	GUY ANCHOR	○	GATE VALVE	---	CONCRETE	---	EXISTING WATER
○	HYDRANT	○	SIGN	---	ASPHALT	---	EXISTING GAS
							EXISTING ELECTRIC
							EXISTING TELEPHONE

BENCHMARK BM=STEAMER VALVE ON HYDRANT AT THE SOUTHWEST CORNER OF THE INTERSECTION OF TAPPAN ST AND MONROE ST, ELEV=102.10 (ASSUMED).

REVISIONS 07-06-21 PER CITY COMMENT

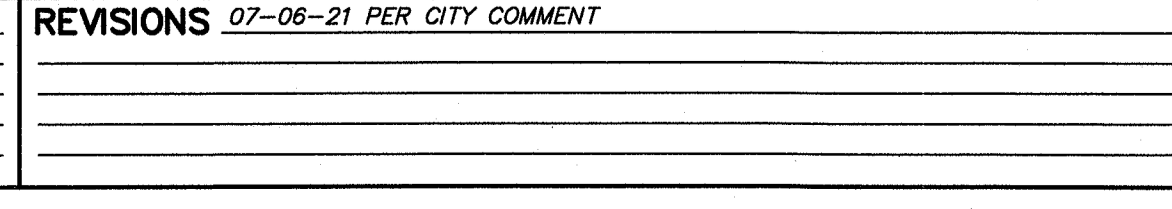

PREPARED BY *Gerald J. Sosnowski*
 GERALD J. SOSNOWSKI RLA, MICH No. 982

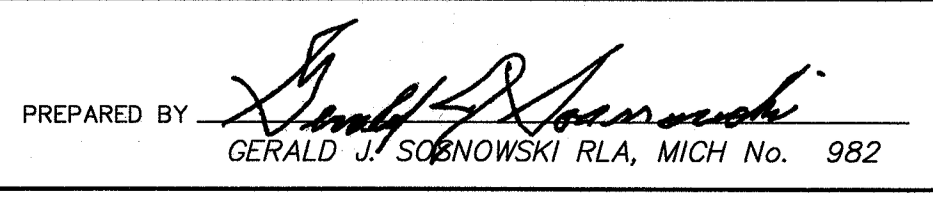

WASHTENAW ENGINEERING
 CIVIL ENGINEERS
 PLANNERS • SURVEYORS
 LANDSCAPE ARCHITECTS
 3526 W. LIBERTY RD
 SUITE 400
 ANN ARBOR, MI 48103
 TEL: 734-761-8800
 FAX: 734-761-8800
 WWW.WASHTENAWENGINEERING.COM

ULDAMAN, INC.
 700 TAPPAN ST
 ANN ARBOR, MI 48104

PROPOSED RAIN GARDEN

SECTION 26 TOWN 2 SOUTH RANGE 6 EAST
 CITY OF ANN ARBOR
 WASHTENAW COUNTY • MICHIGAN
 JOB NO. 32784
 DATE 12-23-20
 DWG NO. 32784
 FIELD BOOK
 FILE NO. 10674