

# CITY OF ANN ARBOR PROJECT MANAGEMENT

## VAUGHN ST./NOB HILL/YOST ALLEY/COPLEY AVE./HARBAL DR. WATER MAIN REPLACEMENT

**JUNE 2010**

BID NO. 4082 FILE NO. 2010.021  
DWRP NO. 7325-01

### SHEET INDEX

SHEET NO.	DRAWING NO.	TITLE
1	2010021-1	COVER SHEET
<b>VAUGHN ST.</b>		
2	2010021-2	TRAFFIC CONTROL - DETAIL "A"
3	2010021-3	TRAFFIC CONTROL - DETAIL "B"
4	2010021-W1	WATER MAIN PLAN & PROFILE
5	2010021-5	STREET CONSTRUCTION DETAILS
<b>NOB HILL</b>		
6	2010021-6	TRAFFIC CONTROL
7	2010021-W2,S1	WATER MAIN & SANITARY PLAN & PROFILE
8	2010021-W3,S2	WATER MAIN PLAN & PROFILE
9	2010021-W4	WATER MAIN PLAN & PROFILE
10	2010021-W5	WATER MAIN PLAN & PROFILE
11	2010021-11	REMOVALS & TREE PROTECTION
<b>YOST ALLEY</b>		
12	2010021-12	TRAFFIC CONTROL
13	2010021-W6	WATER MAIN PLAN & PROFILE
<b>COPLEY AVE.</b>		
14	2010021-14	TRAFFIC CONTROL
15	2010021-15	OVERALL UTILITIES LAYOUT
16	2010021-W7	WATER MAIN PLAN & PROFILE
17	2010021-W8	WATER MAIN PLAN & PROFILE
<b>HARBAL DR.</b>		
18	2010021-18	TRAFFIC CONTROL PLAN
19	2010021-19	TRAFFIC CONTROL PLAN
20	2010021-20	TRAFFIC CONTROL PLAN
21	2010021-W9	WATER MAIN PLAN & PROFILE
22	2010021-W10	WATER MAIN PLAN & PROFILE
23	2010021-23	EROSION CONTROL
24	2010021-24	DETAIL PLAN

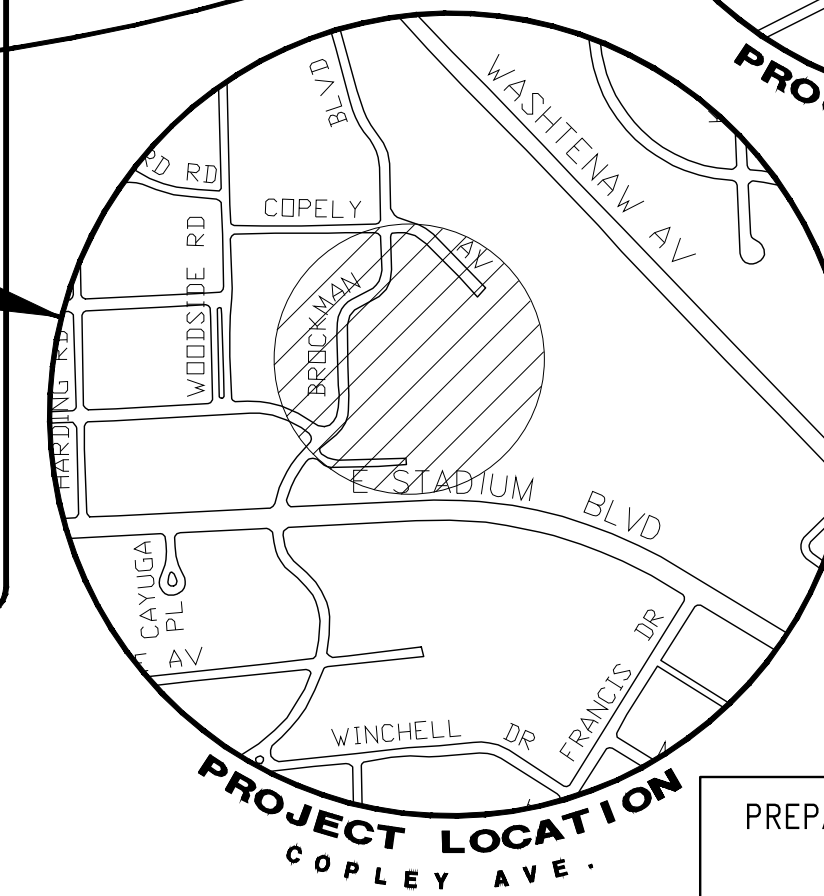
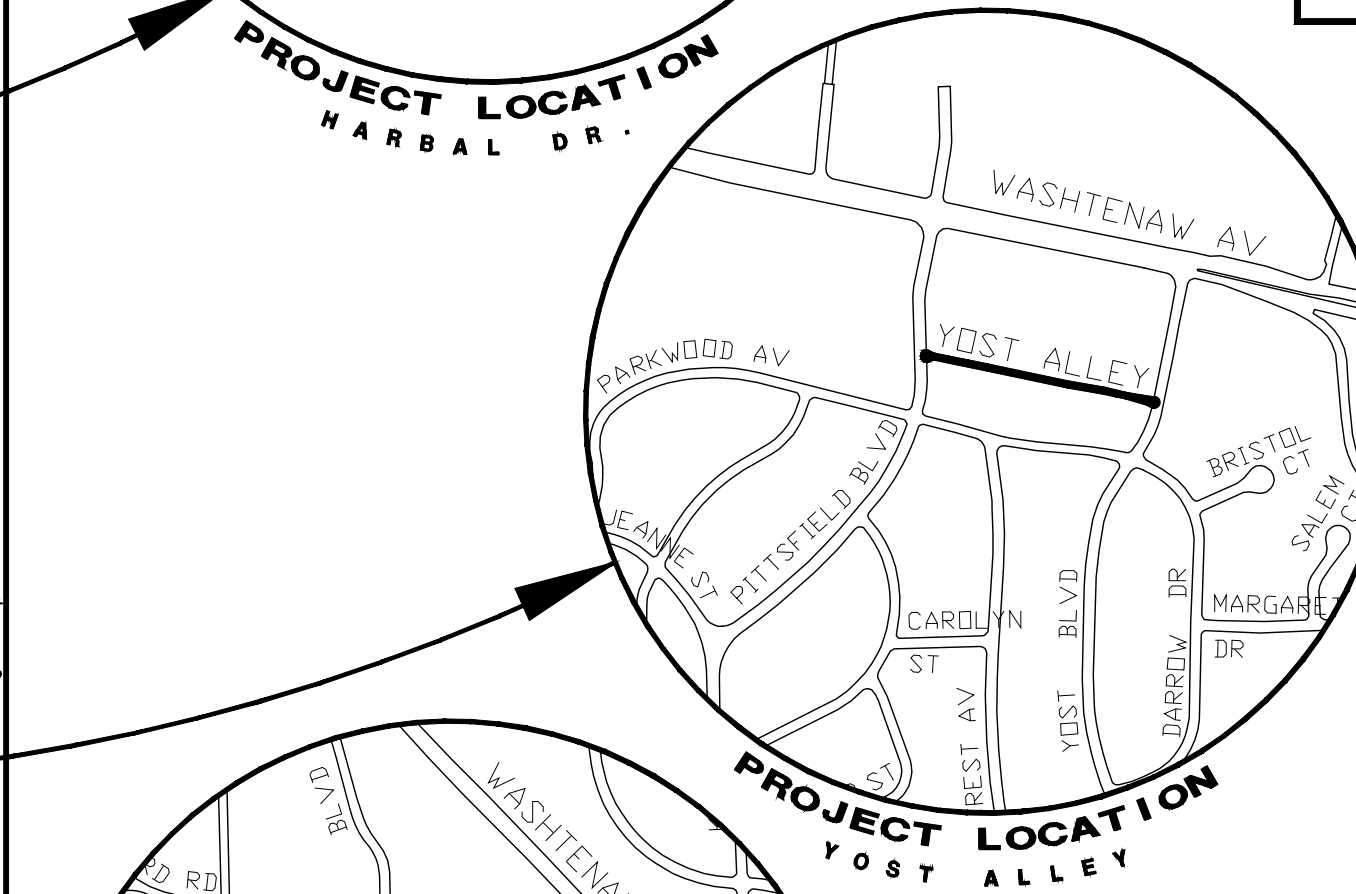
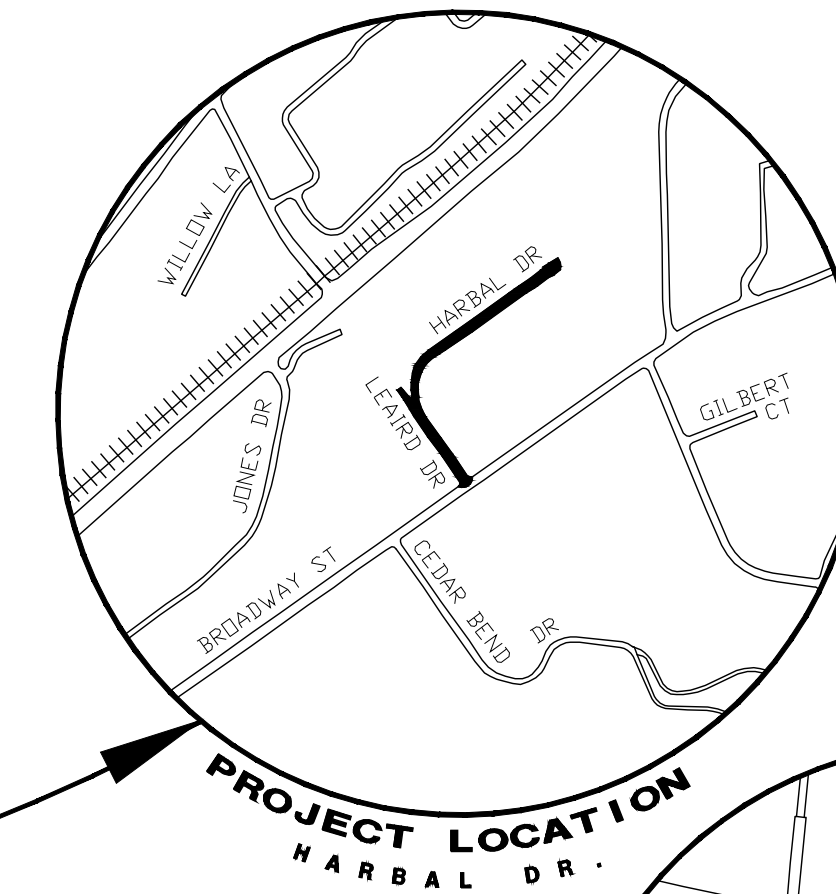
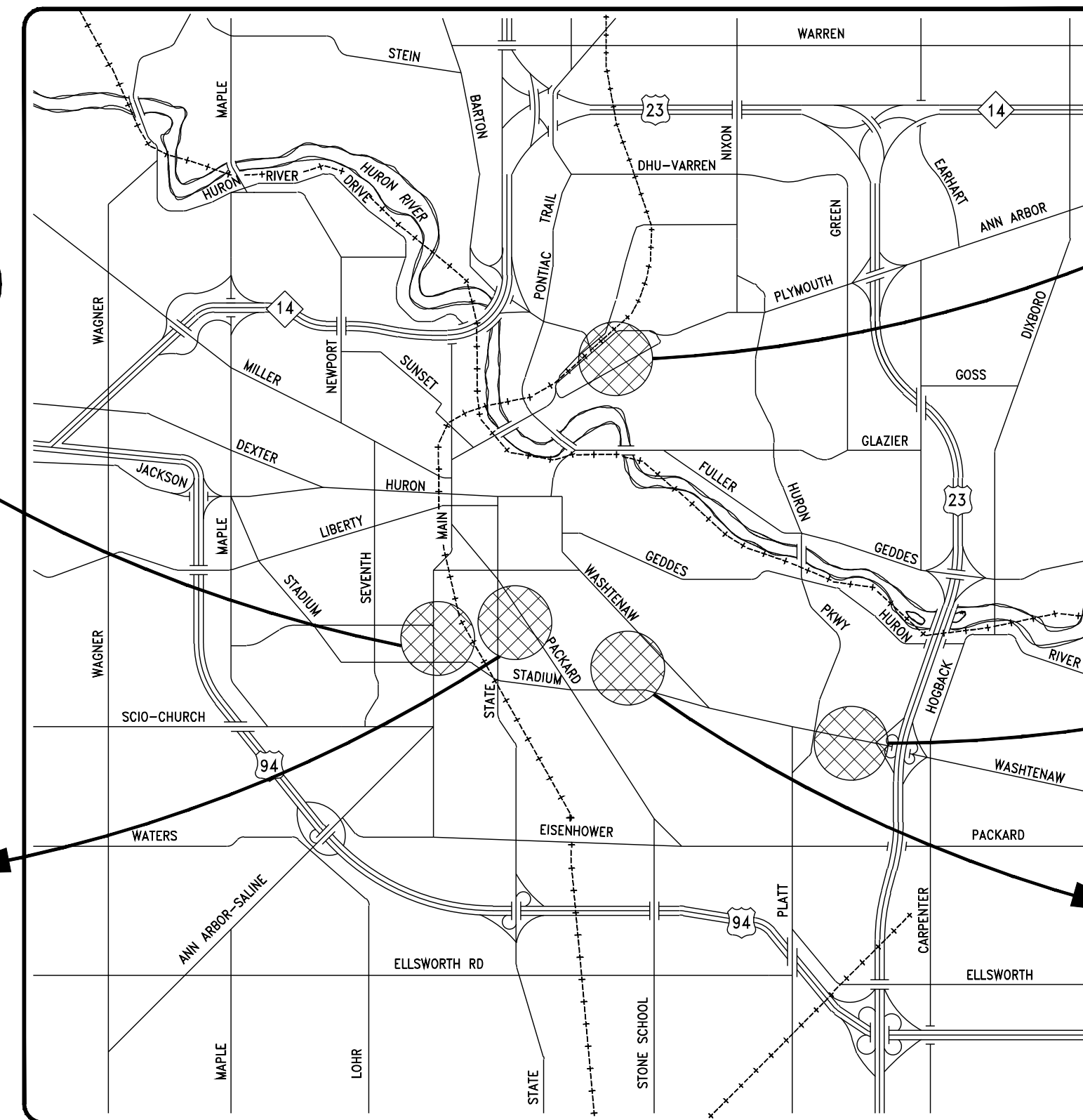
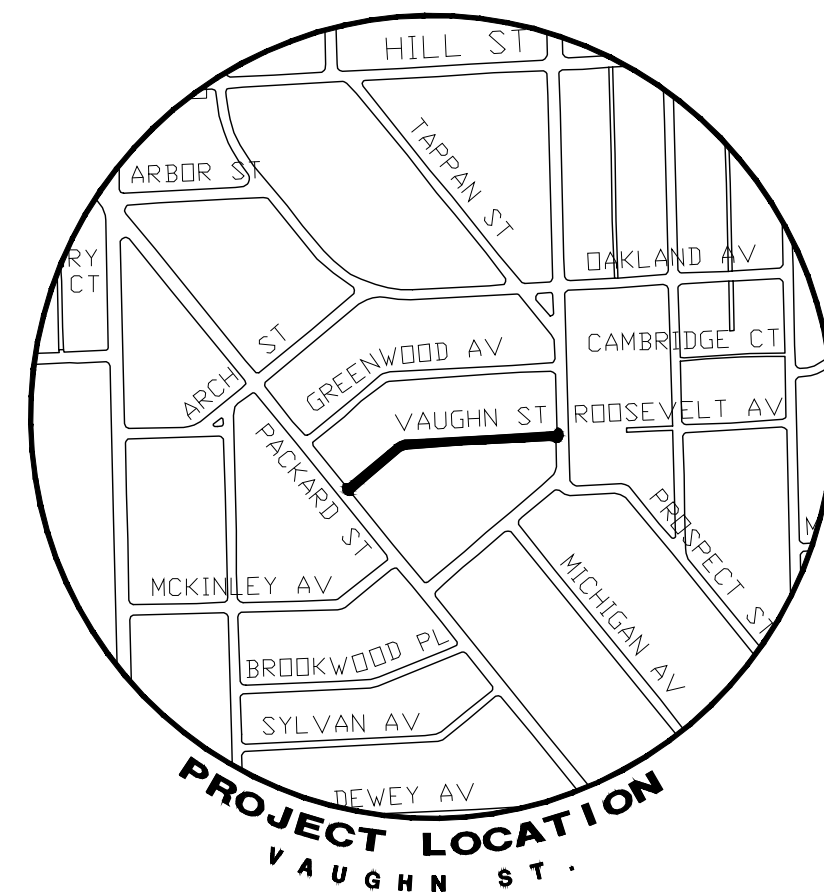
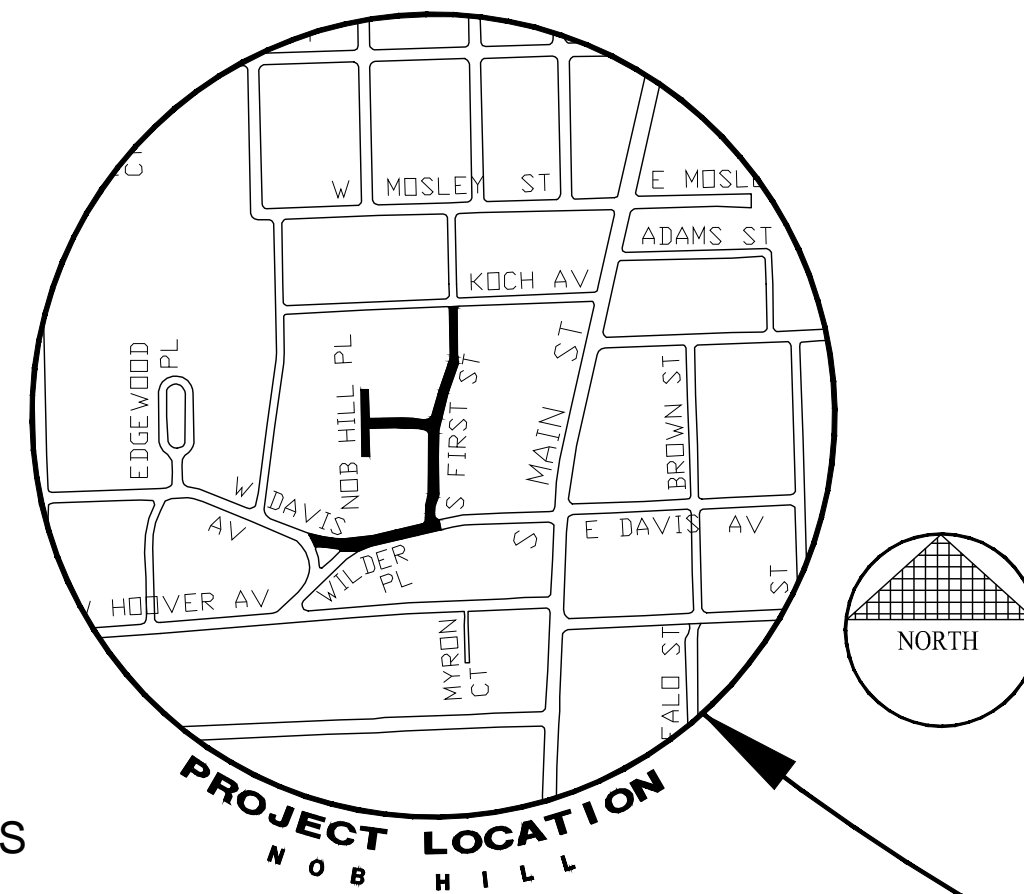

PERMITS REQUIRED TO BE OBTAINED BY THE CONTRACTOR PRIOR TO THE BEGINNING OF CONSTRUCTION. CITY IS RESPONSIBLE FOR THESE PERMIT FEES.	
PERMIT	ISSUING AUTHORITY
LANE CLOSURE PERMIT	CITY OF ANN ARBOR PROJECT MANAGEMENT UNIT
"NO PARKING" SIGNS PERMIT	CITY OF ANN ARBOR PROJECT MANAGEMENT UNIT
ROW PERMIT	CITY OF ANN ARBOR PLANNING AND DEVELOPMENT SERVICES UNIT

PERMITS REQUIRED TO BE OBTAINED BY THE CITY OF ANN ARBOR PRIOR TO THE BEGINNING OF CONSTRUCTION. CITY IS RESPONSIBLE FOR THESE PERMIT FEES.	
PERMIT	ISSUING AUTHORITY
MDEQ WATER MAIN CONSTRUCTION PERMIT	MICHIGAN DEPARTMENT OF ENVIRONMENTAL QUALITY

CITY DEPARTMENTAL REVIEW					
SURVEY	REVIEW ENGINEER	UTILITIES	CES SUPERVISOR	TRAFFIC TEAM	SOIL EROSION
GFD	IK	DZ	N/A	PC	N/A

THE FOLLOWING UTILITIES ARE LOCATED IN OR NEAR THE RIGHT-OF-WAY FOR THIS PROJECT.

PUBLIC UTILITIES		
W.R. WHEELER SERVICE CENTER FIELD SERVICES UNIT	4251 STONESCHOOL RD. ANN ARBOR, MI 48108	734-794-6350 X4-3314

PRIVATE UTILITIES		
AT&T	550 S. MAPLE ANN ARBOR, MI 48103	734-996-5331
DETROIT EDISON CO.	982 BROADWAY ANN ARBOR, MI 48105	734-332-3321
COMCAST	25626 TELEGRAPH RD. SOUTHFIELD, MI 48033	248-809-2757
MICHCON	3150 E. MICHIGAN YPSILANTI, MI 48198	734-485-8100

THE CONSTRUCTION COVERED BY THESE PLANS SHALL CONFORM TO THE CITY OF ANN ARBOR PUBLIC SERVICES DEPARTMENT STANDARD SPECIFICATIONS, WHICH ARE INCLUDED BY REFERENCE. THE OMISSION OF ANY CURRENT STANDARD DETAIL DOES NOT RELIEVE THE CONTRACTOR FROM THIS REQUIREMENT. THE WORK SHALL BE PERFORMED IN COMPLETE CONFORMANCE WITH THE CURRENT PUBLIC SERVICES STANDARD SPECIFICATIONS AND DETAILS.

PREPARED BY:

IGOR KOTLYAR, P.E., MICHIGAN NO. 43287  
SENIOR PROJECT ENGINEER, PROJECT MANAGEMENT SERVICES UNIT

HOMAYOON PIROOZ, P.E., MICHIGAN NO. 34535  
MANAGER, PROJECT MANAGEMENT SERVICES UNIT

DATE

DRAWING NO.  
**2010021-1**

SHEET 1 OF 24

3 WORKING DAYS!  
**BEFORE YOU DIG  
CALL MISS DIG  
800-482-7171  
I TOLL FREE I**

FOR PROTECTION OF UNDERGROUND UTILITIES AND IN CONFORMANCE WITH PUBLIC ACT 53, THE CONTRACTOR SHALL DIAL 1-800-482-7171 A MINIMUM OF THREE FULL WORKING DAYS, EXCLUDING SATURDAYS, SUNDAYS, AND HOLIDAYS PRIOR TO BEGINNING EACH EXCAVATION IN AREAS WHERE PUBLIC UTILITIES HAVE NOT BEEN PREVIOUSLY LOCATED. MEMBERS WILL THUS BE ROUTINELY NOTIFIED. THIS DOES NOT RELIEVE THE CONTRACTOR OF THE RESPONSIBILITY OF NOTIFYING UTILITY OWNERS WHO MAY NOT BE A PART OF THE "MISS DIG" ALERT SYSTEM.

VAUGHN ST./NOB HILL ST./YOST ALLEY/COPLEY AVE./HARBAL DR. WATER MAIN REPLACEMENT BID NO. 4082 FILE NO. 2010021