



STATE OF MICHIGAN
JOCELYN BENSON, SECRETARY OF STATE
DEPARTMENT OF STATE
LANSING

Jaqueline Beaudry
Clerk
301 E Huron St
Ann Arbor MI 48107-8647

RE: Annexation of Property - **Barbour - 3411 Geddes Rd (B-126)**

Dear Jaqueline Beaudry

This letter serves to acknowledge the Office of the Great Seal's receipt on 1/25/2021, of the filing of the annexation pursuant to Act 279 of 1909, Mutual consent or Vacant city owned as amended, from Ann Arbor Township to Ann Arbor City. The receipt date is the effective date of this boundary change. This filing is designated as Job Number 21-001.

All property descriptions for any boundary changes are reviewed by the Michigan Department of Transportation (MDOT), and then published annually in the Michigan Public and Local Acts manual. If any property description is found inaccurate by MDOT, this office will contact you at that time and request a corrected description, which will not impact the effective date of the boundary change.

*****No further acknowledgment will be sent*****

Sincerely,

Mark D Diljak, Analyst
Bureau of Elections/Office of the Great Seal
Telephone: (517)241-1832

cc: Ann Arbor Township Clerk
Washtenaw County Clerk
Michigan Department of Labor and Economic Growth,
State Boundary Commission/Office of Land Survey and
Remonumentation
Michigan Department of Technology Management and
Budget, Center for Shared Solutions Technology
Partnerships
Michigan Department of Treasury, Office of Revenue and
Tax Analysis
Michigan Department of Transportation, Bureau of
Transportation Planning
U.S. Bureau of the Census
Office of the Great Seal Job Number 21-001

Record of Proceedings filed in the Office of the Secretary of State

1/25/2021



STATE OF MICHIGAN
JOCELYN BENSON, SECRETARY OF STATE
DEPARTMENT OF STATE
LANSING

JOB REPORT

Annexation: 21-001- Barbour - **3411**
Geddes Rd (B-126)
Statute: Act 279 of 1909, Mutual
consent or Vacant city owned
Municipality: Ann Arbor City
Township: Ann Arbor Township
County: Washtenaw
Property: A20-004 & Z20-051
Sent to MDOT: 2/24/2021

Record of Proceedings filed in the Office of the Secretary of State

1/25/2021



STATE OF MICHIGAN
JOCELYN BENSON, SECRETARY OF STATE
DEPARTMENT OF STATE
LANSING

Job Number: 21-001

Townships

Washtenaw County

In the matter of the annexation of a certain property located in Ann Arbor Township to Ann Arbor City. Conditionally transferred in accordance with the provisions of Act 279 of 1909, Mutual consent or Vacant city owned, as amended the following described property:

A part of the Southwest 1/4 of Section 22, Town 2 South, Range 6 East, City of Ann Arbor, Washtenaw County, Michigan described as: Commencing at the South 1/4 Corner of said Section 22; thence along the North-South 1/4 line of said Section North 00°19'57" East 2693.85 feet to the Center of said Section as monumented; thence along the West line of "Hill Tops", according to the plat thereof as recorded in Liber 9 of Plats, Page 52, Washtenaw County records, and its southerly extension South 00°00'00" East 1467.11 feet (recorded as 1474.30 feet) to the Centerline of Geddes Road; thence along said Centerline 120.20 feet along the arc of a 2292.01 feet radius circular curve to the left, said curve having a central angle of 3°00'17" and a chord which bears South 88°37'54" East 120.18 feet to the POINT OF BEGINNING; thence North 00°00'00" West 429.25 feet to a point on the South line of Lot 1, "Hill Tops"; thence along said South line North 61°06'07" East 114.33 feet (recorded as North 61°00' East 114.3 feet to the West line of Sumac Lane (66 feet wide, private); thence along said West line South 00°00'00" East 484.25 feet to the Centerline of said Geddes Road; thence along said Centerline in the following three (3) courses: 1) 33.24 feet along the arc of a 1146.28 feet radius circular curve to the left, said curve having a central angle of 1°39'40" and a chord which bears North 89°36'09" West 33.23 feet, 2) South 89°34'01" West 54.90 feet, and 3) 11.96 feet (recorded as 9.2 feet) along the arc of a 2292.01 feet radius circular curve to the right, said curve having a central angle of 00°17'57" and a chord which bears South 89°42'59" West 11.96 feet to the POINT OF BEGINNING.

Parcel ID# I -09-26-440-008 also known as 3411 Geddes, Ann Arbor, MI 48105

*OLD SID - I 09-026-025-10 AA 26-12B-2 COM AT CEN OF SEC TH S 0 DEG 0' 30" E 1110.62 FT ON NS 1/4 LN TH N 61 DEG E 137.2 FT TO POB TH N 61 DEG E 114.3 FT TH S 485.83 FT TH WLY ON C/L GEDDES RD TO A PNT S 0 DEG 0' 30" E 430.2 FT FRM POB TH N 0 DEG 0' 30" W 430.2 FT TO POB PART SE 1/4 SEC 26 T2S R6E 1.05 AC.

Record of Proceedings filed in the Office of the Secretary of State

1/25/2021



STATE OF MICHIGAN
JOCELYN BENSON, SECRETARY OF STATE
DEPARTMENT OF STATE
LANSING

Job Number: 21-001

Townships

Washtenaw County

COMMENCING AT THE CENTER POST OF SECTION 26, T2S, R6E, WASHTENAW COUNTY, MICHIGAN, AND RUNNING THENCE SOUTHERLY ALONG THE NORTH-SOUTH 1/4 LINE OF SAID SECTION 26 FOR 1474.3 FEET TO THE CENTERLINE OF GEDDES ROAD (SO-CALLED); THENCE EASTERLY ALONG SAID CENTERLINE ON A CURVE LEFT WHOSE CENTRAL ANGLE IS 06°10' AND WHOSE RADIUS IS 2292.01 FEET FOR 120.04 FEET FOR A POINT OF BEGINNING; THENCE RUNNING EASTERLY ALONG SAID CENTERLINE OF SAID CURVE LEFT FOR 09.2 FEET TO THE POINT OF TANGENCY OF SAID CURVE LEFT; THENCE EASTERLY ALONG SAID CENTERLINE ALONG THE TANGENT OF SAID CURVE FOR 54.9 FEET; THENCE SOUTHEASTERLY ALONG SAID CENTERLINE ON A CURVE RIGHT, WHOSE CENTRAL ANGLE IS 14°18' AND WHOSE RADIUS IS 1146.28 FEET FOR 35.9 FEET; THENCE NORTHERLY PARALLEL TO THE NORTH-SOUTH 1/4 LINE OF SECTION 26, T2S, R6E, FOR 485.83 FEET; THENCE DEFLECTING 119°00' TO THE LEFT AND RUNNING SOUTHWESTERLY FOR 114.3 FEET; THENCE DEFLECTING 61°00' TO THE LEFT AND RUNNING SOUTHERLY PARALLEL TO THE NORTH-SOUTH 1/4 LINE OF SECTION 26, T2S, R6E, FOR 430.2 FEET TO THE POINT OF BEGINNING, BEING A PART OF THAT PART OF THE WEST 1/2 OF THE WEST 1/2 OF THE SOUTHEAST 1/4 OF SECTION 26, ANN ARBOR TOWNSHIP, WASHTENAW COUNTY, MICHIGAN AND LYING NORTH OF GEDDES ROAD.

Record of Proceedings filed in the Office of the Secretary of State

1/25/2021

OFFICE OF THE GREAT SEAL
RICHARD H. AUSTIN BUILDING ■ 1ST FLOOR ■ 430 W. ALLEGAN ■ LANSING, MICHIGAN 48918
1-888-SOS-MICH (1-888-767-6424)
Michigan.gov/SOS



CITY OF ANN ARBOR, MICHIGAN

City Clerk

301 E Huron Street, P.O. Box 8647, Ann Arbor, Michigan 48107-8647

Phone (734)794-6140 Fax (734)994-8296

www.a2gov.org

City Clerk

January 13, 2021

Office of the Great Seal
Michigan Department of State
717 Allegan St.
Lansing, MI 48918-1750

Re: Annexation from Ann Arbor Township
(City File No. A20-004 and Z20-051)

RECEIVED/FILED
MICHIGAN DEPT OF STATE
2021 JAN 25 PM 2:31
ELECTION/GREAT SEAL

To Whom It May Concern:

Enclosed is a certified copy of the annexation resolution adopted by the Ann Arbor City Council at its regular session of December 7, 2020, relative to the Barbour Property, 1.1 acres, located at 3411 Geddes Road in Ann Arbor Township. Submitted with the City resolution are copies of the township resolution and the petition for the annexation, both containing property descriptions.

Sincerely,

Jacqueline Beaudry
City Clerk

Encl. 3

cc: Lawrence Kestenbaum, Washtenaw County Clerk/Register

State County Annexation.



City of Ann Arbor

301 E. Huron St.
Ann Arbor, MI 48104
<http://a2gov.legistar.com>
/Calendar.aspx

Certified Copy

Resolution/Public Hearing: R-20-455

File Number: 20-1678

Enactment Number: R-20-455

Resolution to Approve the 3411 Geddes Road Annexation, 1.1 Acres (CPC Recommendation: Approval - 6 Yeas and 0 Nays)

Whereas, The territory hereinafter described is located in the Ann Arbor Charter Township and is adjacent to the corporate limits of the City of Ann Arbor;

Whereas, Carol G. Barbour Revocable Trust U/A/D 7-1-1987 is the owner of said property;
and

Whereas, It is the desire of Carol G. Barbour Revocable Trust U/A/D 7-1-1987 to annex said territory to the City of Ann Arbor, pursuant to the provisions of Act 359 of the Public Acts of the State of Michigan, as amended;

RESOLVED, That the following described lands and premises situated and being in the Ann Arbor Charter Township, Washtenaw County, Michigan, be detached from said Township and annexed to the City of Ann Arbor, to-wit:

A part of the Southwest 1/4 of Section 22, Town 2 South, Range 6 East, City of Ann Arbor, Washtenaw County, Michigan described as: Commencing at the South 1/4 Corner of said Section 22; thence along the North-South 1/4 line of said Section North 00°19'57" East 2693.85 feet to the Center of said Section as monumented; thence along the West line of "Hill Tops", according to the plat thereof as recorded in Liber 9 of Plats, Page 52, Washtenaw County records, and its southerly extension South 00°00'00" East 1467.11 feet (recorded as 1474.30 feet) to the Centerline of Geddes Road; thence along said Centerline 120.20 feet along the arc of a 2292.01 feet radius circular curve to the left, said curve having a central angle of 3°00'17" and a chord which bears South 88°37'54" East 120.18 feet to the POINT OF BEGINNING; thence North 00°00'00" West 429.25 feet to a point on the South line of Lot 1, "Hill Tops"; thence along said South line North 61°06'07" East 114.33 feet (recorded as North 61°00' East 114.3 feet to the West line of Sumac Lane (66 feet wide, private); thence along said West line South 00°00'00" East 484.25 feet to the Centerline of said Geddes Road; thence along said Centerline in the following three (3) courses: 1) 33.24 feet along the arc of a 1146.28 feet radius circular curve to the left, said curve having a central angle of 1°39'40" and a chord which bears North 89°36'09" West 33.23 feet, 2) South 89°34'01" West 54.90 feet, and 3) 11.96 feet (recorded as 9.2 feet) along the arc of a 2292.01 feet radius circular curve to the right, said curve having a central angle of 00°17'57" and a chord which bears South 89°42'59" West 11.96 feet to the POINT OF BEGINNING.

I, Jacqueline Beaudry, Clerk of the City of Ann Arbor, Michigan, certify that this is a true copy of Resolution/Public Hearing R-20-455, passed by the Ann Arbor City Council on 12/7/2020.

Attest:  January 13, 2021
Jacqueline Beaudry Date Certified

3411 Geddes Rd

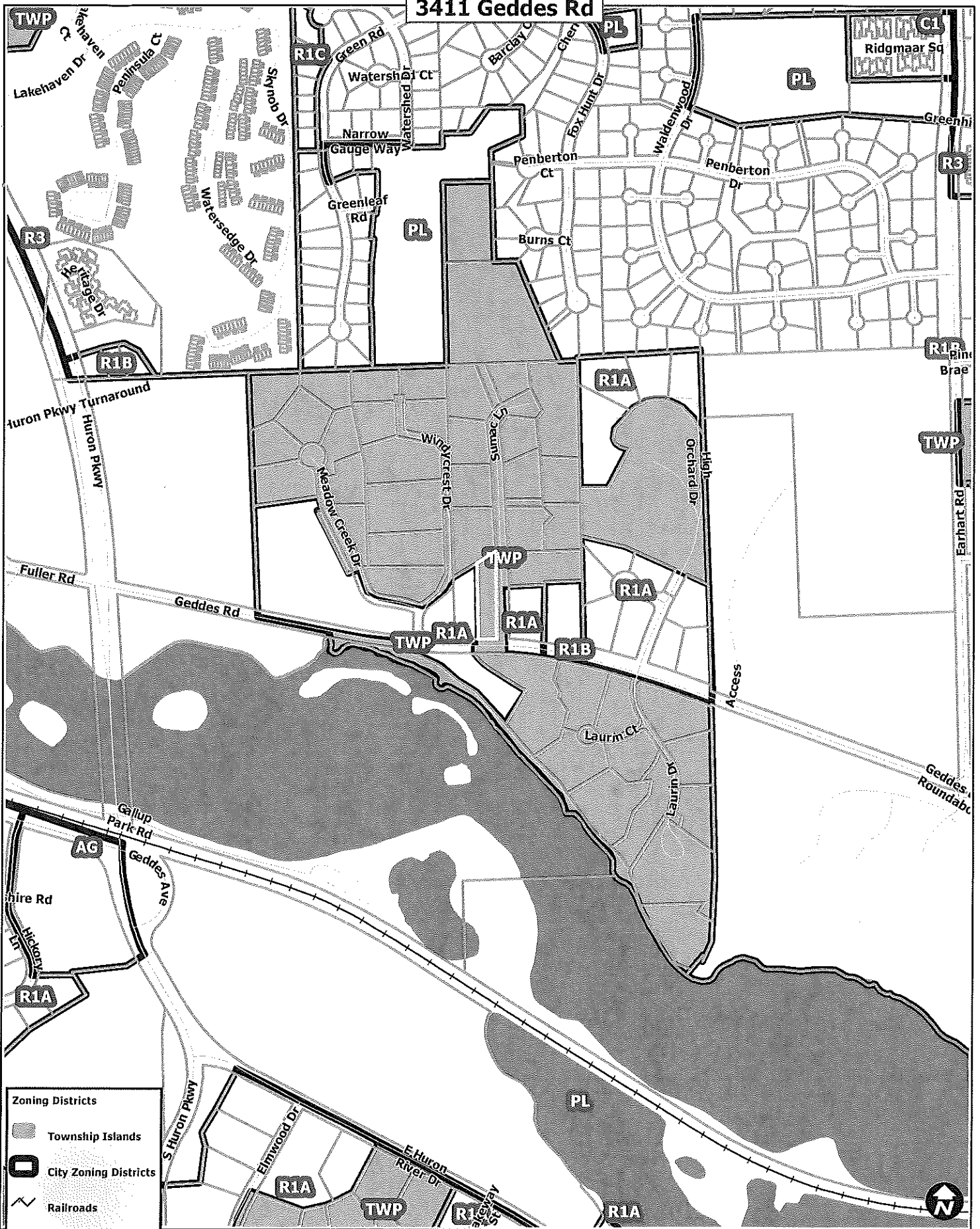

- Zoning Districts**
- Township Islands
 - City Zoning Districts
 - Railroads
 - Huron River
 - Tax Parcels



**ANN ARBOR CHARTER TOWNSHIP
RESOLUTION TO APPROVE ANNEXATION**

WHEREAS, the territory described is located in Ann Arbor Township within the area to be annexed to the city of Ann Arbor under the 1994 Policy Statement between the City of Ann Arbor and Ann Arbor Township, and

WHEREAS, a petition to annex said territory to the City of Ann Arbor, signed by persons or entities who collectively hold record legal title to all of the land in said territory, has been filed with the Township Board, and requests annexation to the City for the purpose of connecting to city utilities, and

WHEREAS, owner

Carol G. Barbour, Trustee

has filed a petition for release for annexation in order to connect to City utilities, and

NOW, BE IT RESOLVED, that the following described lands and premises situated and being in Ann Arbor Charter Township, Washtenaw County, Michigan, be released from the Township in order to be annexed to the City of Ann Arbor, to-wit:

Parcel ID# I -09-26-440-008 also known as 3411 Geddes, Ann Arbor, MI 48105

*OLD SID - I 09-026-025-10 AA 26-12B-2 COM AT CEN OF SEC TH S 0 DEG 0' 30" E 1110.62 FT ON NS 1/4 LN TH N 61 DEG E 137.2 FT TO POB TH N 61 DEG E 114.3 FT TH S 485.83 FT TH WLY ON C/L GEDDES RD TO A PNT S 0 DEG 0' 30" E 430.2 FT FRM POB TH N 0 DEG 0' 30"W 430.2 FT TO POB PART SE 1/4 SEC 26 T2S R6E 1.05 AC.

I hereby certify that the foregoing constitutes a true and complete copy of a resolution adopted by the Board of Ann Arbor Charter Township, Washtenaw County, Michigan, at its regular meeting held on September 21, 2020.

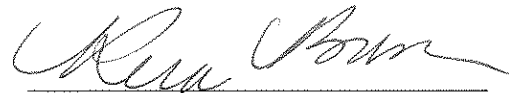

Rena Basch, Clerk
Ann Arbor Township



City of Ann Arbor
PLANNING & DEVELOPMENT SERVICES — PLANNING DIVISION
 301 East Huron Street P.O. Box 8647 Ann Arbor, Michigan 48107-8647
 734.794.6265 : 734.994.8312 planning@a2gov.org

PETITION FOR ANNEXATION BY RELEASE

The Planning and Development Services Unit would like to take this opportunity to welcome you as a member of our community. Annexation to the City will provide you with the same benefits available to Ann Arbor citizens. These benefits include fire and police protection, use of City parks, refuse pick-up and recycling services, eligibility for City water and sewer lines, and participation on City boards and commissions. We are looking forward to your involvement in our community and hope that you will enjoy the many advantages the City of Ann Arbor has to offer.

TO: The Township Board of Ann Arbor, Washtenaw County, Michigan

And

The City Council of the City of Ann Arbor, Michigan

We, the undersigned, respectfully petition your honorable bodies that the following described land be detached from the Township of Ann Arbor and annexed to the City of Ann Arbor by affirmative majority vote of the Ann Arbor City Council and approval of the Ann Arbor Township Board, in accordance with the provisions of Public Act 279 of 1909, or Public Act 359 of 1947, State of Michigan, AS AMENDED.

The land proposed to be detached from the Township of Ann Arbor and annexed to the City of Ann Arbor is described as follows to wit:

Attached (legal description)

We further represent as follows:

- a. That the above-described land is contiguous to the corporate limits of the City of Ann Arbor, Michigan, or within an area being served by said City.
- b. That there are no qualified electors residing on the land proposed to be annexed other than the petitioners.
- c. That the petition includes all qualified parcels within the vicinity that want to annex to the City of Ann Arbor.

d. That the petitioner(s), **CAROL G BARBOUR, TRUSTEE**, is/are the **Owner** (name) of the land proposed to be annexed. (owner, land contract, option to purchase)

The whole of the area of land proposed to be annexed is 1.05 acres, of which

- 0 acres of land are in public roads.
- e. That the person(s) liable for the payment of any outstanding improvement charges acknowledges full knowledge thereof, and consents to pay same in accordance with the resolution to be adopted by the City Council pursuant to Section 1:278 of Chapter 12, Title I of the City Code of the City of Ann Arbor, Michigan.
 - f. That the petitioner(s) attests that the land requested for annexation into the City of Ann Arbor represents all contiguous land holdings of the petitioner(s).
 - g. That the number of people residing on the land requested for annexation is 2.
 - h. That, of the number of people residing on the land requested for annexation, the number of renters is 0.
 - i. That the reason(s) for requesting annexation are as follows:

Connect to City of Ann Arbor water and sewer

Dated: 08-08-2020
 Signature: Carol A. Carlson, Trustee

(Print name and address of petitioner)

Signature: _____

(Print name and address of petitioner)

STATE OF MICHIGAN
 COUNTY OF WASHTENAW

On this 8th day of August, 2020, before me personally appeared the above- named petitioner(s), who being duly sworn, say that they have read the foregoing petition by them signed, and know the contents thereof, and that the same is true of their knowledge, except as to the matter therein stated to be upon their information and belief, and as to those matters they believe it to be true.

Signature: 
Emily Melcher
(Print name of Notary Public)

EMILY MELCHER
 Notary Public Washtenaw County MI
 My Commission Expires July 8, 2026

My Commission Expires: 07/08/2026
 2026₂

LEGAL DESCRIPTION (AS PROVIDED BY CLIENT):

COMMENCING AT THE CENTER POST OF SECTION 26, T2S, R6E, WASHTENAW COUNTY, MICHIGAN, AND RUNNING THENCE SOUTHERLY ALONG THE NORTH-SOUTH 1/4 LINE OF SAID SECTION 26 FOR 1474.3 FEET TO THE CENTERLINE OF GEDDES ROAD (SO-CALLED); THENCE EASTERLY ALONG SAID CENTERLINE ON A CURVE LEFT WHOSE CENTRAL ANGLE IS 06°10' AND WHOSE RADIUS IS 2292.01 FEET FOR 120.04 FEET FOR A POINT OF BEGINNING; THENCE RUNNING EASTERLY ALONG SAID CENTERLINE OF SAID CURVE LEFT FOR 09.2 FEET TO THE POINT OF TANGENCY OF SAID CURVE LEFT; THENCE EASTERLY ALONG SAID CENTERLINE ALONG THE TANGENT OF SAID CURVE FOR 54.9 FEET; THENCE SOUTHEASTERLY ALONG SAID CENTERLINE ON A CURVE RIGHT, WHOSE CENTRAL ANGLE IS 14°18' AND WHOSE RADIUS IS 1146.28 FEET FOR 35.9 FEET; THENCE NORTHERLY PARALLEL TO THE NORTH-SOUTH 1/4 LINE OF SECTION 26, T2S, R6E, FOR 485.83 FEET; THENCE DEFLECTING 119°00' TO THE LEFT AND RUNNING SOUTHWESTERLY FOR 114.3 FEET; THENCE DEFLECTING 61°00' TO THE LEFT AND RUNNING SOUTHERLY PARALLEL TO THE NORTH-SOUTH 1/4 LINE OF SECTION 26, T2S, R6E, FOR 430.2 FEET TO THE POINT OF BEGINNING, BEING A PART OF THAT PART OF THE WEST 1/2 OF THE WEST 1/2 OF THE SOUTHEAST 1/4 OF SECTION 26, ANN ARBOR TOWNSHIP, WASHTENAW COUNTY, MICHIGAN AND LYING NORTH OF GEDDES ROAD.

CLIENT: BARBOUR

SURVEY OF A 1.05 ACRE PARCEL
OF LAND IN THE SE 1/4 OF
SECTION 26, T2S, R6E,
CITY OF ANN ARBOR,
WASHTENAW COUNTY, MICHIGAN.

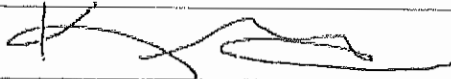



**Arbor Land
Consultants, Inc.**

Professional Land
Surveyors

2936 Madrono
Ann Arbor, Mi 48103
Tel (734) 669-2960
Fax (734) 669-2961
www.arborlandinc.com

SCALE 1 INCH = 100 FEET	JOB No.	17511	DATE	12-16-2011
	SHEET	2 OF 2	REVISION:	-



 <p>The information contained on this map is proprietary and confidential. The use or disclosure of this information by you to third parties is prohibited by law and may give rise to civil or criminal liability.</p>	<p>Source: SENCOCO Aerial Imagery (2015)</p>
<p>1 ft Contours Building Footprint (City of Ann Arbor GIS) Parcel Project Boundary 07/21/2020 (~1.00 acres)</p>	<p>1 inch = 40 feet Atwell, LLC Project: 20002538</p>
<p>3411 Geddes Site Overview Map Washtenaw County, Michigan Date: 7/21/2020</p>	

3411 Geddes Rd

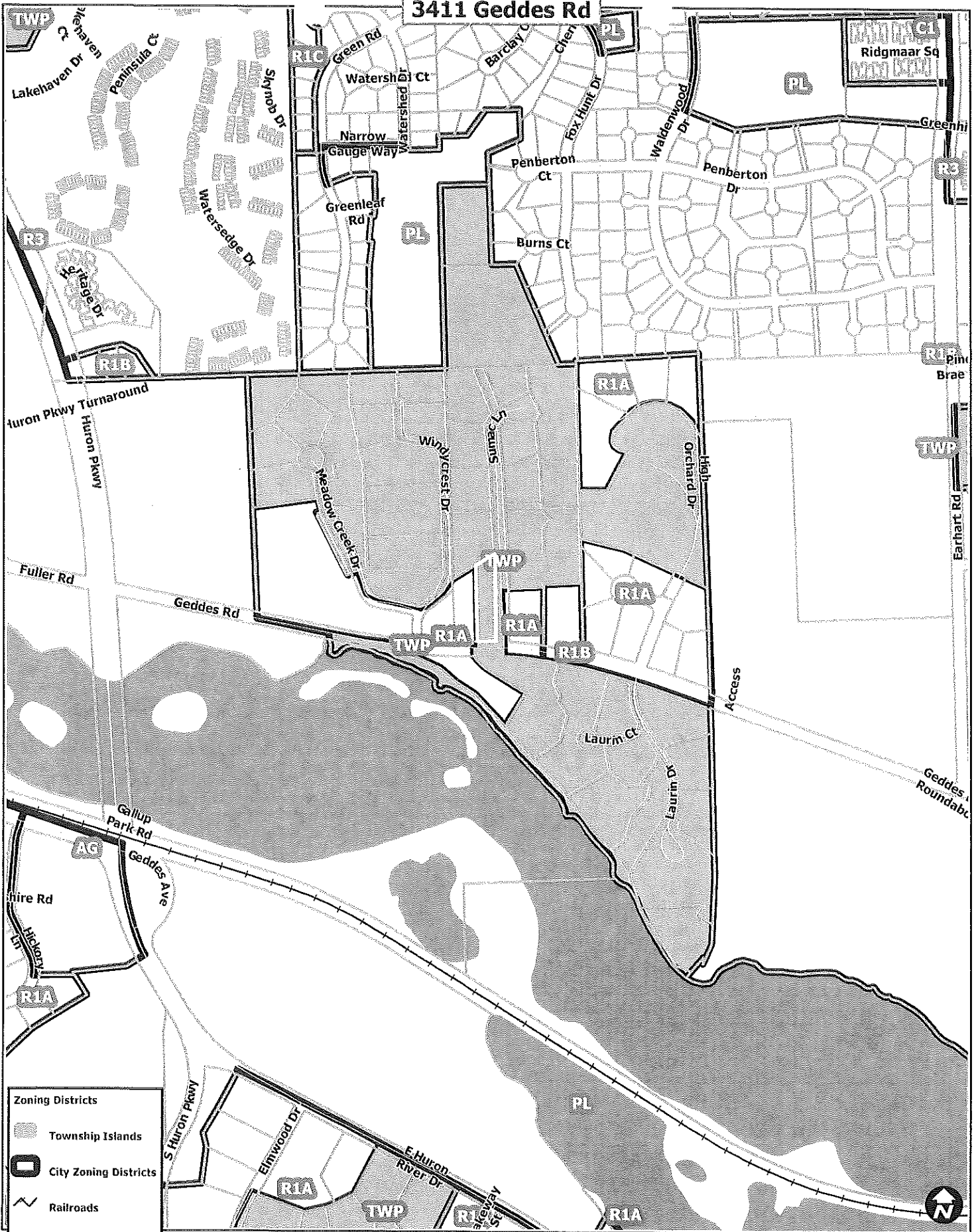

Map date: 9/16/2020
 Any aerial imagery is circa 2018 unless otherwise noted
 Terms of use: www.a2gov.org/terms