

ANNEXATION PETITION
State Boundary Commission
Office of Land Survey and Remonumentation
Bureau of Construction Codes/LARA
Authority: 1968 PA 191

General instructions for preparation of an Annexation Petition, by city council resolution, which consist of the following parts and forms:

Part I Map shall be labeled and prepared pursuant to State Boundary Commission General Rule 37; **attach sheets** [R123.37]

Part II Petition Certification; see page 2 [MCL117.9(7)(a)]

Part IIa Contact information; see page 3 and attach additional sheets as necessary [R123.32(1)]

Part III Legal description shall be labeled and prepared pursuant to State Boundary Commission General Rule 37; **attach sheets** [R123.37]

Part IV Resolution; attach a copy of the resolution passed by the City Council requesting the annexation of the property shown on the “Part I” map and described in the “Part III” description [R123.37]

Part IVa Certification by City Clerk; see page 4

Part V Reason for request petitioner(s) reason(s) for the annexation request and statement indicating that the annexation meets the conditions pursuant to Section 9 of The Home Rule City Act, 1909 PA 279 [MCL117.9(7)(a)]; **no form is prescribed; attach sheets labeled “PART V”** [R123.37]

Part VI This part is not required on this type of petition.

Part VII Map shall be labeled and prepared pursuant to State Boundary Commission General Rule 37; **attach sheets** [R123.37]

The completed petition should be filed with the State Boundary Commission. This may be done in person between the hours of 8:00 a.m. and 5:00 p.m., or by mail.

In Person:
State Boundary Commission
Office of Land Survey and Remonumentation
Bureau of Construction Codes/LARA
2501 Woodlake Circle
Okemos, MI 48864

Mail to:
State Boundary Commission
Office of Land Survey and Remonumentation
Bureau of Construction Codes/LARA
P.O. Box 30254
Lansing, MI 48909

Part 1

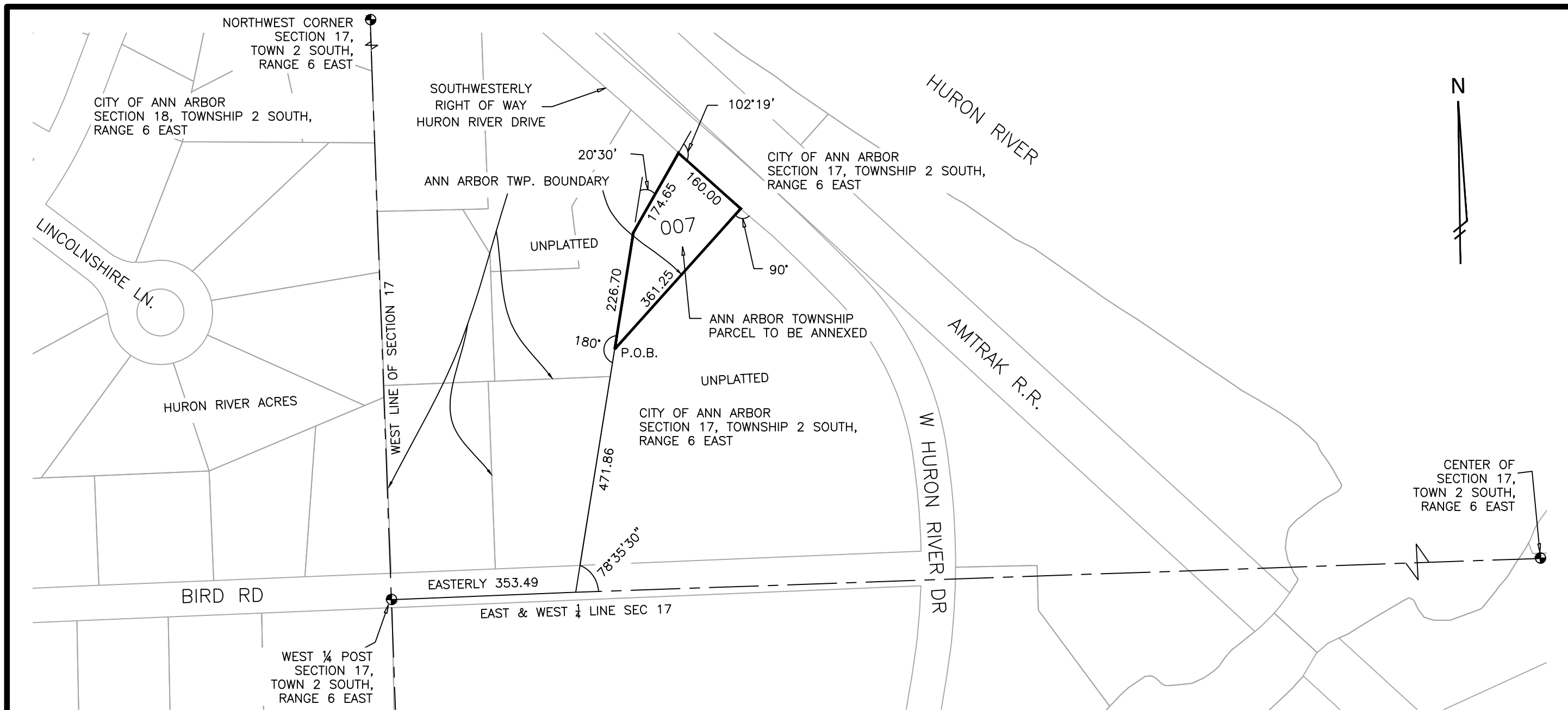

I-09-17-250-007 (1101 HURON RIVER DR)

LEGAL DESCRIPTION

COMMENCING AT WEST ¼ POST OF SECTION 17; THENCE EASTERLY 353.49 FEET IN EAST AND WEST ¼ LINE TO THE WEST LINE OF THE CITY OF ANN ARBOR; THENCE DEFLECTING 78°35'30" LEFT 471.86 FEET ALONG SAID WEST LINE FOR A PLACE OF BEGINNING; THENCE CONTINUE IN SAME LINE 226.70 FEET; THENCE DEFLECTING 20°30' TO THE RIGHT 174.65 FEET; THENCE ALONG THE ANN ARBOR CITY BOUNDARY FOR THE REMAINING COURSES: THENCE DEFLECT 102°19' RIGHT 160.0 FEET IN THE SOUTHWESTERLY LINE OF HURON RIVER DRIVE; THENCE DEFLECTING 90° RIGHT 361.25 FEET TO PLACE OF BEGINNING; BEING IN THE NORTHWEST ¼ OF SECTION 17, TOWNSHIP 2 SOUTH, RANGE 6 EAST; CONTAINS 0.70 OF AN ACRE OF LAND.

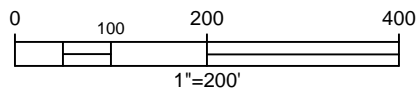

PROJECT MANAGEMENT - PUBLIC SERVICES - CITY OF ANN ARBOR



Part 1
2014 Annexation
1101 HURON RIVER DRIVE

301 EAST HURON STREET
 ANN ARBOR, MI 48107-8647
 734-794-6410
 www.a2gov.org

DATE	14 AUGUST, 2014
REVISED	5 MAY, 2015
DRAWN	MAS
SCALE	1" = 200'
SHEET No.	1 of 1

PART II

WE, the duly elected legislative body of the City of Ann Arbor,
having passed a resolution requesting the annexation of territories as described in Part III within
the township(s) of Ann Arbor Charter, in the County(ies) of
Washtenaw, do hereby petition that the territories described in
Part III be annexed to the City of Ann Arbor and that this
annexation be considered by the State Boundary Commission pursuant to the provisions of 1909
PA 279 and 1968 PA 191.

PART IIa

It is the responsibility of the petitioner(s) to furnish the State Boundary Commission with the following contact information in order for the government units to receive notice of docket material, meetings, and public hearings. The importance of accurate and current information cannot be overemphasized. Processing of a petition may be delayed if inaccuracies cause improper notice.

If the petition should involve more than one county, city, village, and/or township, place the designated government contact information on a separate sheet(s) and attach it to this form.

Petitioner: City of Ann Arbor	
Address: 301 E. Huron St.	
City, State, Zip: Ann Arbor, MI 48107	
Telephone: 734 794-6265 x42614	Fax: 734 994-8296
E-Mail: JKahan@a2gov.org	

City: City of Ann Arbor	Clerk: Jacqueline Beaudry
Address: 301 E. Huron St.	
City, State, Zip: Ann Arbor, MI 48107	
Telephone: 734 794-6140	Telephone: 734 994-8296
E-Mail: CityClerk@a2gov.org or JBeaudry@a2gov.org	

Village: N/A	Clerk:
Address:	
City, State, Zip:	
Telephone:	Telephone:
E-Mail:	

Township: Ann Arbor Charter Township	Clerk: Rena Basch
Address: 3792 Pontiac Trail	
City, State, Zip: Ann Arbor, MI 48105	
Telephone: 734 663-3418 x108	Telephone: 734 663-6678
E-Mail: basch@aatwp.org	

County: Washtenaw County	Clerk: Lawrence Kestenbaum
Address: 200 N. Main; P.O. Box 8645	
City, State, Zip: Ann Arbor, MI 48107	
Telephone: 734 222-6700	Telephone: 734 222-6528
E-Mail:	

Part III
Legal Description

COMMENCING AT WEST ¼ POST OF SECTION 17; THENCE EASTERLY 353.49 FEET IN EAST AND WEST ¼ LINE TO THE WEST LINE OF THE CITY OF ANN ARBOR; THENCE DEFLECTING 78°35'30" LEFT 471.86 FEET ALONG SAID WEST LINE FOR A PLACE OF BEGINNING; THENCE CONTINUE IN SAME LINE 226.70 FEET; THENCE DEFLECTING 20°30' TO THE RIGHT 174.65 FEET; THENCE ALONG THE ANN ARBOR CITY BOUNDARY FOR THE REMAINING COURSES: THENCE DEFLECT 102°19' RIGHT 160.0 FEET IN THE SOUTHWESTERLY LINE OF HURON RIVER DRIVE; THENCE DEFLECTING 90° RIGHT 361.25 FEET TO PLACE OF BEGINNING; BEING IN THE NORTHWEST ¼ OF SECTION 17, TOWNSHIP 2 SOUTH, RANGE 6 EAST; CONTAINS 0.70 OF AN ACRE OF LAND.

Part IV

PART IVa

The foregoing is a certified and true copy of a resolution passed by the legislative body of the City of Ann Arbor on the 15th day of June, 2015, by a vote of _____ to _____.

Clerk Signature

Jacqueline Beaudry

Date

Print Name

Subscribed and sworn before me, _____ this _____ day of _____, 20____, a Notary Public in and for Washtenaw County, Michigan.

Signature

My Commission expires: _____

Part V

Reason for Request







The Ann Arbor Township parcel(s) proposed to be annexed into the City of Ann Arbor are surrounded by land within City of Ann Arbor jurisdiction. The primary reason the City of Ann Arbor is initiating annexation of Ann Arbor Township parcels is to reduce the duplication of municipal services. Currently, both the City and Township provide Police and Fire services within these boundaries. Annexing the properties will reduce duplication of service and increase the emergency response efficiency. Additionally, annexing the properties will allow the City to more effectively plan and implement infrastructure improvements. In 1994, the City of Ann Arbor and the Charter Township of Ann Arbor entered into an annexation agreement that indicated that after December 31, 2007, the Township would no longer contest City initiated annexations in an agreed upon service area. This annexation application is consistent with the 1994 agreement. The proposed annexations meets the conditions pursuant to Section 9 of The Home Rule City Act, 1909 PA 279. This proposed annexation includes fewer than 100 persons. The City of Ann Arbor initiated annexation of this property by City Council resolution on June 15, 2015. The necessary conditions as identified by the State Boundary Commission have been met.

Part VI



<Not required>

PART VII 1101 Huron River Dr. (I-09-17-250-007)

Legend

-  City of Ann Arbor
Municipal Service Boundary
-  Parcel proposed for annexation
-  Highway
-  State Route
-  Major Roads
-  Minor Roads
-  Parcel Lines

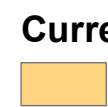
Current Jusidiction

-  City of Ann Arbor
-  Ann Arbor Twp.
-  Location of Parcel Proposed for Annexation

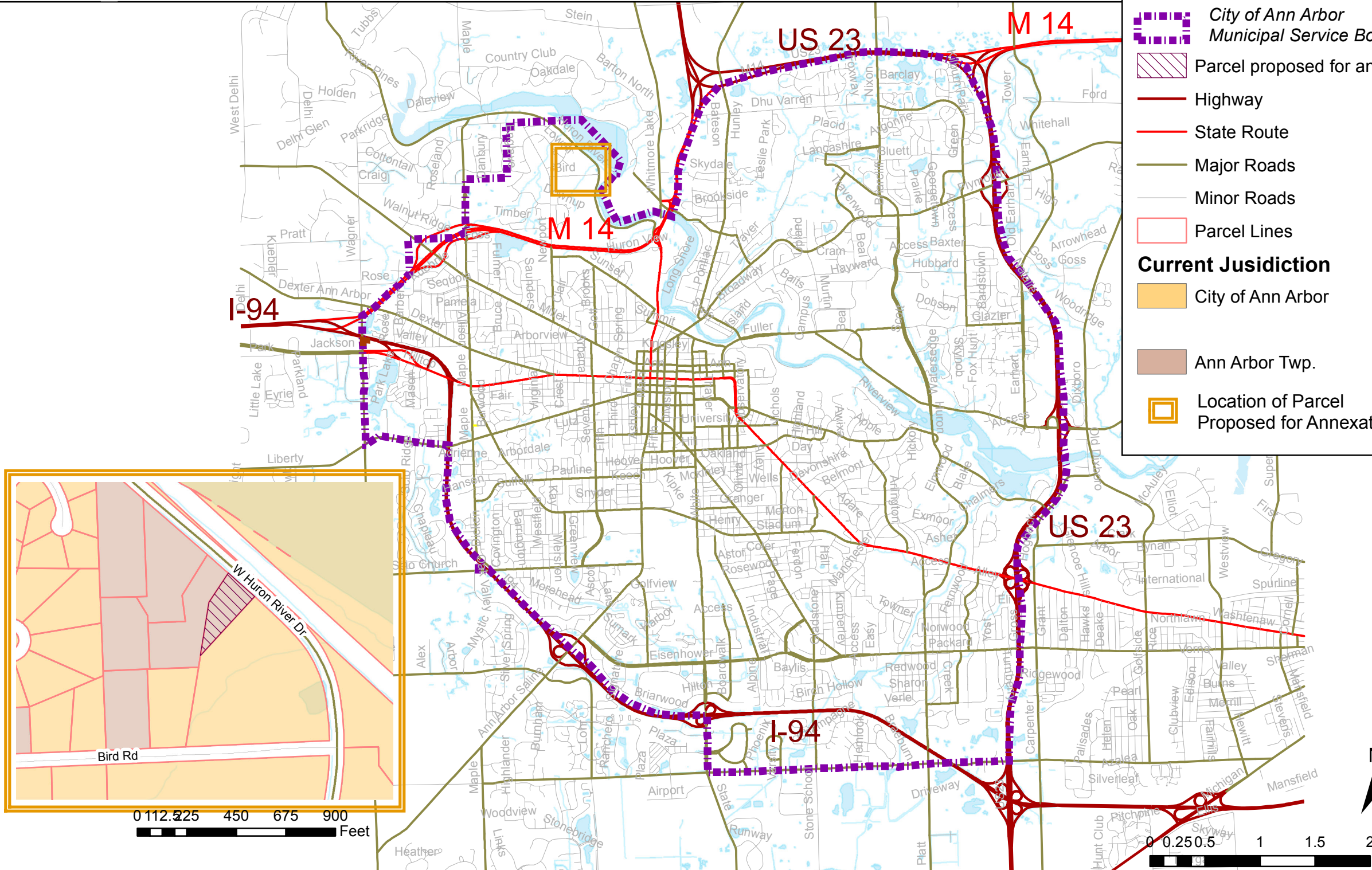

0 112.5 225 450 675 900 Feet

0 0.250.5 1 1.5 2 Miles