

1 WALL SECTION
1/4" = 1'-0" NOT TO SCALE

N1-2008-504-SE03-003

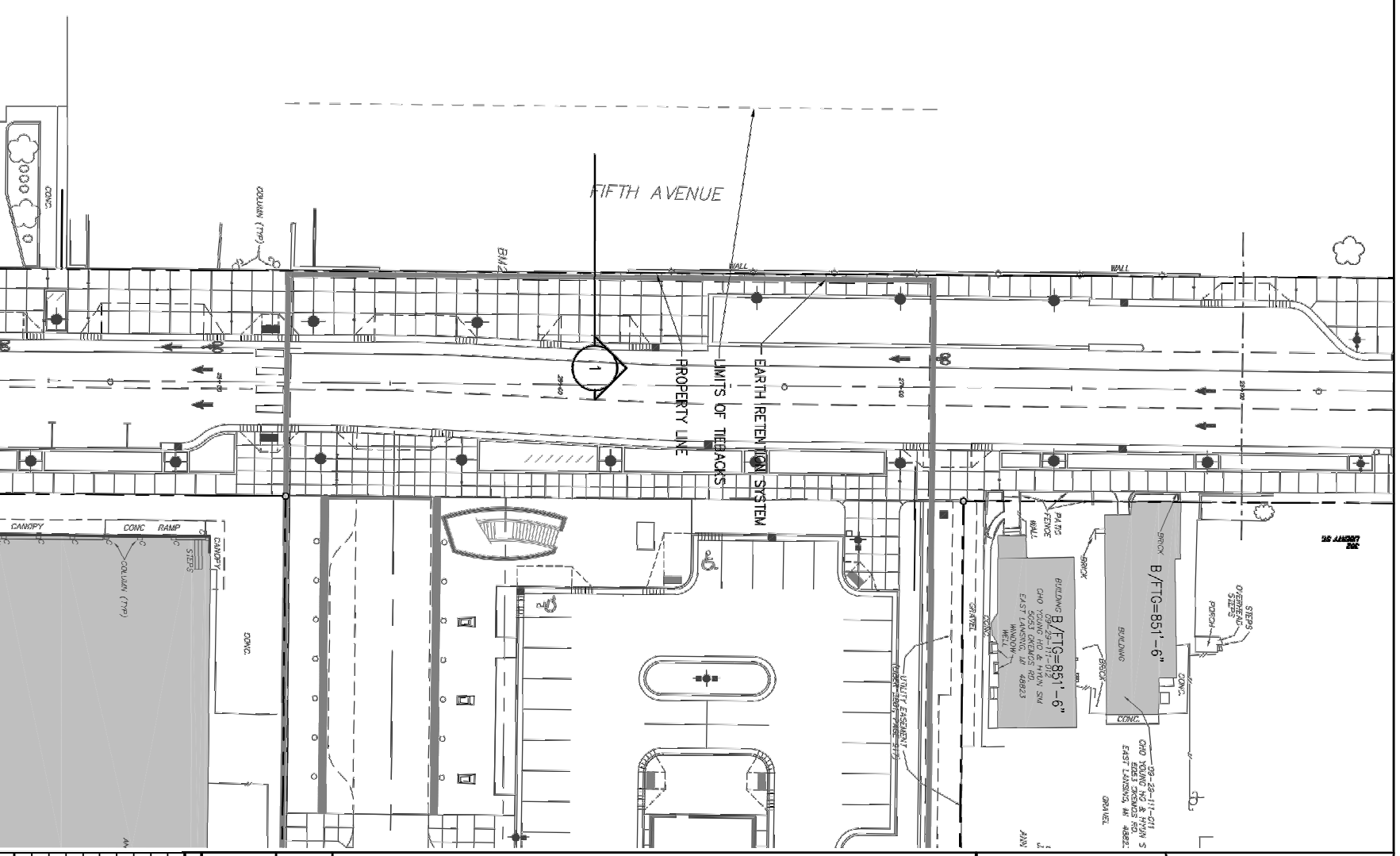

PARTIAL SITE PLAN
1/4" = 1'-0" NOT TO SCALE

Carl Walker, Inc.
6198 Lower Lane
Sula 200
Kalamazoo, Michigan 49002
Phone (269) 381-2222
Fax (269) 344-0782
www.carlwalker.com

ANN ARBOR
DOWNTOWN DEVELOPMENT
AUTHORITY

TEMPORARY EARTH
RETENTION SYSTEM
DRAWING
200 E. LIBERTY ST.

The Drawings are the property of Carl Walker, Inc. and are not to be reused or reproduced without written permission from Carl Walker, Inc.

PROJECT NO.
DESIGNER BY
DRAWN BY

1 2-17-10 ORIGINAL ISSUE

REV.	DATE	DESCRIPTION
1	2-17-10	ORIGINAL ISSUE

EARTH RETENTION
SYSTEM PROFILE

PROJECT NO.
N1-2008-504
DRAWING NO.

Exhibit A-1