

# Liberty Pediatrics

Beth Barclay, MD  
Andy Seiler, MD  
Lauren Gold, MD  
Tansey Rosset, RN, FNP-BC  
Chelsea Valdes-Pierce, RN, FNP-BC  
Kyla Boyse, RN, CPNP-PC

February 10, 2016

RE: Cameryn Waugh  
DOB: 1-28-2007

To the parent of Cameryn Waugh (to share with appropriate personnel City of Ann Arbor)

Cameryn is a patient at Liberty Pediatrics. She has significant allergies to Walnuts and Tree Nuts, both of which can cause anaphylactic allergic reactions. Anaphylaxis can be life-threatening. Mom has reported to our office, that the family home has a walnut tree growing in its backyard. Due to Cameryn's allergy issues, the Walnut tree poses a health hazard to Cameryn. It is important that the Walnut tree be removed from the Waugh backyard to help mitigate the risk of anaphylaxis with Cameryn.

Thank you for your attention to this matter. Feel free to contact our office at 734-994-5858 with any questions or concerns you may have regarding this issue.

Regards,

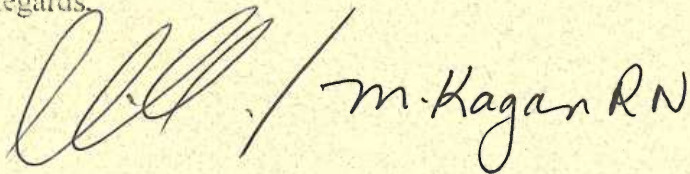
A handwritten signature in black ink, appearing to read "M. Kagan RN". The signature is written in a cursive style with a large, stylized initial "M" and "K".

Dr. Andrew Seiler/M. Kagan RN  
Liberty Pediatrics

---

## Current Situation

- A mature walnut tree can produce up to 5000 walnuts per year
- The drip line of the tree covers a majority of our back yard and our outdoor cooking and eating areas
- The squirrels take the walnuts back up into the tree and shell them, dropping particles of nutmeat and sharp pieces of the hard shell throughout the drip line of the tree

---

## Hazard

- Exposure to the hard shell and nut meat is a hazard due to a Black Walnut / Tree Nut allergy with history of anaphylaxis
- Exposure via a wound can provoke a faster and more severe reaction than via ingestion
- The relevant primary methods of exposure are
  - Exposure through a cut from the sharp pieces of the shell or an existing open wound.
  - Exposure by particles being transferred via hands or clothing
  - Exposure via particles dropping into food while cooking or eating outside

---

## Mitigation

- Removing the tree will reduce the allergen present in our yard dramatically by eliminating a source of thousands of walnuts directly on our property and also by removing the ability for the squirrels to shell the walnuts from the tree branches which spreads the allergens throughout the majority of our back yard.

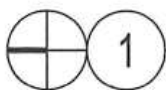
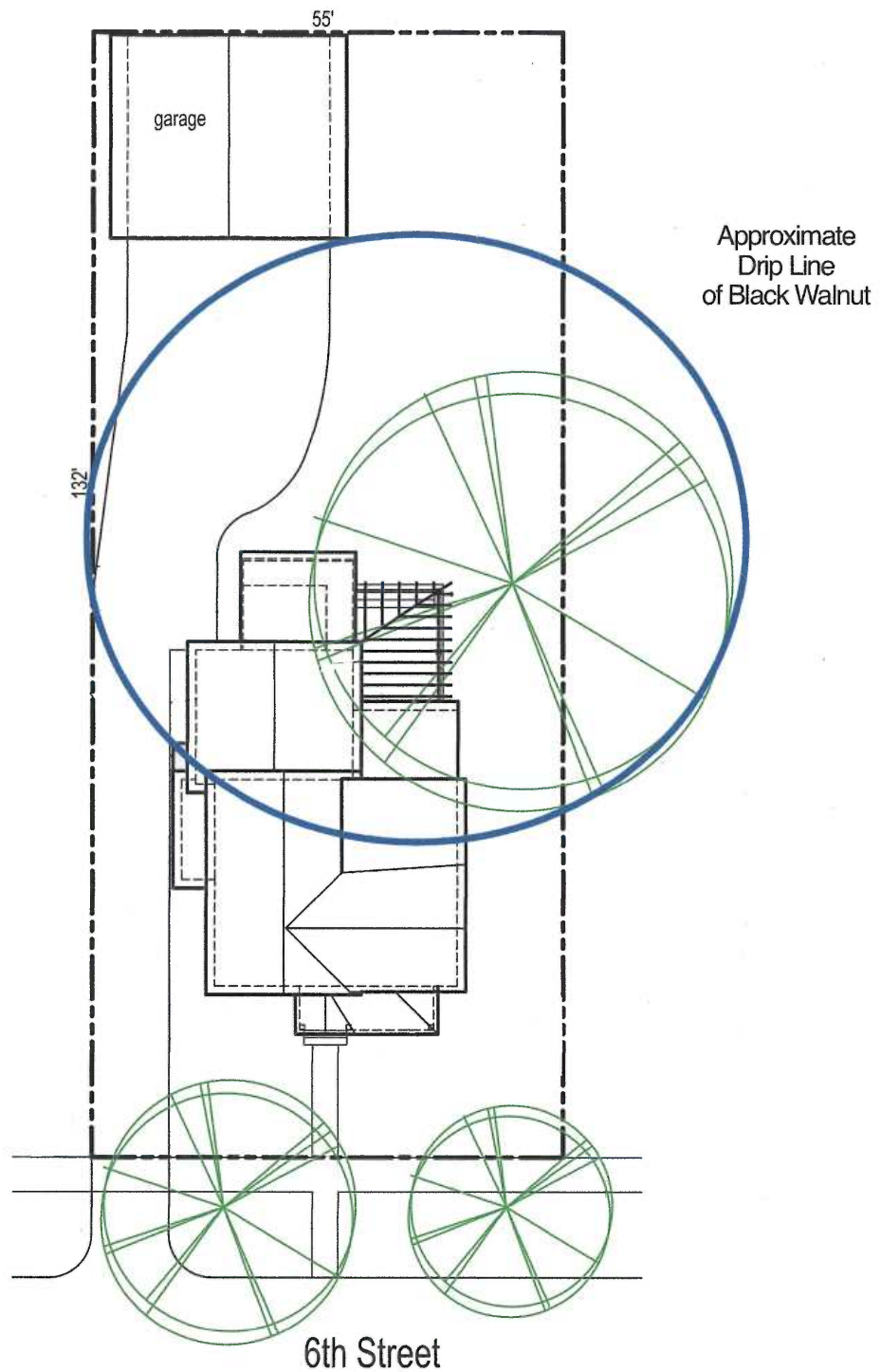

**SITE PLAN**

1" = 20'-0"

---

**Waugh Residence**

HDC application

529 6th Street, Ann Arbor MI 48103

---