

## ANNEXATION PETITION INSTRUCTIONS

### By City Council Resolution State Boundary Commission

Department of Licensing and Regulatory Affairs  
Authority: 1968 PA 191

**General instructions for preparation of an Annexation Petition by city council resolution, which consists of the following parts and forms:**

**Part I Map:** Shall be labeled and prepared pursuant to State Boundary Commission General Rule 37; **attach sheets labeled “PART I”** [R123.37].

**Part II Petition Certification:** Requests that the State Boundary Commission annex the area described in Part III description to the adjacent City; **attach sheets labeled “PART II”** [MCL 117.6; MCL 117.7 and MCL117.9(7)(a)].

**Part III Legal Description:** Shall be labeled and prepared pursuant to State Boundary Commission General Rule 37; **attach sheets labeled “PART III”** [R123.37].

**Part IV Resolution:** Attach a copy of the resolution passed by the City Council requesting the annexation of the property shown on the “Part I” map and described in the “Part III” description certified by the City Clerk [R123.37(10)].

**Part V Reason for Request:** Petitioner(s) reason(s) for the annexation request and statement indicating that the annexation meets the conditions pursuant to Section 9 of The Home Rule City Act, 1909 PA 279 [MCL117.9(7)(a)]; **attach sheets labeled “PART V”** [R123.37].

**Part VI:** This part is not required on this type of petition.

**Part VII Map:** Shall contain a map showing the relationship of the area proposed for annexation to the balance of the involved and adjacent units of government; **attach sheets; attach sheets labeled “PART VII”** [R123.37].

**Provide contact information** of petitioner and involved local units of government; **attach sheets** [R123.32(1)].

**The completed petition shall be filed with the State Boundary Commission. This may be done in person between the hours of 8:00 a.m. and 5:00 p.m., by mail or email to [bccolsr@michigan.gov](mailto:bccolsr@michigan.gov).**

#### **U.S. Postal Service:**

State Boundary Commission  
Office of Land Survey and Remonumentation  
Department of Licensing and Regulatory Affairs  
P.O. Box 30254  
Lansing, MI 48909

#### **Courier Other Than U.S. Postal Service**

State Boundary Commission  
Office of Land Survey and Remonumentation  
Department of Licensing and Regulatory Affairs  
611 West Ottawa  
Ottawa Building, 1<sup>st</sup> Floor  
Lansing, MI 48933

# PART I

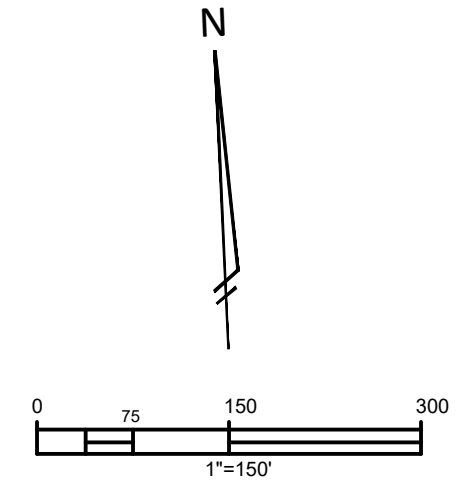

**PETITION #11**

LOTS 121 AND 123, THE EVERGREENS, AS RECORDED IN LIBER 7, PAGE 42, WASHTENAW COUNTY RECORDS, MICHIGAN.

THE ABOVE DESCRIPTION COMBINES THE FOLLOWING PARCELS  
 H-08-24-381-012 (VACANT LOT, LIBER 3656 PAGE 502)  
 H-08-24-381-013 (VACANT LOT, LIBER 3656 PAGE 502)

**PETITION #12**

H-08-24-380-007 (VACANT LOT, LIBER 2942 PAGE 147)

LOT 65, THE EVERGREENS, AS RECORDED IN LIBER 7, PAGE 42, WASHTENAW COUNTY RECORDS, MICHIGAN.  
 ALSO, THE EASTERLY 30' OF PARKWOOD DRIVE, BOUND BY THE EXTENSION OF THE SOUTH AND NORTH LINE OF LOT 65 TO THE CENTERLINE OF PARKWOOD DRIVE

PROJECT MANAGEMENT - PUBLIC SERVICES - CITY OF ANN ARBOR		
	<p>SCIO TOWNSHIP                      PETITION 11 AND 12</p>	DATE <b>18 APRIL, 2017</b>
		REVISED
	<p>301 EAST HURON STREET                      ANN ARBOR, MI 48107-8647                      734-794-6410                      www.a2gov.org</p>	DRAWN <b>MAS</b>
		SCALE <b>1" = 150'</b>
		SHEET No. <b>1 of 1</b>

## **PART II**

### **Petition Certification**

WE, the duly elected legislative body of the City of Ann Arbor, having passed a resolution requesting the annexation of territories as described in Part III within the township of Scio, in the County of Washtenaw, do hereby petition that the territories described in the Part III be annexed into the City of Ann Arbor and that this annexation be considered by the State Boundary Commission pursuant to the provisions of the 1909 PA 279 and 1968 PA 191.

### **PART III**

#### Legal Description

H-08-24-380-007 (VACANT LOT, LIBER 2942 PAGE 147)

LOT 65, THE EVERGREENS, AS RECORDED IN LIBER 7, PAGE 42,  
WASHTENAW COUNTY RECORDS, MICHIGAN.  
ALSO, THE EASTERLY 30' OF PARKWOOD DRIVE, BOUND BY THE  
EXTENSION OF THE SOUTH AND NORTH LINE OF LOT 65 TO THE  
CENTERLINE OF PARKWOOD DRIVE

## **PART IV**

### Resolution

## PART V

The township parcel(s) proposed to be annexed into the City of Ann Arbor are surrounded by land within City of Ann Arbor's ultimate jurisdiction. The City of Ann Arbor is initiating annexation of township parcels for a number of reasons: a) Increase efficiency of municipal services. Currently, emergency responders from both the City and Township provide services within the City's ultimate boundary (e.g. sometimes City police respond to service calls from township island properties). Additionally, the City provides solid waste services to City parcels while private haulers provide solid waste services to township parcels in the same neighborhood. Voting is also inefficient. Both the Township and the City provide voting precincts for neighborhoods that include township islands. Four building departments provide services to properties within the City's ultimate service area. b) Annexation will result in a more equitable provision of public services. Currently, township island residents receive a number of City services without paying for them such as road resurfacing and reconstruction, street lighting, stormwater management, and City parks; and c) Annexing the properties will allow the City to more effectively plan and implement infrastructure improvements. In 1979, The City of Ann Arbor entered into agreements with Scio Township and Pittsfield Township which defined the City's ultimate service area. In 1994, the City of Ann Arbor and the Ann Arbor Township entered into an annexation agreement that defined the City's ultimate boundary. The agreement indicated that after December 31, 2007, the Township would no longer contest City initiated annexations. This annexation application is consistent with these agreements. The proposed annexations meet the conditions pursuant to Section 9 of The Home Rule City Act, 1909 PA 279. This petition for annexation includes fewer than 100 persons.

The City of Ann Arbor initiated annexation of this property by City Council resolution on October 1, 2018. The necessary conditions as identified by the State Boundary Commission have been met.

## **PART VI**

This part is not required on this type of petition.

# PART VII

Vacant Kingwood St (H -08-24-380-007)



City of Ann Arbor  
Municipal Service Boundary



Parcel Proposed for Annexation

## Current Jurisdiction



City of Ann Arbor



Ann Arbor Twp.



Pittsfield Twp.



Scio Twp.

Highway

State Route

Major Roads

Minor Roads

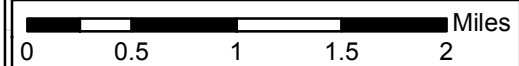
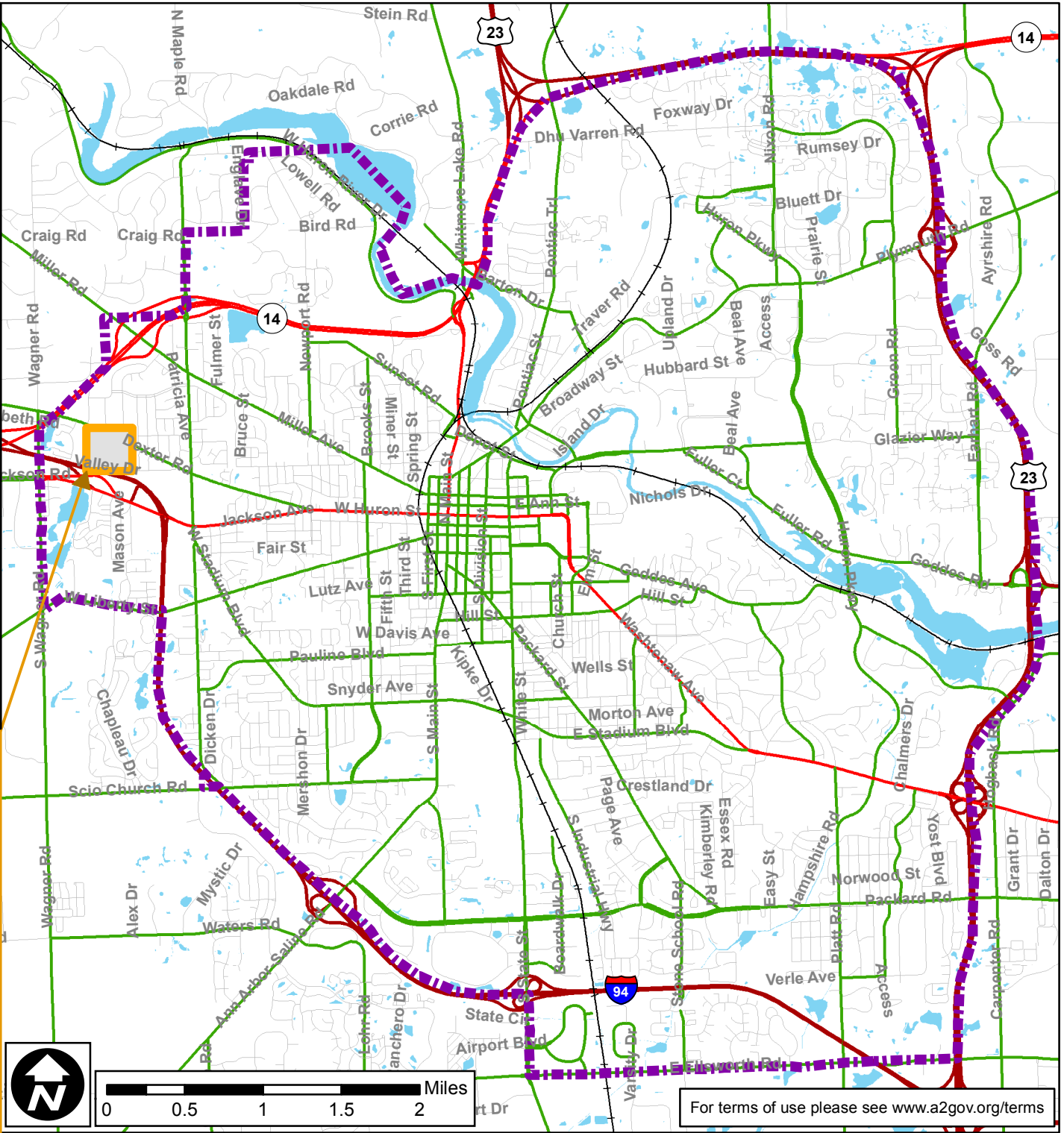
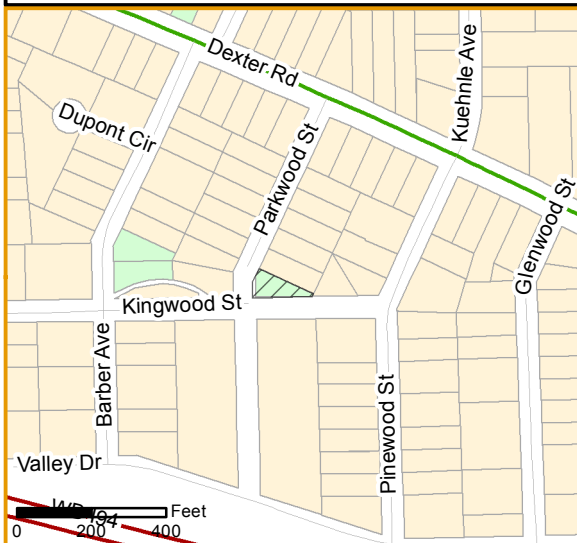

For terms of use please see [www.a2gov.org/terms](http://www.a2gov.org/terms)



## Contact Information

**Petitioner:** City of Ann Arbor  
301 E Huron St.  
Ann Arbor, MI 48017  
Phone: 734-794-6000 x42614  
Fax: 734-994-8296  
Email: [jkahan@a2gov.org](mailto:jkahan@a2gov.org)

**City:** City of Ann Arbor  
Clerk: Jacqueline Beaudry  
301 E Huron St.  
Ann Arbor, MI 48107  
Phone: 734-794-6140  
Email: [JBeaudry@a2gov.org](mailto:JBeaudry@a2gov.org) or  
[CityClerk@a2gov.org](mailto:CityClerk@a2gov.org)

**Township:** Scio Township  
Clerk: Nancy C. Hedberg  
827 N. Zeeb Road  
Ann Arbor, MI 48103  
Phone: 734-369-9400  
Email: [nhedberg@ScioTownship.org](mailto:nhedberg@ScioTownship.org)

**County:** Washtenaw County  
200 N. Main; P.O. Box 8645  
Ann Arbor, MI 48107  
Phone: 734-222-6700  
Fax: 734-222-6528