

ANNEXATION PETITION INSTRUCTIONS

By City Council Resolution State Boundary Commission

Department of Licensing and Regulatory Affairs
Authority: 1968 PA 191

General instructions for preparation of an Annexation Petition by city council resolution, which consists of the following parts and forms:

Part I Map: Shall be labeled and prepared pursuant to State Boundary Commission General Rule 37; **attach sheets labeled “PART I”** [R123.37].

Part II Petition Certification: Requests that the State Boundary Commission annex the area described in Part III description to the adjacent City; **attach sheets labeled “PART II”** [MCL 117.6; MCL 117.7 and MCL117.9(7)(a)].

Part III Legal Description: Shall be labeled and prepared pursuant to State Boundary Commission General Rule 37; **attach sheets labeled “PART III”** [R123.37].

Part IV Resolution: Attach a copy of the resolution passed by the City Council requesting the annexation of the property shown on the “Part I” map and described in the “Part III” description certified by the City Clerk [R123.37(10)].

Part V Reason for Request: Petitioner(s) reason(s) for the annexation request and statement indicating that the annexation meets the conditions pursuant to Section 9 of The Home Rule City Act, 1909 PA 279 [MCL117.9(7)(a)]; **attach sheets labeled “PART V”** [R123.37].

Part VI: This part is not required on this type of petition.

Part VII Map: Shall contain a map showing the relationship of the area proposed for annexation to the balance of the involved and adjacent units of government; **attach sheets; attach sheets labeled “PART VII”** [R123.37].

Provide contact information of petitioner and involved local units of government; **attach sheets** [R123.32(1)].

The completed petition shall be filed with the State Boundary Commission. This may be done in person between the hours of 8:00 a.m. and 5:00 p.m., by mail or email to bccolsr@michigan.gov.

U.S. Postal Service:

State Boundary Commission
Office of Land Survey and Remonumentation
Department of Licensing and Regulatory Affairs
P.O. Box 30254
Lansing, MI 48909

Courier Other Than U.S. Postal Service

State Boundary Commission
Office of Land Survey and Remonumentation
Department of Licensing and Regulatory Affairs
611 West Ottawa
Ottawa Building, 1st Floor
Lansing, MI 48933

PART I

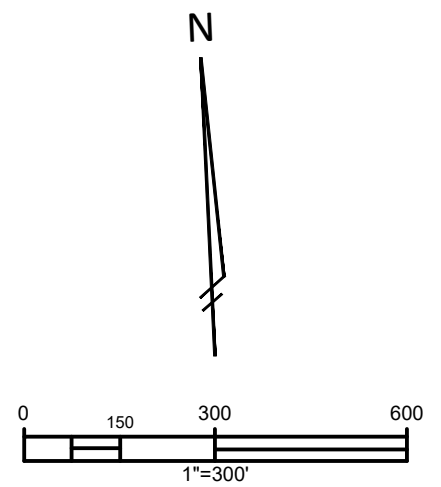
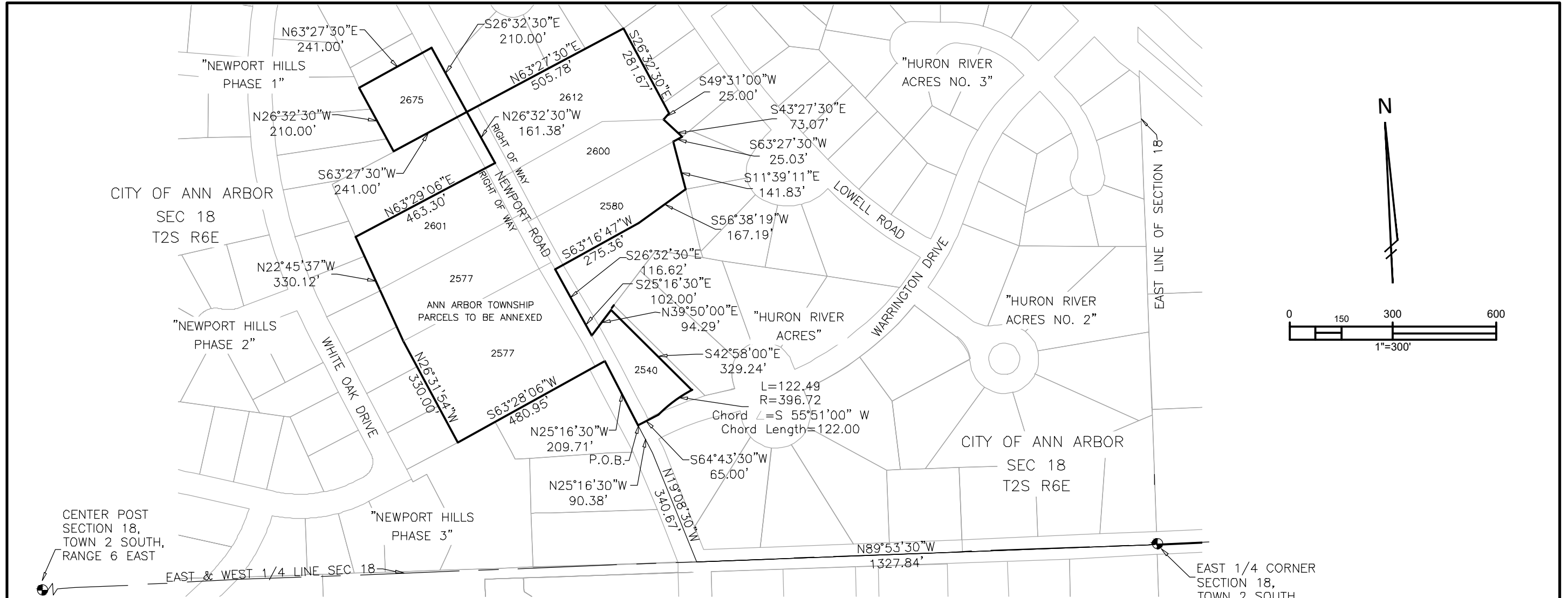

COMBINED DESCRIPTION: COMMENCING AT THE EAST 1/4 CORNER OF SECTION 18, T2S, R6E, ANN ARBOR TOWNSHIP, WASHTENAW COUNTY, MICHIGAN; THENCE N89°53'30" W 1327.84 FEET ALONG THE E-W 1/4 LINE OF SAID SECTION AND THE CENTERLINE OF BIRD ROAD; THENCE N 19°08'30" W 340.67 FEET ALONG THE CENTERLINE OF NEWPORT ROAD; THENCE N25°16'30" W 90.38 FEET FOR THE PLACE OF BEGINNING; THENCE N 25°16'30" W 209.71 FEET; THENCE S 63°28'06" W 480.95 FEET; THENCE N 26°31'54" W 330.00 FEET; THENCE N 22°45'37" W 330.12 FEET; THENCE N 63°29'06" E 463.30 FEET; THENCE N 26°32'30" W 161.38 FEET; THENCE S 63°27'30" W 241.00 FEET; THENCE N 26°32'30" W 210.00 FEET; THENCE N 63°27'30" E 241.00 FEET; THENCE S 26°32'30" E 210.00 FEET; THENCE N 63°27'30" E 505.78 FEET; THENCE S 26°32'30" E 281.67 FEET; THENCE S 49°31'00" W 25.00 FEET; THENCE S 43°27'30" E 73.07 FEET; THENCE S 63°27'30" W 25.03 FEET; THENCE S 11°39'11" E 141.83 FEET; THENCE S 56°38'19" W 167.19 FEET; THENCE S 63°16'47" W 275.36 FEET; THENCE S 26°32'30" E 116.62 FEET; THENCE S 25°16'30" E 102.00 FEET; THENCE N 39°50'00" E 94.29 FEET; THENCE S 42°58'00" E 329.24 FEET; THENCE 122.49 FEET IN THE ARC OF A CIRCULAR CURVE TO THE LEFT, RADIUS 396.72 FEET, CHORD S 55°51'00" W 122.00 FEET; THENCE S 64°43'30" W 65.00 FEET TO THE PLACE OF BEGINNING.

THE ABOVE DESCRIPTION COMBINES THE FOLLOWING PARCELS:

- I-09-18-150-006 (2601 NEWPORT ROAD TAX DESCRIPTION, NO DEED AVAILABLE)
- I-09-18-150-007 (2577 NEWPORT ROAD TAX DESCRIPTION, NO DEED AVAILABLE)
- I-09-18-150-008 (2577 NEWPORT ROAD TAX DESCRIPTION, NO DEED AVAILABLE)
- I-09-18-150-013 (2580 NEWPORT ROAD TAX DESCRIPTION, NO DEED AVAILABLE)
- I-09-18-150-024 (2600 NEWPORT ROAD LIBER 2575 PAGE 856)
- I-09-18-150-025 (2612 NEWPORT ROAD TAX DESCRIPTION, NO DEED AVAILABLE)
- I-09-18-150-015 (2540 NEWPORT PER DEED LIBER 4504 PAGE 865)
- I-09-18-150-004 (2675 NEWPORT ROAD TAX DESCRIPTION, NO DEED AVAILABLE)

PROJECT MANAGEMENT - PUBLIC SERVICES - CITY OF ANN ARBOR		
	ANN ARBOR TOWNSHIP PETITION 6 2612, 2600, 2580, 2601, 2577, 2675, 2540 NEWPORT ROAD	DATE 18 APRIL, 2017
		REVISED
		DRAWN MAS
		SCALE 1" = 300'
	SHEET No. 1 of 2	
	301 EAST HURON STREET ANN ARBOR, MI 48107-8647 734-794-6410 www.a2gov.org	

PART II

Petition Certification

WE, the duly elected legislative body of the City of Ann Arbor, having passed a resolution requesting the annexation of territories as described in Part III within the township of Ann Arbor Charter, in the County of Washtenaw, do hereby petition that the territories described in the Part III be annexed into the City of Ann Arbor and that this annexation be considered by the State Boundary Commission pursuant to the provisions of the 1909 PA 279 and 1968 PA 191.

PART III

Legal Description

COMBINED DESCRIPTION: COMMENCING AT THE EAST 1/4 CORNER OF SECTION 18, T2S, R6E, ANN ARBOR TOWNSHIP, WASHTENAW COUNTY, MICHIGAN; THENCE N89°53'30"W 1327.84 FEET ALONG THE E-W 1/4 LINE OF SAID SECTION AND THE CENTERLINE OF BIRD ROAD; THENCE N 19°08'30" W 340.67 FEET ALONG THE CENTERLINE OF NEWPORT ROAD; THENCE N25° 16'30"W 90.38 FEET FOR THE PLACE OF BEGINNING; THENCE N 25°16'30" W 209.71 FEET; THENCE S 63°28'06" W 480.95 FEET; THENCE N 26°31'54" W 330.00 FEET; THENCE N 22°45'37" W 330.12 FEET; THENCE N 63°29'06" E 463.30 FEET; THENCE N 26°32'30" W 161.38 FEET; THENCE S 63°27'30" W 241.00 FEET; THENCE N 26°32'30" W 210.00 FEET; THENCE N 63°27'30" E 241.00 FEET; THENCE S 26°32'30" E 210.00 FEET; THENCE N 63°27'30" E 505.78 FEET; THENCE S 26°32'30" E 281.67 FEET; THENCE S 49°31'00" W 25.00 FEET; THENCE S 43°27'30" E 73.07 FEET; THENCE S 63°27'30" W 25.03 FEET; THENCE S 11° 39'11" E 141.83 FEET; THENCE S 56°38'19" W 167.19 FEET; THENCE S 63°16'47" W 275.36 FEET; THENCE S 26°32'30" E 116.62 FEET; THENCE S 25°16'30" E 102.00 FEET; THENCE N 39°50'00" E 94.29 FEET; THENCE S 42°58'00" E 329.24 FEET; THENCE 122.49 FEET IN THE ARC OF A CIRCULAR CURVE TO THE LEFT, RADIUS 396.72 FEET, CHORD S 55°51'00" W 122.00 FEET; THENCE S 64°43'30" W 65.00 FEET TO THE PLACE OF BEGINNING.

THE ABOVE DESCRIPTION COMBINES THE FOLLOWING PARCELS:

I-09-18-150-006 (2601 NEWPORT ROAD TAX DESCRIPTION, NO DEED AVAILABLE)

I-09-18-150-007 (2577 NEWPORT ROAD TAX DESCRIPTION, NO DEED AVAILABLE)

I-09-18-150-008 (2577 NEWPORT ROAD TAX DESCRIPTION, NO DEED AVAILABLE)

I-09-18-150-013 (2580 NEWPORT ROAD TAX DESCRIPTION, NO DEED AVAILABLE)

I-09-18-150-024 (2600 NEWPORT ROAD LIBER 2575 PAGE 856)

I-09-18-150-025 (2612 NEWPORT ROAD TAX DESCRIPTION, NO DEED AVAILABLE)

I-09-18-150-015 (2540 NEWPORT PER DEED LIBER 4504 PAGE 865)

I-09-18-150-004 (2675 NEWPORT ROAD TAX DESCRIPTION, NO DEED AVAILABLE)

PART IV

Resolution

PART V

The township parcel(s) proposed to be annexed into the City of Ann Arbor are surrounded by land within City of Ann Arbor's ultimate jurisdiction. The City of Ann Arbor is initiating annexation of township parcels for a number of reasons: a) Increase efficiency of municipal services. Currently, emergency responders from both the City and Township provide services within the City's ultimate boundary (e.g. sometimes City police respond to service calls from township island properties). Additionally, the City provides solid waste services to City parcels while private haulers provide solid waste services to township parcels in the same neighborhood. Voting is also inefficient. Both the Township and the City provide voting precincts for neighborhoods that include township islands. Four building departments provide services to properties within the City's ultimate service area. b) Annexation will result in a more equitable provision of public services. Currently, township island residents receive a number of City services without paying for them such as road resurfacing and reconstruction, street lighting, stormwater management, and City parks; and c) Annexing the properties will allow the City to more effectively plan and implement infrastructure improvements. In 1979, The City of Ann Arbor entered into agreements with Scio Township and Pittsfield Township which defined the City's ultimate service area. In 1994, the City of Ann Arbor and the Ann Arbor Township entered into an annexation agreement that defined the City's ultimate boundary. The agreement indicated that after December 31, 2007, the Township would no longer contest City initiated annexations. This annexation application is consistent with these agreements. The proposed annexations meet the conditions pursuant to Section 9 of The Home Rule City Act, 1909 PA 279. This petition for annexation includes fewer than 100 persons.











The City of Ann Arbor initiated annexation of this property by City Council resolution on October 1, 2018. The necessary conditions as identified by the State Boundary Commission have been met.

PART VI

This part is not required on this type of petition.

PART VII

- 2675 Newport Rd (I -09-18-150-004)
- 2577 Newport Rd (I -09-18-150-007)
- 2577 Newport Rd (I -09-18-150-008)
- 2601 Newport Rd (I -09-18-150-006)
- 2612 Newport Rd (I -09-18-150-025)
- 2580 Newport Rd (I -09-18-150-013)
- 2600 Newport Rd (I -09-18-150-024)
- 2540 Newport Rd (I -09-18-150-015)

-  City of Ann Arbor Municipal Service Boundary
-  Parcel Proposed for Annexation
-  Highway
-  State Route
-  Major Roads
-  Minor Roads
- Current Jurisdiction**
-  City of Ann Arbor
-  Ann Arbor Twp.
-  Pittsfield Twp.
-  Scio Twp.

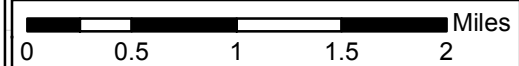
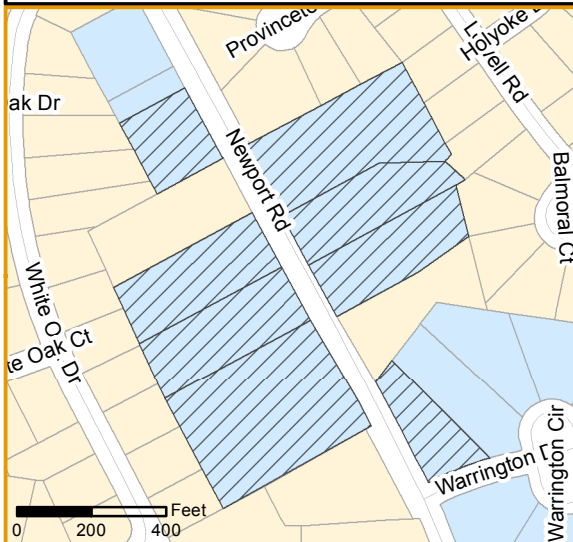
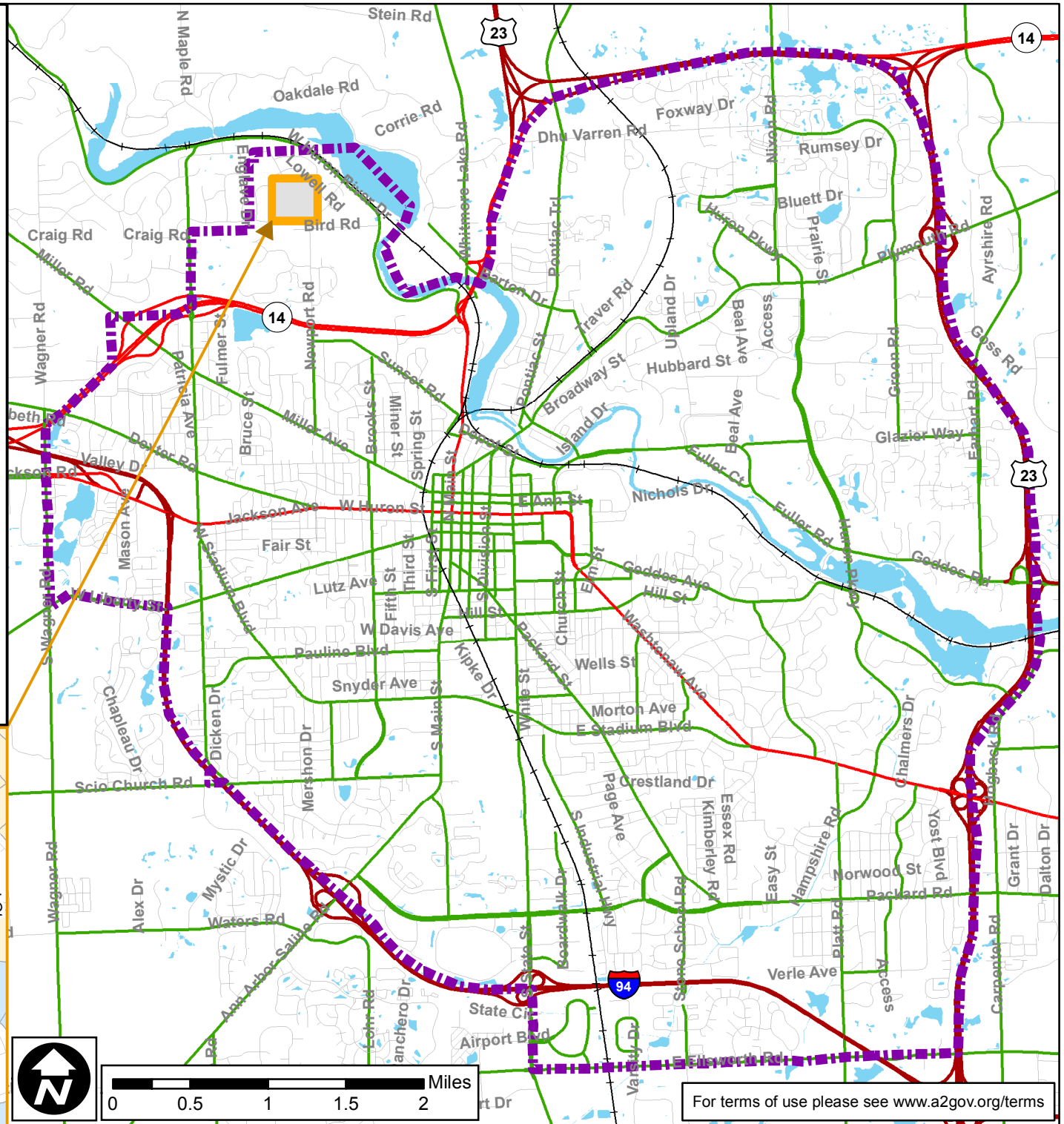

For terms of use please see www.a2gov.org/terms

Contact Information

Petitioner: City of Ann Arbor
301 E Huron St.
Ann Arbor, MI 48017
Phone: 734-794-6000 x42614
Fax: 734-994-8296
Email: JKahan@a2gov.org

City: City of Ann Arbor
Clerk: Jacqeline Beaudry
301 E Huron St.
Ann Arbor, MI 48107
Phone: 734-794-6140
Email: JBeaudry@a2gov.org or
CityClerk@a2gov.org

Township: Ann Arbor Charter Township
Clerk: Rena Basch
3792 Pontiac Trail
Ann Arbor, MI 48105
Phone: 734-663-3418 x108
Fax: 734-663-6678
Email: basch@aatwp.org

County: Washtenaw County
200 N. Main; P.O. Box 8645
Ann Arbor, MI 48107
Phone: 734-222-6700
Fax: 734-222-6528