

LANNING AND DEVELOPMENT SERVICES STAFF REPORT

For Planning Commission Meeting of April 16, 2013

**SUBJECT: Weller Annexation and Zoning (2119 Victoria Circle)
Project Nos. A13-001 and Z13-001**

PROPOSED CITY PLANNING COMMISSION MOTION

The Ann Arbor City Planning Commission hereby recommends that the Mayor and City Council approve the Weller Annexation and R1A (Single-Family Dwelling District) Zoning.

STAFF RECOMMENDATION

Staff recommends this petition be **approved** because the property is within the City's water and sewer service area and the proposed R1A zoning is consistent with the adjacent zoning, surrounding land uses and the Master Plan Future Land Use Element.

LOCATION

This site is located on the west side of Victoria Circle between Springwood Court and Alexandra Boulevard (West Area). This site is in the Huron River Watershed.

DESCRIPTION OF PETITION

The petitioner requests annexation of a 21,888-square foot site from Ann Arbor Township and zoning to R1A Single Family Dwelling district. The site is currently vacant.

COMPARISON CHART

	EXISTING	PROPOSED	REQUIRED/PERMITTED
Zoning	TWP (Township District)	R1A	R1A
Gross Lot Area	21,888 SF	21,888 SF	20,000 sq ft MIN
Lot Width	148 ft	148 ft	90 ft MIN

SURROUNDING LAND USES AND ZONING

	LAND USE	ZONING
NORTH	Single-Family Dwelling	TWP, R1A Single-Family Dwelling District
EAST	Single-Family Dwelling	TWP, R1A
SOUTH	Single-Family Dwelling	TWP, R1A
WEST	Single-Family Dwelling	PUD (Riverwood PUD)

HISTORY AND PLANNING BACKGROUND

Of the eight parcels on Victoria Circle, six are township islands. The other two have already been annexed into the city and zoned R1A. The proposed zoning meets the Land Use Element of the City Master Plan, which calls for single- and two-family residential.

The petitioner requested that he be allowed to start construction before the annexation and zoning are finalized. The City's Chief Development Official is currently waiting for a letter from the Director of Building Services for Ann Arbor Charter Township relinquishing authority to the City to enforce the City's zoning requirements and review and inspect a proposed dwelling on the parcel. At that time, building permit and grading applications (which have already been submitted to the city) will be reviewed.

COMMENTS PENDING, DISMISSED OR UNRESOLVED

Public Services (Systems Planning Unit and Project Management Unit) – Comments pending.

Prepared by Jill Thacher
Reviewed by Wendy Rampson, Planning Manager

Attachments: Zoning/Parcel Maps
Aerial Photo

c: Owner: Derek & Anna Weller
2524 Country Village Court
Ann Arbor, MI

Petitioner: Christopher John Robert Laycock, LLC
350 Nichols Drive
Saline, MI 48176

City Assessor
Systems Planning
Project Nos. A13-001 and Z13-001

2119 Victoria Cir -Zoning Map-

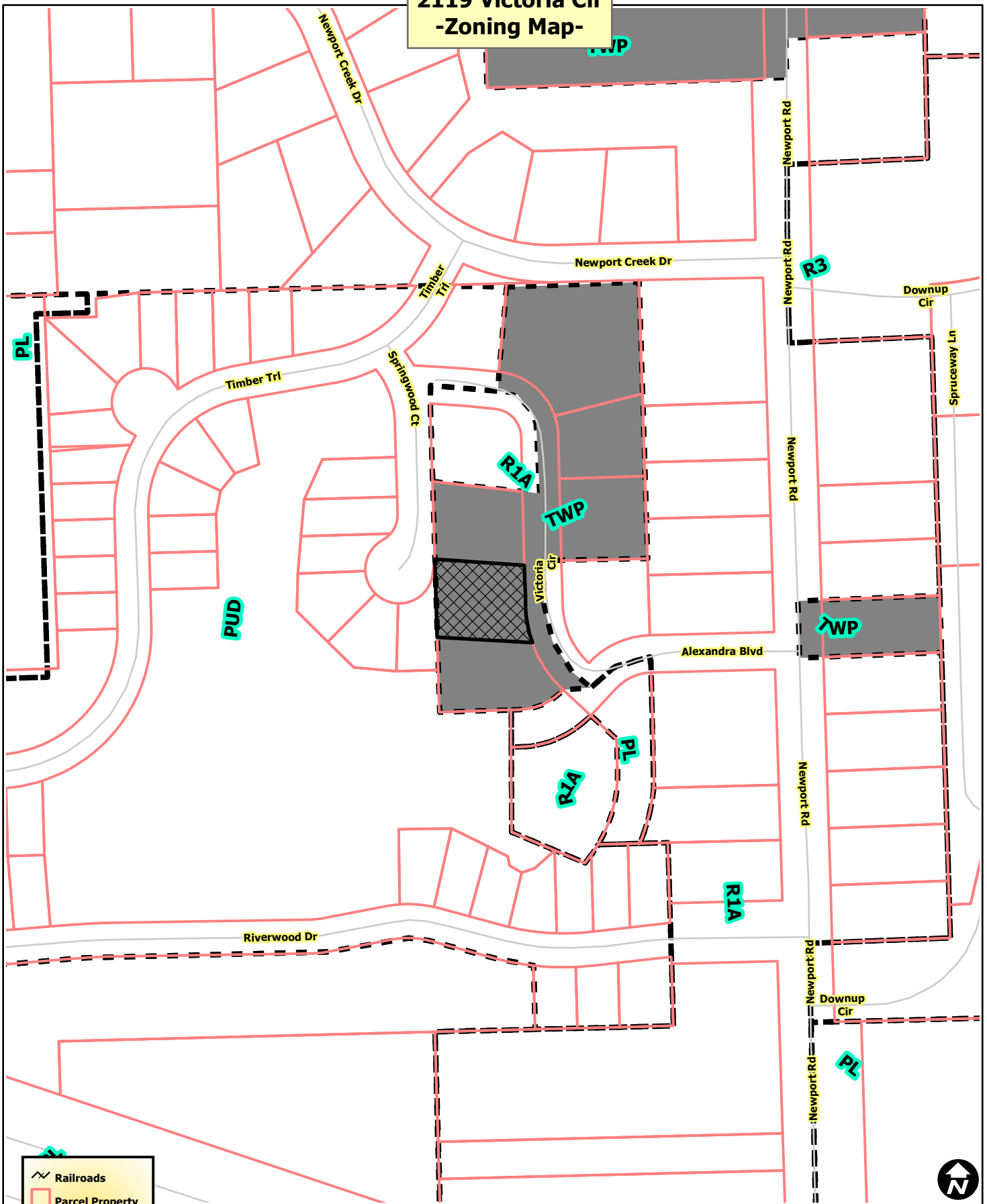

Legend



- Railroads
- Parcel Property
- Zoning**
- Township Island
- Zoning



City of Ann Arbor Map Disclaimer:
 No part of this product shall be reproduced or transmitted in any form or by any means, electronic or mechanical, for any purpose, without prior written permission from the City of Ann Arbor.
 This map complies with National Map Accuracy Standards for mapping at 1 Inch = 100 Feet. The City of Ann Arbor and its mapping contractors assume no legal representation for the content and/or inappropriate use of information on this map.
 Map Created: 3/27/2013

2119 Victoria Cir -Aerial Map-



 Railroads
 Parcel Property



City of Ann Arbor Map Disclaimer:

No part of this product shall be reproduced or transmitted in any form or by any means, electronic or mechanical, for any purpose, without prior written permission from the City of Ann Arbor.

This map complies with National Map Accuracy Standards for mapping at 1 Inch = 100 Feet. The City of Ann Arbor and its mapping contractors assume no legal representation for the content and/or inappropriate use of information on this map.

Map Created: 3/27/2013