

**PART II**

WE, the duly elected legislative body of the City of Ann Arbor,  
having passed a resolution requesting the annexation of territories as described in Part III within  
the township(s) of Ann Arbor Charter, in the County(ies) of  
Washtenaw, do hereby petition that the territories described in  
Part III be annexed to the City of Ann Arbor and that this  
annexation be considered by the State Boundary Commission pursuant to the provisions of 1909  
PA 279 and 1968 PA 191.

Dept. of Licensing & Regulatory Affairs  
**FILED**

NOV 07 2014 '14 AR 08

STATE BOUNDARY COMMISSION

**PART IIa**

It is the responsibility of the petitioner(s) to furnish the State Boundary Commission with the following contact information in order for the government units to receive notice of docket material, meetings, and public hearings. The importance of accurate and current information cannot be overemphasized. Processing of a petition may be delayed if inaccuracies cause improper notice.

If the petition should involve more than one county, city, village, and/or township, place the designated government contact information on a separate sheet(s) and attach it to this form.

Petitioner: City of Ann Arbor	
Address: 301 E. Huron St.	
City, State, Zip: Ann Arbor, MI 48107	
Telephone: 734 794-6265 x42614	Fax: 734 994-8296
E-Mail: JKahan@a2gov.org	

City: City of Ann Arbor	Clerk: Jacqueline Beaudry
Address: 301 E. Huron St.	
City, State, Zip: Ann Arbor, MI 48107	
Telephone: 734 794-6140	Telephone: 734 994-8296
E-Mail: CityClerk@a2gov.org or JBeaudry@a2gov.org	

Village: N/A	Clerk:
Address:	
City, State, Zip:	
Telephone:	Telephone:
E-Mail:	

Township: Ann Arbor Charter Township	Clerk: Rena Basch
Address: 3792 Pontiac Trail	
City, State, Zip: Ann Arbor, MI 48105	
Telephone: 734 663-3418 x108	Telephone: 734 663-6678
E-Mail: basch@aatwp.org	

County: Washtenaw County	Clerk: Lawrence Kestenbaum
Address: 200 N. Main; P.O. Box 8645	
City, State, Zip: Ann Arbor, MI 48107	
Telephone: 734 222-6700	Telephone: 734 222-6528
E-Mail:	

Dept. of Licensing & Regulatory Affairs  
**FILED**

NOV 07 2014 '14 AR 08

**Part III**  
Legal Description

I-09-30-250-005 (2200 DEXTER AVENUE)  
I-09-30-250-006 (2106 DEXTER AVENUE)  
I-09-30-250-007 (VACANT DEXTER AVENUE)

COMBINED LEGAL DESCRIPTION

COMMENCING AT THE NORTH  $\frac{1}{4}$  CORNER OF SECTION 30, TOWN 2 SOUTH, RANGE 6 EAST, TOWNSHIP OF ANN ARBOR, WASHTENAW COUNTY, MICHIGAN, AND PROCEEDING THENCE ALONG THE NORTH LINE OF SAID SECTION 30, NORTH 89°36'50" WEST 1102.80 FEET; THENCE SOUTH 00°42'10" WEST 346.24 FEET, TO THE POINT OF BEGINNING; THENCE SOUTH 87°47'41" EAST 178.78 FEET; THENCE SOUTH 00°36'38" WEST 160.89 FEET; THENCE SOUTH 72°18'06" EAST 47.05 FEET; THENCE SOUTH 00°26'51" WEST 295.89 FEET, TO THE NORTH LINE OF DEXTER AVENUE (66 FEET WIDE); THENCE NORTH 72°29'03" WEST 234.91 FEET; THENCE NORTH 00°42'10" EAST 407.26 FEET, TO THE POINT OF BEGINNING. CONTAINING 2.1± ACRES.

Dept. of Licensing & Regulatory Affairs  
**FILED**

NOV 07 2014 '14 AR 08

STATE BOUNDARY COMMISSION

**Part IV**

Dept. of Licensing & Regulatory Affairs  
**FILED**

NOV 07 2014 '14 AR 08

STATE BOUNDARY COMMISSION



# City of Ann Arbor

301 E. Huron St.  
Ann Arbor, MI 48104  
<http://a2gov.legistar.com/Calendar.aspx>

## Certified Copy

Resolution/Public Hearing: R-14-363

File Number: 14-1078

Enactment Number: R-14-363

Resolution to Petition the State of Michigan Boundary Commission to Annex Various Parcels from the Charter Township of Ann Arbor

Whereas, Currently there are properties in the Charter Township of Ann Arbor, Washtenaw County, that exist as township islands surrounded by lands within the jurisdictional boundaries of the City of Ann Arbor;

Whereas, Annexation of these township islands is necessary to eliminate confusion regarding jurisdiction for law enforcement, fire and other services and to improve the efficiency of services to these properties and the City of Ann Arbor desires to proceed with annexation for those reasons;

Whereas, The Charter Township of Ann Arbor, by agreement with the City of Ann Arbor dated February 1, 1994, as amended on October 22, 2004, has previously agreed that these township islands are part of the territories within and/or on touching the boundaries of the City of Ann Arbor that should be annexed and become a part of the City of Ann Arbor; and

Whereas, The boundaries of the territories to be annexed are described as follows:

I-09-30-250-004 (2020 DEXTER AVE)

COMMENCING AT THE NORTH 1/4 CORNER OF SECTION 30, TOWN 2 SOUTH, RANGE 6 EAST, TOWNSHIP OF ANN ARBOR, WASHTENAW COUNTY, MICHIGAN, AND PROCEEDING THENCE NORTH 89°36'50" WEST 584.70 FEET ALONG THE NORTH LINE OF SAID SECTION 30; THENCE SOUTH 00°21'20" EAST 709.97 FEET; THENCE NORTH 72°32'30" WEST 109.32 FEET TO THE POINT OF BEGINNING; THENCE SOUTH 00°23'30" WEST 207.1 FEET; THENCE ALONG THE NORTHERLY RIGHT OF WAY LINE OF DEXTER AVE. NORTH 72°32'30" WEST 105.62 FEET; THENCE NORTH 00°27'30" EAST 267.34 FEET; THENCE SOUTH 89°29'20" EAST 100.33 FEET; THENCE SOUTH 00°23'30" WEST 91.46 FEET TO THE POINT OF BEGINNING, BEING PART OF THE NORTHWEST 1/4 OF SAID SECTION 30, CONTAINS 0.57 OF AN ACRE, SUBJECT TO EASEMENTS AND RIGHTS OF WAY OF RECORD.

I-09-30-250-006 (2106 DEXTER AVENUE)

I-09-30-250-005 (2200 DEXTER AVENUE)

I-09-30-250-007 (VACANT DEXTER AVENUE)

COMBINED LEGAL DESCRIPTION

Dept. of Licensing & Regulatory Affairs  
**FILED**

NOV 07 2014 '14 AR 08

STATE BOUNDARY COMMISSION

COMMENCING AT THE NORTH ¼ CORNER OF SECTION 30, TOWN 2 SOUTH, RANGE 6 EAST, TOWNSHIP OF ANN ARBOR, WASHTENAW COUNTY, MICHIGAN, AND PROCEEDING THENCE ALONG THE NORTH LINE OF SAID SECTION 30, NORTH 89°36'50" WEST 1102.80 FEET; THENCE SOUTH 00°42'10" WEST 346.24 FEET, TO THE POINT OF BEGINNING; THENCE SOUTH 87°47'41" EAST 178.78 FEET; THENCE SOUTH 00°36'38" WEST 160.89 FEET; THENCE SOUTH 72°18'06" EAST 47.05 FEET; THENCE SOUTH 00°26'51" WEST 295.89 FEET, TO THE NORTH LINE OF DEXTER AVENUE (66 FEET WIDE); THENCE NORTH 72°29'03" WEST 234.91 FEET; THENCE NORTH 00°42'10" EAST 407.26 FEET, TO THE POINT OF BEGINNING. CONTAINING 2.1± ACRES.

#### 2099 THALER

LOT 88, "BOULEVARD MANOR" AS RECORDED IN LIBER 8 OF PLATS, PAGE 22, OF THE WASHTENAW COUNTY RECORDS, AND THE A PORTION OF VACATED CAROLINA AVENUE BOUNDED BY THE SOUTHERLY AND NORTHERLY LINES OF SAID LOT 88 EXTENDED TO THE EASTERLY RIGHT OF WAY LINE OF CAROLINA AVENUE. ALSO DESCRIBED AS COMMENCING AT THE SOUTHEAST CORNER OF SAID PLAT; THENCE ALONG THE EAST LINE OF SAID PLAT N04°49'W 254.32 FEET TO THE POINT OF BEGINNING; THENCE S76°25'27"W 162.47 FEET; THENCE N09°09'41"W 49.87 FEET; THENCE N76°33'38"E 166.02 FEET; THENCE S04°49'E 49.88 FEET TO THE POINT OF BEGINNING, BEING A PART OF THE SOUTHWEST QUARTER OF SECTION 30, ANN ARBOR TOWNSHIP, WASHTENAW COUNTY, MICHIGAN AND CONTAINS 0.19 OF AN ACRE OF LAND, SUBJECT TO EASEMENTS AND RIGHTS OF WAY OF RECORD.

#### US-23, EAST OF EARHART ROAD (PARCEL I-09-23-180-004)

A PARCEL OF LAND IN PART OF THE NORTHEAST QUARTER OF SECTION 23, TOWNSHIP 2 SOUTH, RANGE 6 EAST, CITY OF ANN ARBOR, MICHIGAN, DESCRIBED AS: COMMENCING AT THE EAST QUARTER POST OF SAID SECTION; THENCE ALONG THE EAST AND WEST QUARTER LINE OF SAID SECTION S89°31'W 674.21 TO THE POINT OF BEGINNING; THENCE N00°09'20"W 129.84 FEET; THENCE SOUTHEASTERLY ALONG THE SOUTHWESTERLY RIGHT OF WAY OF US-23 156 +/- FEET; THENCE ALONG THE EAST AND WEST QUARTER LINE OF SAID SECTION N89°31'00"W 84 +/- FEET TO THE POINT OF BEGINNING, CONTAINS 0.13 OF AN ACRE, SUBJECT TO EASEMENTS AND RIGHTS OF WAY OF RECORD.

#### 2997 FULLER ROAD

COMMENCING AT THE WEST ¼ POST OF SECTION 26; THENCE N1°05'W 52.45 FEET IN THE WEST LINE OF SECTION 26; THENCE S33°48'W 669.26 FEET; THENCE S56°53'E 584.20 FEET IN CENTER OF ROAD FOR PLACE OF BEGINNING; THENCE S56°53'E 184.92 FEET; THENCE S23°31'30"W 177.35 FEET; THENCE N54°22'30"W 208.03 FEET; THENCE N30°50'E 165.92 FEET TO POINT OF BEGINNING; BEING PART OF THE SOUTHEAST ¼ OF SECTION 27,

& SOUTHWEST ¼ OF SECTION 26, TOWNSHIP 2 SOUTH, RANGE 6 EAST; CONTAINS 0.77 ACRES OF LAND.

2001 DHU VARREN ROAD

BEGINNING AT THE SOUTH EAST CORNER OF SECTION 9; THENCE WEST 561.78 FEET IN SOUTH LINE OF SECTION; THENCE N38°48'20"W 857.95 FEET; THENCE S89°40'30"E 1126.28 FEET; THENCE S2°20'40"W 662.49 FEET IN EAST LINE OF SECTION TO PLACE OF BEGINNING; BEING SITUATED IN SOUTHEAST ¼ OF SECTION 9, TOWNSHIP 2 SOUTH, RANGE 6 EAST; CONTAINS 12.84 ACRES OF LAND.

1101 W. HURON RIVER DRIVE

COMMENCING AT WEST ¼ POST OF SECTION 17; THENCE EASTERLY 353.49 FEET IN EAST AND WEST ¼ LINE; THENCE DEFLECTING 78°35'30" LEFT 471.86 FEET FOR PLACE OF BEGINNING; THEN CONTINUE IN SAME LINE 226.70 FEET; THEN DEFLECTING 20°30' TO THE RIGHT 174.65 FEET; THENCE DEFLECT 77°41' RIGHT 160.0 FEET IN THE SOUTHWESTERLY LINE OF HURON RIVER DRIVE; THEN DEFLECTING 90° RIGHT 361.25 FEET TO PLACE OF BEGINNING; BEING IN THE NORTHWEST ¼ OF SECTION 17, TOWNSHIP 2 SOUTH, RANGE 6 EAST; CONTAINS 0.70 OF AN ACRE OF LAND.

561 S. MAPLE ROAD

COMMENCING AT THE EAST 1/4 CORNER OF SECTION 25, TOWNSHIP 2 SOUTH, RANGE 5 EAST, THENCE S00°07'30"E 936.94 FEET ALONG THE WEST LINE OF SECTION 30, TOWNSHIP 2 SOUTH, RANGE 6 EAST FOR A PLACE OF BEGINNING; THENCE N89°58'30"E 299.7; THENCE S00°07'30"E 110.00 FEET; THENCE S89°58'30"W 299.7; THENCE N00°07'30"W 110.00 FEET ALONG THE WEST LINE OF SAID SECTION 30 TO THE PLACE OF BEGINNING, BEING PART OF THE SOUTHWEST FRACTIONAL 1/4 OF SECTION 30, TOWNSHIP 2 SOUTH, RANGE 6 EAST, CONTAINING 0.76 OF AN ACRE OF LAND.

845, 849, 855, 859, 865, 869, 875, 879, 885, and 889 WICKFIELD COURT AND 2004 PONTIAC TRAIL

A PARCEL OF LAND BEING SITUATED IN THE SOUTHWEST 1/4 OF SECTION 16, TOWNSHIP 2 SOUTH, RANGE 6 EAST, ANN ARBOR TOWNSHIP, WASHTENAW COUNTY, MICHIGAN, DESCRIBED AS: COMMENCING AT THE SOUTH 1/4 CORNER OF SAID SECTION 16; THENCE ALONG THE NORTH AND SOUTH 1/4 LINE OF SAID SECTION 16 N01°04'30"E 287.5 FEET TO THE POINT OF BEGINNING ALSO BEING THE NORTHEAST CORNER OF LOT 17, STARWICK HEIGHTS NO. 2 SUBDIVISION AS RECORDED IN LIBER 11 OF PLATS PAGE 50, WASHTENAW COUNTY RECORDS, THENCE ALONG THE NORTH LINE OF SAID SUBDIVISION S86°13'40"W 659.9 FEET TO THE NORTHWEST CORNER OF LOT 8; THENCE S03°46'20"E 56.00 FEET; THENCE ALONG THE NORTH LINE OF SAID SUBDIVISION S86°13'40"W 309.03 FEET;

Dept. of Licensing & Regulatory Affairs  
**FILED**

NOV 07 2014 14 AR 0 8

STATE BOUNDARY COMMISSION

THENCE N15°29'03"E 112.28 FEET; THENCE N86°13'40"E 934.26 FEET; THENCE ALONG SAID NORTH AND SOUTH 1/4 LINE S01°04'30"W 50.00 FEET TO THE POINT OF BEGINNING. CONTAINS 1.45 ACRES OF LAND. SUBJECT TO EASEMENTS AND RIGHTS OF WAY OF RECORD.

RESOLVED, That petitions should be submitted to the State Boundary Commission to consider the annexation of the territory described above, located in the Charter Township of Ann Arbor, Washtenaw County, in accordance with the provisions of the 1909 PA 279 (Home Rule City Act; MCL 117.9), as amended, the provisions of 1983 PA 136 (Charter Township Act; MCL 42.34), as amended, and the provisions of 1968 PA 191 (Boundary Commission Act; MCL 123.1001 to 123.1020), as amended; and

RESOLVED, That the City Administrator, City Attorney and City Clerk be and are authorized to proceed with such petitions, to execute all required documents and to take all other administrative actions necessary to pursue and complete the petitions process and annexation.

I, Jacqueline Beaudry, Clerk of the City of Ann Arbor, Michigan, certify that this is a true copy of Resolution/Public Hearing R-14-363, passed by the Ann Arbor City Council on 10/20/2014.

Attest: Anissa R. Bowden  
Anissa R. Bowden,  
Council Administrative Coordinator

October 21, 2014  
Date Certified



PART IVa

The foregoing is a certified and true copy of a resolution passed by the legislative body of the City of Ann Arbor on the 20th day of October, 2014, by a vote of 10 to 0.

Jacqueline Beaudry 10/24/14  
Clerk Signature Date  
Jacqueline Beaudry

Print Name

Subscribed and sworn before me, Jacqueline Beaudry this 24<sup>th</sup> day of October, 2014, a Notary Public in and for Washtenaw County, Michigan.

Anissa R Bowden  
Signature

My Commission expires: \_\_\_\_\_

ANISSA R. BOWDEN  
Notary Public, State of Michigan  
County of Washtenaw  
My Commission Expires Apr. 30, 2020  
Acting in the County of \_\_\_\_\_

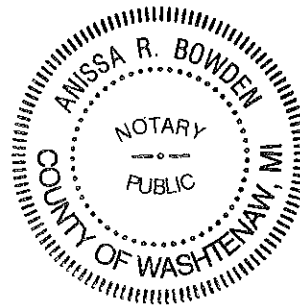

Dept. of Licensing & Regulatory Affairs  
**FILED**

NOV 07 2014 '14 AR 0 8

STATE BOUNDARY COMMISSION

**Part V**  
Reason for Request

The Ann Arbor Township parcel(s) proposed to be annexed into the City of Ann Arbor are surrounded by land within City of Ann Arbor jurisdiction. The primary reason the City of Ann Arbor is initiating annexation of Ann Arbor Township parcels is to reduce the duplication of municipal services. Currently, both the City and Township provide Police and Fire services within these boundaries. Annexing the properties will reduce duplication of service and increase the emergency response efficiency. Additionally, annexing the properties will allow the City to more effectively plan and implement infrastructure improvements. In 1994, the City of Ann Arbor and the Charter Township of Ann Arbor entered into an annexation agreement that indicated that after December 31, 2007, the Township would no longer contest City initiated annexations in an agreed upon service area. This annexation application is consistent with the 1994 agreement. The proposed annexations meets the conditions pursuant to Section 9 of The Home Rule City Act, 1909 PA 279. This proposed annexation includes fewer than 100 persons.

The City of Ann Arbor initiated annexation of this property by City Council resolution on October 20, 2014. The necessary conditions as identified by the State Boundary Commission have been met.

Dept. of Licensing & Regulatory Affairs  
**FILED**

NOV 07 2014 14 AR 08

STATE BOUNDARY COMMISSION

**Part VI**

<Not required>

Dept. of Licensing & Regulatory Affairs  
**FILED**













NOV 07 2014 '14 AR 08

STATE BOUNDARY COMMISSION

# PART VII

2200 Dexter Ave. (I-09-30-250-005)  
 2106 Dexter Ave. (I-09-30-250-006)  
 Vacant Dexter Ave. (I-09-30-250-007)

## Legend

-  City of Ann Arbor
-  Municipal Service Boundary
-  Parcel proposed for annexation
-  Highway
-  State Route
-  Major Roads
-  Minor Roads
-  Parcel Lines
-  Current Jurisdiction
-  City of Ann Arbor
-  Ann Arbor Twp.
-  Location of Parcel Proposed for Annexation

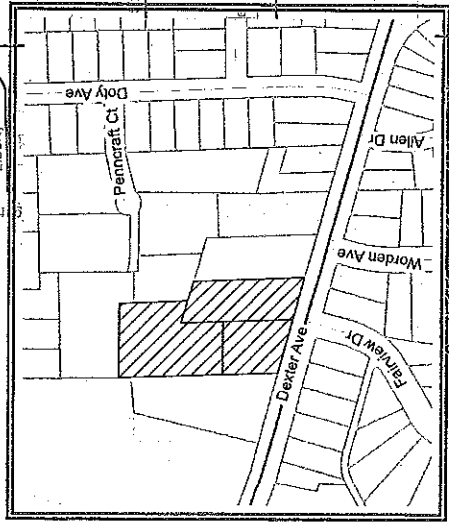
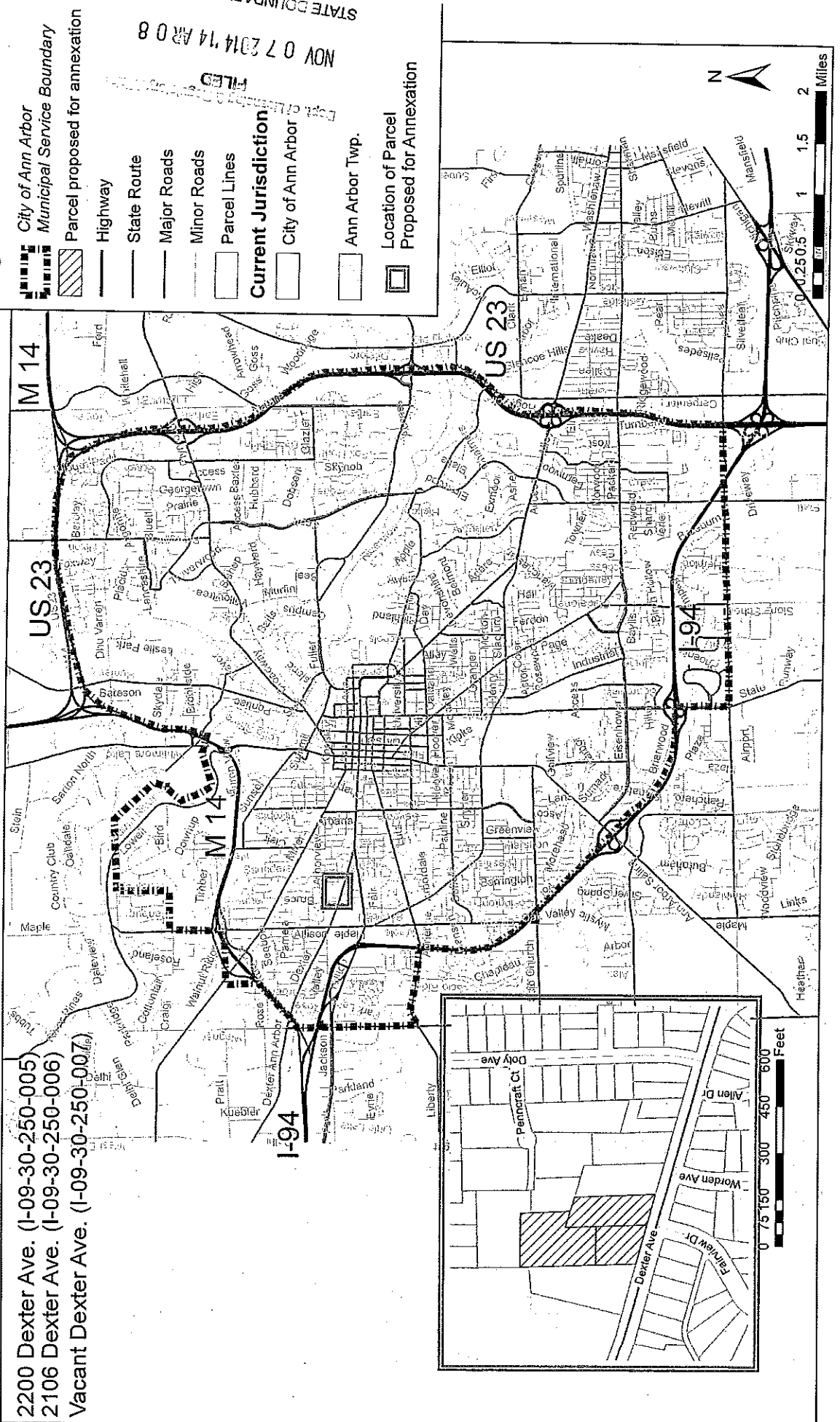

0 75 150 300 450 600 Feet

0 0.5 1 1.5 2 Miles

NOV 07 2014 14 AR 08 FILED

STATE BOUNDARY COMMISSION  
 NOV 07 2014 14:08

Part 1

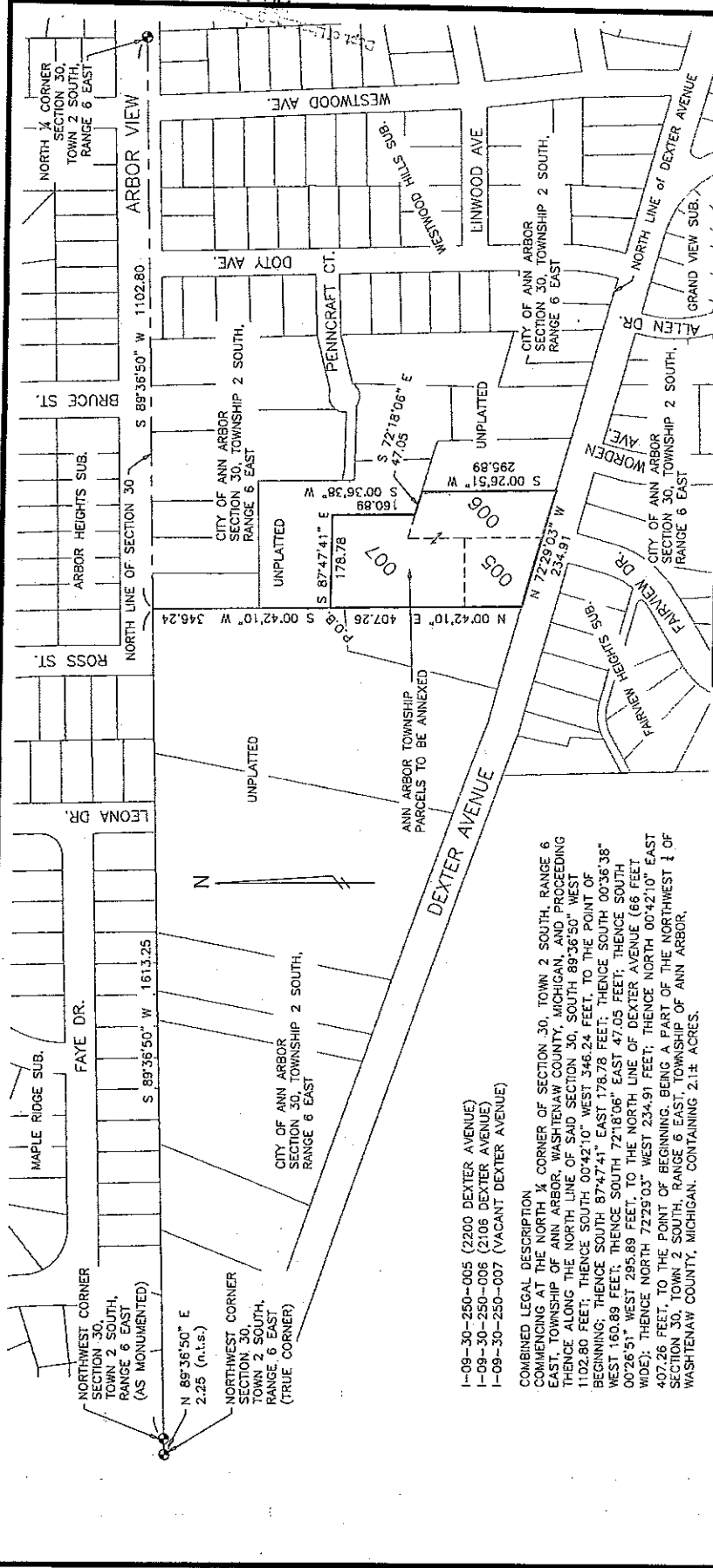

1-09-30-250-005 (2260 DEXTER AVENUE)  
 1-09-30-250-006 (2106 DEXTER AVENUE)  
 1-09-30-250-007 (VACANT DEXTER AVENUE)

COMBINED LEGAL DESCRIPTION  
 COMMENCING AT THE NORTH 1/4 CORNER OF SECTION 30, TOWN 2 SOUTH, RANGE 6 EAST, TOWNSHIP OF ANN ARBOR, WASHTENAW COUNTY, MICHIGAN, AND PROCEEDING THENCE ALONG THE NORTH LINE OF SAID SECTION 30, SOUTH 89°46'50" WEST 1102.80 FEET; THENCE SOUTH 00°42'10" WEST 346.24 FEET, TO THE POINT OF BEGINNING; THENCE SOUTH 87°47'41" EAST 178.78 FEET; THENCE SOUTH 00°36'38" WEST 160.89 FEET; THENCE SOUTH 72°18'06" EAST 47.05 FEET; THENCE SOUTH 00°26'51" WEST 295.89 FEET; TO THE NORTH LINE OF DEXTER AVENUE (66 FEET WIDE); THENCE NORTH 72°29'03" WEST 234.91 FEET; THENCE NORTH 00°42'10" EAST 407.26 FEET, TO THE POINT OF BEGINNING, BEING A PART OF THE NORTHWEST 1/4 OF SECTION 30, TOWN 2 SOUTH, RANGE 6 EAST, TOWNSHIP OF ANN ARBOR, WASHTENAW COUNTY, MICHIGAN, CONTAINING 2.1± ACRES.

**PROJECT MANAGEMENT - PUBLIC SERVICES - CITY OF ANN ARBOR**

Part 1

**2014 Annexation  
 DEXTER AVENUE ISLAND**

301 EAST HURON STREET  
 ANN ARBOR, MI 48107-8847  
 734-794-6410  
 www.a2gov.org

DATE 28 AUGUST, 2014  
 REVISED -  
 DRAWN MAS  
 SCALE 1" = 200'  
 SHEET No. 1 of 1

