

**ANNEXATION PETITION**  
**State Boundary Commission**  
Office of Land Survey and Remonumentation  
Bureau of Construction Codes/LARA  
Authority: 1968 PA 191

**General instructions for preparation of an Annexation Petition, by city council resolution, which consist of the following parts and forms:**

**Part I Map** shall be labeled and prepared pursuant to State Boundary Commission General Rule 37; **attach sheets** [R123.37]

**Part II Petition Certification;** see page 2 [MCL117.9(7)(a)]

**Part IIa Contact information;** see page 3 and attach additional sheets as necessary [R123.32(1)]

**Part III Legal description** shall be labeled and prepared pursuant to State Boundary Commission General Rule 37; **attach sheets** [R123.37]

**Part IV Resolution;** attach a copy of the resolution passed by the City Council requesting the annexation of the property shown on the “Part I” map and described in the “Part III” description [R123.37]

**Part IVa Certification by City Clerk;** see page 4

**Part V Reason for request** petitioner(s) reason(s) for the annexation request and statement indicating that the annexation meets the conditions pursuant to Section 9 of The Home Rule City Act, 1909 PA 279 [MCL117.9(7)(a)]; **no form is prescribed; attach sheets labeled “PART V”** [R123.37]

**Part VI** This part is not required on this type of petition.

**Part VII Map** shall be labeled and prepared pursuant to State Boundary Commission General Rule 37; **attach sheets** [R123.37]

**The completed petition should be filed with the State Boundary Commission. This may be done in person between the hours of 8:00 a.m. and 5:00 p.m., or by mail.**

In Person:  
State Boundary Commission  
Office of Land Survey and Remonumentation  
Bureau of Construction Codes/LARA  
2501 Woodlake Circle  
Okemos, MI 48864

Mail to:  
State Boundary Commission  
Office of Land Survey and Remonumentation  
Bureau of Construction Codes/LARA  
P.O. Box 30254  
Lansing, MI 48909

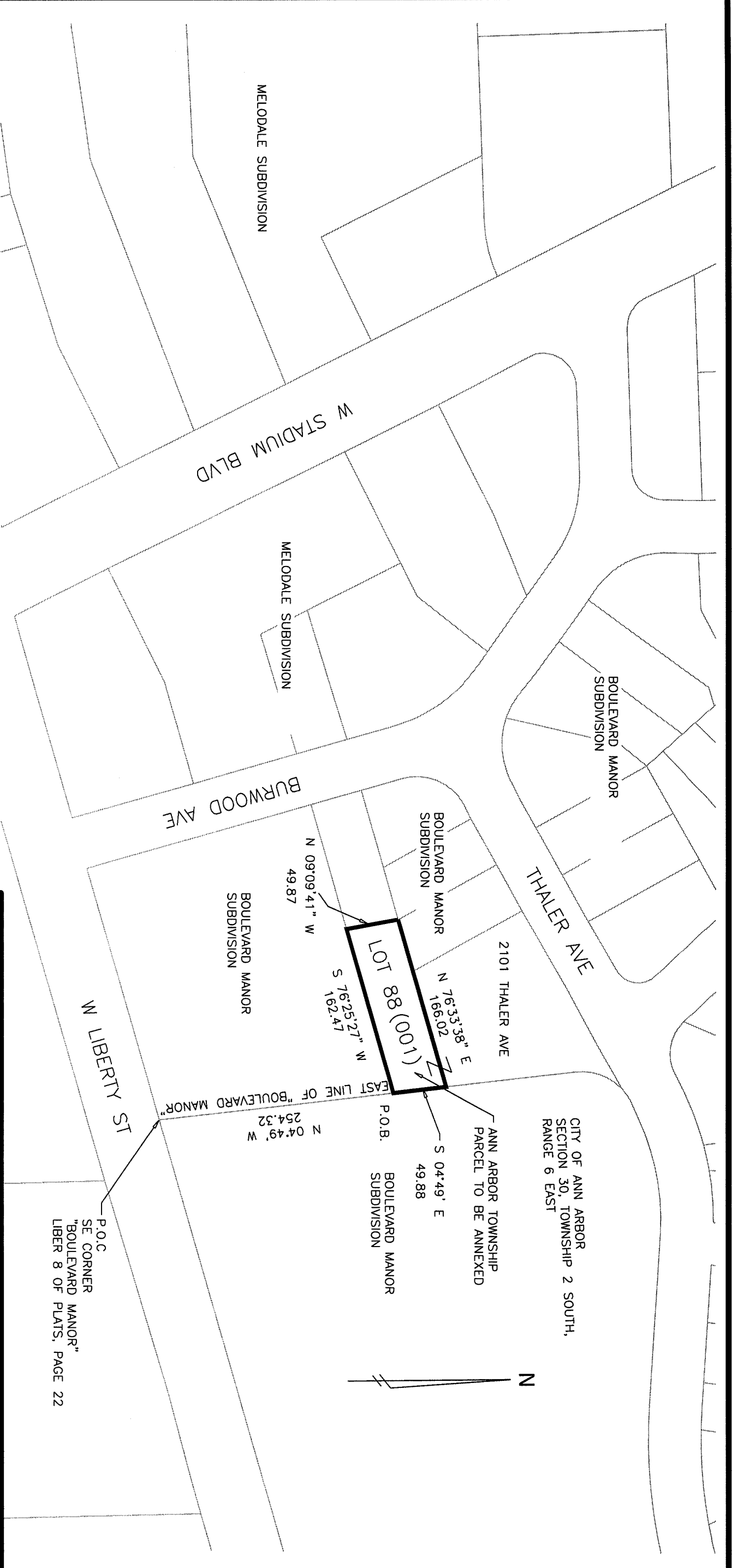

1-09-30-370-001 (VACANT THALER AVE)

**LEGAL DESCRIPTION**  
 LOT 88, "BOULEVARD MANOR" AS RECORDED IN LIBER 8 OF PLATS, PAGE 22, OF THE WASHTEENAW COUNTY RECORDS, AND THE A PORTION OF VACATED CAROLINA AVENUE BOUNDED BY THE SOUTHERLY AND NORTHERLY LINES OF SAID LOT 88 EXTENDED TO THE EASTERLY RIGHT OF WAY LINE OF CAROLINA AVENUE, ALSO DESCRIBED AS COMMENCING AT THE SOUTHEAST CORNER OF SAID PLAT; THENCE ALONG THE EAST LINE OF SAID PLAT N04°49'W 254.32 FEET TO THE POINT OF BEGINNING; THENCE S76°25'27"W 162.47 FEET; THENCE N09°09'41"W 49.87 FEET; THENCE N76°33'38"E 166.02 FEET; THENCE S04°49'E 49.88 FEET TO THE POINT OF BEGINNING, BEING A PART OF THE SOUTHWEST QUARTER OF SECTION 30, ANN ARBOR TOWNSHIP, WASHTEENAW COUNTY, MICHIGAN AND CONTAINS 0.19 OF AN ACRE OF LAND, SUBJECT TO EASEMENTS AND RIGHTS OF WAY OF RECORD.

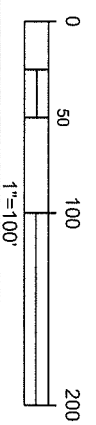

		<b>PROJECT MANAGEMENT - PUBLIC SERVICES - CITY OF ANN ARBOR</b>	
		<b>Part 1</b>	
<b>2014 Annexation</b> <b>THALER AVE (VACANT)</b>		301 EAST HURON STREET ANN ARBOR, MI 48107-8647 734-794-6410 www.a2gov.org	
DATE	14 AUGUST, 2014	SCALE	1" = 100'
REVISED	-	DRAWN	MAS
		SHEET No.	1 of 1

**PART II**

WE, the duly elected legislative body of the City of Ann Arbor,  
having passed a resolution requesting the annexation of territories as described in Part III within  
the township(s) of Ann Arbor Charter, in the County(ies) of  
Washtenaw, do hereby petition that the territories described in  
Part III be annexed to the City of Ann Arbor and that this  
annexation be considered by the State Boundary Commission pursuant to the provisions of 1909  
PA 279 and 1968 PA 191.

**PART IIa**

It is the responsibility of the petitioner(s) to furnish the State Boundary Commission with the following contact information in order for the government units to receive notice of docket material, meetings, and public hearings. The importance of accurate and current information cannot be overemphasized. Processing of a petition may be delayed if inaccuracies cause improper notice.

If the petition should involve more than one county, city, village, and/or township, place the designated government contact information on a separate sheet(s) and attach it to this form.

Petitioner: City of Ann Arbor	
Address: 301 E. Huron St.	
City, State, Zip: Ann Arbor, MI 48107	
Telephone: 734 794-6265 x42614	Fax: 734 994-8296
E-Mail: JKahan@a2gov.org	

City: City of Ann Arbor	Clerk: Jacqueline Beaudry
Address: 301 E. Huron St.	
City, State, Zip: Ann Arbor, MI 48107	
Telephone: 734 794-6140	Telephone: 734 994-8296
E-Mail: CityClerk@a2gov.org or JBeaudry@a2gov.org	

Village: N/A	Clerk:
Address:	
City, State, Zip:	
Telephone:	Telephone:
E-Mail:	

Township: Ann Arbor Charter Township	Clerk: Rena Basch
Address: 3792 Pontiac Trail	
City, State, Zip: Ann Arbor, MI 48105	
Telephone: 734 663-3418 x108	Telephone: 734 663-6678
E-Mail: basch@aatwp.org	

County: Washtenaw County	Clerk: Lawrence Kestenbaum
Address: 200 N. Main; P.O. Box 8645	
City, State, Zip: Ann Arbor, MI 48107	
Telephone: 734 222-6700	Telephone: 734 222-6528
E-Mail:	

### **Part III**

#### Legal Description

LOT 88, "BOULEVARD MANOR" AS RECORDED IN LIBER 8 OF PLATS, PAGE 22, OF THE WASHTENAW COUNTY RECORDS, AND THE A PORTION OF VACATED CAROLINA AVENUE BOUNDED BY THE SOUTHERLY AND NORTHERLY LINES OF SAID LOT 88 EXTENDED TO THE EASTERLY RIGHT OF WAY LINE OF CAROLINA AVENUE. ALSO DESCRIBED AS COMMENCING AT THE SOUTHEAST CORNER OF SAID PLAT; THENCE ALONG THE EAST LINE OF SAID PLAT N04°49'W 254.32 FEET TO THE POINT OF BEGINNING; THENCE S76°25'27"W 162.47 FEET; THENCE N09°09'41"W 49.87 FEET; THENCE N76°33'38"E 166.02 FEET; THENCE S04°49'E 49.88 FEET TO THE POINT OF BEGINNING, BEING A PART OF THE SOUTHWEST QUARTER OF SECTION 30, ANN ARBOR TOWNSHIP, WASHTENAW COUNTY, MICHIGAN AND CONTAINS 0.19 OF AN ACRE OF LAND, SUBJECT TO EASEMENTS AND RIGHTS OF WAY OF RECORD.

## **Part IV**

<resolution to be inserted after council approval>

**PART IVa**

The foregoing is a certified and true copy of a resolution passed by the legislative body of the City of Ann Arbor on \_\_\_\_\_ day of \_\_\_\_\_, 20\_\_\_\_, by a vote of \_\_\_\_\_ to \_\_\_\_\_.

\_\_\_\_\_  
Clerk Signature

Jacqueline Beaudry

\_\_\_\_\_  
Date

\_\_\_\_\_  
Print Name

Subscribed and sworn before me, \_\_\_\_\_ this \_\_\_\_\_ day of \_\_\_\_\_, 20\_\_\_\_, a Notary Public in and for Washtenaw County, Michigan.

\_\_\_\_\_  
Signature

My Commission expires: \_\_\_\_\_

**Part V**  
Reason for Request

The Ann Arbor Township parcel(s) proposed to be annexed into the City of Ann Arbor are surrounded by land within City of Ann Arbor jurisdiction. The primary reason the City of Ann Arbor is initiating annexation of Ann Arbor Township parcels is to reduce the duplication of municipal services. Currently, both the City and Township provide Police and Fire services within these boundaries. Annexing the properties will reduce duplication of service and increase the emergency response efficiency. Additionally, annexing the properties will allow the City to more effectively plan and implement infrastructure improvements. In 1994, the City of Ann Arbor and the Charter Township of Ann Arbor entered into an annexation agreement that indicated that after December 31, 2007, the Township would no longer contest City initiated annexations in an agreed upon service area. This annexation application is consistent with the 1994 agreement. The proposed annexations meets the conditions pursuant to Section 9 of The Home Rule City Act, 1909 PA 279. This proposed annexation includes fewer than 100 persons.













## Part VI

<Not required>

# PART VII 2099 Thaler Ave. (I-09-30-370-001)

## Legend

-  City of Ann Arbor  
Municipal Service Boundary
-  Parcel proposed for annexation
-  Highway
-  State Route
-  Major Roads
-  Minor Roads
-  Parcel Lines
- Current Jurisdiction**
-  City of Ann Arbor
-  Ann Arbor Twp.
-  Location of Parcel Proposed for Annexation

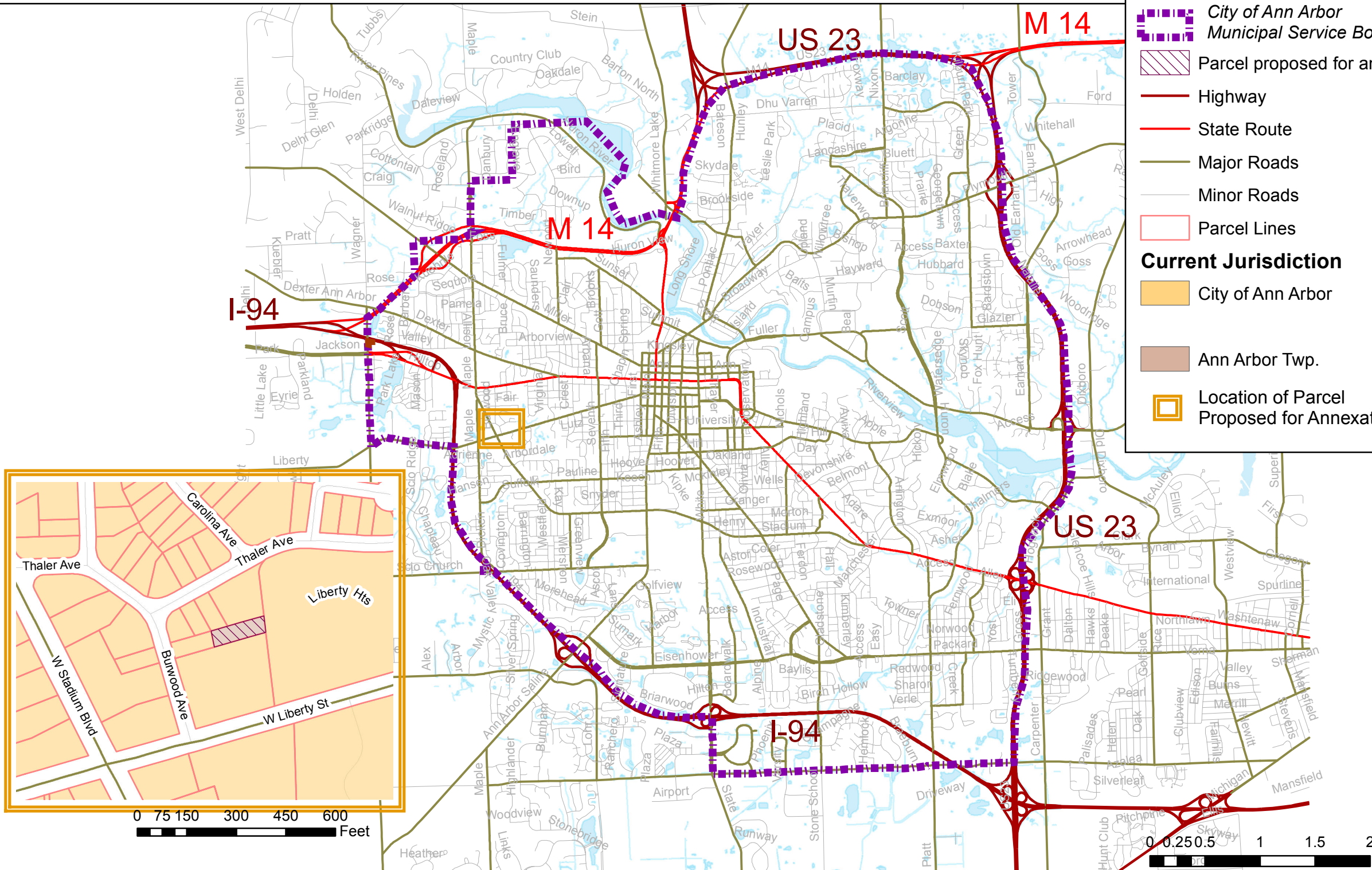

0 75 150 300 450 600 Feet

0 0.250.5 1 1.5 2 Miles