

ANNEXATION PETITION INSTRUCTIONS

By City Council Resolution State Boundary Commission

Department of Licensing and Regulatory Affairs
Authority: 1968 PA 191

General instructions for preparation of an Annexation Petition by city council resolution, which consists of the following parts and forms:

Part I Map: Shall be labeled and prepared pursuant to State Boundary Commission General Rule 37; **attach sheets labeled “PART I”** [R123.37].

Part II Petition Certification: Requests that the State Boundary Commission annex the area described in Part III description to the adjacent City; **attach sheets labeled “PART II”** [MCL 117.6; MCL 117.7 and MCL117.9(7)(a)].

Part III Legal Description: Shall be labeled and prepared pursuant to State Boundary Commission General Rule 37; **attach sheets labeled “PART III”** [R123.37].

Part IV Resolution: Attach a copy of the resolution passed by the City Council requesting the annexation of the property shown on the “Part I” map and described in the “Part III” description certified by the City Clerk [R123.37(10)].

Part V Reason for Request: Petitioner(s) reason(s) for the annexation request and statement indicating that the annexation meets the conditions pursuant to Section 9 of The Home Rule City Act, 1909 PA 279 [MCL117.9(7)(a)]; **attach sheets labeled “PART V”** [R123.37].

Part VI: This part is not required on this type of petition.

Part VII Map: Shall contain a map showing the relationship of the area proposed for annexation to the balance of the involved and adjacent units of government; **attach sheets; attach sheets labeled “PART VII”** [R123.37].

Provide contact information of petitioner and involved local units of government; **attach sheets** [R123.32(1)].

The completed petition shall be filed with the State Boundary Commission. This may be done in person between the hours of 8:00 a.m. and 5:00 p.m., by mail or email to bccolsr@michigan.gov.

U.S. Postal Service:

State Boundary Commission
Office of Land Survey and Remonumentation
Department of Licensing and Regulatory Affairs
P.O. Box 30254
Lansing, MI 48909

Courier Other Than U.S. Postal Service

State Boundary Commission
Office of Land Survey and Remonumentation
Department of Licensing and Regulatory Affairs
611 West Ottawa
Ottawa Building, 1st Floor
Lansing, MI 48933

PART I

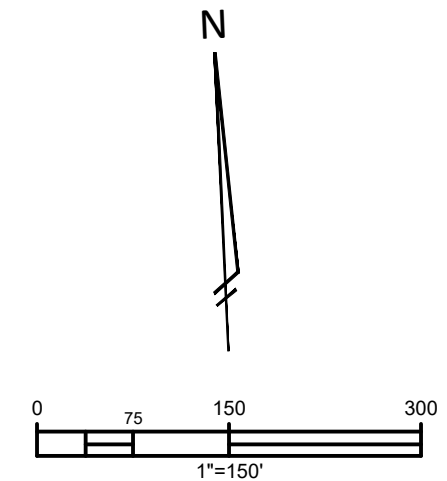

PETITION #9

COMBINED DESCRIPTION: LOTS 250, 251 AND 252 OF SCIOTO HILLS NUMBER ONE AS RECORDED IN LIBER 8 OF PLATS, PAGE 30, WASHTENAW COUNTY RECORDS AND 1/2 OF THE VACATED RIGHT OF WAY ADJACENT TO LOT 252 AS NOTED IN LIBER 1276, PAGE 196, WASHTENAW COUNTY RECORDS, MICHIGAN.

THE ABOVE DESCRIPTION COMBINES THE FOLLOWING PARCELS:

- H-08-24-481-014 (VACANT LOT, LIBER 1964 PAGE 353)
- H-08-24-481-015 (VACANT LOT, LIBER 1964 PAGE 353)
- H-08-24-481-016 (VACANT LOT, LIBER 1964 PAGE 353)

PETITION #10

COMBINED DESCRIPTION: LOTS 242 AND 243, SCIOTO HILLS NUMBER ONE, AS RECORDED IN LIBER 8 OF PLATS, PAGE 30, WASHTENAW COUNTY RECORDS, MICHIGAN.

THE ABOVE DESCRIPTION COMBINES THE FOLLOWING PARCELS:

- H-08-24-481-009 (VACANT LOT, LIBER 4470 PAGE 356)
- H-08-24-481-010 (VACANT LOT, TAX DESCRIPTION, NO DEED AVAILABLE)

PROJECT MANAGEMENT - PUBLIC SERVICES - CITY OF ANN ARBOR



**SCIO TOWNSHIP
PETITION 9 AND 10**

**301 EAST HURON STREET
ANN ARBOR, MI 48107-8647
734-794-6410
www.a2gov.org**

DATE **18 APRIL, 2017**

REVISED

DRAWN **MAS**

SCALE **1" = 150'**

SHEET No. **1 of 1**

PART II

Petition Certification

WE, the duly elected legislative body of the City of Ann Arbor, having passed a resolution requesting the annexation of territories as described in Part III within the township of Scio, in the County of Washtenaw, do hereby petition that the territories described in the Part III be annexed into the City of Ann Arbor and that this annexation be considered by the State Boundary Commission pursuant to the provisions of the 1909 PA 279 and 1968 PA 191.

PART III

Legal Description

COMBINED DESCRIPTION: LOTS 250, 251 AND 252 OF SCIOTO HILLS NUMBER ONE AS RECORDED IN LIBER 8 OF PLATS, PAGE 30, WASHTENAW COUNTY RECORDS AND 1/2 OF THE VACATED RIGHT OF WAY ADJACENT TO LOT 252 AS NOTED IN LIBER 1276, PAGE 196, WASHTENAW COUNTY RECORDS, MICHIGAN.

THE ABOVE DESCRIPTION COMBINES THE FOLLOWING PARCELS:

H-08-24-481-014 (VACANT LOT, LIBER 1964 PAGE 353)

H-08-24-481-015 (VACANT LOT, LIBER 1964 PAGE 353)

H-08-24-481-016 (VACANT LOT, LIBER 1964 PAGE 353)

PART IV

Resolution

PART V

The township parcel(s) proposed to be annexed into the City of Ann Arbor are surrounded by land within City of Ann Arbor's ultimate jurisdiction. The City of Ann Arbor is initiating annexation of township parcels for a number of reasons: a) Increase efficiency of municipal services. Currently, emergency responders from both the City and Township provide services within the City's ultimate boundary (e.g. sometimes City police respond to service calls from township island properties). Additionally, the City provides solid waste services to City parcels while private haulers provide solid waste services to township parcels in the same neighborhood. Voting is also inefficient. Both the Township and the City provide voting precincts for neighborhoods that include township islands. Four building departments provide services to properties within the City's ultimate service area. b) Annexation will result in a more equitable provision of public services. Currently, township island residents receive a number of City services without paying for them such as road resurfacing and reconstruction, street lighting, stormwater management, and City parks; and c) Annexing the properties will allow the City to more effectively plan and implement infrastructure improvements. In 1979, The City of Ann Arbor entered into agreements with Scio Township and Pittsfield Township which defined the City's ultimate service area. In 1994, the City of Ann Arbor and the Ann Arbor Township entered into an annexation agreement that defined the City's ultimate boundary. The agreement indicated that after December 31, 2007, the Township would no longer contest City initiated annexations. This annexation application is consistent with these agreements. The proposed annexations meet the conditions pursuant to Section 9 of The Home Rule City Act, 1909 PA 279. This petition for annexation includes fewer than 100 persons.

The City of Ann Arbor initiated annexation of this property by City Council resolution on October 1, 2018. The necessary conditions as identified by the State Boundary Commission have been met.

PART VI

This part is not required on this type of petition.

PART VII

Vacant Dexter Rd (H -08-24-481-016)
 Vacant Dexter Rd (H -08-24-481-015)
 Vacant Dexter Rd (H -08-24-481-014)



City of Ann Arbor
 Municipal Service Boundary



Parcel Proposed for Annexation

Current Jurisdiction



City of Ann Arbor



Ann Arbor Twp.



Pittsfield Twp.



Scio Twp.

Highway

State Route

Major Roads

Minor Roads

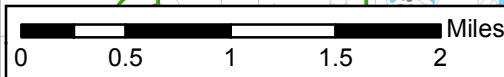
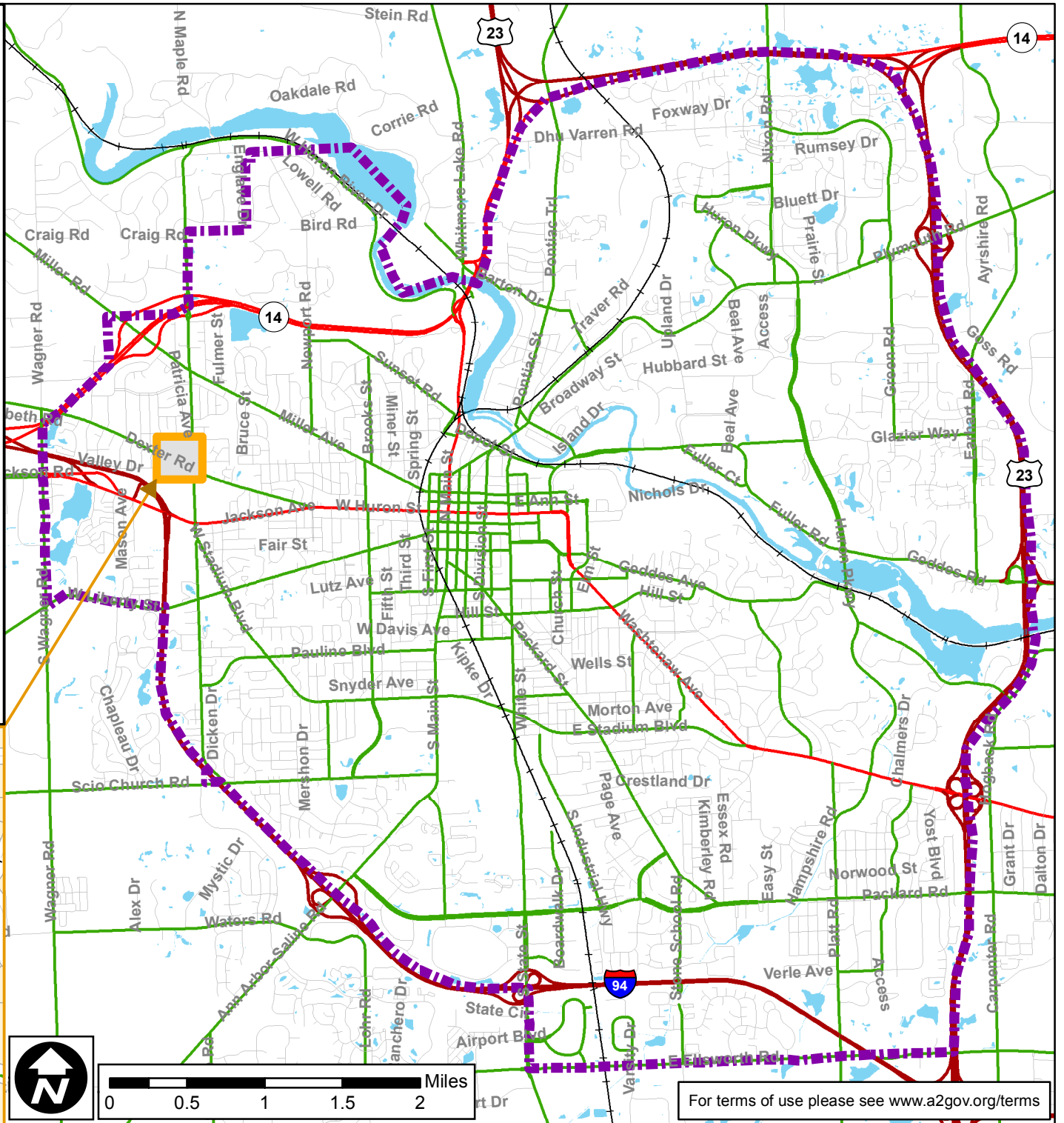

For terms of use please see www.a2gov.org/terms

Contact Information

Petitioner: City of Ann Arbor
301 E Huron St.
Ann Arbor, MI 48017
Phone: 734-794-6000 x42614
Fax: 734-994-8296
Email: jkahan@a2gov.org

City: City of Ann Arbor
Clerk: Jacqueline Beaudry
301 E Huron St.
Ann Arbor, MI 48107
Phone: 734-794-6140
Email: JBeaudry@a2gov.org or
CityClerk@a2gov.org

Township: Scio Township
Clerk: Nancy C. Hedberg
827 N. Zeeb Road
Ann Arbor, MI 48103
Phone: 734-369-9400
Email: nhedberg@ScioTownship.org

County: Washtenaw County
200 N. Main; P.O. Box 8645
Ann Arbor, MI 48107
Phone: 734-222-6700
Fax: 734-222-6528