

**GRANT OF EASEMENT  
FOR  
PUBLIC ROAD RIGHT OF WAY PURPOSES**

**KNOW ALL PERSONS BY THESE PRESENTS:** That the **CITY OF ANN ARBOR**, a Michigan municipal corporation, whose address is 100 North Fifth Avenue, Ann Arbor, Michigan 48104, hereinafter referred to as "**Grantor**", hereby grants and conveys to the **BOARD OF COUNTY ROAD COMMISSIONERS OF THE COUNTY OF WASHTENAW**, a Public Body Corporate, whose address is 555 N. Zeeb Road, Ann Arbor, Michigan 48103 hereinafter referred to as "**Grantee**", a permanent easement for public road purposes upon the following described property, situated in the NE 1/4 of Section 17, T3S, R6E, Township of Pittsfield, County of Washtenaw, State of Michigan, being more fully described in "Attachment A" attached hereto and incorporated herein.

**For good and valuable consideration less than \$100.00, the receipt and adequacy of which is hereby acknowledged, the parties hereby agree as follows:**

This conveyance includes a release of any and all claims arising from or incidental to the widening, draining, and improving of the road and the location thereof, including the removal of such trees, shrubs vegetation, gravel, soil and other materials as the Washtenaw County Road Commission determines to be necessary in the construction and maintenance of said road subject to the FAAMDOT AERO clauses for concurrent use as described in "Attachment B" attached hereto and incorporated herein.

This grant of easement shall run with the land and shall be binding on and shall inure to the benefits of the parties hereto, their successors, heirs, executors and assigns.

Dated this \_\_\_\_\_ day of \_\_\_\_\_, 2012.

**GRANTOR:**

**CITY OF ANN ARBOR**

By: \_\_\_\_\_  
John Hiefije, Mayor

By: \_\_\_\_\_  
Jacqueline Beaudry, City Clerk

**STATE OF MICHIGAN  
COUNTY OF WASHTENAW**

The foregoing instrument was acknowledged before me this \_\_\_\_\_ day of \_\_\_\_\_ 2012, by John Hiefije, Mayor and Jacqueline Beaudry, City Clerk on behalf of and for the City of Ann Arbor, a Michigan municipal corporation, as grantor.

\_\_\_\_\_  
Notary Public, State of Michigan  
County of \_\_\_\_\_, Acting in \_\_\_\_\_ County, Michigan  
My commission expires:

Prepared By and When Recorded Return To:  
Lori E. Beyer, P.S.  
Washtenaw County Road Commission  
555 N. Zeeb Road, Ann Arbor, MI 48103

Tax Parcel No.: Part of: L-12-17-100-007 and L-12-17-100-008

ATTACHMENT 'A'



SCALE: 1" = 50'

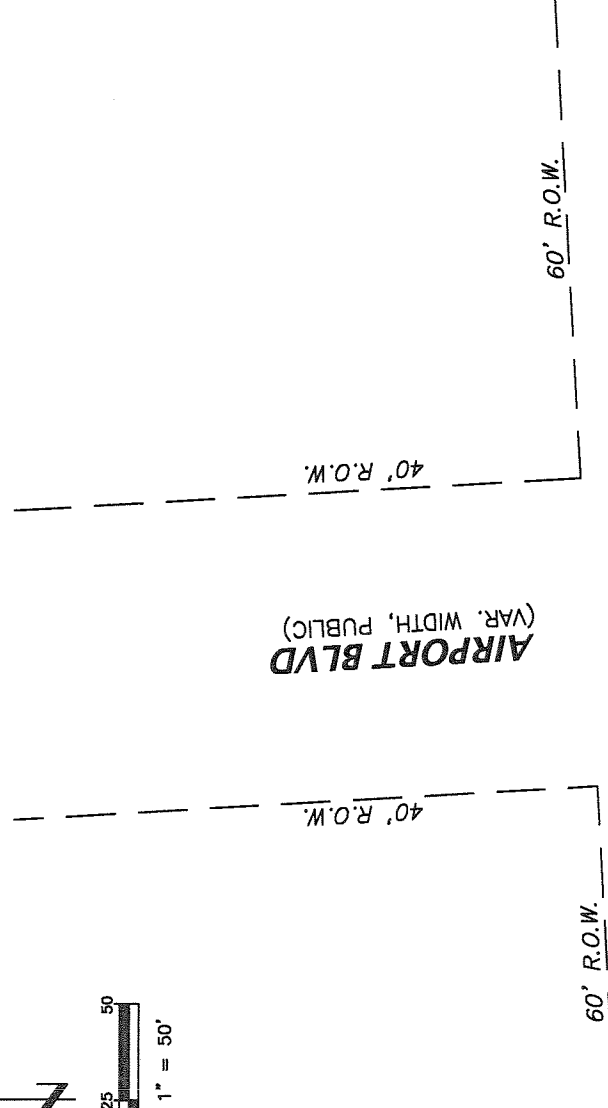

N 1/4 CORNER  
SECTION 17  
T.3S., R.6E.

NORTH LINE SECTION 17

ELLSWORTH RD  
(VAR. WIDTH, PUBLIC)

NORTHEAST CORNER  
SECTION 17  
T.3S., R.6E.

N86°47'50"E  
967.52'

S03°12'10"E  
43.00'

P.O.B.

N86°47'50"E 105.00'

S86°47'50"W 105.00'

S03°12'10"E  
17.00'

APPROX. PROP. LINE

L-12-17-100-008  
CITY OF ANN ARBOR  
100 N. FIFTH AVENUE  
ANN ARBOR, MI 48107  
ENTIRE PARCEL NOT SHOWN

L-12-17-100-007  
CITY OF ANN ARBOR  
100 N. FIFTH AVENUE  
ANN ARBOR, MI 48107  
ENTIRE PARCEL NOT SHOWN

LEGEND

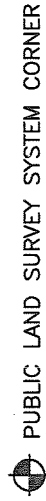

PUBLIC LAND SURVEY SYSTEM CORNER

BASIS OF BEARINGS:  
MCI JOB NO. 11042

AREA

DIMENSIONS AND AREAS BASED ON TAX  
PARCEL DESCRIPTIONS. NOT BASED ON  
ACTUAL FIELD SURVEY.  
THIS DOCUMENT IS NOT A  
P.A. 132 SURVEY



PROPOSED PERMANENT EASEMENT  
AREA: 0.041 AC (1785 SF)

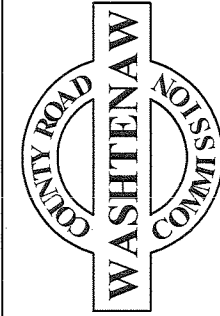

DATE: 01/31/2012

DRAWN: J.A.M.

CHECKED: L.E.B.

FILE: SURVEY/LAND/2012/COSTCO/ROW

PROJ. NO.:

REVISED:

PERMANENT EASEMENT  
ELLSWORTH RD

NORTHEAST QUARTER  
SECTION 17, T.3S., R.6E.  
WASHTENAW COUNTY  
MICHIGAN

# ATTACHMENT 'A'

## LEGAL DESCRIPTION - PERMANENT EASEMENT

A PERMANENT EASEMENT LOCATED IN THE NORTHEAST QUARTER OF SECTION 17, TOWN 3 SOUTH, RANGE 6 EAST, PITTSFIELD TOWNSHIP, WASHTENAW COUNTY, MICHIGAN, BEING MORE PARTICULARLY DESCRIBED AS:

COMMENCING AT THE NORTH QUARTER CORNER OF SECTION 17, THENCE ALONG THE NORTH LINE OF SECTION 17 AND CENTERLINE OF ELLSWORTH ROAD, NORTH 86°47'50" EAST, 967.52 FEET; THENCE SOUTH 03°12'10" EAST 43.00 FEET TO THE POINT OF BEGINNING; THENCE ALONG THE EXISTING SOUTHERLY RIGHT OF WAY LINE OF ELLSWORTH ROAD, NORTH 86°47'50" EAST 105.00 FEET; THENCE SOUTH 03°12'10" EAST 17.00 FEET; THENCE ALONG A LINE 60.00 FEET SOUTH OF AND PARALLEL TO THE NORTH LINE OF SECTION 17 AND CENTERLINE OF ELLSWORTH ROAD, S86°47'50" WEST 105.00 FEET; THENCE NORTH 03°12'10" WEST 17.00 FEET TO THE POINT OF BEGINNING. SAID EASEMENT CONTAINING 0.041 ACRES (1785 SQUARE FEET) OF LAND, MORE OR LESS. ALSO BEING SUBJECT TO EASEMENTS AND RESTRICTIONS OF RECORD, IF ANY.

### LEGEND

 PUBLIC LAND SURVEY SYSTEM CORNER

BASIS OF BEARINGS:  
PROPERTY TAX DESCRIPTIONS

*DIMENSIONS AND AREAS BASED ON TAX  
PARCEL DESCRIPTIONS. NOT BASED ON  
ACTUAL FIELD SURVEY.  
THIS DOCUMENT IS NOT A  
P.A. 132 SURVEY*



DATE: 01/31/2012

DRAWN: J.A.M.

CHECKED: L.E.B.

FILE: SURVEY/LAND/2012/COSTCO/ROW

PROJ. NO.:

REVISED:

**PERMANENT EASEMENT  
ELLSWORTH RD**

NORTHEAST QUARTER  
SECTION 17, T.3S., R.6E.  
WASHTENAW COUNTY  
MICHIGAN