

MEMORANDUM

TO : «DepartmentEmail»
FROM : Jacqueline Beaudry, City Clerk
SUBJECT : COMPLETED ANNEXATIONS
DATE : December 7, 2011

The City Clerk's Office received notice from the Secretary of State's Office of the following completed annexations:

1. from Ann Arbor Township: Hofmann Property, 0.52 acre, located at 1643 and 1645 South State St. (City File Nos. A11-002 and Z11-002) and
2. from Pittsfield Township: Mill Creek Property, 1.17 acres, located at East side of Stone School Road, North and South of Birch Hollow Dr. (City File Nos. A11-001 and Z11-002)

JB/aa
Attachments
cc: All Departments



CITY OF ANN ARBOR
CITY CLERK
REC'D

STATE OF MICHIGAN
RUTH JOHNSON, SECRETARY OF STATE
DEPARTMENT OF STATE
LANSING

2011 DEC -5 PM 1:26

November 29, 2011

Jacqueline Beaudry
City of Ann Arbor
100 North Fifth Avenue
PO Box 8647
Ann Arbor, MI 48107

RE: Annexation of property - Hofmann - 1643 & 1645 S. State St.

Dear Ms. Beaudry:

This letter serves to acknowledge the Office of the Great Seal's receipt on November 22, 2011 of the filing of the annexation pursuant to Public Act 359 of 1947, as amended, from Ann Arbor Township to the City of Ann Arbor. The receipt date is the effective date of this boundary change. This filing is designated as Job Number 11-031.

All property descriptions for any boundary changes are reviewed by the Michigan Department of Transportation (MDOT), and then published annually in the Michigan Public and Local Acts manual. If any property description is found inaccurate by MDOT, this office will contact you at that time and request a corrected description, which will not impact the effective date of the boundary change.

*****No further acknowledgment will be sent*****

Sincerely,

Michele Martin, Technician
Office of the Great Seal
517-241-1829

cc: Ann Arbor Township Clerk
Washtenaw County Clerk
Michigan Department of Labor and Economic Growth, State Boundary Commission
Michigan Department of Labor and Economic Growth, Liquor Control Commission
Michigan Department of Labor and Economic Growth, Office of Land Survey and Remonumentation
Michigan Department of Information Technology, Center for Geographic Information
Michigan Department of Treasury, Office of Revenue and Tax Analysis
Michigan Department of Transportation, Bureau of Transportation Planning
U.S. Bureau of the Census
Office of the Great Seal Job Number: 11-031

Cities
Washtenaw County

In the matter of the annexation of certain property located in Ann Arbor Township to the City of Ann Arbor. Annexed in accordance with the provisions of Public Act 359 of 1947, as amended the following described property:

Parcel ID# I-09-33-370-006 (1643 S. State Street)

*OLD SID - I 09-033-008-00 33-5 COM AT SW COR OF SEC, TH E 116.23 FT IN S LINE OF SEC, TH DEFL 110 DEG 50' 30" TO LEFT 217.71 FT, TH DEFL 22 DEG 27' 30" TO RIGHT 203.80 FT FOR PL OF BEG, TH CONTINUING NLY 50 FT IN SAMECOURSE, TH DEFL 89 DEG 02' TO RIGHT 150 FT, TH DEFL 89 DEG 02' TO LEFT 48 FT, TH DEFL 89 DEG 02' TO RIGHT 29.80 FT, TH DEFL 68 DEG 31' TO RIGHT 117.04 FT, TH DEFL 112 DEG 27' TO RIGHT 54.52 FT, TH DEFL 90 DEG TO RIGHT 10 FT, TH DEFL 90 DEG 58' TO LEFT 170 FT TO PL OF BEG, BEING PART OF SW 1/4 SEC. 33 T2S R6E 0.30 AC.

and

Parcel ID# I-09-33-370-007 (1645 S. State Street)

AA 33-6 COM AT NW COR OF SW 1/4 OF SW 1/4, TH S 01-43-35 E 921.79 FT, TH N 87-18-25 E 45.10 FT TO POB, TH N 87-18-25 E 157.9 FT, TH S 03-39-35 E 60 FT, TH S 87-18-25 W 153.68 FT, TH 60.05 FT ALNG ARC OF CURV- RAD 1392.39 FT TO POB. PT OF SW 1/4 SEC 33 T2S, R6E 0.22 AC

**1643 and 1645 S. State St.
-Zoning Map-**

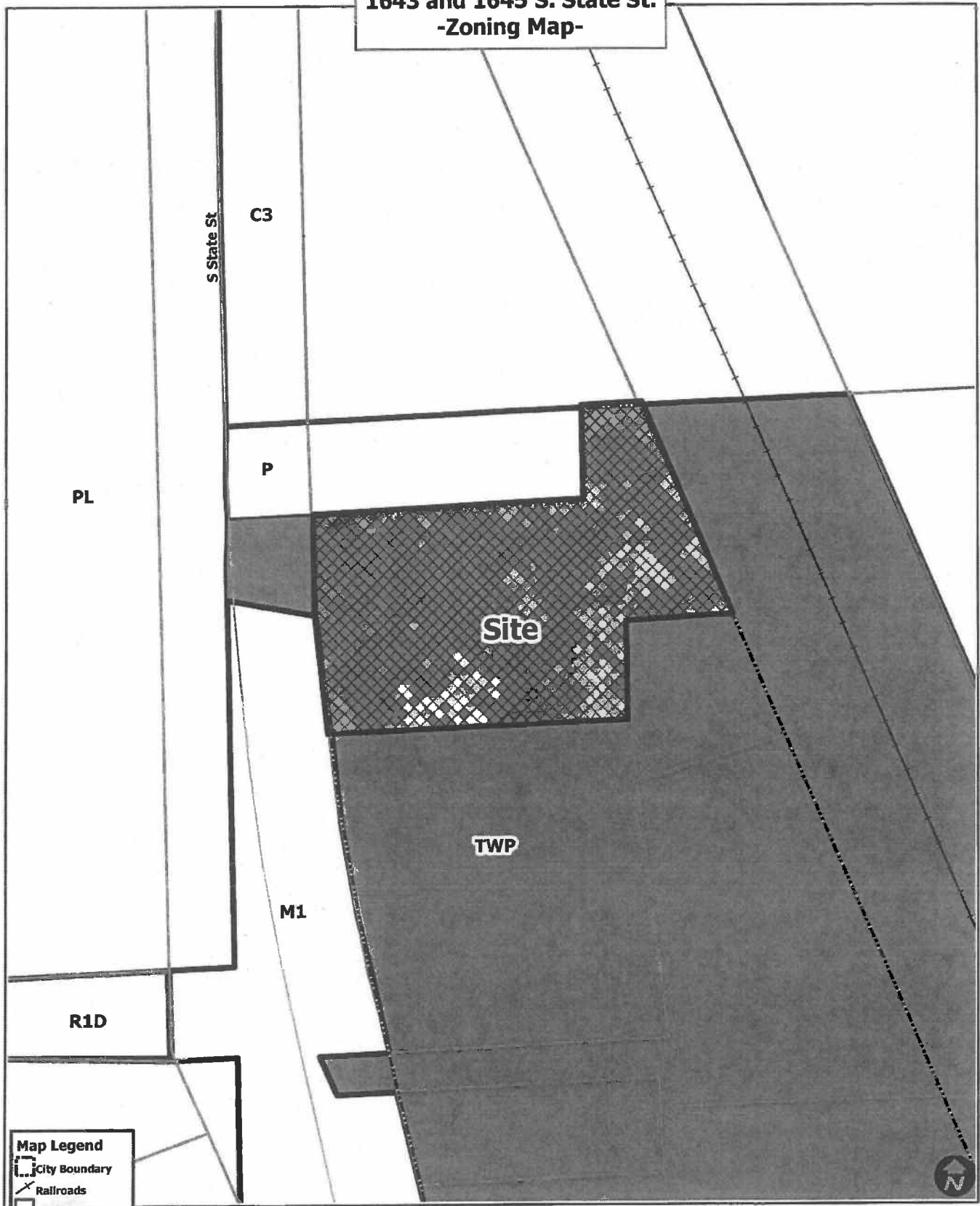

Map Legend

- City Boundary
- Railroads
- Parcel Property
- Zoning**
- Township
- City of Ann Arbor



City of Ann Arbor Map Disclaimer:
 No part of this product shall be reproduced or transmitted in any form or by any means, electronic or mechanical, for any purpose, without prior written permission from the City of Ann Arbor.
 This map complies with National Map Accuracy Standards for mapping at 1 inch = 100 feet. The City of Ann Arbor and its mapping contractors assume no legal responsibility for the content and/or inappropriate use of information on this map.
 Map Created: 6/23/2011