

MEMORANDUM

TO : «DepartmentEmail»
FROM : Jacqueline Beaudry, City Clerk
SUBJECT : COMPLETED ANNEXATIONS
DATE : December 3, 2008

The City Clerk's Office received notice from the Secretary of State's Office of the following completed annexations from Ann Arbor Township:

1. Muhleman Property, 1.25 acres, located at 3055 Dover Place and Vacant Lot (City File No A08-003 and Z08-004) and
2. Willing Property, 0.47 acre, located at 1545 Chalmers Drive (City File No A08-002 and Z08-003).

JB/aa
Attachments
cc: All Departments



STATE OF MICHIGAN
TERRI LYNN LAND, SECRETARY OF STATE
DEPARTMENT OF STATE
LANSING

CITY OF ANN ARBOR
CITY CLERK
REC'D

2008 DEC -3 AM 10:32

November 25, 2008

Ms. Jacqueline Beaudry, City Clerk
100 North Fifth Avenue
PO Box 8647
Ann Arbor, MI 48107

RE: Annexation of 3055 Dover Place & Vacant lot - Muhleman Property

Dear Ms. Beaudry:

This letter serves to acknowledge the Office of the Great Seal's receipt on November 21, 2008 of the filing of the annexation pursuant to Public Act 359 of 1947, as amended, from Ann Arbor Township to the City of Ann Arbor. The receipt date is the effective date of this boundary change. This filing is designated as Job Number 08-025.

All property descriptions for any boundary changes are reviewed by the Michigan Department of Transportation (MDOT), and then published annually in the Michigan Public and Local Acts manual. If any property description is found inaccurate by MDOT, this office will contact you at that time and request a corrected description, which will not impact the effective date of the boundary change.

*****No further acknowledgment will be sent*****

Sincerely,

Michele Martin, Technician
Office of the Great Seal
517-241-1829

cc: Ann Arbor Township Clerk
Washtenaw County Clerk
Michigan Department of Labor and Economic Growth, State Boundary Commission
Michigan Department of Labor and Economic Growth, Liquor Control Commission
Michigan Department of Labor and Economic Growth, Office of Land Survey and Remonumentation
Michigan Department of Information Technology, Center for Geographic Information
Michigan Department of Treasury, Office of Revenue and Tax Analysis
Michigan Department of Transportation, Bureau of Transportation Planning
U.S. Bureau of the Census
Office of the Great Seal Job Number: 08-025

Job Number: 08-025

Cities
Washtenaw County

In the matter of the annexation of certain property located in Ann Arbor Township to City of Ann Arbor. Annexed in accordance with the provisions of Public Act 359 of 1947, as amended the following described property:

3055 Dover Place

OLD SID I-09-27-475-028 AND 029 LOT 6, EXC THE E 30 FT THEREOF & ALL OF LOT 7 GEDDES AVENUE RIVER VIEW HEIGHTS, WASHTENAW COUNTY, MICHIGAN.

Vacant Parcel

OLD SID - I 09-095-005-00 AA 45-5A COM AT SE COR OF LOT 5 TH N 2-21 E 140.00 FT IN E/L OF LOT 5 FOR POB, TH N 89-41-36 W 116.86 FT, TH N 2-46 W 80.34 FT, TH 23.80 FT IN ARC OF CURVE LEFT RADIUS 270.54 FT, CHORD N 53-39 E 23.79 FT, TH N 51-18 E 87.48 FT, TH S 29-34 E 74.55 FT, TH S 2-21 W 84.91 FT TO POB, BEING PART OF LOTS 5 & 6, GEDDES AVENUE RIVER VIEW HEIGHTS, WASHTENAW COUNTY, MICHIGAN.

3055 Dover Place and Vacant Parcel -Zoning Map-

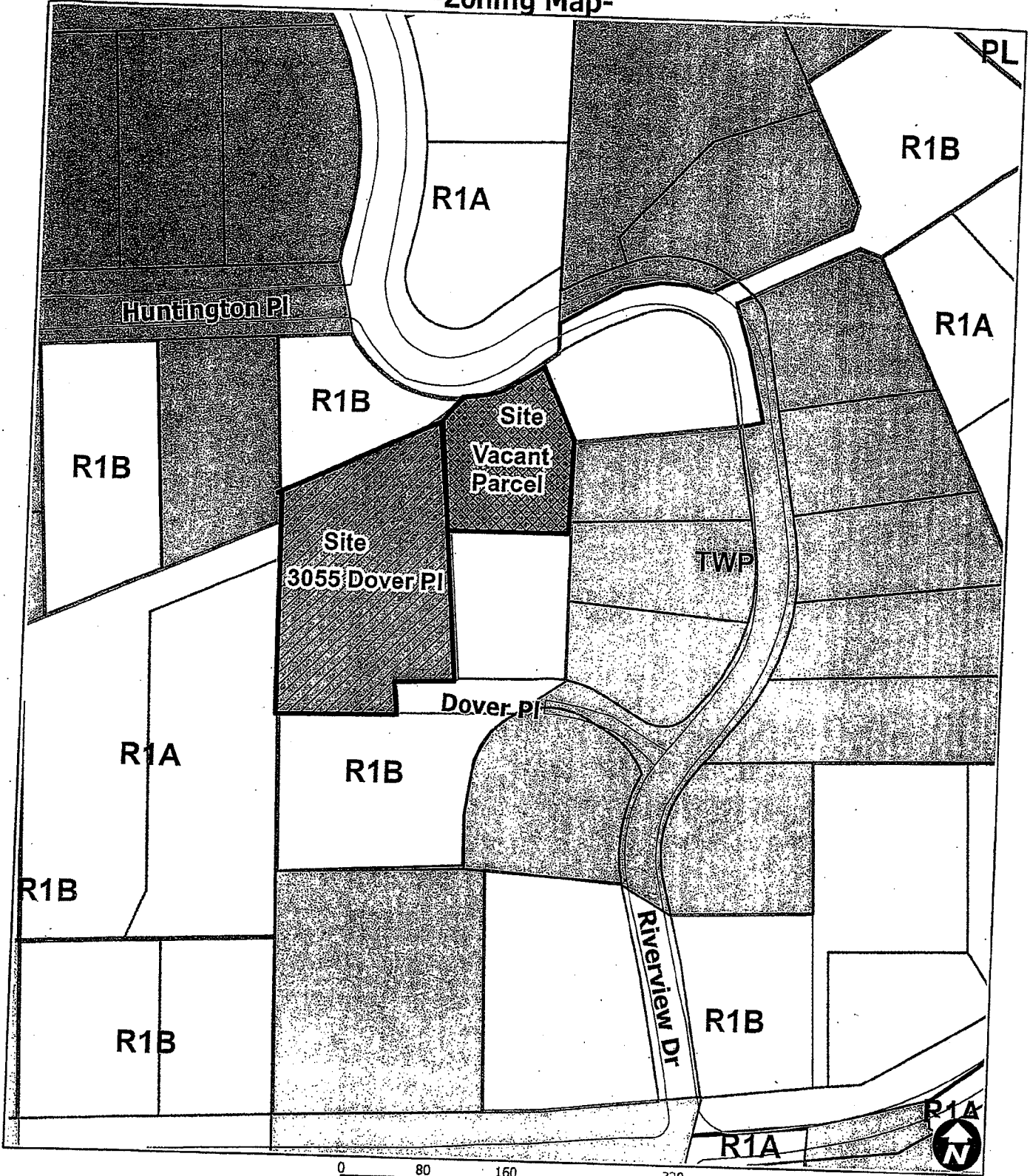

Map Legend
 — Railroads



Maps available online:
<http://gisweb.ewashtenaw.org/website/mapwashtenaw/>

Copyright 2008 City of Ann Arbor, Michigan

No part of this product shall be reproduced or transmitted in any form or by any means, electronic or mechanical, for any purpose, without prior written permission from the City of Ann Arbor.

This map complies with National Map Accuracy Standards for mapping at 1 inch = 100 Feet. The City of Ann Arbor and its mapping contractors assume no legal representation for the content and/or inappropriate use of information on this map.