

MEMORANDUM

TO : «DepartmentEmail»
FROM : Jacqueline Beaudry, City Clerk
SUBJECT : COMPLETED ANNEXATIONS
DATE : November 29, 2011

The City Clerk's Office received notice from the Secretary of State's Office of the following completed annexations from Scio Township:

1. Andres Property, 0.3 acre, located at 305 Pinewood St. (City File Nos. A11-008 and Z11-008);
2. ~~Ellis Property, 1.13 acres, located at 3313 Dexter Road (City File Nos. A11-007 and Z11-007);~~
3. French Property, 0.2 acre, located at 3225 Dexter Road (City File Nos. A11-005 and Z11-005);
4. Morris Property, 0.2 acre, located at 427 Barber Ave. (City File Nos. A11-004 and Z11-004);
5. Skelley Property, 0.3 acre, located at 545 Allison Dr. (City File Nos. A11-003 and Z11-003) and
6. Zummer Property, 0.4 acre, located at 3249 Dexter Road (City File Nos. A11-006 and Z11-006).

JB/aa

Attachments

cc: All Departments



STATE OF MICHIGAN
RUTH JOHNSON, SECRETARY OF STATE
DEPARTMENT OF STATE
LANSING

CITY OF ANN ARBOR
CITY CLERK
REC'D

2011 NOV 18 PM 8:06

November 8, 2011

Jacqueline Beaudry
City of Ann Arbor
100 North Fifth Avenue
PO Box 8647
Ann Arbor, MI 48107

RE: Annexation of property - *French Property/3225 Dexter Rd.*

Dear Ms. Beaudry:

This letter serves to acknowledge the Office of the Great Seal's receipt on October 6, 2011 of the filing of the annexation pursuant to Public Act 279 of 1909, as amended, from Scio Township to the City of Ann Arbor. The receipt date is the effective date of this boundary change. This filing is designated as Job Number 11-026.

All property descriptions for any boundary changes are reviewed by the Michigan Department of Transportation (MDOT), and then published annually in the Michigan Public and Local Acts manual. If any property description is found inaccurate by MDOT, this office will contact you at that time and request a corrected description, which will not impact the effective date of the boundary change.

*****No further acknowledgment will be sent*****

Sincerely,

Michele Martin, Technician
Office of the Great Seal
517-241-1829

cc: Scio Township Clerk
Washtenaw County Clerk
Michigan Department of Labor and Economic Growth, State Boundary Commission
Michigan Department of Labor and Economic Growth, Liquor Control Commission
Michigan Department of Labor and Economic Growth, Office of Land Survey and Remonumentation
Michigan Department of Information Technology, Center for Geographic Information
Michigan Department of Treasury, Office of Revenue and Tax Analysis
Michigan Department of Transportation, Bureau of Transportation Planning
U.S. Bureau of the Census
Office of the Great Seal Job Number: 11-026

Cities
Washtenaw County

In the matter of the annexation of certain property located in Scio Township to the City of Ann Arbor. Annexed in accordance with the provisions of Public Act 279 of 1909, as amended the following described property:



Lot 143, The Evergreens, A Subdivision of Part of the South Half, Section 24, Scio Township, Washtenaw County, Michigan, according to the Plat thereof as recorded in Liber 7 of Plats, Page 42, Washtenaw County Records.

Scio Township 6 -Locaton Map-

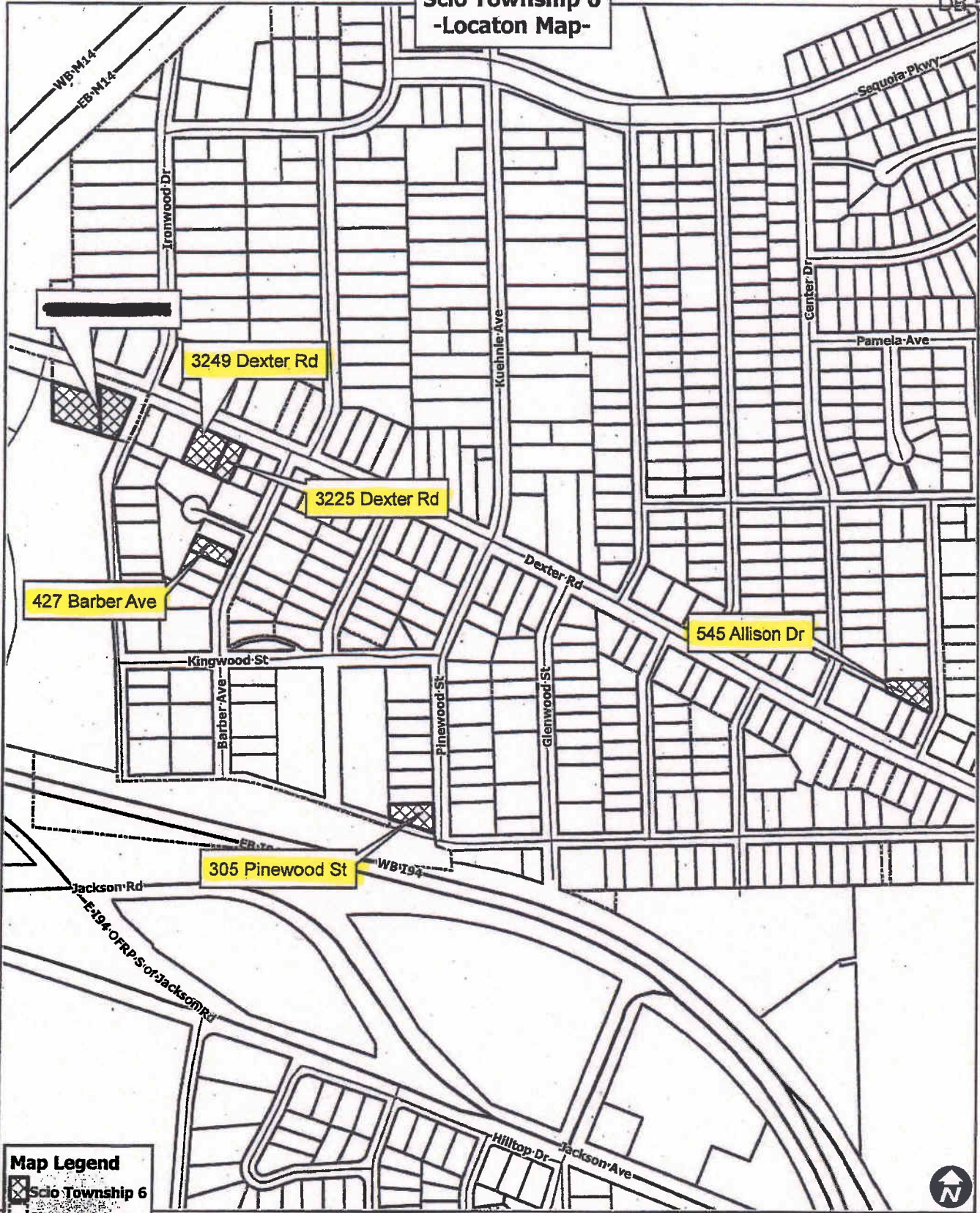
DB 5



Map Legend

-  Scio Township 6
-  City Boundary
-  Railroads
-  Parcel Property



City of Astoria Map Department:
 No part of this product shall be reproduced or transmitted in any form or by any means, electronic or mechanical, for any purpose, without prior written permission from the City of Astoria.
 This map complies with National Map Accuracy Standards for mapping at 1 inch = 120 Feet. The City of Astoria and its mapping contractors assume no responsibility for the content and/or inappropriate use of information on this map.
 Map Control: 6/24/2011