



STATE OF MICHIGAN  
RUTH JOHNSON, SECRETARY OF STATE  
DEPARTMENT OF STATE  
LANSING

June 10, 2015

2015 JUN 18 AM 9:07  
CITY OF ANN ARBOR  
CITY CLERK  
REC'D

Jacqueline Beaudry, City Clerk  
City of Ann Arbor  
301 E Huron Street, PO Box 8647  
Ann Arbor, MI 48107

RE: Annexation of Property - *NIXON FARM SOUTH 7-31*  
*2999 NIXON RD.*

Dear Ms. Beaudry:

This letter serves to acknowledge the Office of the Great Seal's receipt on May 8, 2015, of the filing of the annexation pursuant to Public Act 359 of 1947, as amended, from Ann Arbor Township to the City of Ann Arbor. The receipt date is the effective date of this boundary change. This filing is designated as Job Number 15-012.

All property descriptions for any boundary changes are reviewed by the Michigan Department of Transportation (MDOT), and then published annually in the Michigan Public and Local Acts manual. If any property description is found inaccurate by MDOT, this office will contact you at that time and request a corrected description, which will not impact the effective date of the boundary change.

\*\*\*\*\*No further acknowledgment will be sent\*\*\*\*\*

Sincerely,

Lucinda J. Shelton, Departmental Technician  
Bureau of Elections/Office of the Great Seal  
Telephone: (517)241-1832

- cc: Ann Arbor Township Clerk
- Washtenaw County Clerk
- Michigan Department of Labor and Economic Growth, State Boundary Commission
- Michigan Department of Labor and Economic Growth, Office of Land Survey and Remonumentation
- Michigan Department of Technology Management and Budget, Center for Shared Solutions & Technology Partnerships
- Michigan Department of Treasury, Office of Revenue and Tax Analysis
- Michigan Department of Transportation, Bureau of Transportation Planning
- U.S. Bureau of the Census

Office of the Great Seal Job Number: 15-012

Cities  
Washtenaw County

In the matter of the annexation of certain property located in Ann Arbor Township to the City of Ann Arbor. Annexed in accordance with the provisions of Public Act 359 of 1947, as amended the following described property:

BEGINNING at the North 1/4 corner of Section 15, T2S, R6E, Ann Arbor Township, Washtenaw County, Michigan; thence N88°16'54"E 1316.90 feet along the centerline of Dhu Varren Road (66 feet wide) and the North line of said Section 15; thence S01°36'10"E 1353.65 feet along the centerline of Nixon Road (variable width) and the East line of the Northwest 1/4 of the Northeast 1/4 of said Section 15, as monumented; thence S88°24'03"W 1315.77 feet along the South line of the Northwest 1/4 of the Northeast 1/4 of said Section 15, as monumented; thence N01°39'01"W (recorded as N01°11'07"W) 1350.91 feet along the North-South 1/4 line of said Section 15 and along the East line of Traver Lakes Subdivision No.1, recorded in Liber 20 of plats, page 33, Washtenaw County Records and along the East line of Traver Vistas Subdivision, recorded in Liber 22 of plats, page 79, Washtenaw County Records and along the East line of Fox Ridge Commons Condominium, Washtenaw County Condominium Subdivision Plan No. 176 to the Place of Beginning, being a part of the Northeast 1/4 of said Section 15 and containing 40.864 acres of land, more or less. Being subject to the rights of the public over the Easterly 33 feet thereof as occupied by said Nixon Road, also subject to the rights of the public over the Northerly 33 feet thereof as occupied by said Dhu Varren Road, also being subject to easements, conditions, restrictions and exceptions of record, if any.



## CITY OF ANN ARBOR, MICHIGAN

301 E Huron Street, P.O. Box 8647, Ann Arbor, Michigan 48107-8647

Phone (734)794-6140 Fax (734)994-8296

www.a2gov.org

City Clerk

May 5, 2015

Lucinda J. Sheltroun, Dept. Technician  
Office of the Great Seal  
Michigan Department of State  
717 Allegan St.  
Lansing, MI 48918-1750

RECEIVED/FILED  
MICHIGAN DEPT OF STATE  
2015 MAY -8 PM 2:53  
OFFICE OF THE GREAT SEAL

Re: 2 Annexations from Ann Arbor Township

Dear Ms. Sheltroun:

Enclosed are certified copies of two annexation resolutions adopted by the Ann Arbor City Council at its regular session of November 6, 2014 and December 1, 2014. Submitted with the City resolutions are copies of the township resolution and the petition for each annexation, both containing property descriptions. The properties are listed as follows:

1. Nixon Farm North property, 69 acres, located at 3381 Nixon Road. (City Annexation File Nos. A14-006 and Z14-023, SP14-042 and WUP14-002);
2. Nixon Farm South property, 41 acres, located at 2999 Nixon Road. (City Annexation File No. A14-007, Z14-024 and SP14-041 and WUP14-001).

Sincerely,

Jacqueline Beaudry  
City Clerk

JB/ab

Enclosures

cc: Lawrence Kestenbaum, Washtenaw County Clerk/Register  
State/County Annexation.



# City of Ann Arbor

15-012

301 E. Huron St.  
Ann Arbor, MI 48104  
<http://a2gov.legistar.com/Calendar.aspx>

## Certified Copy

Resolution/Public Hearing: R-15-083

**File Number: 14-1573**

**Enactment Number: R-15-083**

Resolution to Approve the Nixon Farm South Annexation, 41 Acres, 2999 Nixon Road (CPC Recommendation: Approval - 8 Yeas and 0 Nays)

Whereas, The territory hereinafter described is located in the Township of Ann Arbor and is adjacent to the corporate limits of the City of Ann Arbor;

Whereas, Betty N. Spurway Trust is the owner of said property; and

Whereas, It is the desire of Toll Brothers, Inc. to annex said territory to the City of Ann Arbor, pursuant to the provisions of Act 359 of the Public Acts of the State of Michigan, as amended;

RESOLVED, That the following described lands and premises situated and being in the Township of Ann Arbor, Washtenaw County, Michigan, be detached from said Township and annexed to the City of Ann Arbor, to-wit:

BEGINNING at the North 1/4 corner of Section 15, T2S, R6E, Ann Arbor Township, Washtenaw County, Michigan; thence N88°16'54"E 1316.90 feet along the centerline of Dhu Varren Road (66 feet wide) and the North line of said Section 15; thence S01°36'10"E 1353.65 feet along the centerline of Nixon Road (variable width) and the East line of the Northwest 1/4 of the Northeast 1/4 of said Section 15, as monumented; thence S88°24'03"W 1315.77 feet along the South line of the Northwest 1/4 of the Northeast 1/4 of said Section 15, as monumented; thence N01°39'01"W (recorded as N01°11'07"W) 1350.91 feet along the North-South 1/4 line of said Section 15 and along the East line of Traver Lakes Subdivision No.1, recorded in Liber 20 of plats, page 33, Washtenaw County Records and along the East line of Traver Vistas Subdivision, recorded in Liber 22 of plats, page 79, Washtenaw County Records and along the East line of Fox Ridge Commons Condominium, Washtenaw County Condominium Subdivision Plan No. 176 to the Place of Beginning, being a part of the Northeast 1/4 of said Section 15 and containing 40.864 acres of land, more or less. Being subject to the rights of the public over the Easterly 33 feet thereof as occupied by said Nixon Road, also subject to the rights of the public over the Northerly 33 feet thereof as occupied by said Dhu Varren Road, also being subject to easements, conditions, restrictions and exceptions of record, if any.

# Nixon Rd and Dhu Varren Rd -Zoning Map-

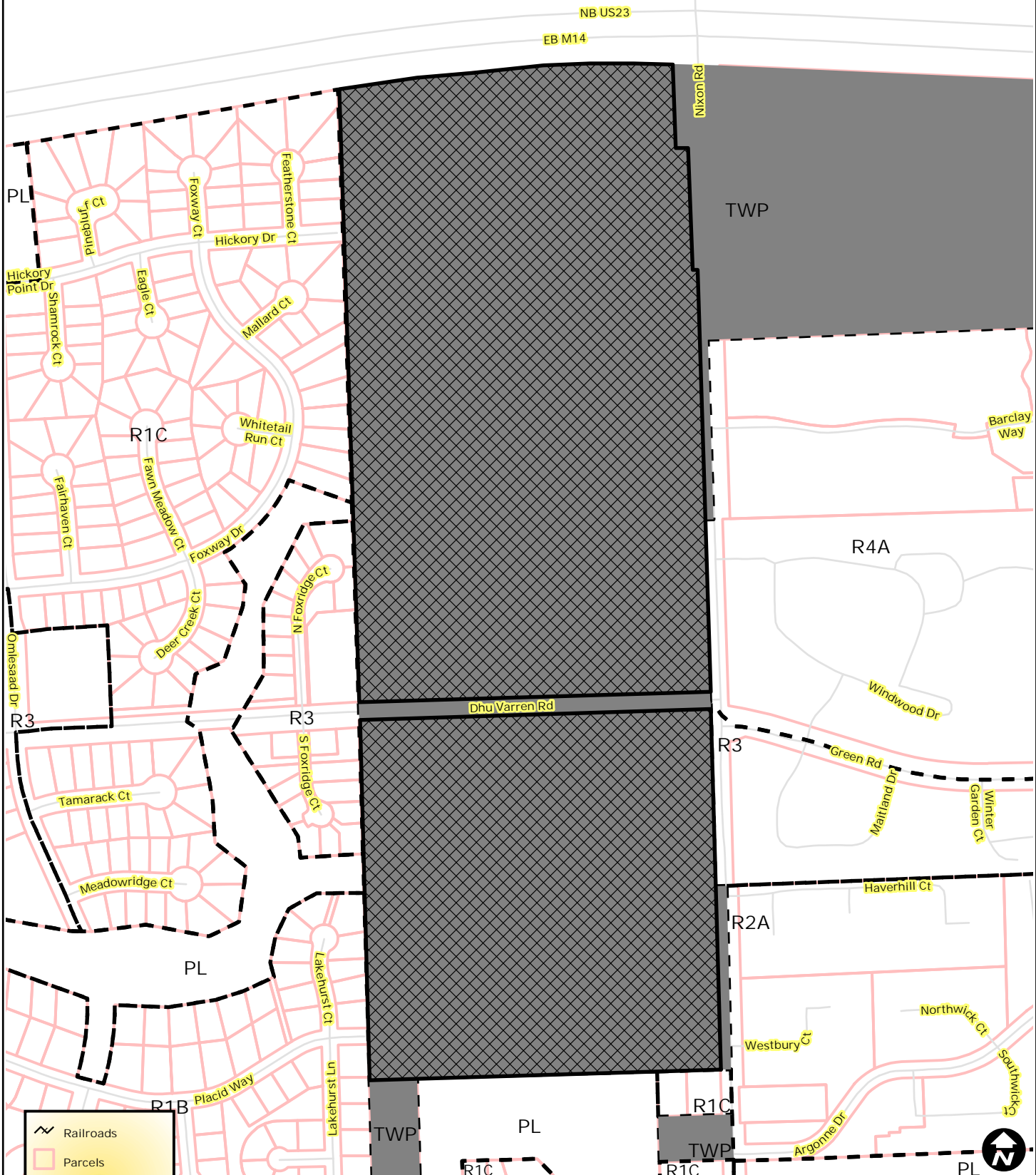

- Railroads
- Parcels
- Zoning**
- Township Islands
- Zoning Districts



City of Ann Arbor Map Disclaimer:  
No part of this product shall be reproduced or transmitted in any form or by any means, electronic or mechanical, for any purpose, without prior written permission from the City of Ann Arbor.  
This map complies with National Map Accuracy Standards for mapping at 1 inch = 100 Feet. The City of Ann Arbor and its mapping contractors assume no legal representation for the content and/or inappropriate use of information on this map.  
Map Created: 6/6/2014

**ANN ARBOR CHARTER TOWNSHIP  
RESOLUTION TO APPROVE ANNEXATION**

**WHEREAS**, the territory described is located in Ann Arbor Township within the area to be annexed to the city of Ann Arbor under the 1994 Policy Statement between the City of Ann Arbor and Ann Arbor Township, and

**WHEREAS**, a petition to annex said territory to the City of Ann Arbor, signed by persons or entities who collectively hold record legal title to all of the land in said territory, has been filed with the Township Board, and requests annexation to the City for the purpose of connecting to city utilities, and

**WHEREAS**, there are no qualified electors residing in said the territories, based on the petitions, and

**WHEREAS**, petitioner Toll Brothers, Inc. has filed a petition on behalf of owner: Betty N. Spurway Trust

**NOW, BE IT RESOLVED**, that the following described lands and premises situated and being in Ann Arbor Charter Township, Washtenaw County, Michigan, be again released from the Township in order to be annexed to the City of Ann Arbor, to-wit:

Parcel ID# I -09-15-150-001 (2999 Nixon Road) SOUTH

\*OLD SID - I 09-015-002-00 15-2 NW 1/4 OF NE 1/4 SEC. 15 T2SR6E 40.00 AC.

Parcel ID# I -09-15-150-001 may also be described, to-wit:

BEGINNING at the North 1/4 corner of Section 15, T2S, R6E, Ann Arbor Township, Washtenaw County, Michigan; thence N88°16'54"E 1316.90 feet along the centerline of Dhu Varren Road (66 feet wide) and the North line of said Section 15; thence S01°36'10"E 1353.65 feet along the centerline of Nixon Road (variable width) and the East line of the Northwest 1/4 of the Northeast 1/4 of said Section 15, as monumented; thence S88°24'03"W 1315.77 feet along the South line of the Northwest 1/4 of the Northeast 1/4 of said Section 15, as monumented; thence N01°39'01"W (recorded as N01°11'07"W) 1350.91 feet along the North-South 1/4 line of said Section 15 and along the East line of Traver Lakes Subdivision No.1, recorded in Liber 20 of plats, page 33, Washtenaw County Records and along the East line of Traver Vistas Subdivision, recorded in Liber 22 of plats, page 79, Washtenaw County Records and along the East line of Fox Ridge Commons Condominium, Washtenaw County Condominium Subdivision Plan No. 176 to the Place of Beginning, being a part of the Northeast 1/4 of said Section 15 and containing 40.864 acres of land, more or less. Being subject to the rights of the public over the Easterly 33 feet thereof as occupied by said Nixon Road, also subject to the rights of the public over the Northerly 33 feet thereof as occupied by said Dhu Varren Road, also being subject to easements, conditions, restrictions and exceptions of record, if any.

I hereby certify that the foregoing constitutes a true and complete copy of a resolution adopted by the Board of Ann Arbor Charter Township, Washtenaw County, Michigan, at its regular meeting held on April 20, 2015.



Rena H. Basch, Clerk  
Ann Arbor Township

April 28, 2015





**City of Ann Arbor**  
**PLANNING & DEVELOPMENT SERVICES — PLANNING DIVISION**

301 East Huron Street P.O. Box 8647 Ann Arbor, Michigan 48107-8647  
p 734.794.6265 f 734.994.8312 planning@a2gov.org

**PETITION FOR ANNEXATION BY RELEASE**

The Planning Department would like to take this opportunity to welcome you as a member of our community. Annexation to the City will provide you with the same benefits available to Ann Arbor Citizens. These benefits include fire and police protection, use of City parks; refuse pick-up and recycling services, eligibility for City water and sewer lines, and participation on City boards and commissions. We are looking forward to your involvement in our community and hope that you will enjoy the many advantages the City of Ann Arbor has to offer.

To: The **TOWNSHIP BOARD OF ANN ARBOR CHARTER TOWNSHIP**, Washtenaw County, Michigan and the City Council of the City of Ann Arbor, Michigan.

We, the undersigned, respectfully petition your honorable bodies that the following described land be detached from the **ANN ARBOR CHARTER TOWNSHIP** and annexed to the City of Ann Arbor by affirmative majority vote of the Ann Arbor City Council and approval of the **ANN ARBOR CHARTER TOWNSHIP BOARD**, in accordance with the provisions of Public Act 359 of 1947, State of Michigan, **AS AMENDED**.

The land proposed to be detached from the **ANN ARBOR CHARTER TOWNSHIP** and annexed to the City of Ann Arbor is described as follows, to wit: *(legal description)*

See Attachment

Property Tax I.D. #  
I-90-15-150-001

We further represent as follows:

- 1) That the above described land is contiguous to the corporate limits of the City of Ann Arbor, Michigan, or within an area being served by said City.
- 2) That there are no qualified electors residing on the land proposed to be annexed other than the petitioners.
- 3) That the petitioner(s), Toll Bros., Inc., is/are the option to purchase (owner, land contract, option to purchase) of the land proposed to be annexed.

11x44 FARM SOUTH

DESCRIPTION OF A 40.864 ACRE PARCEL OF LAND LOCATED IN THE NORTHEAST 1/4 OF SECTION 15, T2S, R6E, ANN ARBOR TOWNSHIP, WASHTENAW COUNTY, MICHIGAN (AS SURVEYED BY ATWELL)

BEGINNING at the North 1/4 corner of Section 15, T2S, R6E, Ann Arbor Township, Washtenaw County, Michigan; thence N88°16'54"E 1316.90 feet along the centerline of Dhu Varren Road (66 feet wide) and the North line of said Section 15; thence S01°36'10"E 1353.65 feet along the centerline of Nixon Road (variable width) and the East line of the Northwest 1/4 of the Northeast 1/4 of said Section 15, as monumented; thence S88°24'03"W 1315.77 feet along the South line of the Northwest 1/4 of the Northeast 1/4 of said Section 15, as monumented; thence N01°39'01"W (recorded as N01°11'07"W) 1350.91 feet along the North-South 1/4 line of said Section 15 and along the East line of Traver Lakes Subdivision No.1, recorded in Liber 20 of plats, page 33, Washtenaw County Records and along the East line of Traver Vistas Subdivision, recorded in Liber 22 of plats, page 79, Washtenaw County Records and along the East line of Fox Ridge Commons Condominium, Washtenaw County Condominium Subdivision Plan No. 176 to the Place of Beginning, being a part of the Northeast 1/4 of said Section 15 and containing 40.864 acres of land, more or less. Being subject to the rights of the public over the Easterly 33 feet thereof as occupied by said Nixon Road, also subject to the rights of the public over the Northerly 33 feet thereof as occupied by said Dhu Varren Road, also being subject to easements, conditions, restrictions and exceptions of record, if any.

SOUTH  
NIXON FARM ~~ROAD~~