

Location Map: Glacier Highlands Park Rezoning

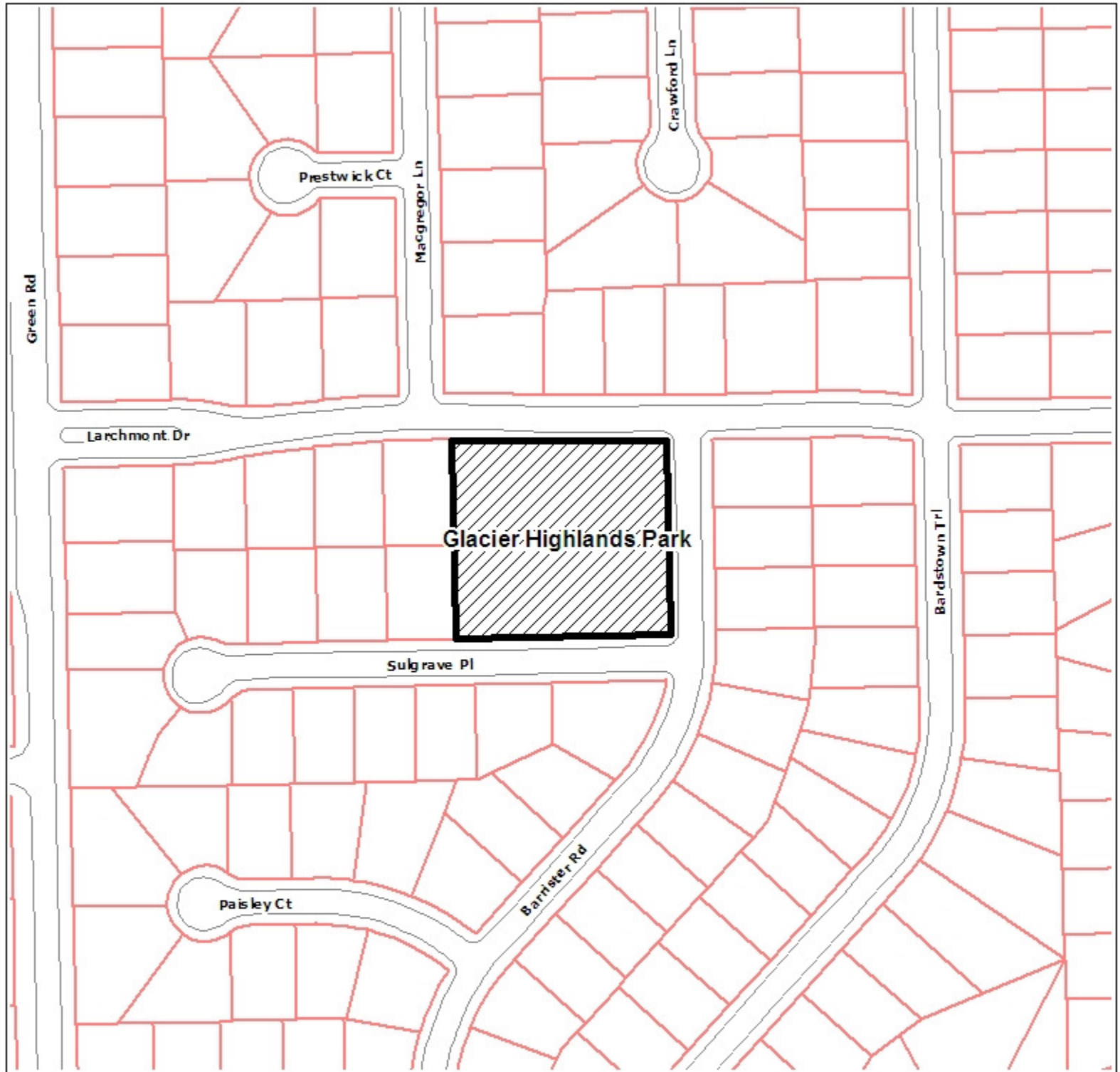

Map Legend

- Parcels
- Edge Of Pavement
- Railroads

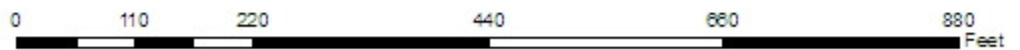

Maps available online:
<http://gisweb.ewashtenaw.org/website/mapwashtenaw/>

Copyright 2008 City of Ann Arbor, Michigan

No part of this product shall be reproduced or transmitted in any form or by any means, electronic or mechanical, for any purpose, without prior written permission from the City of Ann Arbor.

This map complies with National Map Accuracy Standards for mapping at 1:25,000 scale (1 inch = 100 feet). The City of Ann Arbor and its mapping contractors assume no legal responsibility for the content and/or inappropriate use of information on this map.

Location Map: Berkshire Creek Nature Area and Malletts Creek Nature Area Rezoning

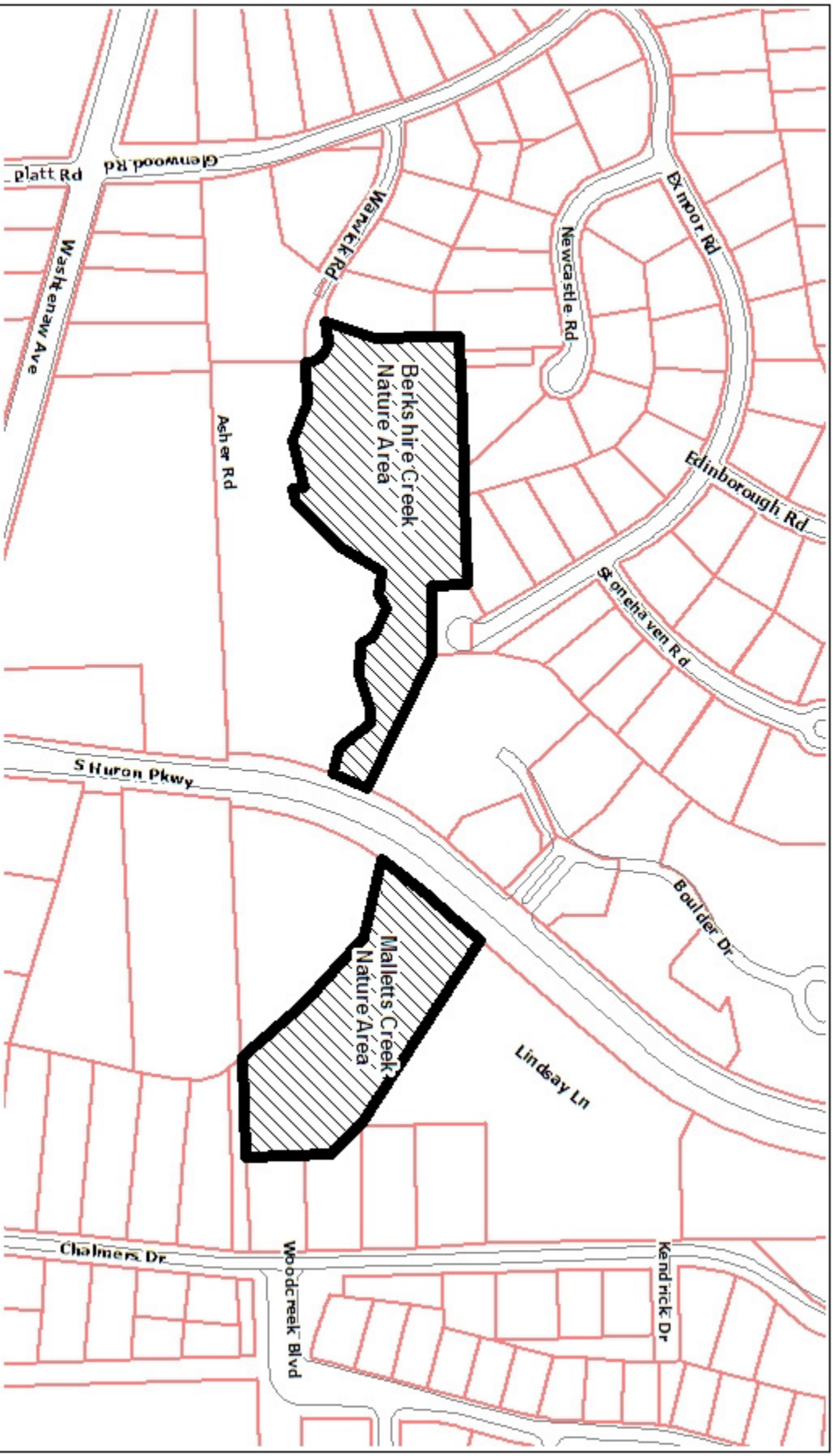

Map Legend

- Parcels
- Edge Of Pavement
- Railroads

Maps available online:
<http://gisweb.washburn.edu/website/imap/washburn/>

Copyright 2012 City of Ash Grove, Oregon
 This map is a product that has been produced or reproduced in any form or by any means, electronic or mechanical, for any purpose, without prior written permission from the City of Ash Grove.
 This map complies with National Map Accuracy Standards for mapping at 1:2500 = 1:20 Feet. The City of Ash Grove and its mapping contractors assume no legal responsibility for the accuracy and/or appropriateness of information on this map.

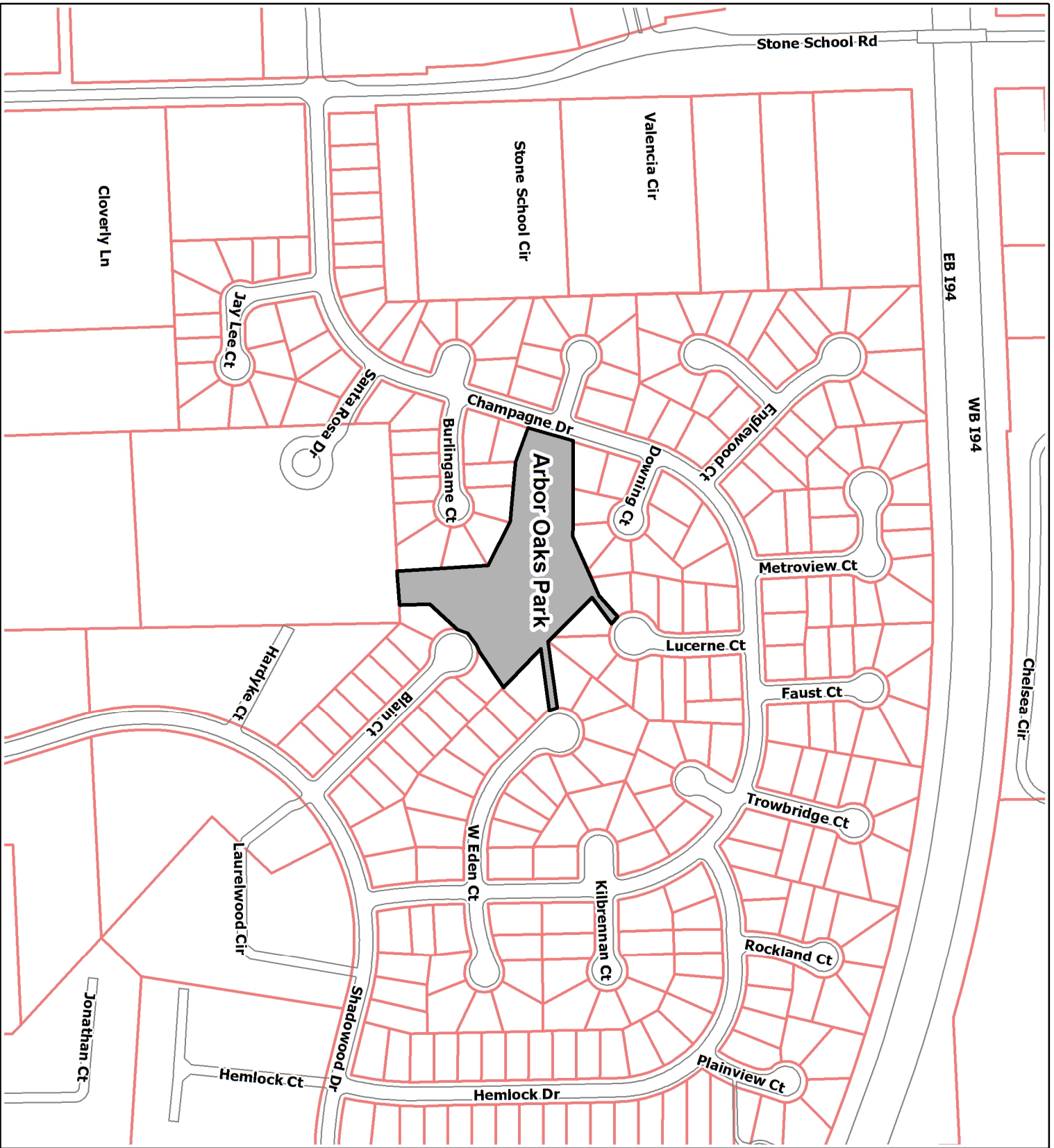

Location Map:

Arbor Oaks Park

Map Legend

-  Edge Of Pavement
-  Parcels



Copyright 2008 City of Ann Arbor, Michigan

No part of this product shall be reproduced or transmitted in any form or by any means, electronic or mechanical, for any purpose, without prior written permission from the City of Ann Arbor.

This map complies with National Map Accuracy Standards for mapping at 1 inch = 100 Feet. The City of Ann Arbor and its mapping contractors assume no legal representation for the content and/or inappropriate use of information on this map.

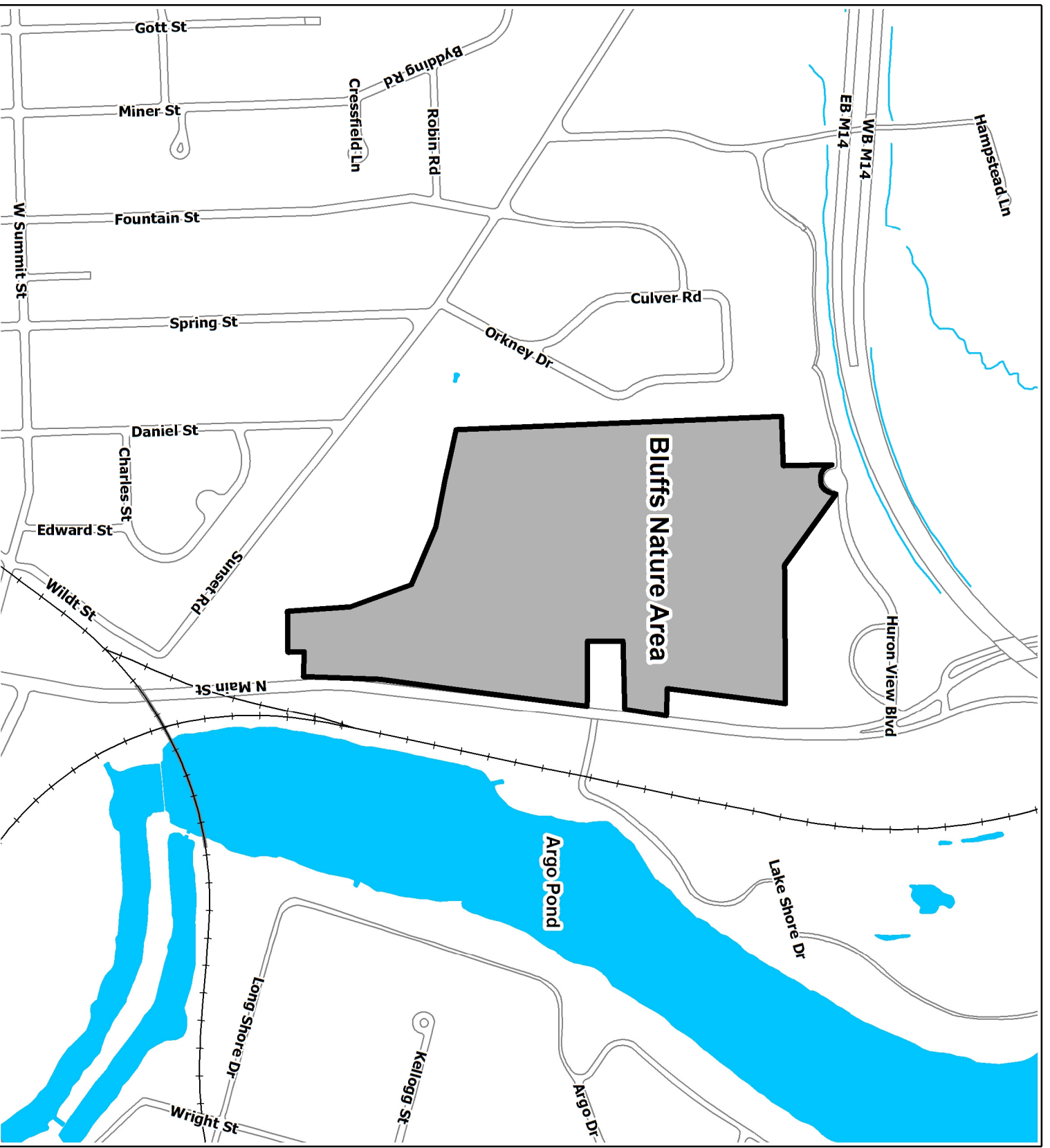

Location Map:

Bluffs Nature Area

Map Legend

-  Railroads
-  Edge Of Pavement
-  City Hydro Poly



Copyright 2008 City of Ann Arbor, Michigan
 No part of this product shall be reproduced or transmitted in any form or by any means, electronic or mechanical, for any purpose, without prior written permission from the City of Ann Arbor.
 This map complies with National Map Accuracy Standards for mapping at 1 inch = 100 Feet. The City of Ann Arbor and its mapping contractors assume no legal representation for the content and/or inappropriate use of information on this map.