

Copyright 2010. All rights reserved. No part of this document may be reproduced in any form or by any means without permission from Walker Parking Consultants/Engineers, Inc.

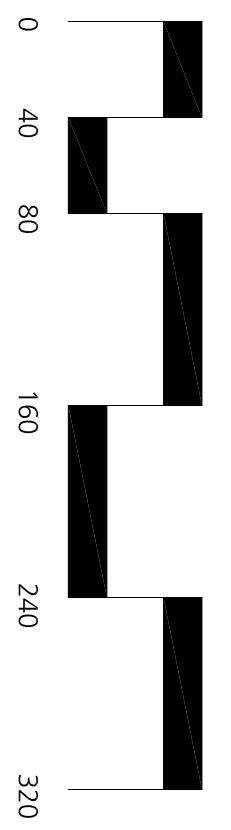
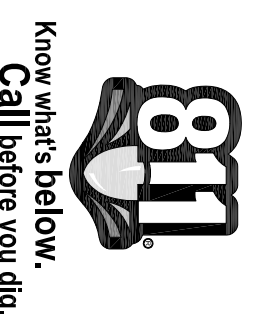

WPC PROJECT NO: 20-1092.00	
U of M PROJECT NO: P00003570	
DRAWN BY: B08/AH	CHECKED BY: B08
SHEET TITLE: OVERALL ILLUSTRATIVE SITE PLAN	
C-010	
DATE	DESCRIPTION
08/25/10	CITY OF ANN ARBOR SITE PLAN - REV.
08/04/10	DESIGN DEVELOPMENT
08/02/10	CITY OF ANN ARBOR SITE PLAN
05/18/10	SCHEMATIC DESIGN
MARK	ISSUE: City of Ann Arbor Site Plan

FULLER ROAD STATION PHASE 1

ANN ARBOR MICHIGAN

Beckett & Raeder
 Landscape Architecture
 Planning, Engineering &
 Environmental Services
 525 West William, Suite 101
 Ann Arbor, MI 48103
 734.663.2622

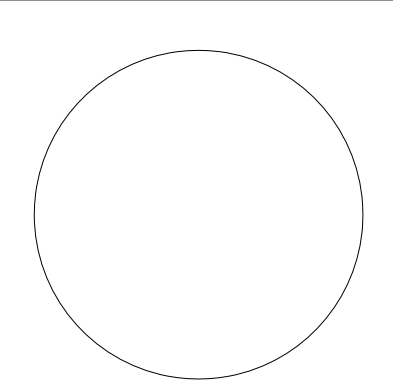

WALKER
 PARKING CONSULTANTS
 525 Avis Drive
 Suite 1
 Ann Arbor, MI 48108
 734.663.1070 Ph
 734.663.1717 Fax
 www.walkerparking.com

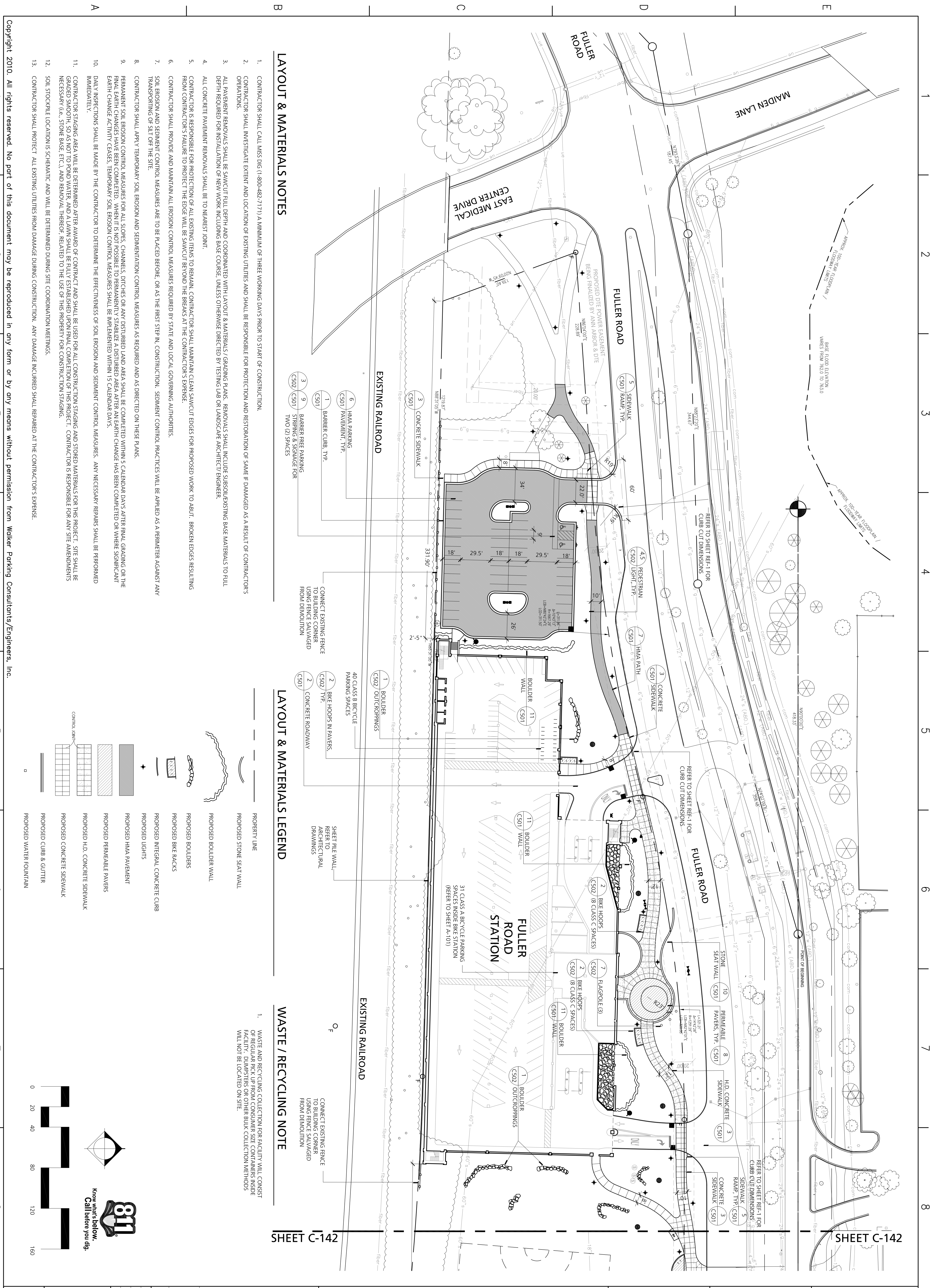

- LAYOUT & MATERIALS NOTES**
1. CONTRACTOR SHALL CALL MISS DIG (1-800-482-7171) A MINIMUM OF THREE WORKING DAYS PRIOR TO START OF CONSTRUCTION.
 2. CONTRACTOR SHALL INVESTIGATE EXTENT AND LOCATION OF EXISTING UTILITIES AND SHALL BE RESPONSIBLE FOR PROTECTION AND RESTORATION OF SAME IF DAMAGED AS A RESULT OF CONTRACTOR'S OPERATIONS.
 3. ALL PAVEMENT REMOVALS SHALL BE SAWCUT FULL DEPTH AND COORDINATED WITH LAYOUT & MATERIALS / GRADING PLANS. REMOVALS SHALL INCLUDE SUBSOIL/EXISTING BASE MATERIALS TO FULL DEPTH REQUIRED FOR INSTALLATION OF NEW WORK INCLUDING BASE COURSE, UNLESS OTHERWISE DIRECTED BY TESTING LAB OR LANDSCAPE ARCHITECT/ENGINEER.
 4. ALL CONCRETE PAVEMENT REMOVALS SHALL BE TO NEAREST JOINT.
 5. CONTRACTOR IS RESPONSIBLE FOR PROTECTION OF ALL EXISTING TREES TO REMAIN. CONTRACTOR SHALL MAINTAIN CLEAN SAWCUT EDGES FOR PROPOSED WORK TO ABUT. BROKEN EDGES RESULTING FROM CONTRACTOR'S FAILURE TO PROTECT THE EDGE WILL BE SAWCUT BEYOND THE BREAKS AT THE CONTRACTOR'S EXPENSE.
 6. CONTRACTOR SHALL PROVIDE AND MAINTAIN ALL EROSION CONTROL MEASURES REQUIRED BY STATE AND LOCAL GOVERNING AUTHORITIES.
 7. SOIL EROSION AND SEDIMENT CONTROL MEASURES ARE TO BE PLACED BEFORE, OR AS THE FIRST STEP IN, CONSTRUCTION. SEDIMENT CONTROL PRACTICES WILL BE APPLIED AS A PERMETER AGAINST ANY TRANSPORTING OF SILT OFF THE SITE.
 8. CONTRACTOR SHALL APPLY TEMPORARY SOIL EROSION AND SEDIMENTATION CONTROL MEASURES AS REQUIRED AND AS DIRECTED ON THESE PLANS.
 9. PERMANENT SOIL EROSION CONTROL MEASURES FOR ALL SLOPES, CHANNELS, DITCHES OR ANY DISTURBED LAND AREA SHALL BE COMPLETED WITHIN 5 CALENDAR DAYS AFTER FINAL GRADING OR THE FIRST SIGNIFICANT EARTH CHANGE OCCURS. POSSIBLE PERMANENT EROSION CONTROL MEASURES TO BE COMPLETED ON OTHER SIGNIFICANT EARTH CHANGE ACTIVITY CASES. TEMPORARY SOIL EROSION CONTROL MEASURES SHALL BE IMPLEMENTED WITHIN 15 CALENDAR DAYS.
 10. DAILY INSPECTIONS SHALL BE MADE BY THE CONTRACTOR TO DETERMINE THE EFFECTIVENESS OF SOIL EROSION AND SEDIMENT CONTROL MEASURES. ANY NECESSARY REPAIRS SHALL BE PERFORMED IMMEDIATELY.
 11. CONTRACTOR STAGING AREA WILL BE DETERMINED AFTER AWARD OF CONTRACT AND SHALL BE USED FOR ALL CONSTRUCTION STAGING AND STORED MATERIALS FOR THIS PROJECT. SITE SHALL BE GRADED SMOOTH, SO AS NOT TO POND WATER, AND A LAWN SHALL BE FULLY ESTABLISHED UPON FINAL COMPLETION OF THIS PROJECT. CONTRACTOR IS RESPONSIBLE FOR ANY SITE AMENDMENTS NECESSARY (IE, STONE BASE, ETC.), AND REMOVAL THEREOF, RELATED TO THE USE OF THIS PROPERTY FOR CONSTRUCTION STAGING.
 12. SOIL STOCKPILE LOCATIONS IS SCHEMATIC AND WILL BE DETERMINED DURING SITE COORDINATION MEETINGS.
 13. CONTRACTOR SHALL PROTECT ALL EXISTING UTILITIES FROM DAMAGE DURING CONSTRUCTION. ANY DAMAGE INCURRED SHALL BE REPAIRED AT THE CONTRACTOR'S EXPENSE.

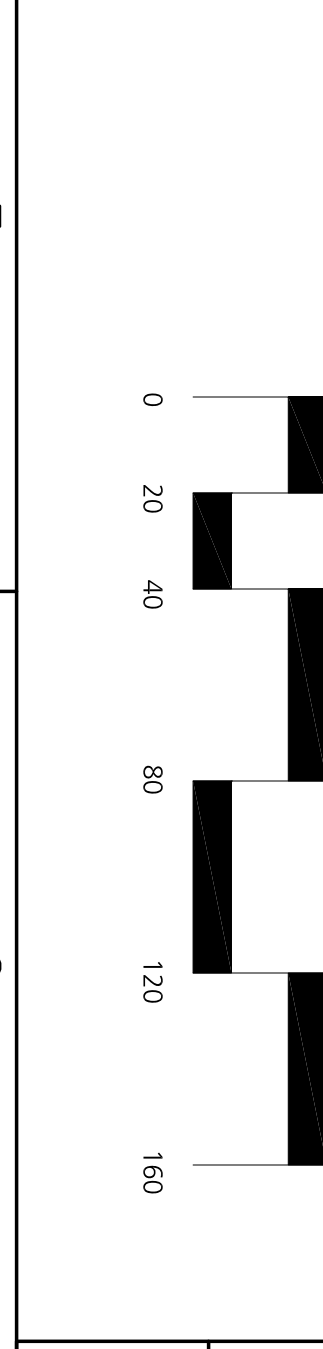
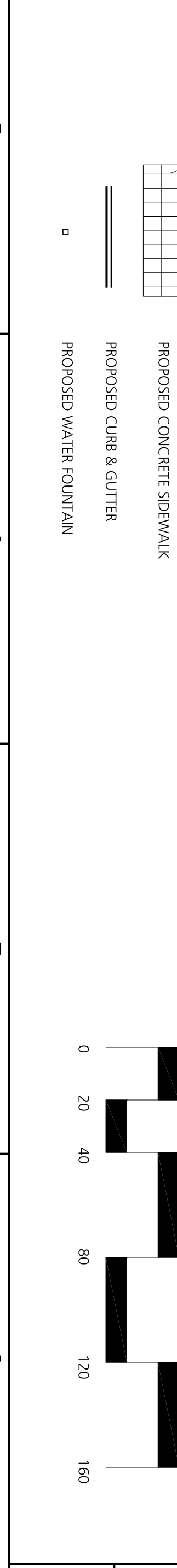

WALKER
PARKING CONSULTANTS
525 Avis Drive
Suite 1
Ann Arbor, MI 48108
734.663.1070 Ph
734.663.1717 Fax
www.walkerparking.com

Beckett & Raeder
Landscape Architecture
Planning, Engineering &
Environmental Services
535 West William, Suite 101
Ann Arbor, MI 48103
734.663.2622

ANN ARBOR **MICHIGAN**

FULLER ROAD STATION PHASE 1

MARK	DATE	DESCRIPTION
	08/25/10	CITY OF ANN ARBOR SITE PLAN - REV.
	08/04/10	DESIGN DEVELOPMENT
	08/02/10	CITY OF ANN ARBOR SITE PLAN
	05/18/10	SCHEMATIC DESIGN

WPC PROJECT NO.: 20-1092.00
U of M PROJECT NO.: P00003570
DRAWN BY: BBR/JH
CHECKED BY: BBR

LAYOUT & MATERIALS PLAN WEST

C-141

ISSUE: City of Ann Arbor Site Plan

Copyright 2010. All rights reserved. No part of this document may be reproduced in any form or by any means without permission from Walker Parking Consultants/Engineers, Inc.

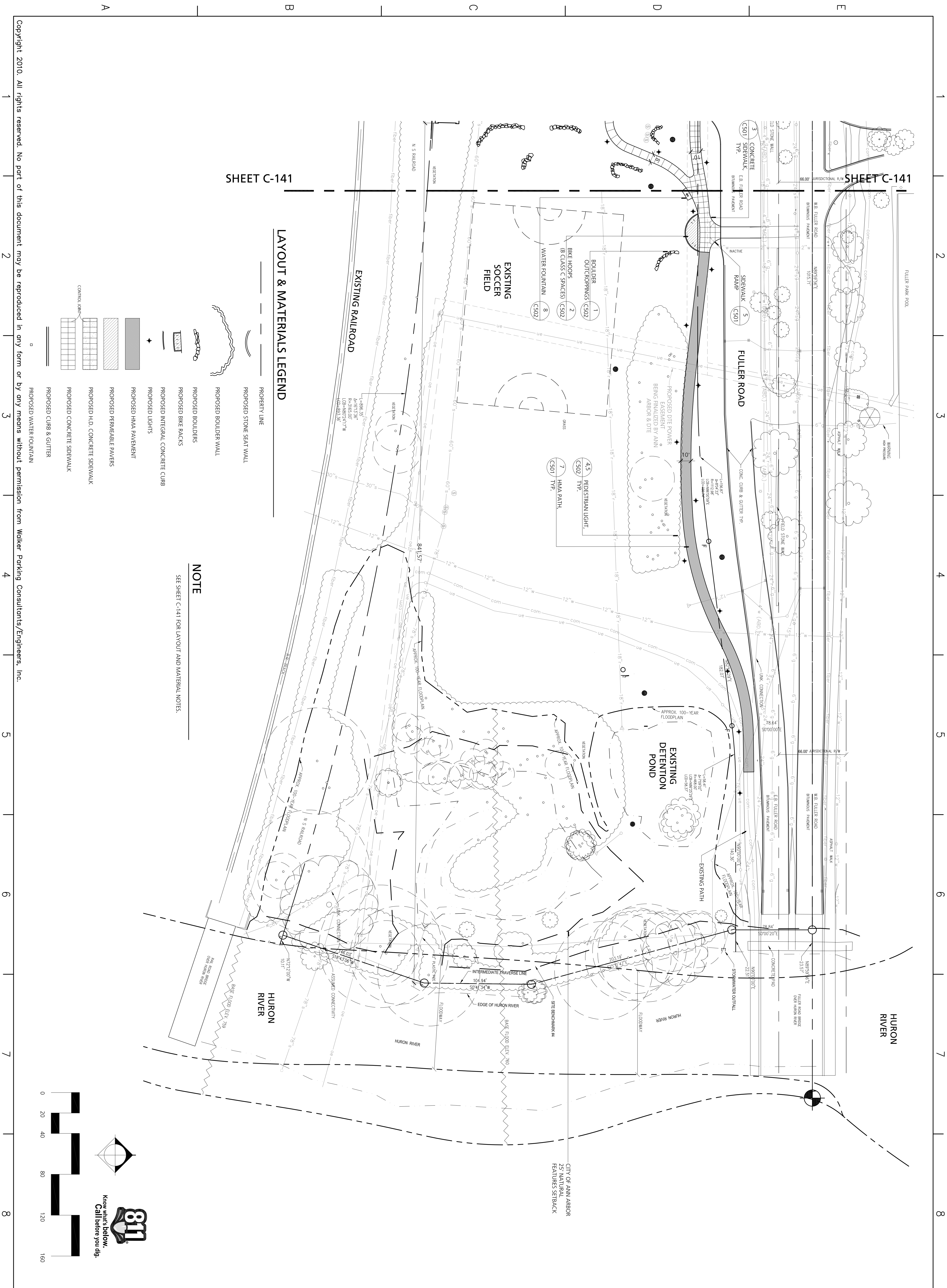

SHEET C-141

SHEET C-141

Copyright 2010. All rights reserved. No part of this document may be reproduced in any form or by any means without permission from Walker Parking Consultants/Engineers, Inc.

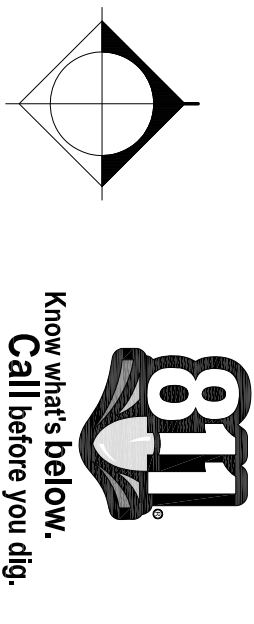

C-142
LAYOUT & MATERIALS PLAN EAST

MARK	DATE	DESCRIPTION
	08/25/10	CITY OF ANN ARBOR SITE PLAN - REV.
	08/04/10	DESIGN DEVELOPMENT
	08/02/10	CITY OF ANN ARBOR SITE PLAN
	05/18/10	SCHEMATIC DESIGN

WPC PROJECT NO.: 20-1092.00
U of M PROJECT NO.: P00003570
DRAWN BY: BDB/AH
CHECKED BY: BDB

FULLER ROAD STATION PHASE 1

ANN ARBOR MICHIGAN

Beckett & Raeder
Landscape Architecture
Planning, Engineering & Environmental Services
535 West Wilkum, Suite 101
Ann Arbor, MI 48103
734.663.2622

WALKER
PARKING CONSULTANTS
525 Avis Drive
Suite 1
Ann Arbor, MI 48108
734.663.1070 Ph
734.663.1717 Fax
www.walkerparking.com