



RICK SNYDER
GOVERNOR

STATE OF MICHIGAN
DEPARTMENT OF ENVIRONMENTAL QUALITY
JACKSON DISTRICT OFFICE



DAN WYANT
DIRECTOR

March 26, 2014

Mr. Tim Gruszczynski
Ann Arbor Public Schools
2555 South State Street
Ann Arbor, Michigan 48104

Dear Mr. Gruszczynski:

SUBJECT: Michigan Department of Environmental Quality (MDEQ)
Permit Number 10-81-0062-P
T3S, R6E, Section 14, City of Ann Arbor, Washtenaw County

We received your letter dated February 21, 2014, requesting a minor revision for work authorized by MDEQ Permit Number 10-81-0062-P.

This letter authorizes revision of your MDEQ Permit Number 10-81-0062-P to excavate approximately 22.2 cubic yards of material from .005 acre of wetland to widen and deepen the existing channel between Thurston Pond and its outlet. Remove approximately 862 cubic yards of material from approximately 0.24 acres of wetland and place approximately 107 cubic yards of the excavated material in wetland for Wetland Habitat Restoration and Enhancement. Remove approximately 228 cubic yards of material from wetland to construct a 0.03 acre sediment basin. Install a 16-inch diameter pipe through 50 linear feet of the outlet channel. All work shall be completed in accordance with the attached plans dated March 26, 2014.

You are reminded that all conditions as set forth in the original permit remain in full force. This letter must be attached to your permit and kept at the site of the work, available for inspection at all times during the duration of the project or until the date of expiration. This revision does not obviate the need for other federal, state, and/or local permits as may be required by law.

If you have any questions regarding this letter, please contact me at 517-416-7001; nelsonh1@michigan.gov; or MDEQ, Water Resources Division, Jackson District Office, 301 East Louis Glick Highway, Jackson Michigan, 49201-1535. Please include your Permit Number 10-81-0062-P in your response.

Sincerely,

Helana Nelson
Environmental Quality Analyst
Water Resources Division

Attachment

cc/att: City of Ann Arbor Clerk

2014 MAR 28 PM 5:01
CITY OF ANN ARBOR
CITY CLERK
REC'D

PERMITTEE SIGNATURE

DATE

SILT FENCING TO BE IN PLACE DURING RECONSTRUCTION OF BERM

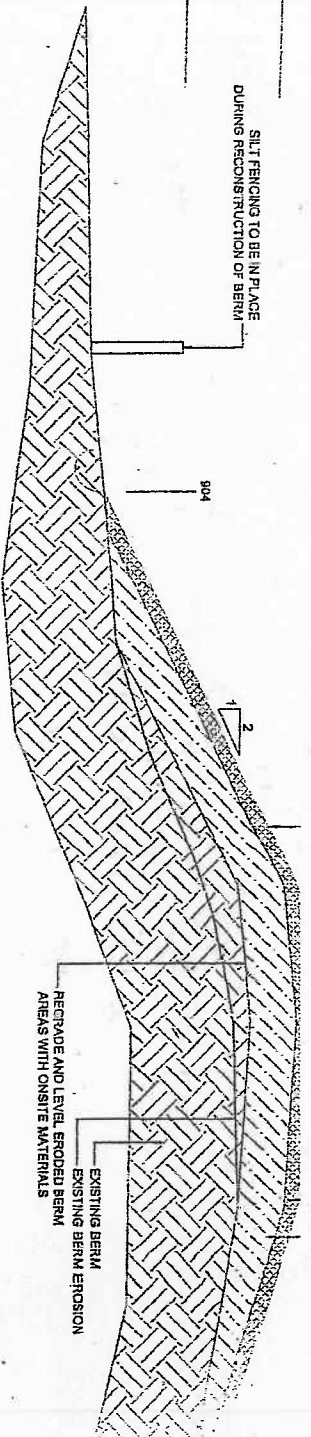

DEO-WRPD

FILE # 10-81-0062 P

APPROVED PLANS

PAGE 4 OF 5

12/16/10

DEO-WRPD

FILE # 10-81-0062

APPROVED PLANS

PAGE 1 OF 8

03/26/14

Revised

BERM MODIFICATIONS - SECTION A-A
NOT TO SCALE

INLET PROTECTION SCREEN (SILT SACKS TO BE IN PLACE DURING CONSTRUCTION)

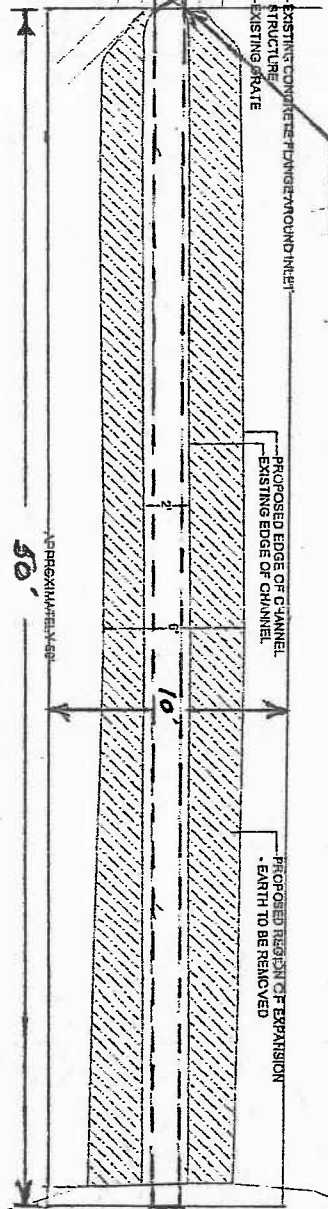

OUTLET CHANNEL MODIFICATIONS - PLAN
7/4" = 1' 0"
1/8" = 1' 0"

OUTLET
7/24" = 1' 0"
1/4" = 1'

BIG Overflow
Elevation 0.0

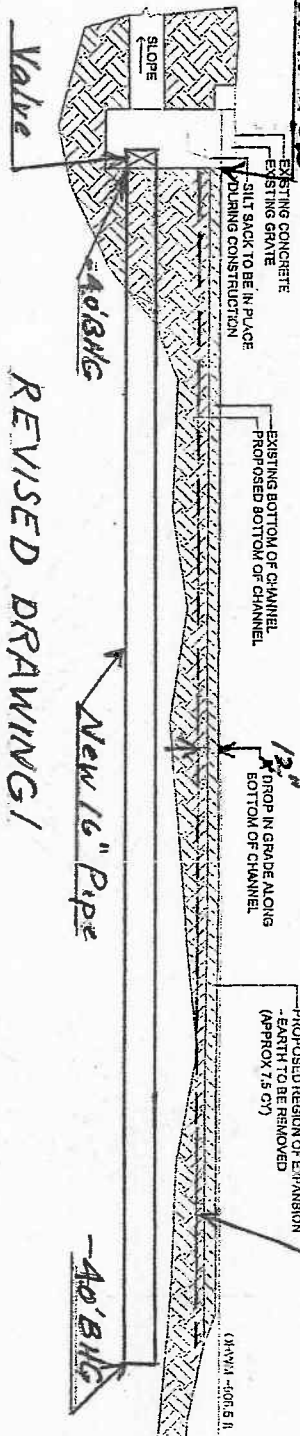

REVISED DRAWING 1

RECEIVED

OCT 19 2010

OUTLET CHANNEL MODIFICATIONS - SECTION B-B

7/8" = 1' 0"
1/8" = 1' 0"

SPILL
NOT 1'

DATE PLOTTED: 10/19/2010 11:48:23 AM

1" = 100'
3" x 10"

OUTLET CHANNEL AND SPILLWAY IMPROVEMENT - PLAN

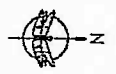
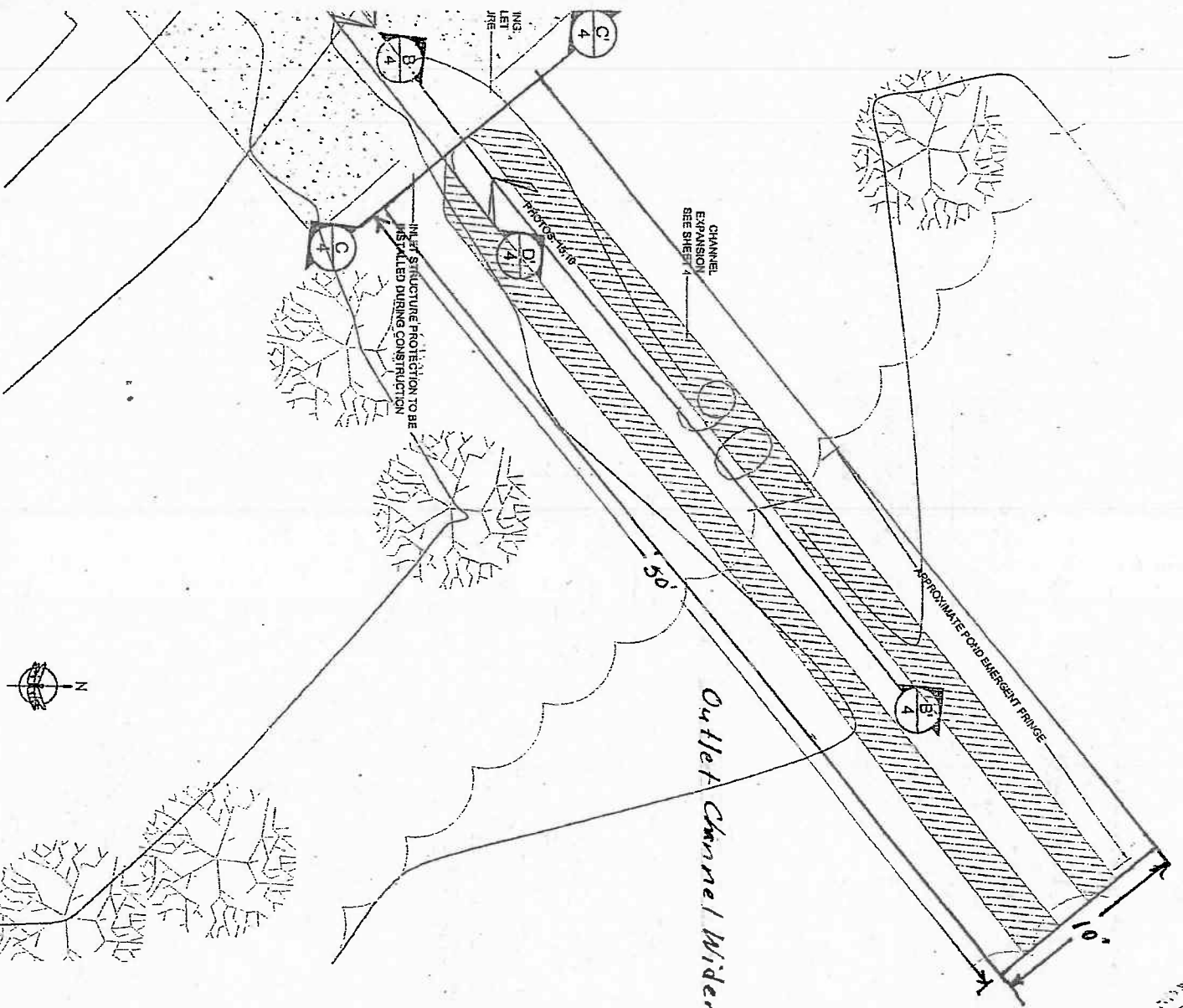

REVISED DRAWING 2

DEQ - WRPD

File # 10-81-0062 Revised

APPROVED PLANS

Page 2 of 8

03/26/14

DESIGNED BY: 10-81-0062

APPROVED PLANS

PAGE 3 OF 5

DATE 10/1/10

THURSTON POND IMPROVEMENT AREAS - PLAN

Sediment Retention Basin

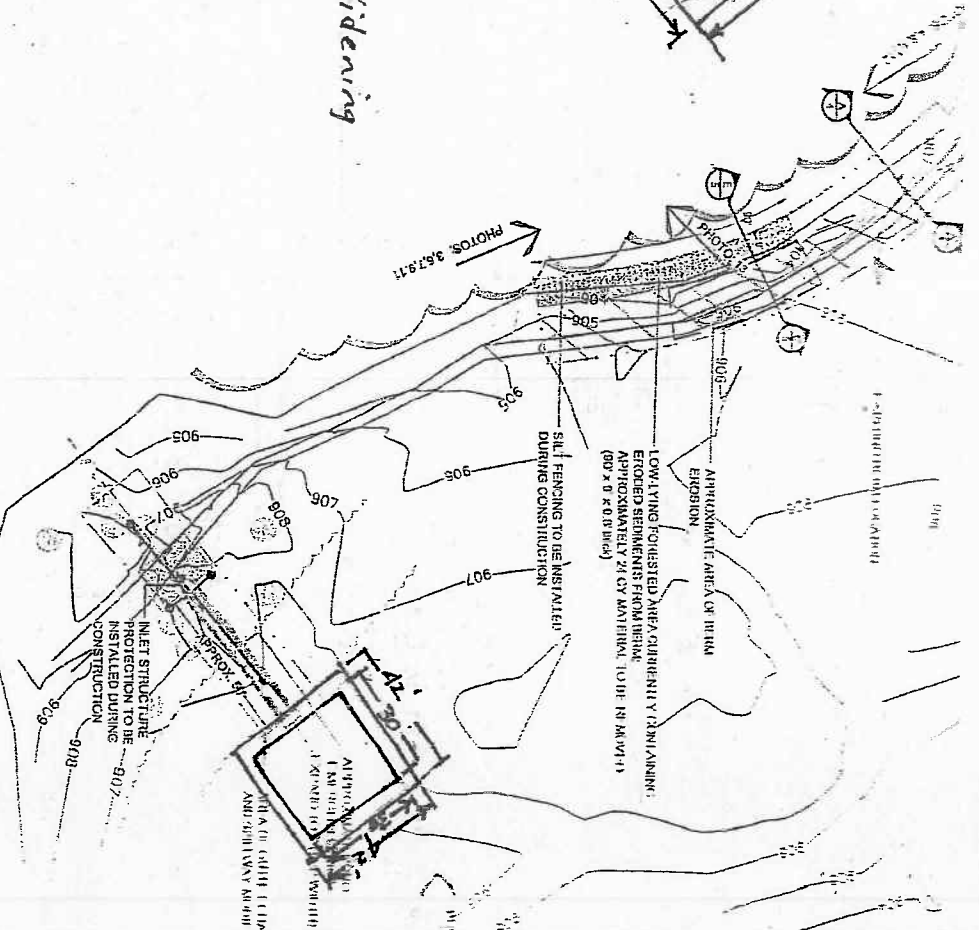

Bluett Rd.

Inlet from
Clague Middle
School

Area of Berm
Erosion and
Re-Construction

Existing Outlet
Structure and
Pipe to Millers
Creek

Sediment Retention Basin/16" Pipe Addition

THURSTON POND - EXISTING PLAN VIEW

1" = 30'
1" = 100'

REVISED DRAWING 3

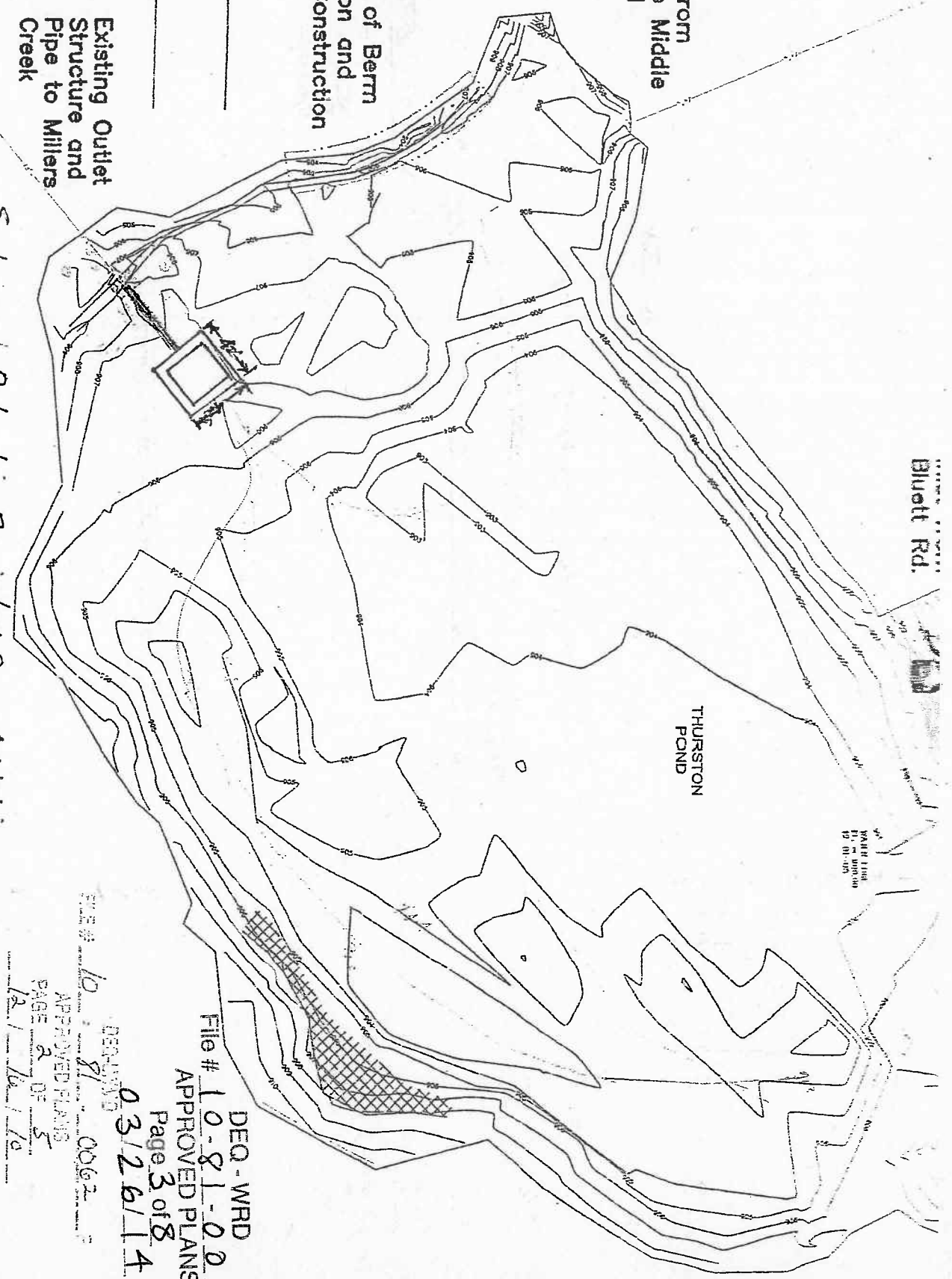

SIGNATURE

DATE

DEQ - WRD
File # 10-81-0062 revise

APPROVED PLANS
Page 3 of 8

03/26/14

DESIGNED BY: 81-0062
APPROVED PLANS
PAGE 2 OF 5
12/1/14

PERMIT SUBMITTAL
NOT APPROVED 11

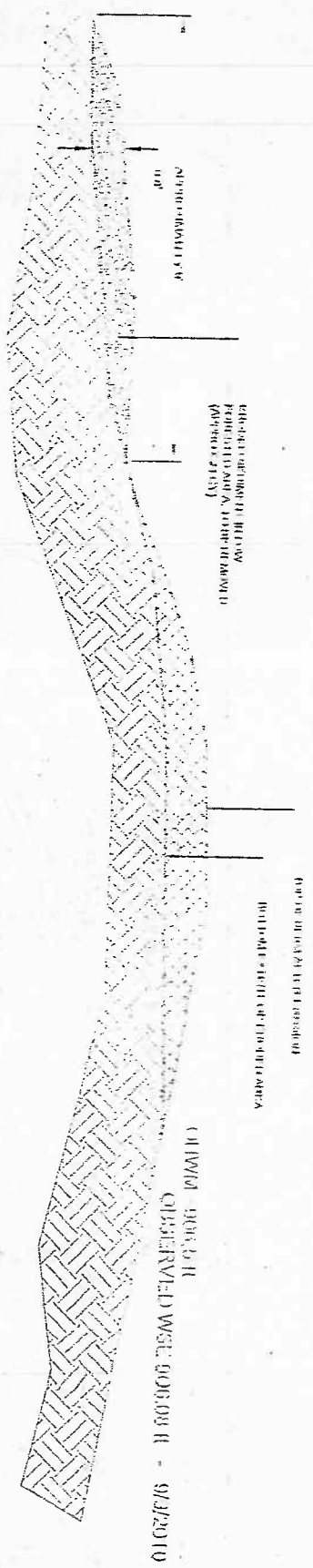

ERODED SEDIMENT EXCAVATION - SECTION E-E
 NOT TO SCALE

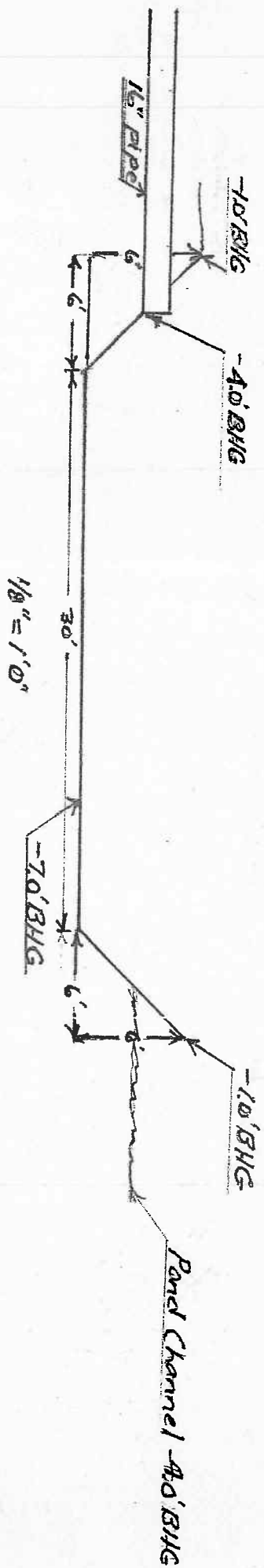

Sediment Basin Cross Section

REVISED DRAWING 4

DEQ-WRD
 File # 10-81-0062 Revised
 APPROVED PLANS
 Page 4 of 8
03/26/14

Pond Channel - 4.0' BHC

FOR EACH AND EVERY LINED AREA THE AREAS WITH CHECK MARK HAVE

BERM MODIFICATIONS - SECTION A-A'
NOT TO SCALE

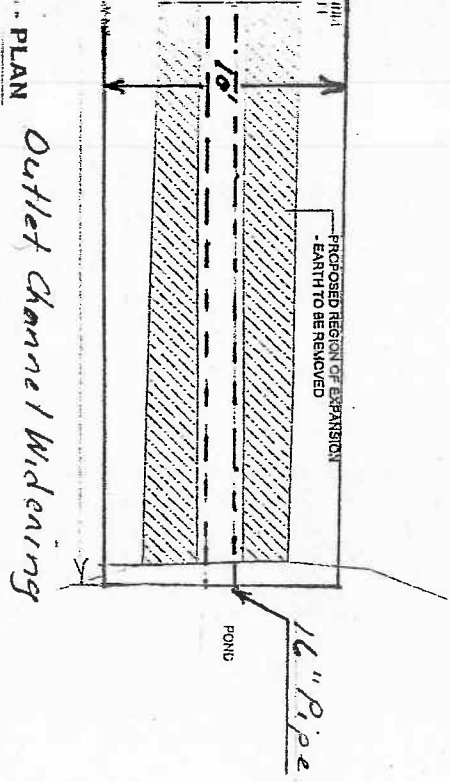

DECA-WRPD
File # 10-81-0062 *Revised*
APPROVED PLANS
Page 5 of 8
03/26/14

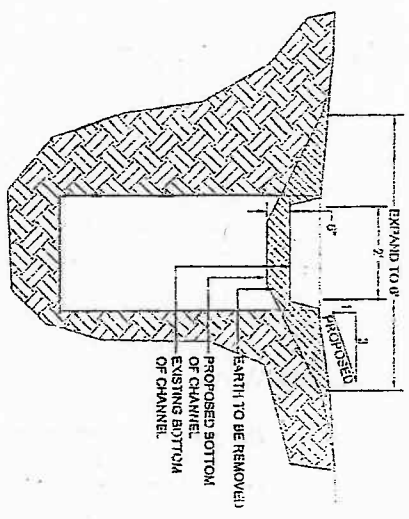

OUTLET CHANNEL MODIFICATIONS - SECTION C-C'

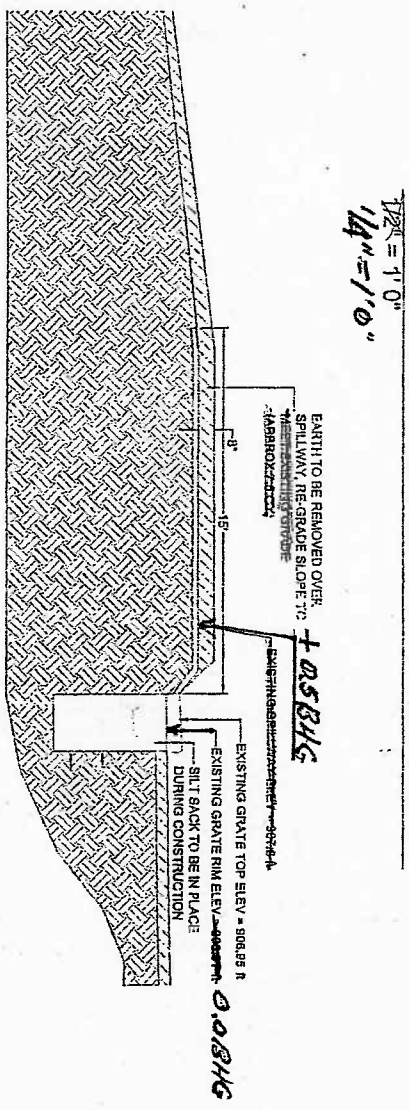

SPILLWAY MODIFICATIONS - SECTION D-D'
NOT TO SCALE

PERMIT SUBMITTAL DRAWING:
NOT APPROVED FOR CONSTRUCTION.

REVISED DRAWING 5

OUTLET CHANNEL & BERM SECTIONS	
Thurston Pond	
Ann Arbor Public Schools	
Washtenaw County, Michigan	
DRAWN BY: AM	
DESIGNED BY: SDJRGES	
DATE: September 2010	
JOB NO: 050044	
DRAFT	
SHEET NO.	
4	
OF 5	

Figure 3. Channel X-Section Area (sq ft).

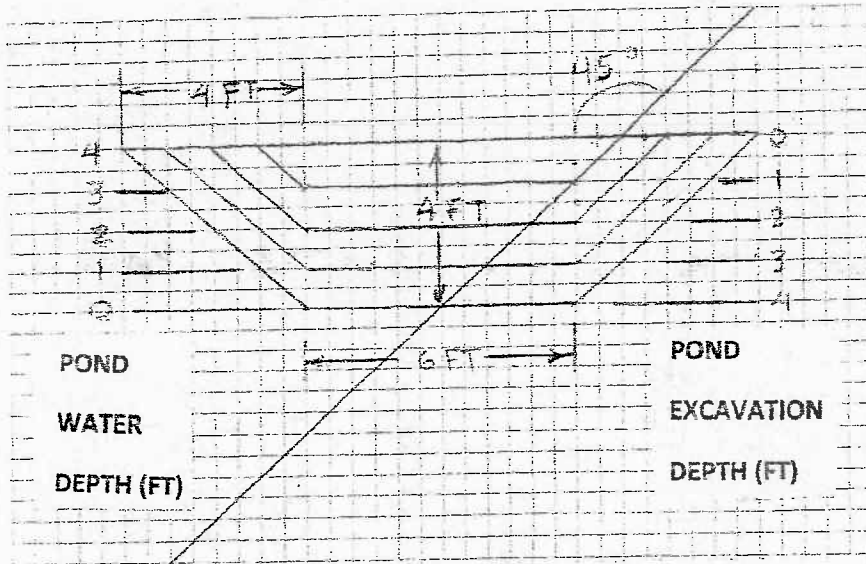

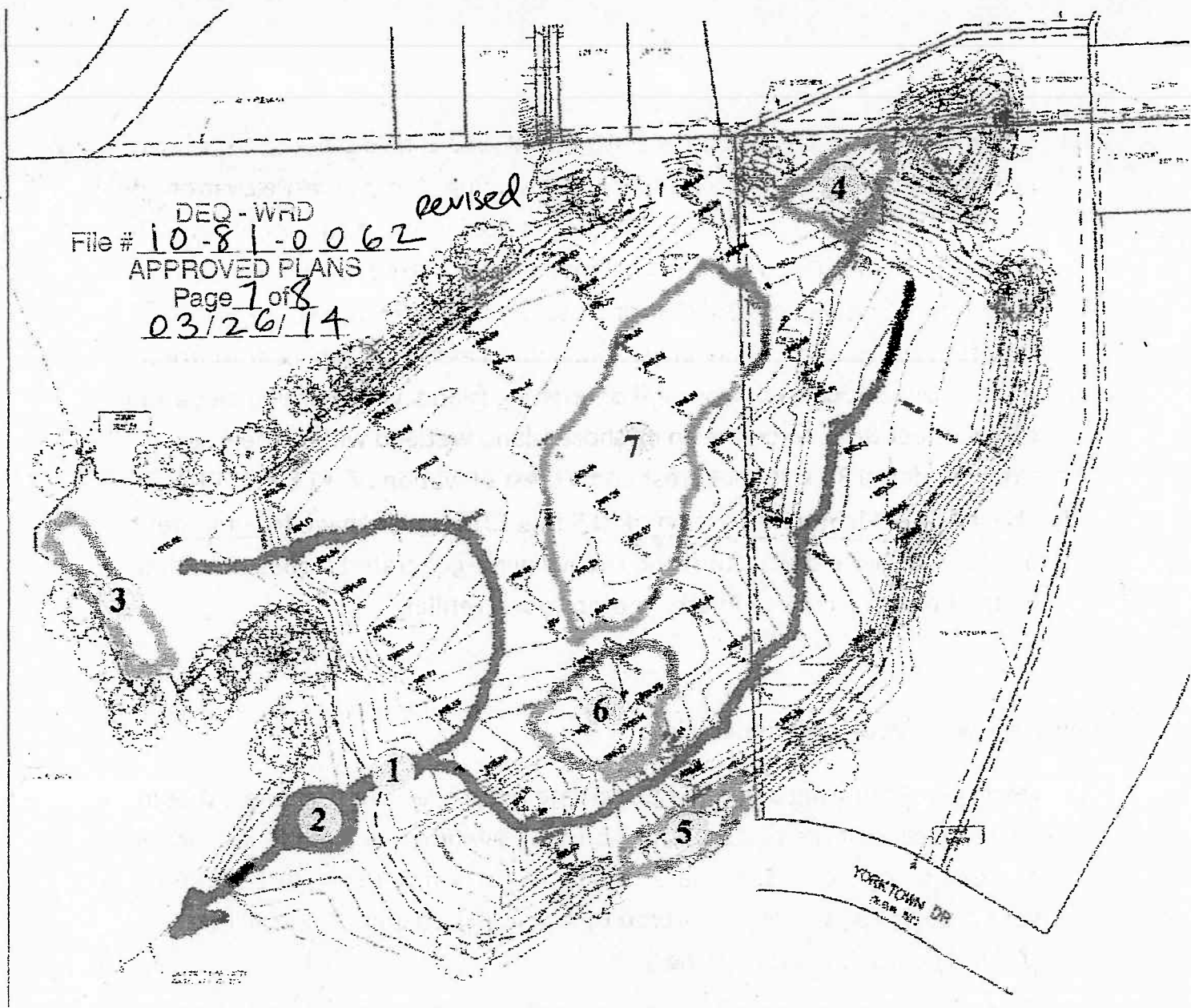

Figure 2. Thurston Pond Restoration Map and Legend:

1. Pond Channels—Re-grade pond bottom to create channels with a bottom elevation of -4.0 feet BHG.
2. Sediment Retention Basin—Excavate a sediment retention basin with a 30 x 30 foot bottom, 45 degree sloping walls, and a bottom elevation of -7.0 feet BHG. Install a 16-inch pipe connecting the sediment retention basin to the BHGC at BHG = -4.0 feet.
3. Berm Addition—Deposit pond bottom soil in the pond along the east face of the berm to widen the berm by 8 feet and raise the berm crest to elevation of +1.5 feet BHG.

4. North Overlook— Deposit pond bottom soil on old-field uplands to create an overlook site with a 10 x 20 foot crest, sloping sides, a crest elevation of +4.0 feet above existing site elevation, and access to the adjacent footpath.
5. South Overlook—Deposit pond bottom soil on forested uplands to create an overlook site with a 10 x 20 foot crest, sloping sides, a crest elevation of +4.0 feet above existing site elevation, and access to the adjacent footpath.
6. Island—Deposit pond bottom soil on existing island, which has an elevation of + 0.5 feet BHG, to create an offshore island wetland with 45 degree sloping sides, a 30 x 30 foot crest and a crest elevation of +1.5 feet BHG.
7. Shoal Area—Maintain elevation of -0.5 feet BHG and manage for emergent plants to stabilize the bottom and reduce wind-generated turbidity. Initiate Phase 3 plantings late in Phase 2 before pond refilling.

Phase 2 work involves the following:

1. Deploy earth moving equipment to create pond channels. Channels should be 6 feet wide at the bottom with bottom elevation = -4.0 feet BHG and 45 degree sloping walls. See Figure 3. The excavation volume = 862.2 cubic yards and the pond bottom altered by channel dredging = 0.243 acres (Table 1). See Revised Drawing 1, 2.
2. Deposit soils created by the project in fill sites as described in Fig. 2. The estimated quantities of soils to be deposited at each fill site are shown in Table 2.

DEQ - WRD
File # 10-81-0062
APPROVED PLANS
Page 8 of 8
03/26/14