



STATE OF MICHIGAN
TERRI LYNN LAND, SECRETARY OF STATE
DEPARTMENT OF STATE
LANSING

January 3, 2008

Ms. Jacqueline Beaudry
City Clerk
City of Ann Arbor
100 North Fifth Avenue
Ann Arbor, MI 48107

RE: 19 Annexations from Ann Arbor Township to the City of Ann Arbor

Dear Ms. Beaudry:

This letter serves to acknowledge the Office of the Great Seal's receipt on December 27, 2007 of the filing of the annexation pursuant to Public Act 279 of 1909, as amended, from Ann Arbor Township to the City of Ann Arbor. The receipt date is the effective date of this boundary change. This filing has been designated as Job Number 07-058.

All property descriptions for any boundary changes are reviewed by the Michigan Department of Transportation (MDOT), and then published annually in the Michigan Public and Local Acts manual. If any property description is found inaccurate by MDOT, this office will contact you at that time and request a corrected description, which will not impact the effective date of the boundary change.

*****No further acknowledgment will be sent*****

Sincerely,

Debbie Anchak, Analyst
Legal Policy and Procedures Section
517-335- 6720

cc: Ann Arbor Township Clerk
Washtenaw County Clerk
Michigan Department of Labor and Economic Growth, State Boundary Commission
Michigan Department of Labor and Economic Growth, Liquor Control Commission
Michigan Department of Labor and Economic Growth, Office of Land Survey and Remonumentation
Michigan Department of Information Technology, Center for Geographic Information
Michigan Department of Treasury, Office of Revenue and Tax Analysis
Michigan Department of Transportation, Bureau of Transportation Planning
U.S. Bureau of the Census
Office of the Great Seal Job Number: 07-058

08 JAN 7 11:52

NOV 11 2007

Cities
Washtenaw County

In the matter of the annexation of certain property located in Ann Arbor Township to the city of Ann Arbor. Annexed in accordance with the provisions of Public Act 279 of 1909, as amended the following described property:

For Tax ID #I-09-27-351-008 parcel (200 Orchard Hills Drive)

OLD SID I 09-027-030-00 AA 27-10A COM AT CEN OF SEC 27, TH S 89-16-20 W 1118.31 FT ON E-W ¼ LINE TO POB, TH S 4-7-30 E 394.91 FT, TH S 78-44-30 W 219.49 FT, TH N 0-23-30 E 434.39 FT, TH N 89-16-20 E 183.94 FT TO POB, PT SW ¼ SEC 27 T2S R6E 1.9 AC.

For Tax ID #I-09-27-350-008 parcel (186 Riverview Court)

OLD SID I 09-142-019-00 AA 70A-19 LOT 72 HILLWOOD SUBDIVISION #5, ANN ARBOR TOWNSHIP, WASHTENAW COUNTY, MICHIGAN.

For Tax IDs #I -09-27-354-005 (225 Pineview Court)

OLD SID I 09-142-023-00 AA 70A-23 LOT 76 HILLWOOD SUBDIVISION #5, ANN ARBOR TOWNSHIP, WASHTENAW COUNTY, MICHIGAN.

For Tax ID #I-09-27-372-002 parcel (402 Orchard Hills Drive)

Lot 1, Orchard Hills, as recorded in Liber 5, Page 2, of Plats, Ann Arbor Township, Washtenaw County, Michigan.

For Tax ID #I-09-27-371-004 parcel (370 Rock Creek Drive)

Lot 28, Hillwood Subdivision No. 2, a part of the Southwest ¼ Section 27, T2S, R6E, Ann Arbor Township, Washtenaw County, Michigan, recorded in Liber 10 of Plats, page 54, Washtenaw County Records.

(CONTINUED ON NEXT PAGE)

(CONTINUED FROM PREVIOUS PAGE)

For Tax ID #I-09-27-475-008 parcel (422 Huntington Place)

COM AT NE COR LOT 53 HILLWOOD SUB NO 4, TH N 89 DEG 46' 30" E 160.0 FT ALNG N LN SUB EXTENDED TO P.O.B., TH N 0 DEG 4' W 1.04 FT, TH N 45 DEG 56' 30" E 70.95 FT, TH N 89 DEG 20' 30" E 102.35 FT ALNG S LN HUNTINGTON PL TO NW COR LOT 1 HUNTINGTON WOOD NO 1, TH S 0 DEG 39' 30" E 308.98 FT ALNG W LN LOTS 1 & 2 HUNTINGTON WOODS NO. 1, TH S 89 DEG 46' 30" W 156.57 FT, TH N 0 DEG 4' W 257.96 FT TO P.O.B., PART SE ¼ SEC 27 T2S R6E 1.06 AC.

For Tax IDs #I -09-27-475-003 (442 Huntington Place)

Lot 5, Huntington Woods Subdivision No. 1, a subdivision of part of the Southeast ¼ of Section 27, Town 2 South, Range 6 East, Ann Arbor Township, Washtenaw County, Michigan, according to the recorded plat thereof as shown in Liber 16, Page 60, Washtenaw County Records.

For Tax ID #I-09-27-490-015 parcel (3125 Geddes Avenue)

OLD SID - I 09-027-080-00 AA 27-31B-1 COM AT SE COR OF SEC, TH W 907.5 FT IN S LINE OF SEC, TH N 180.09 FT, TH E 15 FT FOR PL OF BEG, TH E 135 FT, TH S 24-28-20 E 100.43 FT, TH S 57-23-50 W 117.08 FT, TH DEFL 28 DEG 05' RIGHT 82.40 FT, TH NORTH 158.82 FT TO PL OF BEG, BEING PART OF SE ¼ SEC 27, T2S-R6E 0.52 AC.

For Tax ID #I-09-27-490-020 parcel (505 Riverview Drive)

*OLD SID - I 09-027-078-00 AA 27-30 C COM AT S 1/4 POST OF SEC, THEAST 1468.81 FT IN S LINE OF SEC, TH DEFL 4 DEG 31' 10" LEFT 253.78 FT, TH N 338.15 FT, TH E 271.30 FT, TH DEFL 112 DEG 56' LEFT 570.00 FT FOR PL OF BEG, TH CONT N 22 DEG 56' W 107.41 FT, TH N 51 DEG 09' E 135.98 FT, TH S 50 DEG 33' E 156.06 FT IN SWLY LN OF R.R., TH CONT IN SWLY LN OF R.R. S 50 DEG 50' E 29.14 FT, TH S 59 DEG 02' W 218.92 FT, TH N 67 DEG 56' W 21.21 FT, TH S 67 DEG 04' W 113.26 FT, TH NWLY 21.21 FT IN ARC OF CURVE LEFT OF RADIUS 72.71 FT, TH CHORD BEARS N 41 DEG 46' W 21.14 FT, TH N 67 DEG 04' E 120.06 FT, TH N 22 DEG 04' E 21.21 FT TO PL OF BEG, BEING PART OF LOT 19, GEDDES AVENUE RIVER- VIEW HGTS AND PART OF SE FRL 1/4 SEC 27 T2S R6E. 0.73 AC.

(CONTINUED FROM PREVIOUS PAGE)

For Tax ID #I-09-34-160-003 parcel (865 Arlington)

OLD SID - I 09-034-023-00 AA 34-19 COM AT N ¼ POST OF SEC, THE 500.33 FT IN N LINE OF SEC, TH DEFL 88 DEG TO RIGHT 312 FT, TH DEFL 17 DEG 43' 30" TO LEFT 351.85 FT, TH DEFL 25 DEG 05' 30" TO RIGHT 15.09 FT FOR POB, TH CONT 132.89 FT IN SAME COURSE, TH DEFL 54-54 RIGHT 163.16 FT, TH NWLY IN ARC OF CURVE RIGHT, RAD 749.54 FT, CENT ANGLE 12-59, CHORD MAKING NELY ANGLE OF 81-44 WITH PRECEDING COURSE, TH NELY 224.75 FT TO POB, BEING PART OF NE ¼ SEC 34 T2S R6E.

For Tax IDs #I-09-34-180-002 (2930 Heatherway Street)

*OLD SID - I 09-034-007-00 AA 34-3E COM AT E 1/4 POST OF SEC, THS 88 DEG 17' 20" W 1048.70 FT IN THEE & W 1/4 LINE OF SEC, TH N 0 DEG 45' 10" W 369.66 FT, TH N 89 DEG 14' 50" E 40 FT TH N 48 DEG 43' E 412.70 FT FOR A PL OF BEG, TH N 48 DEG 43' E 125.00 FT, N 32 DEG 58' W 174.35 FT, TH N 35 DEG 24' W 3.00 FT TO A POINT OF CURVATURE, TH SW'LY IN THE ARC OF A CIRCULAR CURVE TO THE RIGHT, THE CHORD SUBTENDING SAID ARC BEING 104.03 FT IN LENGTH AND HAVING A BEARING OF S 59 DEG 30' W, THE RADIUS OF SAID CURVE BEING 608.94 FT, TH S 25 DEG 41' E 3.00 FT TH S 27 DEG 08' E 197.40 FT TO THE PL OF BEG, BEING A PART OF NE 1/4 SEC. 34 T2S R6E 0.50 AC.

For Tax ID #I-09-18-480-006 parcel (2060 Newport Road)

Lot 4, Bowen's Subdivision, Ann Arbor Township,
Washtenaw County, Michigan,

For Tax ID #I-09-18-480-005 parcel (2080 Newport Road)

Lot 5, Bowen's Subdivision, Ann Arbor Township,
Washtenaw County, Michigan,

For Tax ID #I-09-18-150-005 parcel (2625 Newport Road)

Commencing at the East ¼ corner of Section 18, T2S, R6E, Ann Arbor Township, Washtenaw County, Michigan; thence N 89°56' W 1327.84 feet along the E-W ¼ line of said section; thence along the centerline of Newport Road along the following courses: N 19°42' W 340.67 feet (as monumented), N 25°20' W 485.20 feet, N 26°33'30" W 470.41 feet for a Place of Beginning; thence S 63°26'30" W 463.30 feet; thence N 22°48'30" W 170.96 feet; thence N 63°26'30" E 452.20 feet; thence S 26°33'30" E 170.59 feet along said centerline to the Place of Beginning; being part of the NE ¼ of said Section 18.

(CONTINUED FROM PREVIOUS PAGE)

For Tax IDs #I -09-35-450-003 and I -09-35-450-016 (1305 Chalmers Drive and adjacent vacant land)

Lots 73, 74 and 75, Washtenaw Hills Estates No. 1, a subdivision of part of the southeast quarter of Section 35, Ann Arbor Township, Washtenaw County, Michigan, according to the plat thereof as recorded in Liber 8 of Plats, Page 32, Washtenaw County Records; together with 33 feet of the land abutting the northeast boundary of the above-described land, which is the southwesterly one-half of Stratford Avenue as originally described in the Plat of Washtenaw Hills Estates, but has since been vacated.

For Tax ID #I-09-35-450-011 parcel (1575 Chalmers)

Old SID - I 09-250-033-00, AA 60-31, Lot 49, Washtenaw Hills Estates No. 1, Ann Arbor Township, Washtenaw County, Michigan.

For Tax ID #I-09-26-430-010 parcel (3451 Geddes Road)

OLD SID - I 09-115-015-00 AA 62-13 BEG AT SE COR OF LOT 12, TH NORTH 1 DEG 08' E 374.16 FT IN E LINE OF LOT 12, TH S 89 DEG 42'30" W 190.88 FT, TH S 3 DEG 07' W 322 FT, TH ELY IN S LINE OF LOT 12 TO PL OF BEG, BEING PART OF LOT 12, HILL TOPS, ANN ARBOR TOWNSHIP, WASHTENAW COUNTY, MICHIGAN.

For Tax ID #I-09-17-425-012 parcel (169 Barton Drive)

Lot 4, Long Shore Park, as recorded in Liber 5, Page 39, of Plats, Washtenaw County Records, Ann Arbor Township, Washtenaw County, Michigan.

For Tax ID #I-09-23-375-008 parcel (3175 Glazier Way)

OLD SID - I 09-023-021-00 AA 23-9 HS COM AT SW COR OF SEC, TH E 979 FT IN S LINE OF SEC FOR A PL OF BEG, TH DEFL 88 DEG 54' TO THE LEFT 421.30 FT, TH DEFL 90 DEG TO RIGHT 203.36 FT TH DEFL 90 DEG TO RIGHT 417.40 FT TO S LINE OF SEC, TH W 203.45 FT IN S LINE OF SEC TO THE PL OF BEG, BEING A PART OF W 1/2 OF SW 1/4 SEC 23 T2S R6E 1.96 AC.

October 2007 Annexations and Zonings 1

Parcel and Zoning Map 1

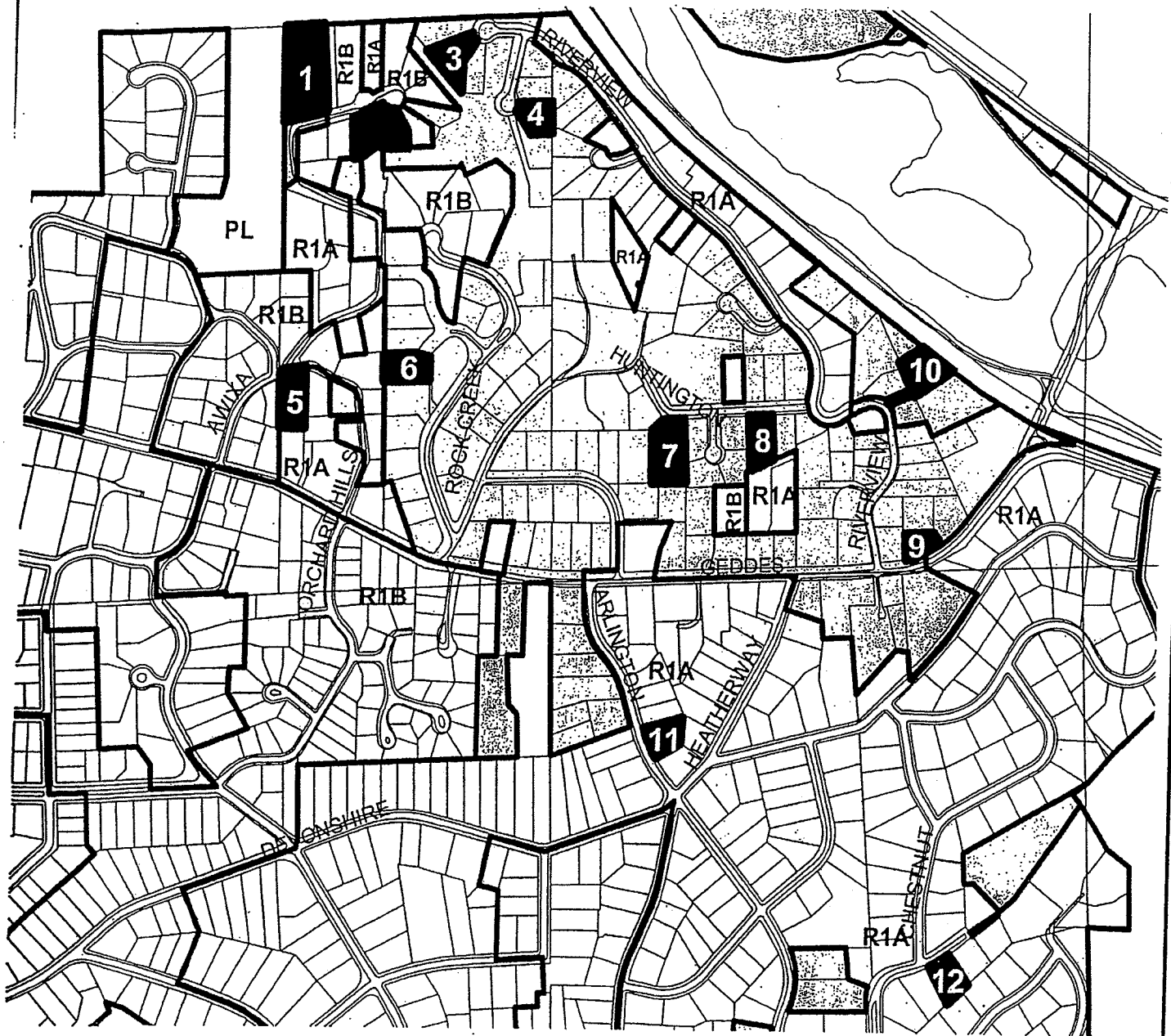

- 1. Porter/Crispell (200 Orchard Hills)
- 3. Salmeen (186 Riverview Ct)
- 4. McNamara (225 Pineview Ct)
- 5. Gilpin (402 Orchard Hills Dr)
- 6. Bonds/Mau (370 Rock Creek Dr)

- 7. Gross/Ellsworth (422 Huntington Pl)
- 8. Gates (442 Huntington Pl)
- 9. Connellan (3125 Geddes Ave)
- 10. Cares (505 Riverview Dr)
- 11. Dazy (865 Arlington Blvd)
- 12. Jokelainen (2930 Heatherway)



October 2007 Annexations and Zonings

Parcel and Zoning Map 3

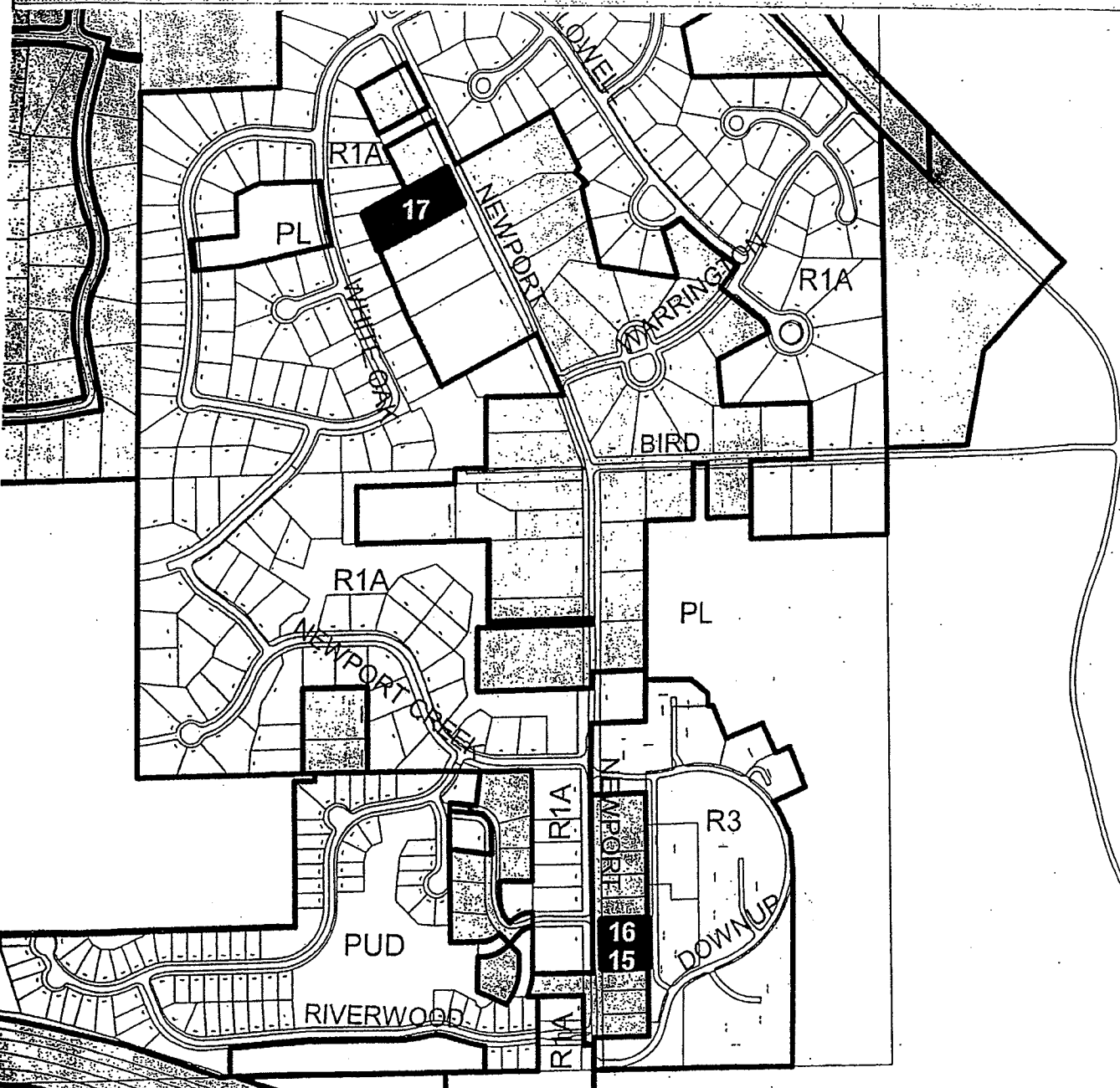

- 15. Zelnik (2060 Newpor)
- 16. Yocum (2080 Newport)
- 17. Bogdasarian (2625 Newport)

200 0 200 400 Feet



October 2007 Annexations and Zonings

Parcel and Zoning Map 2

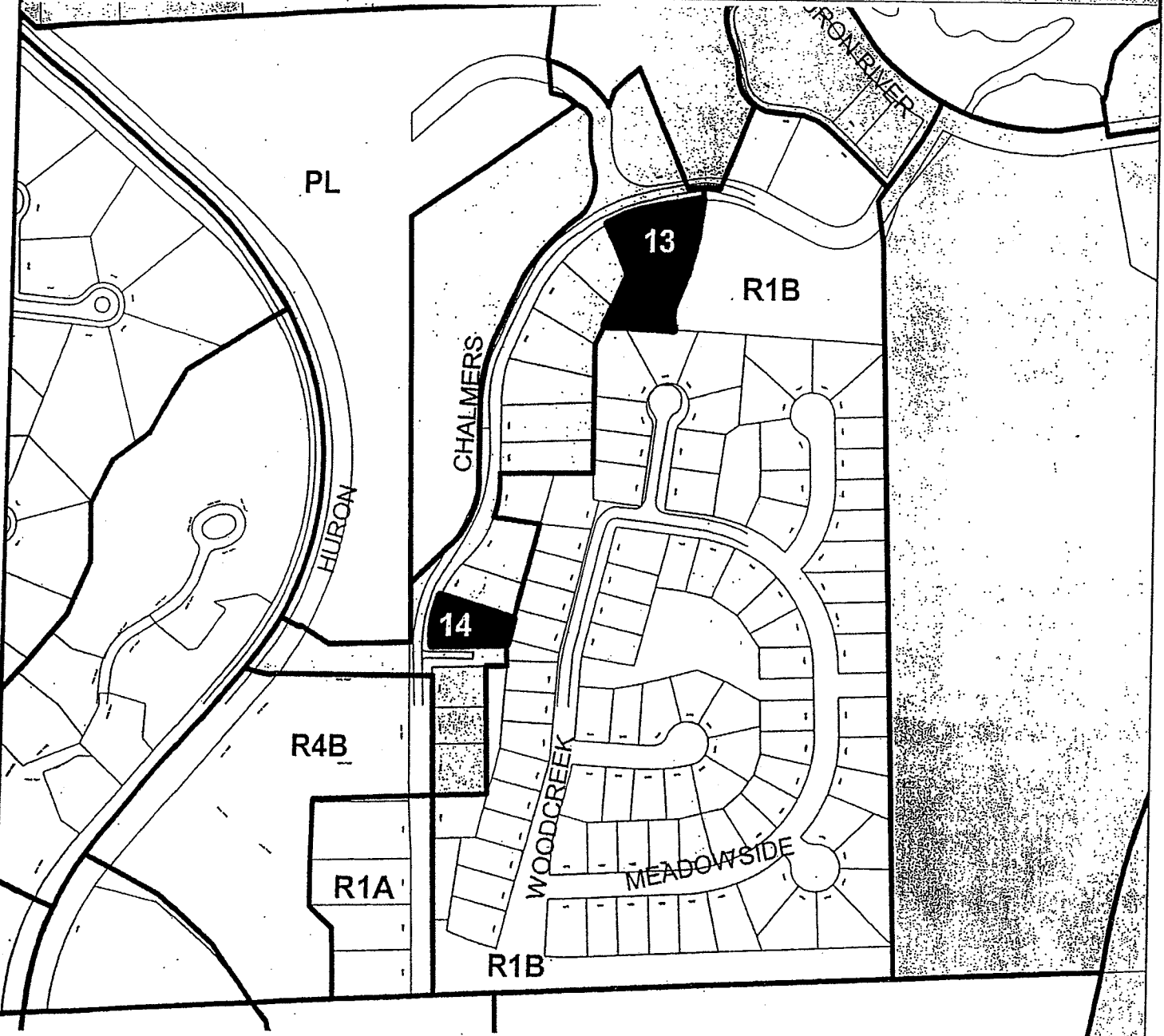

- 13. Lindsay (1305 Chalmers Dr)
- 14. Bennett/Wahlman (1575 Chalmers Dr)

200 0 200 400 Feet

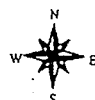

Rosenblum (3451 Geddes Ave.) Annexation and Zoning

Parcel and Zoning Map

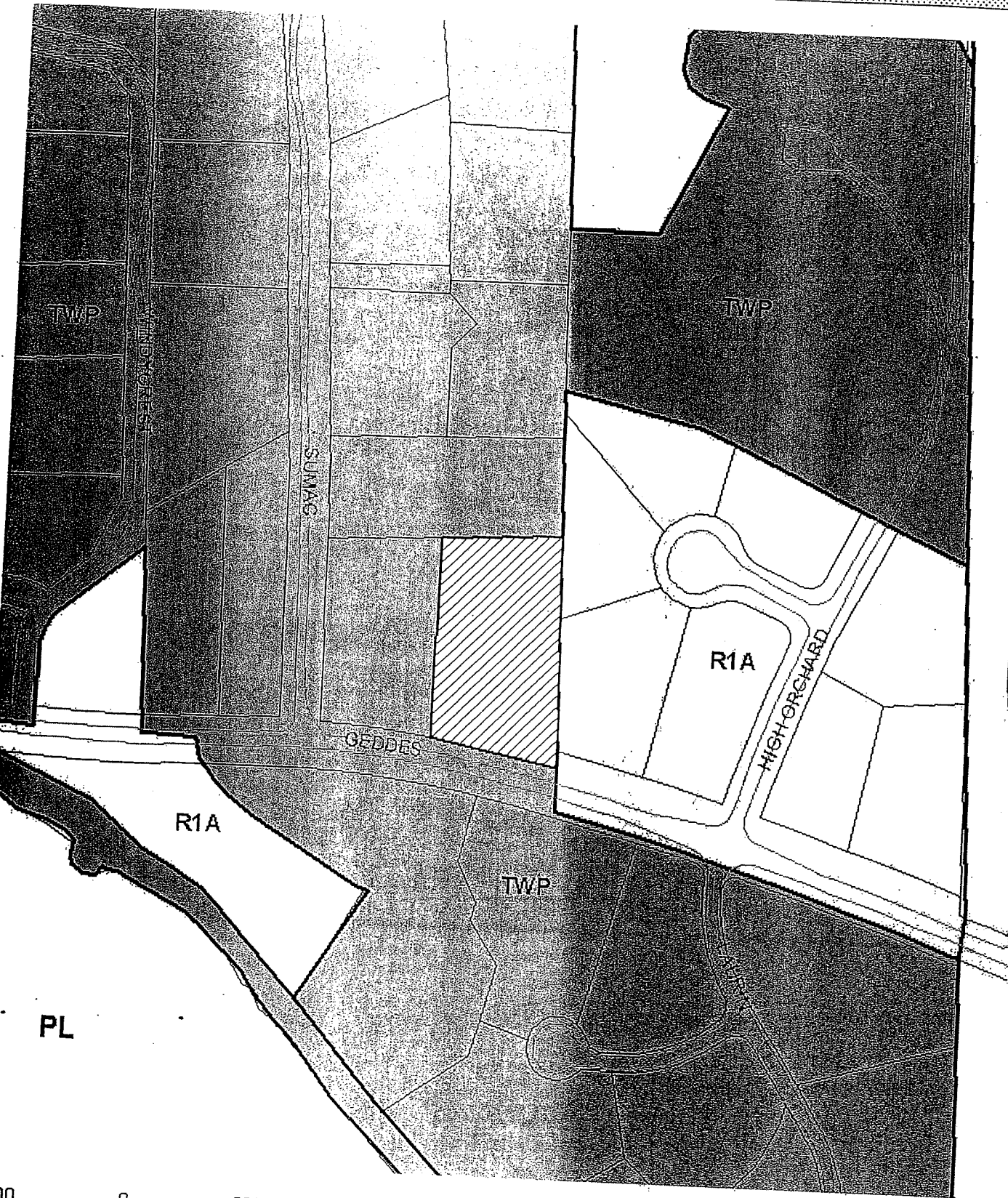

0 200 400 Feet



169 Barton

Parcel and Zoning Map

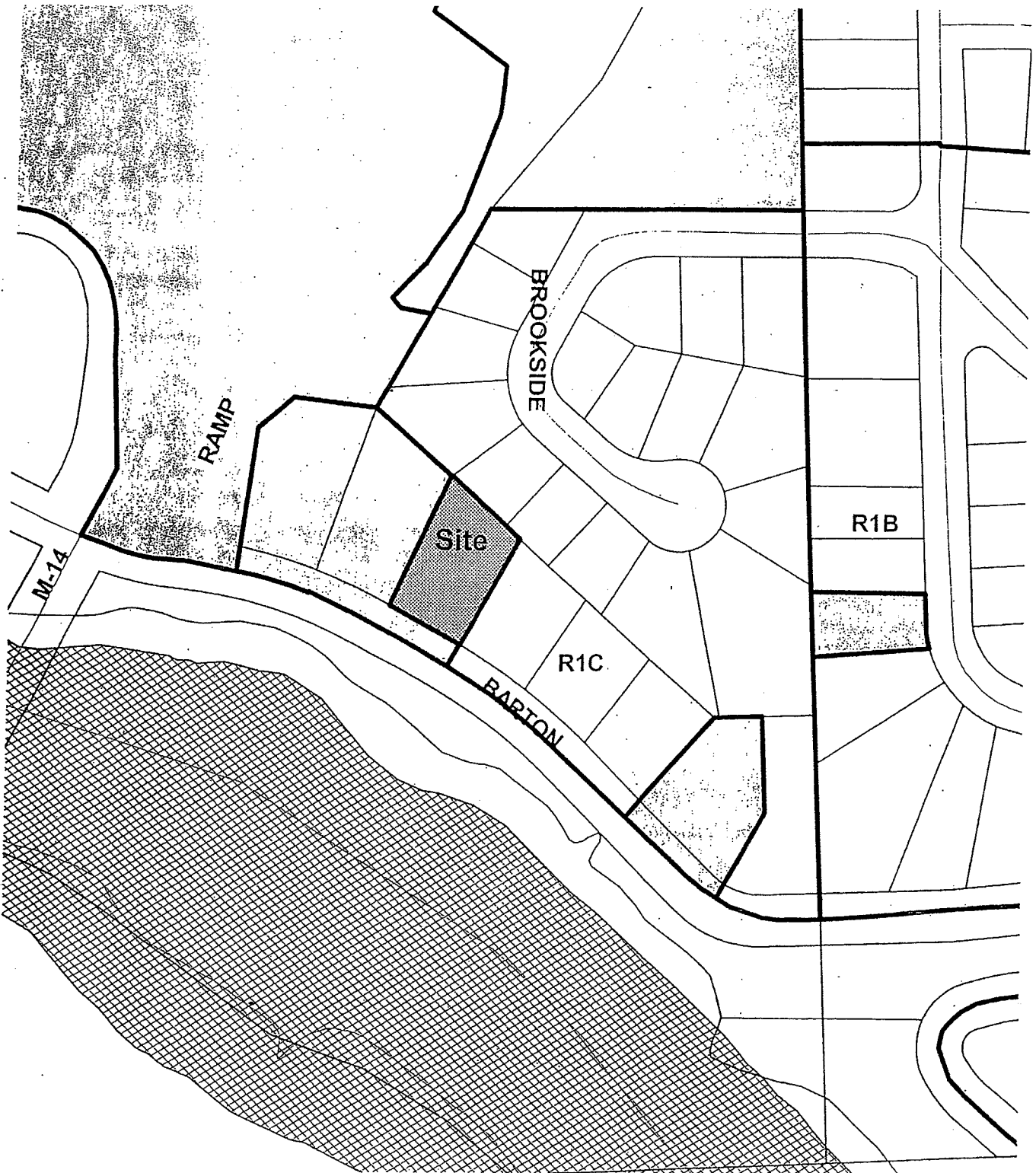

200 0 200 400 Feet

Township
Floodway
Floodplain



3175 Glazier Way

Parcel & Zoning Map

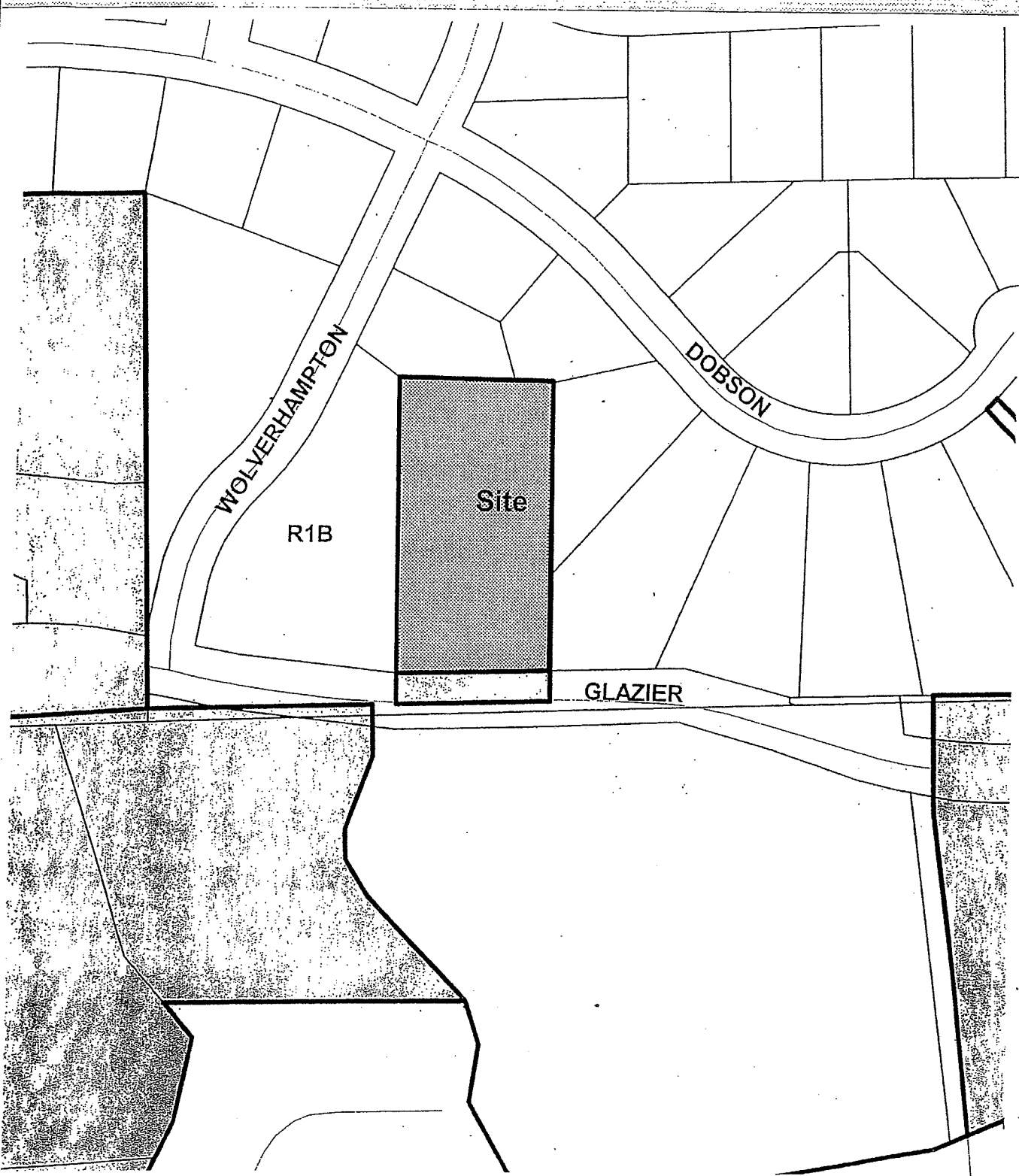

 Township



Cities
Washtenaw County

In the matter of the annexation of certain property located in Ann Arbor Township to the city of Ann Arbor. Annexed in accordance with the provisions of Public Act 279 of 1909, as amended the following described property:

For Tax ID #I-09-27-351-008 parcel (200 Orchard Hills Drive)

OLD SID I 09-027-030-00 AA 27-10A COM AT CEN OF SEC 27, TH S 89-16-20 W 1118.31 FT ON E-W ¼ LINE TO POB, TH S 4-7-30 E 394.91 FT, TH S 78-44-30 W 219.49 FT, TH N 0-23-30 E 434.39 FT, TH N 89-16-20 E 183.94 FT TO POB, PT SW ¼ SEC 27 T2S R6E 1.9 AC.

For Tax ID #I-09-27-350-008 parcel (186 Riverview Court)

OLD SID I 09-142-019-00 AA 70A-19 LOT 72 HILLWOOD SUBDIVISION #5, ANN ARBOR TOWNSHIP, WASHTENAW COUNTY, MICHIGAN.

For Tax IDs #I-09-27-354-005 (225 Pineview Court)

OLD SID I 09-142-023-00 AA 70A-23 LOT 76 HILLWOOD SUBDIVISION #5, ANN ARBOR TOWNSHIP, WASHTENAW COUNTY, MICHIGAN.

For Tax ID #I-09-27-372-002 parcel (402 Orchard Hills Drive)

Lot 1, Orchard Hills, as recorded in Liber 5, Page 2, of Plats, Ann Arbor Township, Washtenaw County, Michigan.

For Tax ID #I-09-27-371-004 parcel (370 Rock Creek Drive)

Lot 28, Hillwood Subdivision No. 2, a part of the Southwest ¼ Section 27, T2S, R6E, Ann Arbor Township, Washtenaw County, Michigan, recorded in Liber 10 of Plats, page 54, Washtenaw County Records.

(CONTINUED ON NEXT PAGE)

(CONTINUED FROM PREVIOUS PAGE)

For Tax ID #I-09-27-475-008 parcel (422 Huntington Place)

COM AT NE COR LOT 53 HILLWOOD SUB NO 4, TH N 89 DEG 46' 30" E 160.0 FT ALNG N LN SUB EXTENDED TO P.O.B., TH N 0 DEG 4' W 1.04 FT, TH N 45 DEG 56' 30" E 70.95 FT, TH N 89 DEG 20' 30" E 102.35 FT ALNG S LN HUNTINGTON PL TO NW COR LOT 1 HUNTINGTON WOOD NO 1, TH S 0 DEG 39' 30" E 308.98 FT ALNG W LN LOTS 1 & 2 HUNTINGTON WOODS NO. 1, TH S 89 DEG 46' 30" W 156.57 FT, TH N 0 DEG 4' W 257.96 FT TO P.O.B., PART SE ¼ SEC 27 T2S R6E 1.06 AC.

For Tax IDs #I -09-27-475-003 (442 Huntington Place)

Lot 5, Huntington Woods Subdivision No. 1, a subdivision of part of the Southeast ¼ of Section 27, Town 2 South, Range 6 East, Ann Arbor Township, Washtenaw County, Michigan, according to the recorded plat thereof as shown in Liber 16, Page 60, Washtenaw County Records.

For Tax ID #I-09-27-490-015 parcel (3125 Geddes Avenue)

OLD SID - I 09-027-080-00 AA 27-31B-1 COM AT SE COR OF SEC, TH W 907.5 FT IN S LINE OF SEC, TH N 180.09 FT, TH E 15 FT FOR PL OF BEG, TH E 135 FT, TH S 24-28-20 E 100.43 FT, TH S 57-23-50 W 117.08 FT, TH DEFL 28 DEG 05' RIGHT 82.40 FT, TH NORTH 158.82 FT TO PL OF BEG, BEING PART OF SE ¼ SEC 27, T2S-R6E 0.52 AC.

For Tax ID #I-09-27-490-020 parcel (505 Riverview Drive)

*OLD SID - I 09-027-078-00 AA 27-30 C COM AT S 1/4 POST OF SEC, THEAST 1468.81 FT IN S LINE OF SEC, TH DEFL 4 DEG 31' 10" LEFT 253.78 FT, TH N 338.15 FT, TH E 271.30 FT, TH DEFL 112 DEG 56' LEFT 570.00 FT FOR PL OF BEG, TH CONT N 22 DEG 56' W 107.41 FT, TH N 51 DEG 09' E 135.98 FT, TH S 50 DEG 33' E 156.06 FT IN SWLY LN OF R.R., TH CONT IN SWLY LN OF R.R. S 50 DEG 50' E 29.14 FT, TH S 59 DEG 02' W 218.92 FT, TH N 67 DEG 56' W 21.21 FT, TH S 67 DEG 04' W 113.26 FT, TH NWLY 21.21 FT IN ARC OF CURVE LEFT OF RADIUS 72.71 FT, TH CHORD BEARS N 41 DEG 46' W 21.14 FT, TH N 67 DEG 04' E 120.06 FT, TH N 22 DEG 04' E 21.21 FT TO PL OF BEG, BEING PART OF LOT 19, GEDDES AVENUE RIVER- VIEW HGTS AND PART OF SE FRL 1/4 SEC 27 T2S R6E. 0.73 AC.

(CONTINUED FROM PREVIOUS PAGE)

For Tax ID #I-09-34-160-003 parcel (865 Arlington)

OLD SID - I 09-034-023-00 AA 34-19 COM AT N ¼ POST OF SEC, THE 500.33 FT IN N LINE OF SEC, TH DEFL 88 DEG TO RIGHT 312 FT, TH DEFL 17 DEG 43' 30" TO LEFT 351.85 FT, TH DEFL 25 DEG 05' 30" TO RIGHT 15.09 FT FOR POB, TH CONT 132.89 FT IN SAME COURSE, TH DEFL 54-54 RIGHT 163.16 FT, TH NWLY IN ARC OF CURVE RIGHT, RAD 749.54 FT, CENT ANGLE 12-59, CHORD MAKING NELY ANGLE OF 81-44 WITH PRECEDING COURSE, TH NELY 224.75 FT TO POB, BEING PART OF NE ¼ SEC 34 T2S R6E.

For Tax IDs #I-09-34-180-002 (2930 Heatherway Street)

*OLD SID - I 09-034-007-00 AA 34-3E COM AT E 1/4 POST OF SEC, THS 88 DEG 17' 20" W 1048.70 FT IN THEE & W 1/4 LINE OF SEC, TH N 0 DEG 45' 10" W 369.66 FT, TH N 89 DEG 14' 50" E 40 FT TH N 48 DEG 43' E 412.70 FT FOR A PL OF BEG, TH N 48 DEG 43' E 125.00 FT, N 32 DEG 58' W 174.35 FT, TH N 35 DEG 24' W 3.00 FT TO A POINT OF CURVATURE, TH SWLY IN THE ARC OF A CIRCULAR CURVE TO THE RIGHT, THE CHORD SUBTENDING SAID ARC BEING 104.03 FT IN LENGTH AND HAVING A BEARING OF S 59 DEG 30' W, THE RADIUS OF SAID CURVE BEING 608.94 FT, TH S 25 DEG 41' E 3.00 FT TH S 27 DEG 08' E 197.40 FT TO THE PL OF BEG, BEING A PART OF NE 1/4 SEC. 34 T2S R6E 0.50 AC.

For Tax ID #I-09-18-480-006 parcel (2060 Newport Road)

Lot 4, Bowen's Subdivision, Ann Arbor Township,
Washtenaw County, Michigan,

For Tax ID #I-09-18-480-005 parcel (2080 Newport Road)

Lot 5, Bowen's Subdivision, Ann Arbor Township,
Washtenaw County, Michigan,

For Tax ID #I-09-18-150-005 parcel (2625 Newport Road)

Commencing at the East ¼ corner of Section 18, T2S, R6E, Ann Arbor Township, Washtenaw County, Michigan; thence N 89°56' W 1327.84 feet along the E-W ¼ line of said section; thence along the centerline of Newport Road along the following courses: N 19°42' W 340.67 feet (as monumented), N 25°20' W 485.20 feet, N 26°33'30" W 470.41 feet for a Place of Beginning; thence S 63°26'30" W 463.30 feet; thence N 22°48'30" W 170.96 feet; thence N 63°26'30" E 452.20 feet; thence S 26°33'30" E 170.59 feet along said centerline to the Place of Beginning; being part of the NE ¼ of said Section 18.

(CONTINUED FROM PREVIOUS PAGE)

For Tax IDs #I -09-35-450-003 and I -09-35-450-016 (1305 Chalmers Drive and adjacent vacant land)

Lots 73, 74 and 75, Washtenaw Hills Estates No. 1, a subdivision of part of the southeast quarter of Section 35, Ann Arbor Township, Washtenaw County, Michigan, according to the plat thereof as recorded in Liber 8 of Plats, Page 32, Washtenaw County Records; together with 33 feet of the land abutting the northeast boundary of the above-described land, which is the southwesterly one-half of Stratford Avenue as originally described in the Plat of Washtenaw Hills Estates, but has since been vacated.

For Tax ID #I-09-35-450-011 parcel (1575 Chalmers)

Old SID – I 09-250-033-00, AA 60-31, Lot 49, Washtenaw Hills Estates No. 1, Ann Arbor Township, Washtenaw County, Michigan.

For Tax ID #I-09-26-430-010 parcel (3451 Geddes Road)

OLD SID – I 09-115-015-00 AA 62-13 BEG AT SE COR OF LOT 12, TH NORTH 1 DEG 08' E 374.16 FT IN E LINE OF LOT 12, TH S 89 DEG 42'30" W 190.88 FT, TH S 3 DEG 07' W 322 FT, TH ELY IN S LINE OF LOT 12 TO PL OF BEG, BEING PART OF LOT 12, HILL TOPS, ANN ARBOR TOWNSHIP, WASHTENAW COUNTY, MICHIGAN.

For Tax ID #I-09-17-425-012 parcel (169 Barton Drive)

Lot 4, Long Shore Park, as recorded in Liber 5, Page 39, of Plats, Washtenaw County Records, Ann Arbor Township, Washtenaw County, Michigan.

For Tax ID #I-09-23-375-008 parcel (3175 Glazier Way)

OLD SID – I 09-023-021-00 AA 23-9 HS COM AT SW COR OF SEC, TH E 979 FT IN S LINE OF SEC FOR A PL OF BEG, TH DEFL 88 DEG 54' TO THE LEFT 421.30 FT, TH DEFL 90 DEG TO RIGHT 203.36 FT TH DEFL 90 DEG TO RIGHT 417.40 FT TO S LINE OF SEC, TH W 203.45 FT IN S LINE OF SEC TO THE PL OF BEG, BEING A PART OF W ½ OF SW ¼ SEC 23 T2S R6E 1.96 AC.

October 2007 Annexations and Zonings 1

Parcel and Zoning Map 1

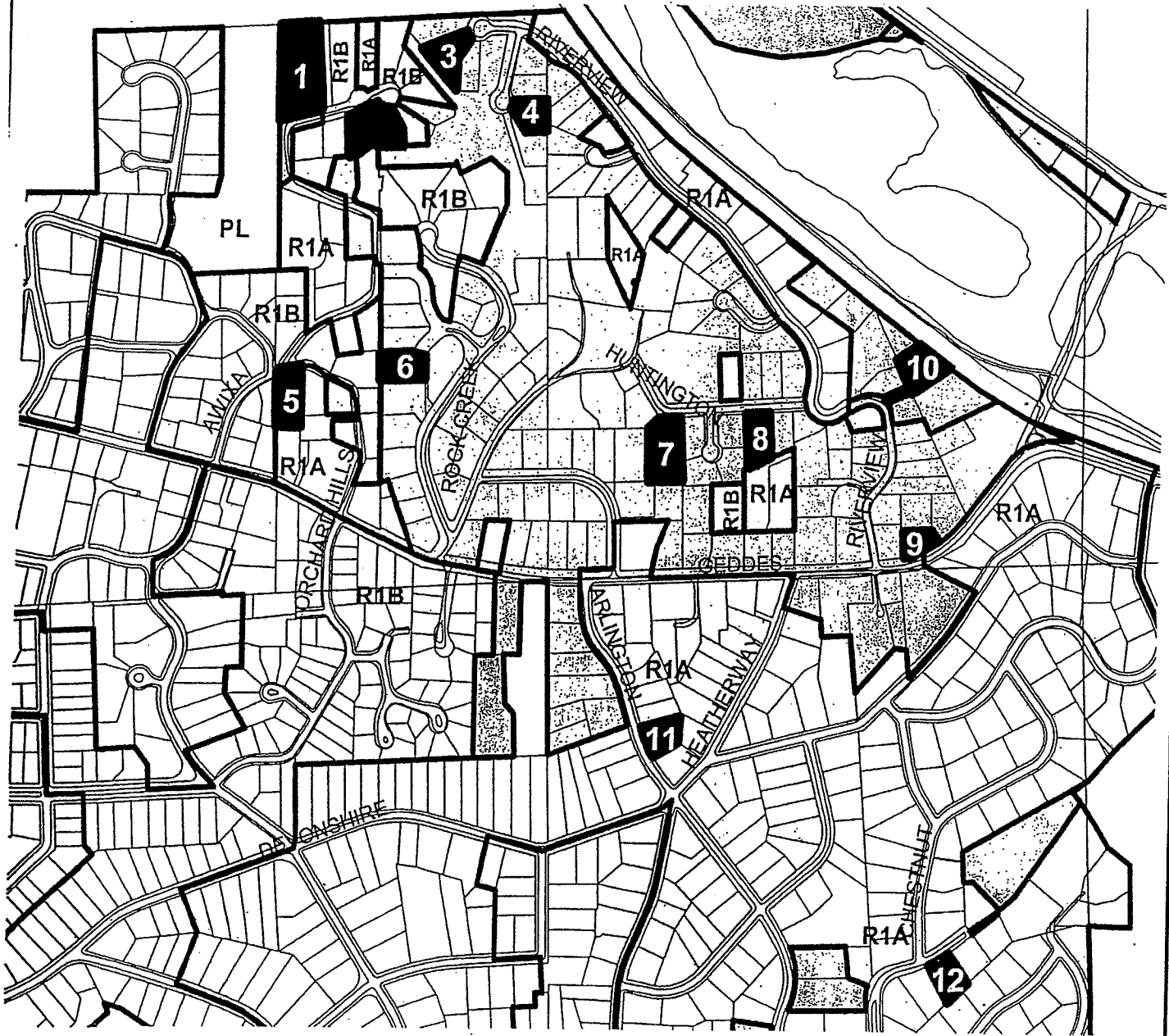

1. Porter/Crispell (200 Orchard Hills)

3. Salmeen (186 Riverview Ct)

4. McNamara (225 Pineview Ct)

5. Gilpin (402 Orchard Hills Dr)

6. Bonds/Mau (370 Rock Creek Dr)

7. Gross/Ellsworth (422 Huntington Pl)

8. Gates (442 Huntington Pl)

9. Connellan (3125 Geddes Ave)

10. Cares (505 Riverview Dr)

11. Dazy (865 Arlington Blvd)

12. Jokelainen (2930 Heatherway)

200 0 200 400 Feet

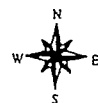

October 2007 Annexations and Zonings

Parcel and Zoning Map 3

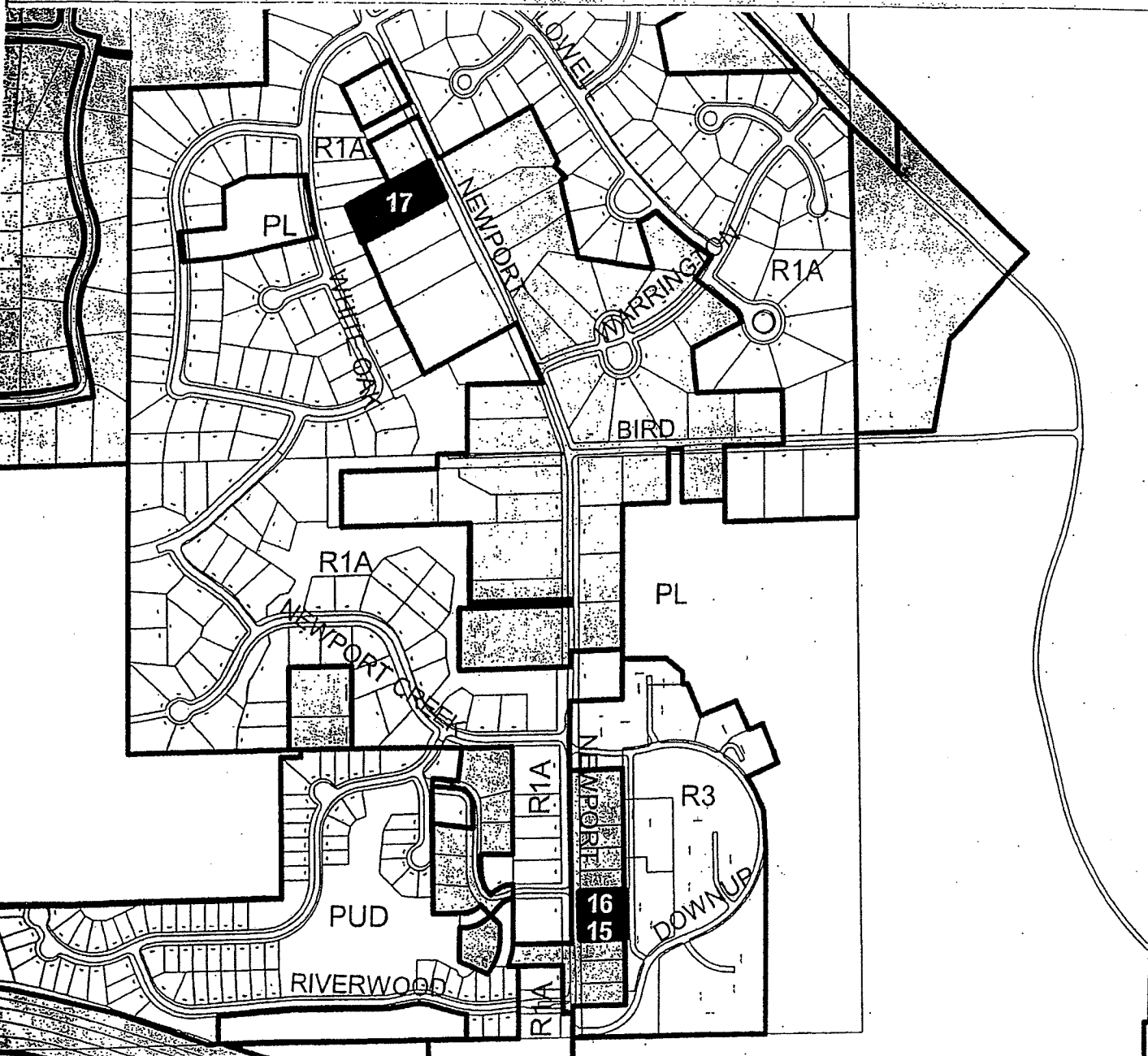

- 15. Zelnik (2060 Newport)
- 16. Yocum (2080 Newport)
- 17. Bogdasarian (2625 Newport)

200 0 200 400 Feet

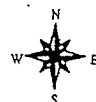
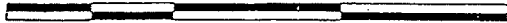

October 2007 Annexations and Zonings

Parcel and Zoning Map 2

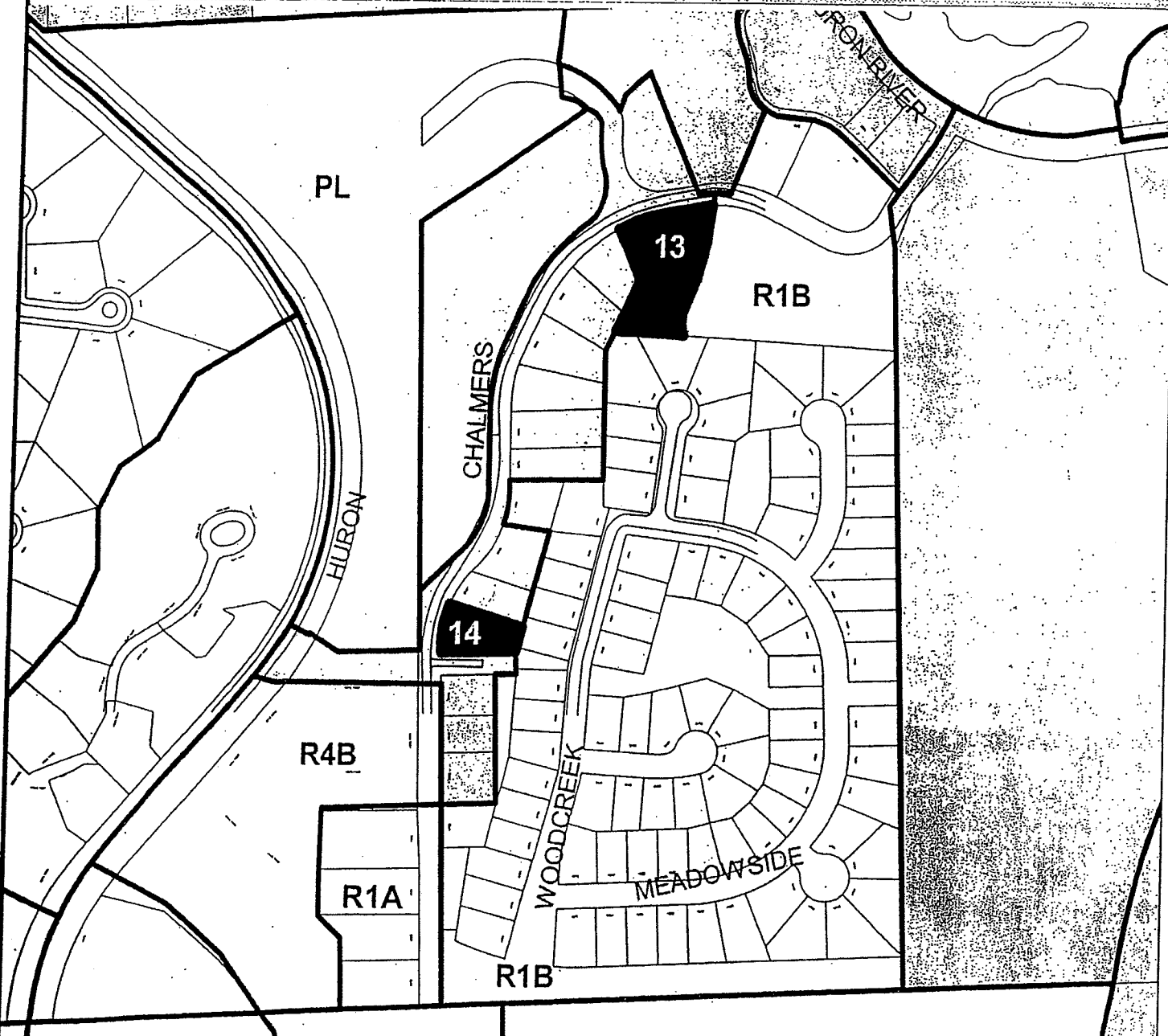

- 13. Lindsay (1305 Chalmers Dr)
- 14. Bennett/Wahlman (1575 Chalmers Dr)

200 0 200 400 Feet



Rosenblum (3451 Geddes Ave.) Annexation and Zoning

Parcel and Zoning Map

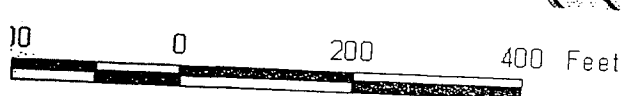
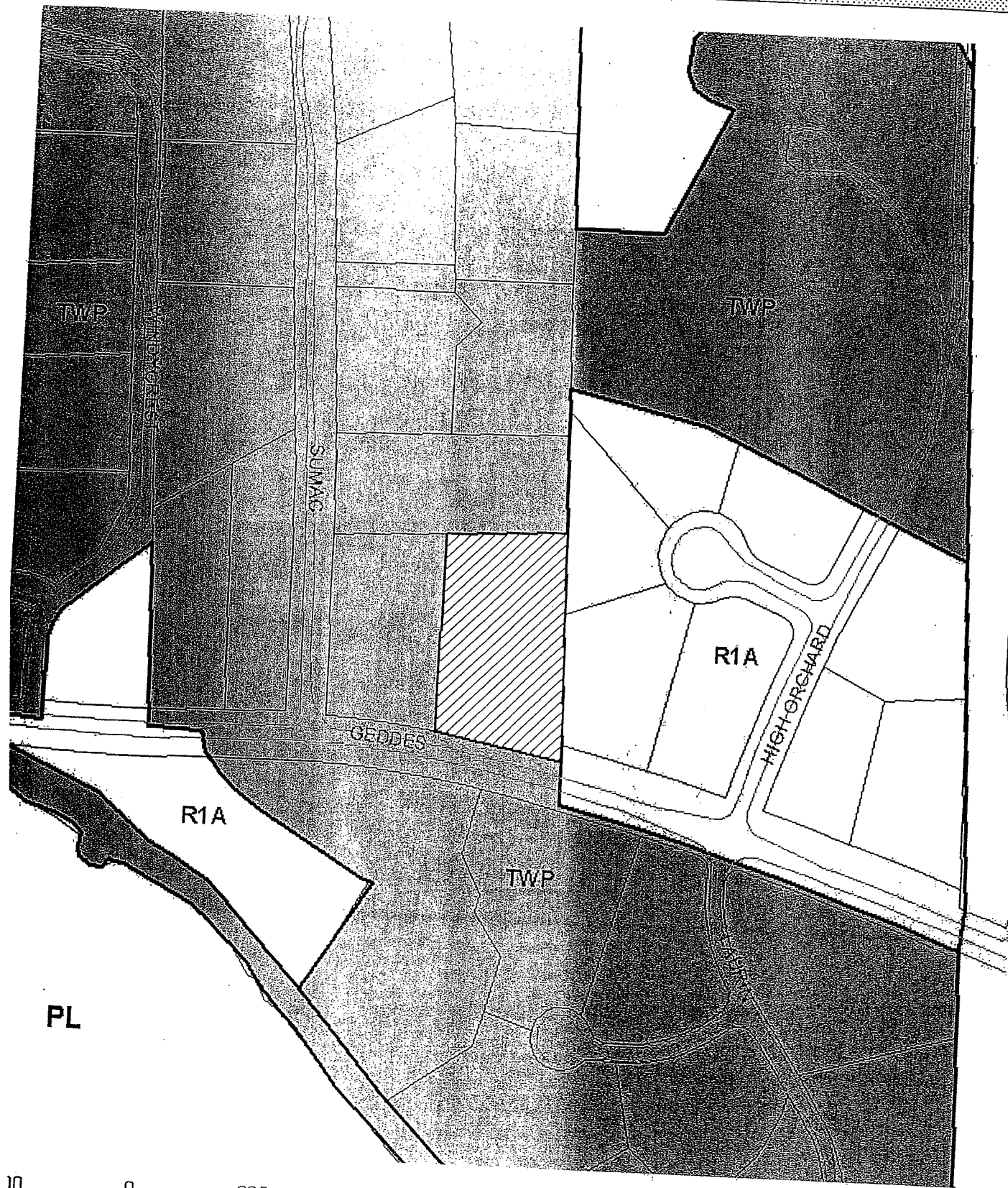

169 Barton

Parcel and Zoning Map

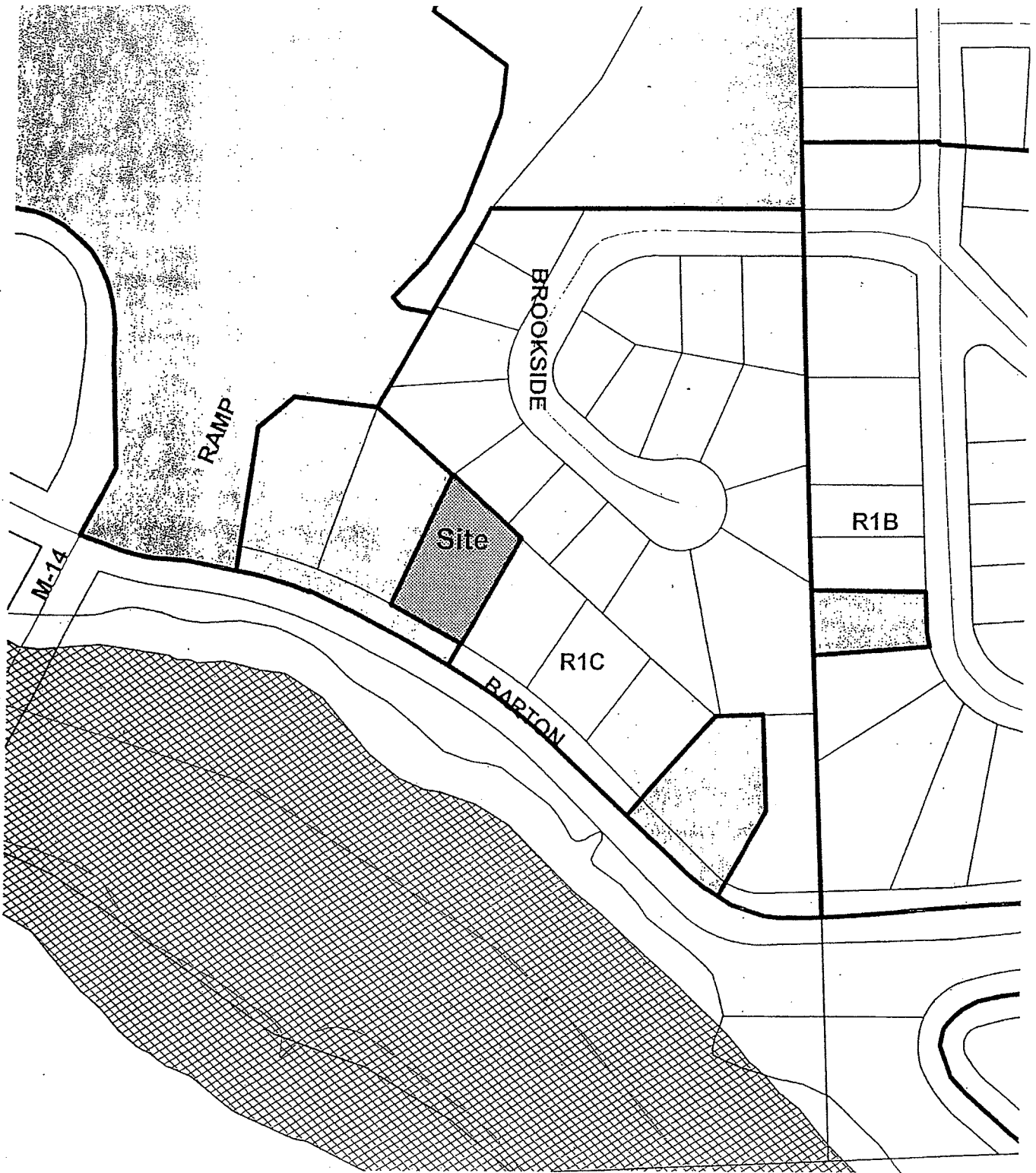

200 0 200 400 Feet

Township
Floodway
Floodplain



3175 Glazier Way

Parcel & Zoning Map

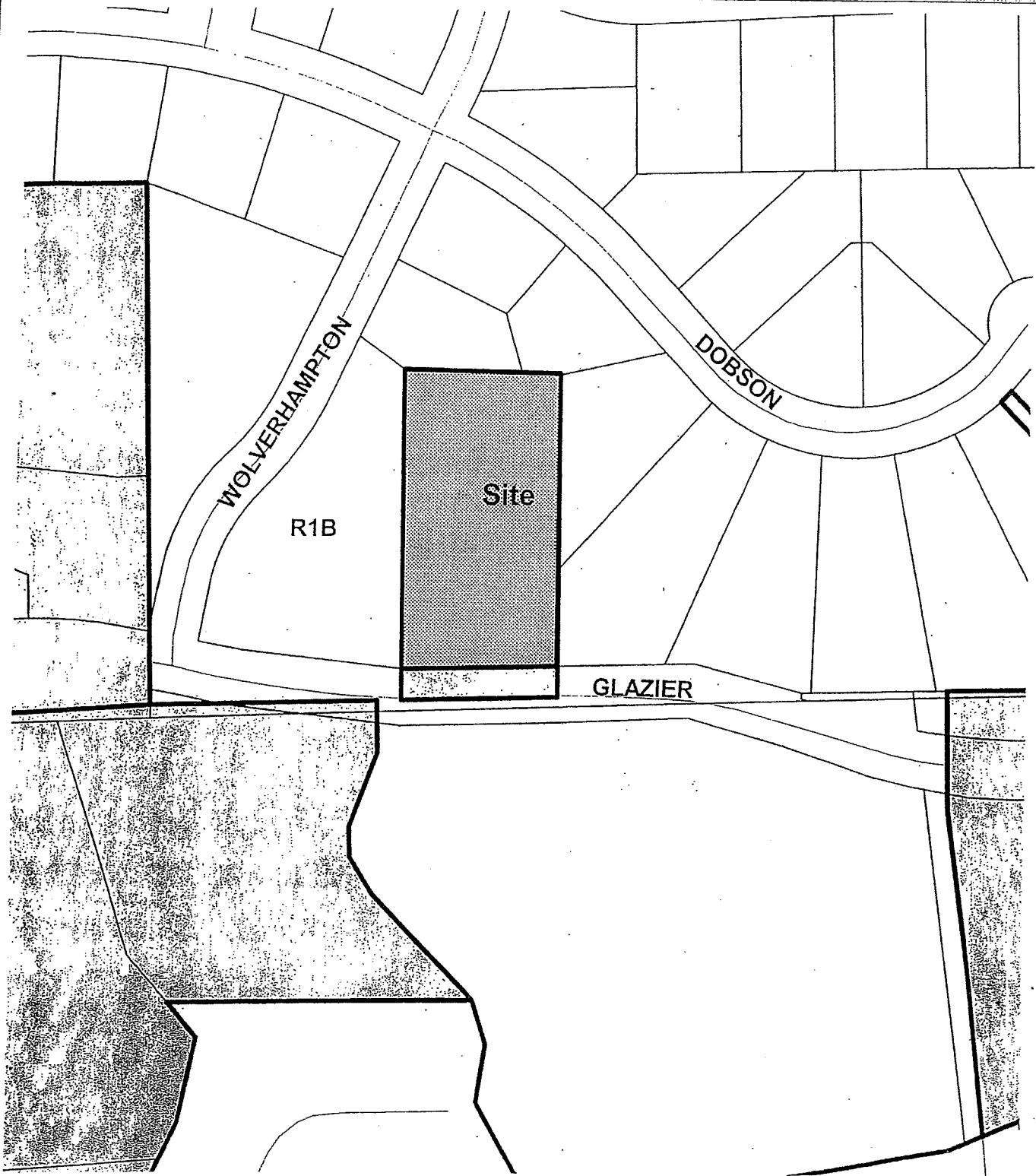

200 0 200 400 Feet

 Township

