

CITIES
Washtenaw County

In the matter of the annexation of certain property located in Ann Arbor Charter Township to the City of Ann Arbor. Annexed in accordance with the provisions of Public Act 359 of 1947, as amended the following described property:

OLD SID - I 09-027-074-00 27-28 COM AT SE COR OF LOT 6, HUNTINGTON WOODS SUB. NO. 1, TH N 01 DEG 36' W 13.32 FT FOR PL OF BEG, TH CONT N 01 DEG 36' W 161.07 FT, TH N 88 DEG 24' E 71.74 FT, TH SE'LY 131.61 FT IN ARC OF CURVE CONCAVE TO NE OF RADIUS 115.85 FT, CHORD BEARS S 60 DEG 50' 19' 124.65 FT, TH S 49 DEG 49' W 13.89 FT, TH SW'LY 28.04 FT IN ARC OF CURVE CONCAVED TO NW OF 247.42 FT RADIUS CHORD BEARS S 53 DEG 03' 46" W 28.02 FT, TH S 4 DEG 20' E 14.05 FT, TH SW'LY 46.81 FT IN ARC OF CURVE CONCAVED TO NW OF 259.92 FT RADIUS, CHORD BEARS S 63 DEG 00' 25" W 46.75 FT, TH S 68 DEG 10' W 110.40 FT TO P.O.B., BEING PART S E 1/4 SEC 27 T2S R6E 0.39 AC.

Record of proceedings filed in the Office of the Secretary of State October 18, 2007

448 Huntington Place

Parcel and Zoning Map

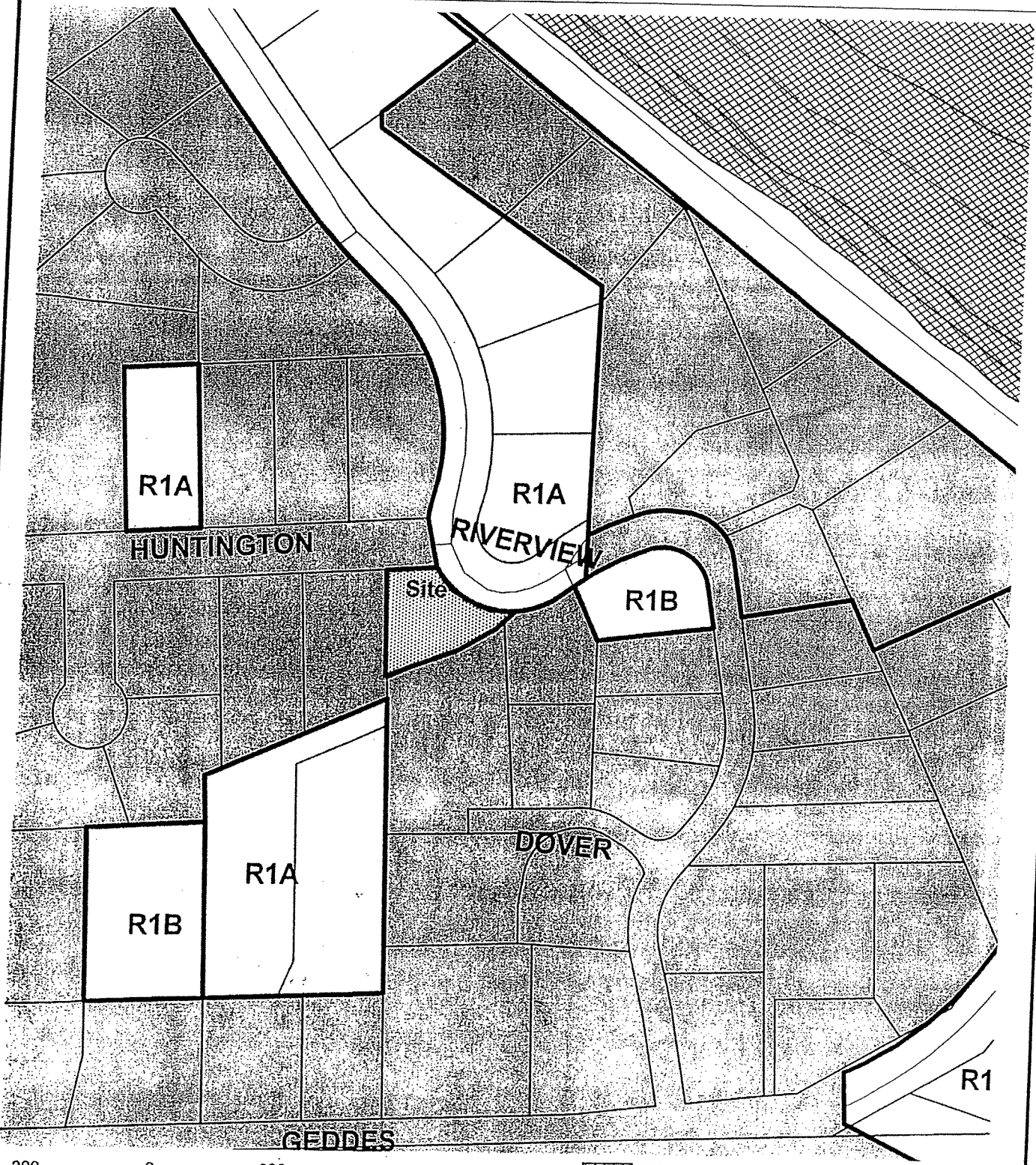

200 0 200 400 Feet

- Floodway
- Floodplain
- Township

