



STATE OF MICHIGAN  
JOCELYN BENSON, SECRETARY OF STATE  
DEPARTMENT OF STATE  
LANSING

ANN ARBOR  
CITY CLERK

JUN 07 19

TIME: \_\_\_\_\_

May 31, 2019

Ms. Jacqueline Beaudry, City Clerk  
Washtenaw County  
PO Box 8647  
Ann Arbor, MI 48107-8647

RE: Annexation of Property

Dear Ms. Beaudry:

This letter serves to acknowledge the Office of the Great Seal's receipt on May 07, 2019, of the filing of the annexation pursuant to Public Act 279 of 1909 as amended, from Ann Arbor Township to the City of Ann Arbor. The receipt date is the effective date of this boundary change. This filing is designated as Job Number 19-008.

All property descriptions for any boundary changes are reviewed by the Michigan Department of Transportation (MDOT), and then published annually in the Michigan Public and Local Acts manual. If any property description is found inaccurate by MDOT, this office will contact you at that time and request a corrected description, which will not impact the effective date of the boundary change.

\*\*\*\*\*No further acknowledgment will be sent\*\*\*\*\*

Sincerely,

Mark D Diljak, Analyst  
Bureau of Elections/Office of the Great Seal  
Telephone: (517)241-1832

cc: Ann Arbor Township Clerk  
Washtenaw County Clerk  
Michigan Department of Labor and Economic Growth, State Boundary Commission/Office of Land Survey and Remonumentation  
Michigan Department of Technology Management and Budget, Center for Shared Solutions & Technology Partnerships  
Michigan Department of Treasury, Office of Revenue and Tax Analysis  
Michigan Department of Transportation, Bureau of Transportation Planning  
U.S. Bureau of the Census

Office of the Great Seal Job Number: 19-008

JUN 07 2019 10:00 AM

Cities  
Washtenaw County

In the matter of the annexation of certain property located in Ann Arbor Township to the City of Ann Arbor. Annexed in accordance with the provisions of Public Act 279 of 1909, as amended the following described property:

Commencing at the N  $\frac{1}{4}$  corner of Section 18, T2S, R6E, Ann Arbor Township, Washtenaw County, Michigan; thence along the North line of said Section 18 and the centerline of Newport Road N 89 degrees 32' 30" E 43.16 feet; thence S 26 degrees 33' 30" E 976.55 feet for a Place of Beginning thence continuing along the centerline of Newport Road S 26 degrees 33' 30" E 215.77 feet; thence S 63 degrees 26' 30" W 241.0 feet; thence N 26 degrees 33' 30" W 215.77 feet; thence N 63 degrees 26' 30" E 241.0 feet to the Place of Beginning, being a part of the NE  $\frac{1}{4}$  of Section 18, T2S, R6E, Ann Arbor Township, subject to the rights of the public over the easterly 33 feet thereof as occupied by Newport Road

Commonly known as: 2705 Newport Road, Ann Arbor, MI 48103



## CITY OF ANN ARBOR, MICHIGAN

301 E. Huron Street, P.O. Box 8647, Ann Arbor, Michigan 48107-8647  
Phone (734)794-6140 Fax (734)994-8296 email: [cityclerk@a2gov.org](mailto:cityclerk@a2gov.org)

[www.a2gov.org](http://www.a2gov.org)

City Clerk

May 3, 2019

Office of the Great Seal  
Michigan Department of State  
717 Allegan St.  
Lansing, MI 48918-1750

2019 MAY -7 AM 9:59  
OFFICE OF THE GREAT SEAL  
MICHIGAN DEPARTMENT OF STATE

Re: Annexation from Ann Arbor Township  
(City File No. A19-001 and Z19-001)

To Whom It May Concern:

Enclosed is a certified copy of the annexation resolution adopted by the Ann Arbor City Council at its regular session of April 15, 2019, relative to the Picazo/Erb-Downward Property, 1.19 acre, located at 2705 Newport Road in Ann Arbor Township. Submitted with the City resolution are copies of the township resolution and the petition for the annexation, both containing property descriptions.

Sincerely,

Jacqueline Beaudry  
City Clerk

Encl. 3

cc: Lawrence Kestenbaum, Washtenaw County Clerk/Register

State County Annexation.



# City of Ann Arbor

301 E. Huron St.  
Ann Arbor, MI 48104  
<http://a2gov.legistar.com/Calendar.aspx>

## Certified Copy

Resolution/Public Hearing: R-19-184

File Number: 19-0621

Enactment Number: R-19-184

Resolution to Approve the Picazo/Erb-Downward Annexation, 1.16 Acres, 2705 Newport Road  
(CPC Recommendation: Approval - 8 Yeas and 0 Nays)

Whereas, The territory hereinafter described is located in the Township of Ann Arbor and is adjacent to the corporate limits of the City of Ann Arbor;

Whereas, Ingrid Picazo and John Erb-Downward are the owners of said property; and

Whereas, It is the desire of Ingrid Picazo and John Erb-Downward to annex said territory to the City of Ann Arbor, pursuant to the provisions of Public Act 279 of 1909 or Public Act 359 of 1947 of the State of Michigan, as amended;

RESOLVED, That the following described lands and premises situated and being in the Township of Ann Arbor, Washtenaw County, Michigan, be detached from said Township and annexed to the City of Ann Arbor:

Commencing at the N ¼ corner of Section 18, T2S, R6E, Ann Arbor Township, Washtenaw County, Michigan; thence along the North line of said Section 18 and the centerline of Newport Road N 89 degrees 32' 30" E 43.16 feet; thence S 26 degrees 33' 30" E 976.55 feet for a Place of Beginning thence continuing along the centerline of Newport Road S 26 degrees 33' 30" E 215.77 feet; thence S 63 degrees 26' 30" W 241.0 feet; thence N 26 degrees 33' 30" W 215.77 feet; thence N 63 degrees 26' 30" E 241.0 feet to the Place of Beginning, being a part of the NE ¼ of Section 18, T2S, R6E, Ann Arbor Township, subject to the rights of the public over the easterly 33 feet thereof as occupied by Newport Road

Commonly known as: 2705 Newport Road, Ann Arbor, MI 48103

I, Jacqueline Beaudry, Clerk of the City of Ann Arbor, Michigan, certify that this is a true copy of Resolution/Public Hearing R-19-184, passed by the Ann Arbor City Council on 4/15/2019.

Attest:   
Jacqueline Beaudry

April 24, 2019  
Date Certified

**ANN ARBOR CHARTER TOWNSHIP  
RESOLUTION TO APPROVE ANNEXATION**

**WHEREAS**, the territory described is located in Ann Arbor Township within the area to be annexed to the city of Ann Arbor under the 1994 Policy Statement between the City of Ann Arbor and Ann Arbor Township, and

**WHEREAS**, a petition to annex said territory to the City of Ann Arbor, signed by persons or entities who collectively hold record legal title to all of the land in said territory, has been filed with the Township Board, and requests annexation to the City for the purpose of connecting to city utilities, and

**WHEREAS**, the well serving the property is failing, and

**WHEREAS**, land owners

John Erb-Downward and Ingrid Picazo

have filed a petition for release for annexation

**NOW, BE IT RESOLVED**, that the following described lands and premises situated and being in Ann Arbor Charter Township, Washtenaw County, Michigan, be released from the Township in order to be annexed to the City of Ann Arbor, to-wit:

Parcel ID# I -09-18-150-003 (2705 Newport Road, Ann Arbor, MI)

\*OLD SID - I 09-018-013-30 AA 18-4A-4 COM AT N 1/4 COR OF SEC, TH N 89-32-30 E 43.16 FT IN N/L OF SEC, TH S 26-33-30 E 976.55 FT FOR POB, TH S 26-33-30 E 215.77 FT, TH S 63-26-30 W 241.00 FT, TH N 26-33-30 W 215.77 FT, TH N 63-26-30 E 241.00 FT TO POB, BEING PART OF NE 1/4 SEC 18 T2S R6E 1.19 AC

I hereby certify that the foregoing constitutes a true and complete copy of a resolution adopted by the Board of Ann Arbor Charter Township, Washtenaw County, Michigan, at its regular meeting held on March 18, 2019.



\_\_\_\_\_  
Rena Basch, Clerk  
Ann Arbor Township

1-3-19



# PETITION APPLICATION

**City of Ann Arbor Planning Services** City Hall: 301 E Huron Street Ann Arbor, MI 48107-8647  
 Phone: 734-794-6265 Fax: 734-794-8460 Email:

PROJECT NAME: 1-09-18-150-003			
PROJECT TYPE: (SELECT ALL THAT APPLY)			
<input type="checkbox"/> Site Plan for City Council Approval	<input type="checkbox"/> Planned Project Modification	<input checked="" type="checkbox"/> Annexation	
<input type="checkbox"/> Site Plan for Planning Commission Approval	<input type="checkbox"/> Special Exception Use	<input type="checkbox"/> Rezoning	
<input type="checkbox"/> Site Plan for Administrative Amendment	<input type="checkbox"/> Land Division	<input type="checkbox"/> Other _____	
<input type="checkbox"/> Planned Unit Development Site Plan	<input type="checkbox"/> Land Transfer		
PROJECT ADDRESS: 2705 Newport Rd.	CITY: Ann Arbor	State: MI	ZIP: 48103
PARCEL ZONING:	PARCEL SIZE: 1.19 acres	NUMBER OF PROPOSED RESIDENTIAL UNITS: 1	
SQUARE FOOTAGE OF PROPOSED CONSTRUCTION:			
DESCRIPTION OF PROPOSED PROJECT:			
PROJECT PRE-SUBMISSION MEETING DATE:		PRE-SUBMISSION MEETING PLANNER NAME:	
PROPERTY OWNER John R. Erb-Downward and Ingrid Picazo			
PHONE: (734) 846-4494		EMAIL: jre@umich.edu	
ADDRESS: 2705 Newport Rd.			
NAME: Ingrid Picazo		NAME:	
John R. Erb-Downward			
PHONE: (734) 846-4494		CONTACT PERSON:	
EMAIL: jre@umich.edu		PHONE:	
ADDRESS: 2705 Newport Rd.		EMAIL:	
INTEREST IN PROPERTY: owner		ADDRESS:	



**City of Ann Arbor**  
**PLANNING & DEVELOPMENT SERVICES — PLANNING DIVISION**  
301 East Huron Street | P.O. Box 8647 | Ann Arbor, Michigan 48107-8647  
p 734.794.6265 | f 734.994.8312 | [planning@a2gov.org](mailto:planning@a2gov.org)

**PETITION FOR ANNEXATION BY RELEASE**

The Planning Department would like to take this opportunity to welcome you as a member of our community. Annexation to the City will provide you with the same benefits available to Ann Arbor Citizens. These benefits include fire and police protection, use of City parks; refuse pick-up and recycling services, eligibility for City water and sewer lines, and participation on City boards and commissions. We are looking forward to your involvement in our community and hope that you will enjoy the many advantages the City of Ann Arbor has to offer.

To: The **TOWNSHIP BOARD OF ANN ARBOR CHARTER TOWNSHIP**, Washtenaw County, Michigan and the City Council of the City of Ann Arbor, Michigan.

We, the undersigned, respectfully petition your honorable bodies that the following described land be detached from the **ANN ARBOR CHARTER TOWNSHIP** and annexed to the City of Ann Arbor by affirmative majority vote of the Ann Arbor City Council and approval of the **ANN ARBOR CHARTER TOWNSHIP BOARD**, in accordance with the provisions of Public Act 359 of 1947, State of Michigan, AS AMENDED.

The land proposed to be detached from the **ANN ARBOR CHARTER TOWNSHIP** and annexed to the City of Ann Arbor is described as follows, to wit: *(legal description)*

see attached.  
\_\_\_\_\_  
\_\_\_\_\_

Property Tax I.D. #

1-09-18-150-003  
\_\_\_\_\_

We further represent as follows:

- 1) That the above described land is contiguous to the corporate limits of the City of Ann Arbor, Michigan, or within an area being served by said City.
- 2) That there are no qualified electors residing on the land proposed to be annexed other than the petitioners.
- 3) That the petitioner(s), John Erb-Dennard + Ingrid Picazo, is/are the owners (owner, land contract, option to purchase) of the land proposed to be annexed.

- 4) That if the petitioner(s) is/are not the owner, the owner has given consent to petitioner(s) to request release for annexation by Ann Arbor Charter Township and to annex to the City of Ann Arbor. (Consent is to be attached.)
- 5) That the whole of the area of land proposed to be annexed is 1 acres, of which \_\_\_\_\_ acres of land are in public roads.
- 6) That release for annexation by Ann Arbor Charter Township will not result in leaving a land-locked parcel or a non-conforming parcel in Ann Arbor Charter Township.
- 7) That the person(s) liable for the payment of any outstanding improvement charges acknowledges full knowledge thereof, and consents to pay same in accordance with the resolution to be adopted by the City Council pursuant to Section 1:278 of Chapter 12, Title I of the City Code of the City of Ann Arbor, Michigan.
- 8) That all Township property taxes have been paid in full.
- 9) That the number of people residing on the land requested for annexation is 4.
- 10) That, of the number of people residing on the land requested for annexation, the number of renters is 0.
- 11) That the reason(s) for requesting annexation are as follows: (You must provide a reason or your application may be denied).

We need water.  
\_\_\_\_\_  
\_\_\_\_\_  
\_\_\_\_\_

Date: Jan 03, 2019

PETITIONER(S)

Signature: [Handwritten Signature]

Printed Name: Jim R. Erb-Bannawell

Address: 2705 Newport Rd. City/State/Zip Ann Arbor, MI 48103

Telephone No. 734-623-0752

Signature: [Handwritten Signature]

Printed Name: Ingrid Picazo

Address: 2705 Newport Rd. City/State/Zip Ann Arbor, MI 48103

Telephone No. (734) 846-7699



OWNER: (If different from Petitioner)

Signature: Ingrid Picazo

Printed Name: Ingrid Picazo

Address: 2705 Newport Rd. City/State/Zip Ann Arbor, MI 48103

Telephone No. (734) 846-7699

STATE OF MICHIGAN  
COUNTY OF Washtenaw

On this 3rd day of January, 2019, before me personally appeared the above-named petitioner(s)/owner(s), who being duly sworn, say that they have read the foregoing petition by them signed, and know the contents thereof, and that the same is true of their knowledge, except as to the matter therein stated to be upon their information and belief, and as to those matters they believe it to be true.

Signature: [Signature]

Printed Name: Luis Escudero-Flores

My Commission expires: 10/23/2019

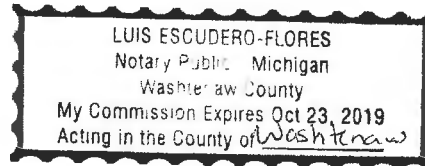

\*\*\*\*\*

Petition presented to Township Board: \_\_\_\_\_

Township Board Decision: \_\_\_\_\_ Approved \_\_\_\_\_

\_\_\_\_\_  
\_\_\_\_\_

FILE NO. M104836

PARCEL ID I-09-18-150-003

**EXHIBIT A/LEGAL DESCRIPTION**

Land is located in the Township of Ann Arbor, County of Washtenaw, State of Michigan, and described as follows:

Parcel B:

Commencing at the N 1/4 corner of Section 18, T2S, R6E, Ann Arbor Township, Washtenaw County, Michigan; thence along the North line of said Section 18 and the centerline of Newport Road N 89 degrees 32' 30" E 43.16 feet; thence S 26 degrees 33' 30" E 976.55 feet for a Place of Beginning thence continuing along the centerline of Newport Road S 26 degrees 33' 30" E 215.77 feet; thence S 63 degrees 26' 30" W 241.0 feet; thence N 26 degrees 33' 30" W 215.77 feet; thence N 63 degrees 26' 30" E 241.0 feet to the Place of Beginning, being a part of the NE 1/4 of Section 18, T2S, R6E, Ann Arbor Township, subject to the rights of the public over the easterly 33 feet thereof as occupied by Newport Road.

Commonly known as: 2705 Newport Rd, Ann Arbor, MI 48103.

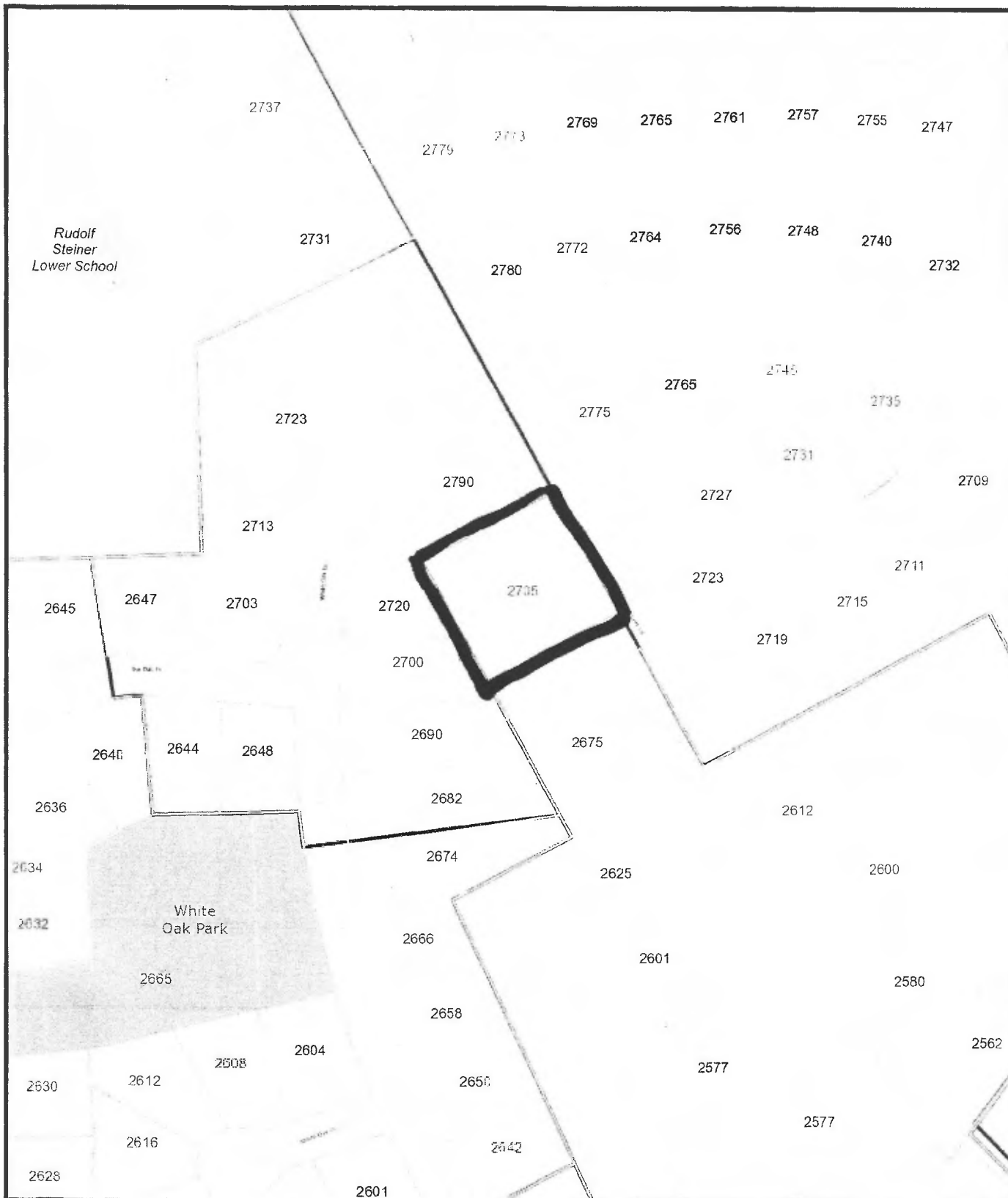

Rudolf Steiner Lower School

White Oak Park



1: 2,400

1/10/2019



Geographic Information System

NOTE: Parcels may not be to scale.

The information contained in this cadastral map is used to locate, identify and inventory parcels of land in Washtenaw County for appraisal and taxing purposes only and is not to be construed as a "survey description". The information is provided with the understanding that the conclusions drawn from such information are solely the responsibility of the user. Any assumption of legal status of the data is hereby disclaimed.